









**T 17 & T. 18 S., R. 47 E., W.M. MALHEUR COUNTY, OREGON**

**POINT OF DIVERSION**

SNAKE RIVER 1353 FEET SOUTH AND 2545 FEET EAST FROM THE NW CORNER OF SECTION 11

**LEGEND**

-  STORAGE RESERVOIR
-  TREATMENT PLANT
-  UGB
-  PLACE OF USE PER THE PERMIT
-  CITY LIMITS
-  TOWNSHIP LINE
-  SECTION LINE
-  1/4 SECTION AND 1/4 1/4 SECTION LINES
-  TAXLOTS

**PLACE OF USE PERMIT S-43401**

T. 17 S., R 47 E.  
SECTION 33 - SE 1/4

T. 18 S., R 47 E.  
SECTION 2  
SECTION 3  
SECTION 4  
SECTION 5 - E 1/2, SE 1/4, SW 1/4  
SECTION 7  
SECTION 8 - N 1/2, SE 1/4  
SECTION 9  
SECTION 10  
SECTION 11

Received

MAY 20 2026

OWRD



RENEWS: 12/31/26  
SIGNED: 3/6/26

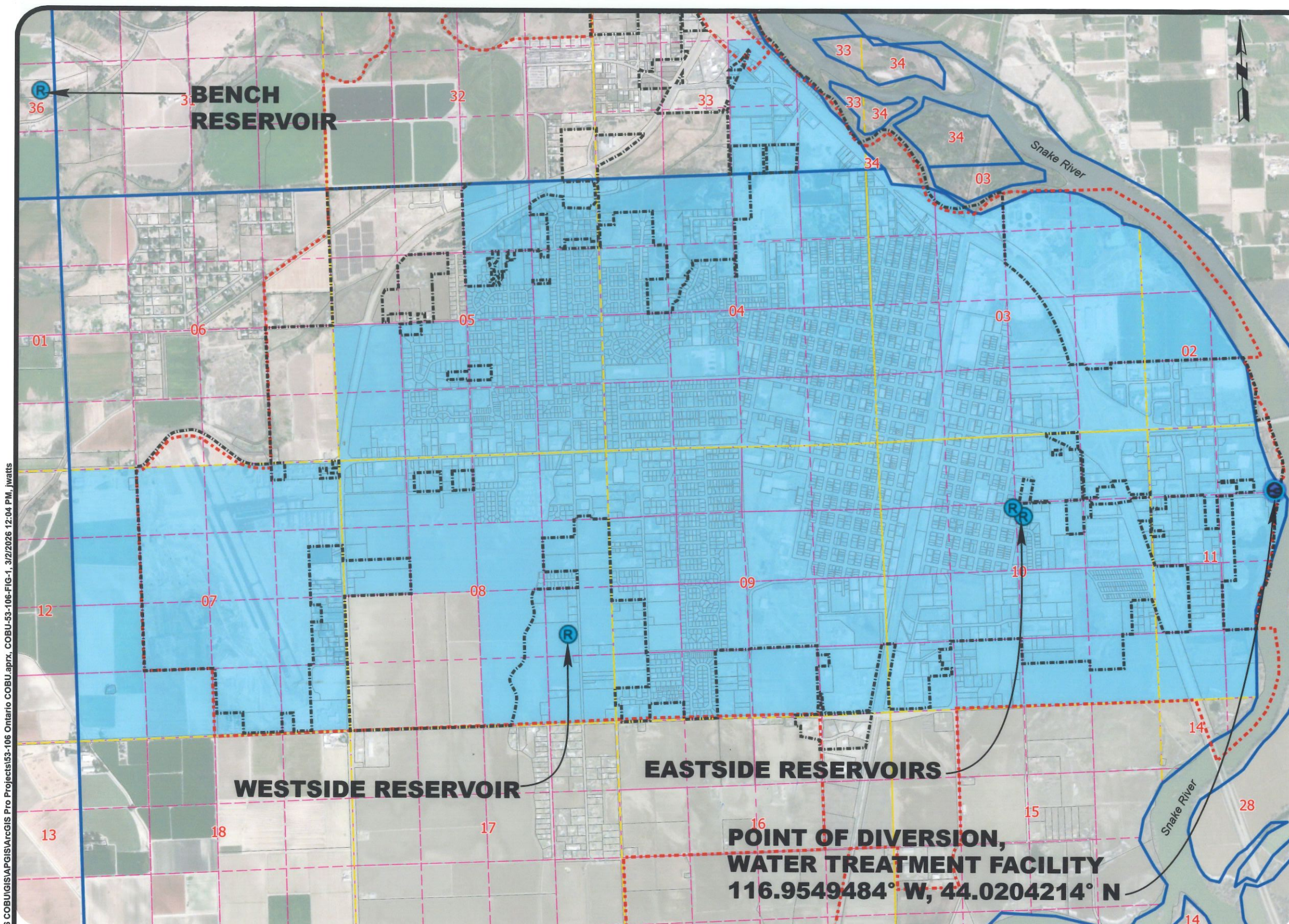

**NOTES**

1. THIS MAP IS FOR THE PURPOSE OF LOCATING A WATER RIGHT ONLY AND IS NOT INTENDED TO PROVIDE LEGAL DIMENSIONS OR LOCATIONS OF PROPERTY LINES
2. DATE OF SURVEY: JUNE 2025

3. DISTRIBUTION SYSTEM NOT SHOWN FOR CLARITY
4. THE PLACE OF USE FOR THIS MUNICIPAL RIGHT IS THE CITY OF ONTARIO'S SERVICE AREA AND DOES NOT EXACTLY MATCH THE PLACE OF USE DESCRIBED IN THE PERMIT



CITY OF  
ONTARIO, OREGON  
APPLICATION #S-57572 , PERMIT #S-43401

**CLAIM OF BENEFICIAL USE MAP**

**FIGURE**

**1**

Received

OWRD