

RECEIVED

APR - 6 1994

SURFACE WATER REGISTRATION  
IN THE NAME OF JOHN W. OR ANNA E. BRANDS  
WATER RESOURCES DEPT.  
SALEM, OREGON

DESCRIPTION OF THE DELIVERY SYSTEM

A ten horsepower electric motor with centrifugal pump delivers water to one metal stocktank and 30.8 acres of irrigation via a five inch diameter main line and three inch diameter lateral lines through an elevation range of thirty feet. A normal sprinkler set consists of 24 model 30H Rainbird sprinklers operating at 50 psi.

CAPACITY OF THE DELIVERY SYSTEM

$$USING Q_{PUMP} = \frac{C \times HP}{H_{TOTAL}}$$

WHEN

$$C = 6.61$$

$$HP = 10$$

$$H_{ELEVATION} = 30 \text{ FT.}$$

$$H_{PRESSURE} = 50 \text{ psi} = 116 \text{ FT.}$$

$$H_{FRICTION} = 10 \text{ FT. (ESTIMATED)}$$

THEN

$$Q_{PUMP} = \frac{(6.61)(10)}{30+116+10} = \frac{66.1}{156} = 0.424 \text{ cfs}$$

$$Q_{CLAIM} = 0.390 \text{ cfs}$$

$$Q_{PUMP} > Q_{CLAIM} \text{ O.K.}$$

$$Q_{HEADS} = (24)(7.87) = 189 \text{ GPM} = 0.421 \text{ cfs}$$

$$Q_{HEADS} = Q_{CLAIM} \text{ O.K.}$$

**JAMES F. GOSSON** Consulting Engineer

580 South State Street  
Sutherlin, Oregon 97479

CIVIL ENGINEER  
LAND SURVEYOR  
WATER RIGHTS EXAMINER

(503) 459-2243

**RECEIVED**

**APR - 6 1994**

WATER RESOURCES DEPT.  
SALEM, OREGON

April 5, 1994

Oregon Water Resources Department  
158 12th Street, N.E.  
Salem, Oregon 97310

Attention: Don Knauer

Re: Surface Water Registration 588 (Brands)

Dear Don,

Enclosed is a Surface Water Registration map along with information on the delivery system.

Please contact me if you have any questions, or need additional information.

Very truly yours,

  
James F. Gosson

cc: John Brands

Enclosures

JFG/p

RECEIVED

FEB - 7 1994

580 South State Street  
Sutherlin, Oregon 97479

**JAMES F. GOSSON** Consulting Engineer

CIVIL ENGINEER  
LAND SURVEYOR  
WATER RIGHTS EXAMINER

WATER RESOURCES DEPT  
SALEM, OREGON

(503) 459-2243

February 4, 1994

Oregon Water Resources Department  
3850 Portland Road, N.E.  
Salem, Oregon 97310

Attention: Donald Knauer

Re: Surface Water Registration #588 - Brands

Dear Don,

In response to your letter of January 27, 1994, I plan to make the field survey in February and prepare the map in March of this year.

Please contact me if you have any questions.

Very truly yours,

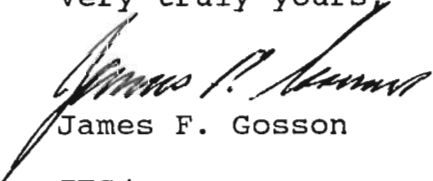
  
James F. Gosson

JFG/p



RECEIVED

JAN 05 1998

WATER RESOURCES DEPT.  
SALEM, OREGON

RECEIVED

JAN 05 1993

WATER RESOURCES DEPT.  
SALEM, OREGON

Watermaster's Office  
District No. 19  
Coos County Courthouse  
Coquille, OR 97423

Receipt

John Brands

Date: December 30, 1992

Amount: \$ 200<sup>00</sup>.

Pre-1989 application form.

Received by:

Jerry L Woody

RECEIVED

JAN 05 1993

WATER RESOURCES DEPT.  
SALEM, OREGON

# APPLICATION MAP

IN THE NAME OF JOHN W. OR ANNA E. BRANDS

SECTION 36, TOWNSHIP 25 SOUTH, RANGE 12 WEST, W.M.  
SECTION 31, TOWNSHIP 25 SOUTH, RANGE 11 WEST, W.M.  
SECTION 1, TOWNSHIP 26 SOUTH, RANGE 12 WEST, W.M.



1 INCH = 1320 FEET

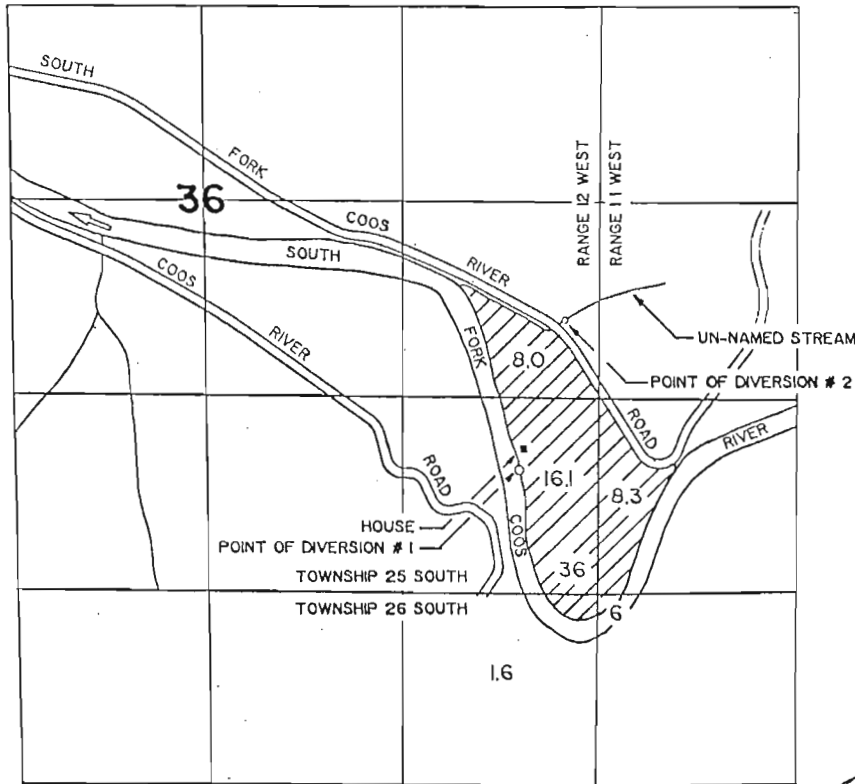

See letter from Dwight, this like May 4.

①

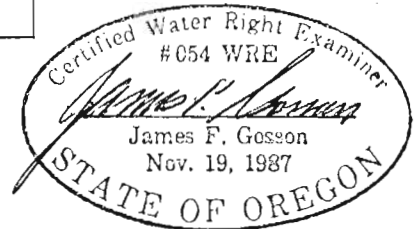

POINT OF DIVERSION #1 IS TO BE LOCATED 840 FEET NORTH AND 550 FEET WEST FROM THE SOUTHEAST CORNER OF SECTION 36, BEING WITHIN THE SE 1/4 OF THE SE 1/4 OF SECTION 36. POINT OF DIVERSION #2 IS TO BE LOCATED 1850 FEET NORTH AND 230 FEET WEST FROM THE SOUTHEAST CORNER OF SECTION 36, BEING WITHIN THE NE 1/4 OF THE SE 1/4 OF SECTION 36. BOTH POINTS OF DIVERSION BEING WITHIN TOWNSHIP 25 SOUTH, RANGE 12 WEST, W.M., COOS COUNTY.

THE PURPOSE OF THIS MAP IS TO IDENTIFY THE LOCATION OF THE WATER RIGHT. IT IS NOT INTENDED TO PROVIDE INFORMATION RELATIVE TO THE LOCATION OF PROPERTY OWNERSHIP BOUNDARY LINES.

**SURFACE WATER REGISTRATION CHECKLIST**

(received after July 18, 1990)

CHECK BASIN MAP DWF NAME SOUTH COAST # 17 UNADJUDICATED AREA ? OK DWF  
RECEIPT # 95984 S W R NUMBER 588  
CHECK ENCLOSURES DWF PRELIMINARY DATA BASE ENTRY DWF  
ACKNOWLEDGEMENT LETTER DWF ENTER ON STREAM INDEX \_\_\_\_\_  
CHECK QUADRANGLE MAP \_\_\_\_\_ CHECK GLO PLATS \_\_\_\_\_  
WATERMASTER CHECKLIST \_\_\_\_\_ PUBLIC NOTICE PUBLICATION SC8V

**FORM REVIEW**

\_\_\_\_\_ blanks filled in  
\_\_\_\_\_ signed  
\_\_\_\_\_ date received stamped

**MAP REVIEW**

source and trib  
 diversion point location  
 conveyances (pipes, ditch, etc.)  
 place of use  
 scale  
 township, range, section  
 north arrow  
 CWRE stamp  
 disclaimer  
\_\_\_\_\_ date survey was performed  
 P.O.B. of survey  
 dimensions and capacity of diversion system  
 "beneficial use" type title  
 "permanent-quality" paper

WATER RIGHT RECORD CHECK \_\_\_\_\_ FIELD INSPECTION \_\_\_\_\_  
FINAL FILE REVIEW \_\_\_\_\_ FINAL DATA BASE ENTRY \_\_\_\_\_  
ENTER ON PLAT CARDS \_\_\_\_\_

April 12, 1994

JAMES F GOSSON  
580 S STATE ST  
SUTHERLIN OR 97479

RE: SWR-588

Dear Jim,

This will acknowledge the receipt of map to support the pre-1909 vested water right claim in the name of JOHN & ANNA BRANDS you returned with corrections and completions. I have added the map to the file. Thank you for your attention to this matter. If you have any questions, please give me a call.

Sincerely,

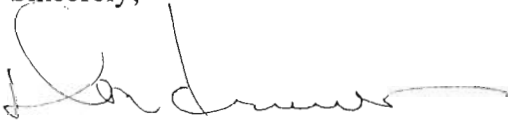

Don Knauer  
Adjudication Specialist

J:\WS\C\5\SWR-0588.003



---

Commerce Building  
158 12th Street NE  
Salem, OR 97310-0210  
(503) 378-3739  
FAX (503) 378-8130



January 27, 1994

JAMES GOSSON  
580 S STATE ST  
SUTHERLIN OR 97479

RE: Surface Water Registration Map SWR-588

Dear Jim,

JOHN OR ANNA BRANDS has indicated to the Oregon Water Resources Department (WRD) that you have been hired to prepare the claim of beneficial use map for their Surface Water Registration Statement. Would you please inform me of your anticipated schedule of map preparation and submission to the WRD.

Please mark all correspondence related to this claim with the file number SWR-588.

Sincerely,



Don Knauer  
Adjudication Specialist

J:\WP51\SWR\CLAIMANT\5\SWR-0588.002



---

3850 Portland Rd NE  
Salem, OR 97310  
(503) 378-3739  
FAX (503) 378-8130

May 4, 1993

JOHN W OR ANNA E BRANDS  
HC 52 BOX 260  
COOS BAY OR 97420

Dear JOHN & ANNA BRANDS,

This will acknowledge that your Surface Water Registration Statement in the name of JOHN W. OR ANNA E. has been received by our office. The fees in the amount of \$200.00 have been received and our receipt #95984 is enclosed. Your registration statement has been numbered SWR-588.

The map you submitted with your claim is not acceptable. The requirements for an application map and a map to accompany a Surface Water Registration Statement are different. The map that you sent with your Surface Water Registration Statement is a copy of the map that arrived here December 18, 1992. It is on file as application #73080.

We will not be able to process you claim until we have received a map that meets the standards required for Surface Water Registration (SWR). If you have any questions regarding this process, please do not hesitate to give me a call.

Within 60 days of this letter contracted with to prepare y my attention. You must ind statement map. We will cor

Please feel free to contact th

Sincerely,

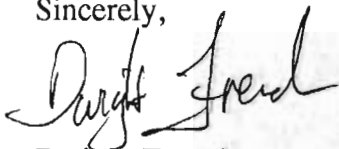

Dwight French  
Adjudication Section

Enclosure

J:\WP51\SWR\CLAIMANT\5\SWR-0588.001

*John BRANDS 267-41147 WK  
269-7269 HW*

*I spoke with John Brands this am. 7.9.93  
He now understands that there are diff.  
mapping requirements for SWR + new app. He  
will contact Mr. Gossen + send in an  
acceptable map. ASAP Dwight*



3850 Portland Rd NE  
Salem, OR 97310  
(503) 378-3739  
FAX (503) 378-8130

Application No. 73000  
Permit No. 73090  
APPLICATION MAP

RECEIVED

DEC 18 1992

IN THE NAME OF JOHN W. OR ANNA E. BRANDS WATER RESOURCES DEPT.  
SALEM, OREGON

SECTION 36, TOWNSHIP 25 SOUTH, RANGE 12 WEST, W.M.  
SECTION 31, TOWNSHIP 25 SOUTH, RANGE 11 WEST, W.M.  
SECTION 1, TOWNSHIP 26 SOUTH, RANGE 12 WEST, W.M.

1 INCH = 1320 FEET



ADDED TO FILE BY DWIGHT

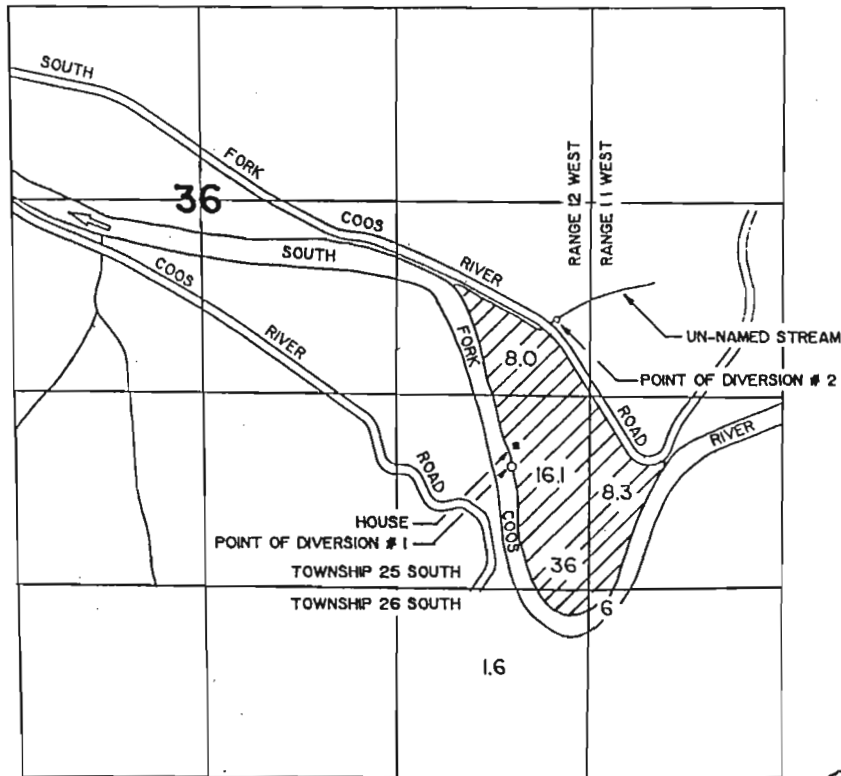

Certified Water Right Examiner  
#054 WRE  
*James F. Gosson*  
James F. Gosson  
Nov. 19, 1987  
STATE OF OREGON

POINT OF DIVERSION #1 IS TO BE LOCATED 840 FEET NORTH AND 550 FEET WEST FROM THE SOUTHEAST CORNER OF SECTION 36, BEING WITHIN THE SE 1/4 OF THE SE 1/4 OF SECTION 36. POINT OF DIVERSION #2 IS TO BE LOCATED 1850 FEET NORTH AND 230 FEET WEST FROM THE SOUTHEAST CORNER OF SECTION 36, BEING WITHIN THE NE 1/4 OF THE SE 1/4 OF SECTION 36. BOTH POINTS OF DIVERSION BEING WITHIN TOWNSHIP 25 SOUTH, RANGE 12 WEST, W.M., COOS COUNTY.

THE PURPOSE OF THIS MAP IS TO IDENTIFY THE LOCATION OF THE WATER RIGHT. IT IS NOT INTENDED TO PROVIDE INFORMATION RELATIVE TO THE LOCATION OF PROPERTY OWNERSHIP BOUNDARY LINES.

**STATE OF OREGON  
WATER RESOURCES DEPARTMENT**

RECEIPT # **95984**

3850 PORTLAND ROAD NE  
SALEM, OR 97310  
378-8455/378-8130 (FAX)

RECEIVED FROM: <u>John W Brands</u>	APPLICATION
BY:	PERMIT
	TRANSFER

CASH:  CHECK: # 2422 OTHER: (IDENTIFY)

TOTAL REC'D \$ 300.00

**01-00-0 WRD MISC CASH ACCT**

842.010	ADJUDICATIONS	\$ <u>300.00</u> ✓
831.087	PUBLICATIONS/MAPS	\$
830.650	PARKING FEES Name/month	\$
	OTHER: (IDENTIFY)	\$

**REDUCTION OF EXPENSE**

CASH ACCT.	\$
COST CENTER AND OBJECT CLASS	VOUCHER #

**03-00-0 WRD OPERATING ACCT**

**MISCELLANEOUS:**

840.001	COPY FEES	\$
850.200	RESEARCH FEES	\$
880.109	MISC REVENUE: (IDENTIFY)	\$
520.000	OTHER (P-6): (IDENTIFY)	\$

**WATER RIGHTS:**

842.001	SURFACE WATER	EXAM FEE	\$	842.002	RECORD FEE	\$
842.003	GROUND WATER	\$		842.004	\$	
842.005	TRANSFER	\$		842.006	\$	

**WELL CONSTRUCTION**

842.022	WELL DRILL CONSTRUCTOR	EXAM FEE	\$	842.023	LICENSE FEE	\$
842.016	WELL DRILL OPERATOR	\$		842.019	\$	
	LANDOWNER'S PERMIT			842.024	\$	

**06-00-0 WELL CONST START FEE**

842.013	WELL CONST START FEE	\$	CARD #	
	MONITORING WELLS	\$	CARD #	

**45-00-0 LOTTERY PROCEEDS**

864.000	LOTTERY PROCEEDS	\$
---------	------------------	----

**07-00-0 HYDRO ACTIVITY**

842.011	POWER LICENSE FEE(FW/WRD)	LIC NUMBER	\$
842.115	HYDRO LICENSE FEE(FW/WRD)		\$
	HYDRO APPLICATION		\$

RECEIPT # **95984** DATED: 1-6-93 BY: D Bushnell