

RECEIVED  
JAN 15 1993  
WATER RESOURCES DEPT.  
SALEM, OREGON

Watermaster's Office  
District No. 19  
Coos County Courthouse  
Coquille, OR 97423

Receipt Name: Stock Slough Live Prod Ass.

Date: December 31, 1992

Amount: \$ 200<sup>00</sup>.

Pre-1989 application form.

Received by Terre L Woods.

LAND SURVEYING

ENGINEERING

FORESTRY

STUNTZNER ENGINEERING & FORESTRY

CLAIM OF BENEFICIAL USE AND SITE REPORT (PRE 1909 VESTED  
RIGHT)  
5/28/93

INFORMATION

THE PERMITTEE IS: STOCK SLOUGH LIVESTOCK PRODUCERS ASSOC.  
1050 STOCK SLOUGH  
COOS BAY, OREGON 97420  
PHONE: 267-3378

I TALKED WITH GORDON ROSS WHO IS THE SEC. TREAS.

SOURCES

THE SOURCES OF WATER ARE CATCHING SLOUGH, WHICH IS A  
TRIBUTARY OF COOS BAY, UNNAMED SPRINGS AND CREEKS, JIMMY  
GULCH, BLAKE GULCH, MONKEY RANCH GULCH, DINGLE DELL, KAINO  
CREEK, STONE CREEK, SOUTH MEADOW CREEK, LAXSTROM GULCH AND  
STOCK SLOUGH. THESE ARE TRIBUTARIES OF CATCHING INLET.

DIVERSION POINT

THIS IS FOR INSTREAM STOCK WATERING ONLY.

MOTOR/PUMP

NO MOTOR

PIPE

NO PIPE

HEADS

NO HEADS

USES

THE WATER IS BEING USED FOR INSTREAM STOCK WATERING.

LIFT

NO LIFT

RECEIVED  
SEP 2 1993

SEP - 2 1993

STATE OF OREGON  
SALEM, OR 97330

SEP 2 1993

WATER RESOURCES DEPT.  
SALEM, OREGON

CAPACITY

THERE ARE 14 INDIVIDUAL PROPERTY OWNERS THAT MAKE UP THE STOCK SLOUGH LIVESTOCK PRODUCERS ASSOCIATION. GORDON ROSS GAVE ME A LIST OF THE STOCK OWNED BY EACH INDIVIDUAL. THE TOTALS ARE: 30 SHEEP, 174 CATTLE AND 8 HORSES. AT 1.5 GAL/DAY FOR SHEEP AND 15 GAL/DAY FOR HORSES AND CATTLE THE TOTAL USAGE IS 2775 GAL/DAY

SURVEY TIE

THE LOCATION OF THE STREAMS WERE TRACED FROM THE USGS QUAD MAP.

THE PRE 1909 WATER RIGHTS SURVEY AND INSPECTION OF THE USE ARE FOUND TO BE COMPLETED UNDER THE TERMS AND CONDITIONS OF PRE 1909 VESTED WATER RIGHTS AND WAS COMPLETED BY ME ON 6/21/93 AND THE FACTS CONTAINED ON THIS REPORT AND ACCOMPANYING PRE 1909 VESTED WATER RIGHTS MAP ARE CORRECT TO THE BEST OF MY KNOWLEDGE.

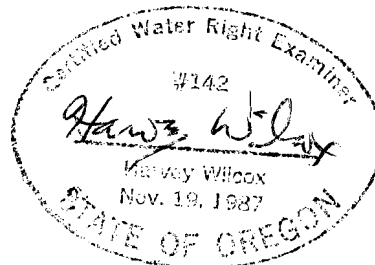

HARVEY WILCOX CWRE #142  
EXPIRES 12/31/94

I, GORDON ROSS, AGREE TO THE FINDINGS OF THE CWRE AND DO SUBMIT THIS SITE REPORT AND MAP AS OUR CLAIM OF BENEFICIAL USE OF THE WATER AS PROVIDED UNDER THE TERMS AND CONDITIONS OF PRE 1909 VESTED WATER RIGHTS.

*Gordon Ross*

(SIGNATURE)

# PRE-190 VESTED WATER RIGHT

Section 4,5,8&9 Township 26S Range 12W W.M.  
 Coos County

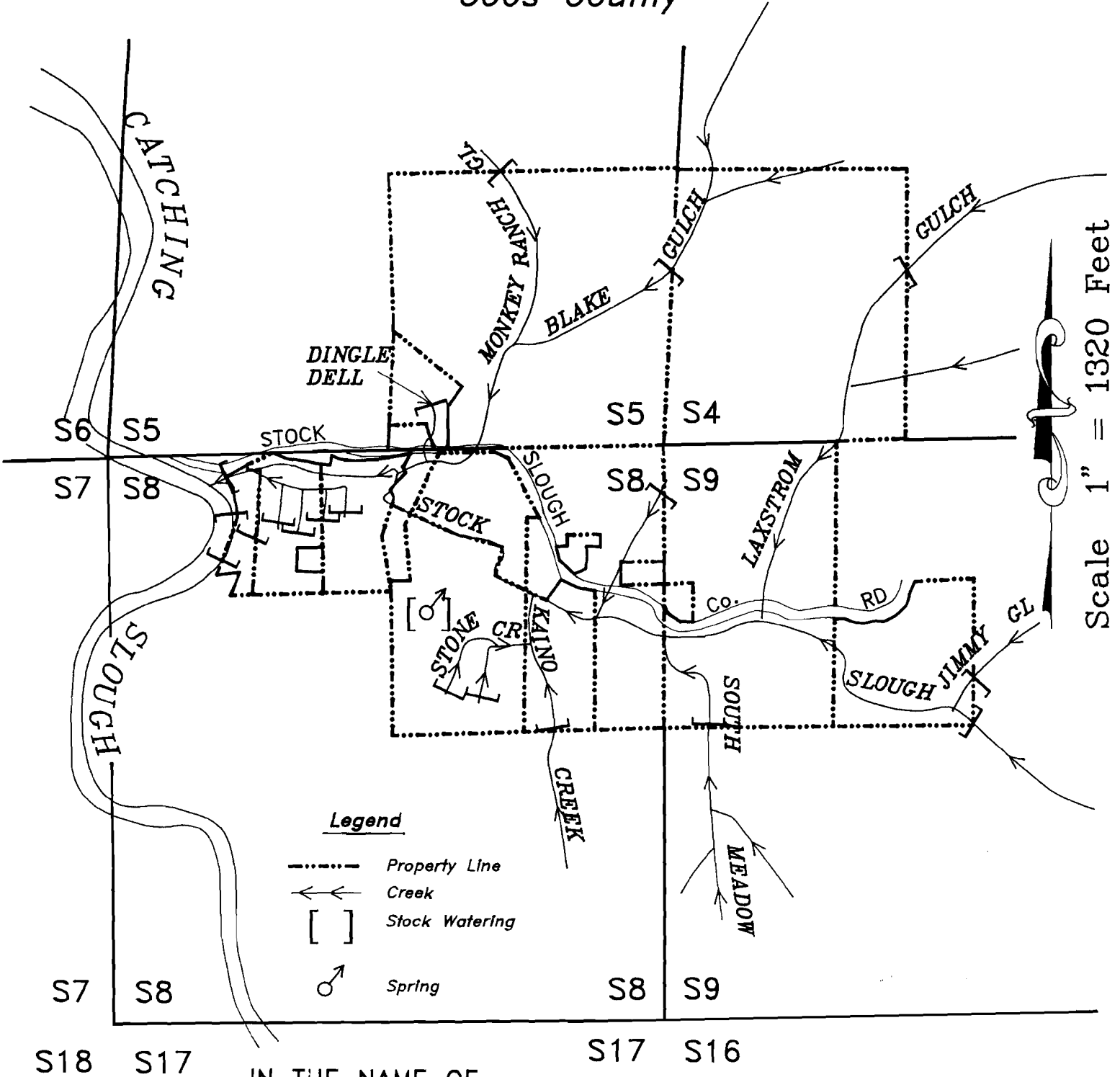

IN THE NAME OF

Stock Slough Livestock Producers Assoc.

Surveyed on May 28, 1993 by H.A. Wilcox

**EXAMINERS DISCLAIMER STATEMENT**

The preparation of this map was for the purpose of identifying the location of the Water Right only and has no intent to provide dimensions or location of property ownership lines.

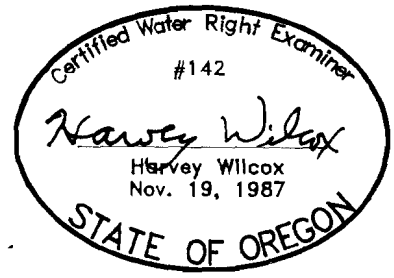

EXPIRES 12/31/94

RECEIVED  
SEP 10 1993

SEP 10 1993

WATER RESOURCES DEPT.  
SALEM, OREGON

September 3, 1993

Water Resources Department  
Atten: Mr. Don Knauer  
3850 Portland Rd. NE  
Salem, OR 97310

Dear Mr. Knauer,

RE: Registration statement SWR-602

Enclosed please find our registration statement map for  
STOCK SLOUGH LIVESTOCK PRODUCERS ASSOC. prepared by a  
Certified Water Right Examiner.

STOCK SLOUGH LIVESTOCK PRODUCERS ASSOC.  
1050 Stock Slough  
Coos Bay, OR 97420

**RECEIVED**

**JUN 17 1993**

**WATER RESOURCES DEPT.  
SALEM, OREGON**

1050 Stock Slough  
Coos Bay, OR 97420  
June 14, 1993

Oregon Water Resources Department  
Attn: Mr. Don Knauer  
3850 Portland Rd. NE  
Salem, OR 97310

Dear Mr. Knauer

RE: Registration statement SWR-602

The STOCK SLOUGH LIVESTOCK PRODUCERS ASSOC has engaged  
Mr. Harvey Wilcox of Stuntzner Engineering, 705 S. Fourth  
Coos Bay, OR 97420, to prepare our registration statement  
map.

Sincerely,



Gordon Ross, Chairman  
Stock Slough Livestock Producers Assoc

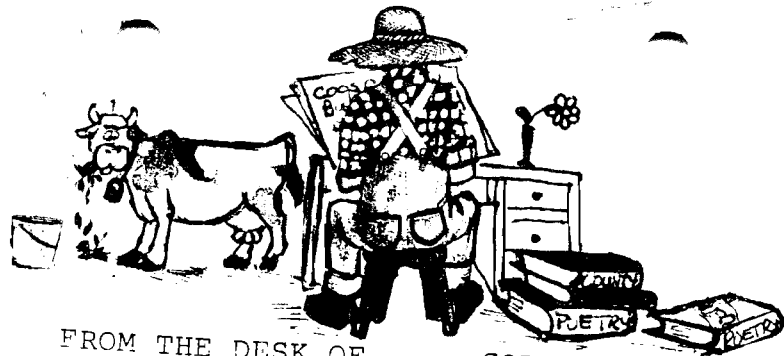

FROM THE DESK OF.....GORDON ROSS

*This was done separately  
but then submitted along with  
the rest of the stock slough  
livestock producers*

*Gordon Ross* RECEIVED

JAN 05 1993

WATER RESOURCES DEPT.  
SALEM, OREGON

Coos Ranch  
 Sections 4 & 9, T26S, R12W  
 Coos County, OR

RECEIVED

JAN 05 1993

WATER RESOURCES DEPT.  
 SALEM, OREGON

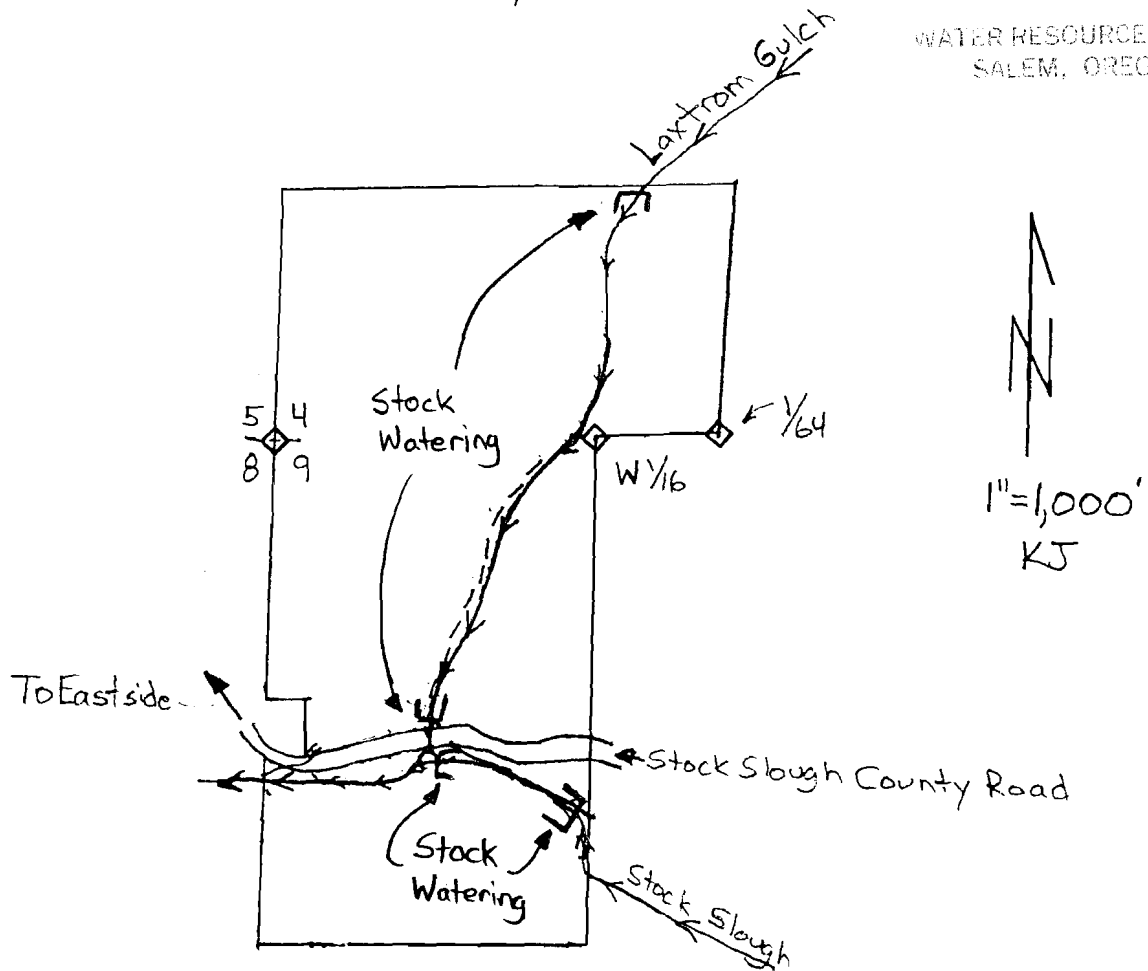

Legend:

- ◇ Known Corner
- Gravel Road

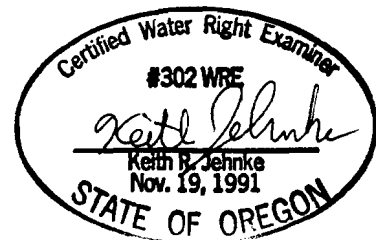

EXAMINERS DISCLAIMER STATEMENT

THE PREPARATION OF THIS MAP WAS FOR THE PURPOSE OF IDENTIFYING THE LOCATION OF THE WATER RIGHT ONLY AND HAS NO INTENT TO PROVIDE DIMENSIONS OR LOCATION OF PROPERTY OWNERSHIP LINES.

Stutzner Engineering & Forestry

TELEPHONE 287-2872

706 SO. 4TH, P.O. BOX 118 - COOS BAY, OREGON 97420



JAN 25 1992

WATER RESOURCES DEPT.  
SALEM, OREGON

**STATE OF OREGON  
WATER RESOURCES DEPARTMENT**

**SURFACE WATER REGISTRATION STATEMENT  
PRE-1909 VESTED WATER RIGHT CLAIM**

1. Name of Registrant: Messerle & Sons  
Mailing Address: 2330 E. Catching Slough Rd  
Coos Bay, OR 97420 Telephone No: 269-2997
2. Source of water: Laxtrom Gulch - Tributary to Stock Slough  
Tributary to: & Stock Slough - Tributary to Catching Slough
3. Purpose(s) for which water is used: Stock water  
(Irrigation, Stockwater, Domestic, Hydroelectric power, Industrial, Etc.)  
If irrigation, total number of acres irrigated: NA
4. Priority Date  
a) Date of first use: 1884/1891  
b) Date water use development first initiated: 1884  
c) Name of party who initiated development: Jacob A. Bunabrako / William  
Albert Collver
5. Amount of water claimed: .0025, in (CFS) or GPM  
(Water put to beneficial use)
6. Location of place of use:  
4,9 Sections, Township 26 N (S), Range 12 E/(W)  
\_\_\_\_ Sections, Township \_\_\_\_ N/S, Range \_\_\_\_ E/W.  
(Attach additional pages if necessary)
7. Usual period of use: \_\_\_\_ / \_\_\_\_ to \_\_\_\_ / \_\_\_\_  
month day month day

Ross Ranch

9-26-12 TL 1200-1400

JAN 13 1893

RESOURCES DEPT.  
RECORDS

12/5/96

The General Land Office of the United States, a part of the  
 Register of the Land Office at Astoria, Oregon, hereby certifies  
 that pursuant to the act of Congress approved 22d May 1861  
 to secure Homesteads of certain tracts on the public domain  
 and the acts supplemental thereto the claim of Jacob A. Hancock  
 has been established and duly commuted in conform-  
 ity to law for the south east quarter of the north east quarter  
 of Section eight, and the lots numbered one and two, and  
 the south east quarter of the north west quarter of Section kind and  
 Township twenty six south of Range twelve West of Willamette  
 Meridian in Oregon, containing one hundred and seventy nine  
 acres and sixty five hundredths of an acre, according to the offic-  
 ial plat of the survey of the said land returned to the General  
 Land Office by the surveyor General. Now know ye, that there is  
 therefore granted by the United States unto the said Jacob A.  
 Hancock the tract of land above described. So have and to  
 hold the said tract of land with the appurtenances thereof,  
 unto the said Jacob A. Hancock and to his heirs and as-  
 signs forever subject to any valid and accrued water right  
 for mining agricultural manufacturing or other purposes, and  
 right to ditches and reservoirs used in connection with such  
 water right as may be recognized and acknowledged by the  
 local customs laws and decisions of courts, and also subject  
 to the right of the proprietor of a mine or lode to appropriate  
 water from his own stream should the same be found to be  
 available in the future.

and the  
 done,  
 by the  
 Register  
 of the  
 Land  
 Office  
 at Astoria,  
 Oregon  
 this  
 26th  
 day of  
 September  
 1912.  
 J. A. Hancock  
 Jacob A. Hancock  
 and by  
 Andrew  
 May Jr  
 to sell  
 said  
 water,  
 east,  
 the  
 and  
 to  
 which  
 as an  
 for the  
 hereby  
 and  
 what  
 the  
 right  
 and  
 and

RECORDED  
INDEXED

JAN 05 1893

DEPT

persons

deposited in  
file of the  
by it appear  
to May 1862

Remains  
of a house  
and contains  
east quarter  
two, and  
other kind in  
Williamette  
county nine  
to the effe  
the house  
that there is  
in fact a  
house and  
see thereof.

and as  
wells right  
purpose, and  
with such  
ged by the  
also subject  
tract or all  
nd to per  
provided by  
President  
letter to the  
Office to be  
city of  
of

*[The main body of the document is almost entirely illegible due to extreme darkening and noise. Only faint traces of text are visible.]*

*[A small, dark, irregular mark or stamp is visible on the right edge of the page.]*



The said... the same... all...  
...her right...

In testimony whereof, Benjamin Harrison, President of the United States of America, has caused this letter to be made public, and the said...  
...at the City of Washington, the  
...  
...  
By the President, Benjamin Harrison  
Ellen Macfarlane, act. Secretary.  
Darius H. Payson, M. T. James, Receiver of the General Land Office.  
Recorded - 11 P. M., November 28<sup>th</sup> 1891  
J. B. Smith, Clerk of the Court.

The United States of America,

to all to whom these Presents shall come, Greeting: -  
Edmund S. Anderson, of Cass County, Oregon has deposited  
... the General Land Office of the United States a Certificate of the Rights  
... Oregon, when by it appears that full pay  
... made by the said Edmund S. Anderson according to the  
... of the Act of Congress of the 24<sup>th</sup> of April, 1829, entitled "An Act  
... provision for the sale of the Public Lands; and the act,  
... for the west half of the north half of section eight in  
... south of Range Eleven, east of Willamette River  
... Oregon, containing one hundred and sixty acres according to the Official  
... of the Survey of the said lands returned to the General Land Office of  
... which said tract has been purchased by the  
... said Edmund S. Anderson for the purpose of...  
... States of America, in Consideration of the...  
... with the several States of...  
... have given and granted...  
... to the said Edmund S. Anderson...

To whom it may concern:

I, Enid (Callner) Staines was born Sept. 10, 1907 and have vivid remembrance of my childhood. I lived on Stock Slough up to the time I was married in 1930. After seven years my husband and I returned and have lived on Stock Slough ever since.

Every farmer ran stock on his place, mostly dairy stock, which was their livelihood.

Those who owned property on Stock Slough, when I was a child, (beginning with that now owned by Misselle & Sons and Gordon Ross are as follows:)

- John J. Callner (uncle)
- Silo M. Callner (father)
- Henry Kaino
- Emil Stone
- Louis Stone
- Wm A. Callner (uncle)

12-28-92  
 JAN 05 1993  
 RESEARCH DEPT.  
 ASTORIA, OREGON

Enid R. Staines

Subscribed and Sworn before me this 28th Day of December 1992.

Shelly J. Quisenberry  
Notary Public for Oregon

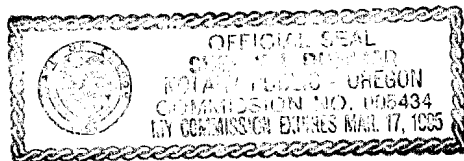

12-28-92

To Whom it May Concern

I, Gladys (Callen) Lundquist was born Aug. 31, 1903, and I well remember each ~~each~~ farm with livestock on Stock Slough

As a child I recall those productive farms and who owned them. They were as follows:

John J. Callen (uncle)

Jesse M. Callen (father)

Henry Caino

Emil Stone

Louis Stone

Wm A Callen (uncle)

Gladys L. Lundquist.

RECEIVED

JAN 15 1993

WATER RESOURCES DEPT.  
SALEM, OREGON

Subscribed and sworn before me this 28th Day of December 1992

Shelley J. Dickson

Notary Public for Oregon

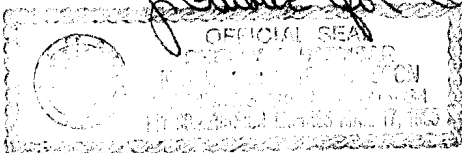

December 18, 1992

JAN 25 1993

U.S. DEPARTMENT OF AGRICULTURE  
NATIONAL ARCHIVES

To Whom it may Concern:

I, George Ross, Jr., was born in Marshfield (now Coos Bay) July 29, 1905 and was raised on my father's dairy farm on Catching Inlet and Ross Slough.

My earliest memories are of the milk boat with its deck lined with milk cans from the dairies on Catching Inlet stopping at our wharf to pick up the milk. Its destination was the Coos Bay Creamery on the other side of Bull Island in the old Coos River channel.

The creamery was built in 1892, my grandfather, Frank Ross, being one of the founders. When my parents, George Ross and Lucy Black were married in 1899, Frank Ross gave them the farm and a herd of dairy cows. I have positive knowledge that from that time to the present the dairy has continued uninterrupted. It included more land in 1899, running from what is now Azalea Acres on Catching Inlet down to Ross Inlet and up Ross Inlet including Boekeloos, Evans, Atkins, and Dr. Levy's.

In 1900 my father sold the land straight across from us to John Collver. Ida Matson used to tell the story when I was less than two years old, looking across the slough and saying, "John Collver's cows are sitting down. This land was later sold to Albert Collver, Everett Messerle's grandfather, and has been in Messerle ownership ever since as a dairy until the barn burned down and as a beef ranch since that time.

The portion that my son Gordon dairies now was divided into five fields. Four of them had watering troughs fed from springs along the foothill, while in the pasture next to Ross Inlet, the cows had to drink out of the slough. I remember this from my early memories of going after the cows with my father and later on my pony.

My early associations with Gordon Collver, my same age, across on Stock Slough, of fishing up Collver Creek (Stock Slough) afforded me the knowledge that the Collvers had dairied there for many years and that livestock has continued until this day on all the bottom lands on Stock Slough on lands now owned by John Stalcup, John Dubisar, Foster McSwain, Messerle's, Dan Scoville, Lou Ann and John Rode, Mel Burnette, Gordon Ross, John Szymik, and Chet Fors, and have dairied and ran stock on every acre of it at one time myself.



My grandfather, Henry Black, milked cows on a farm halfway to Sumner now owned by Bill Cole and the Messerle farm, called the Anchor Ranch, was four separate dairies in the early years. On to Sumner from Henry Blacks we could go by wagon to the Byers Ranch. Uncle Frank Black married Alice Byers. This farm is still in dairying being owned now by V. J. Willis. The Messerle farm in Sumner was at that time owned by Capt. Harris. Mrs Harris had her own cheese plant, and in 1902 exhibited the Grand Champion Cheese at the Chicago Expedition.

I can attest that all of the ownerships I have specifically mentioned have been in livestock production continuously from my earliest memories until this day, and that I can say with equal certainty that any bottom land on Ross Inlet, Catching Inlet, Stock Slough, or Sumner has supported livestock from the time it was cleared and drained until the present with the exception of a few annual crops for a season at a time.

*George F. Ross, Jr.*

George F. Ross, Jr.

Subscribed and sworn to before me this 16<sup>th</sup> day of

December, 1972.

*Kelly J. ...*

Notary Public for Oregon  
My commission: 3-17-75

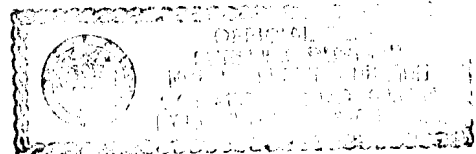

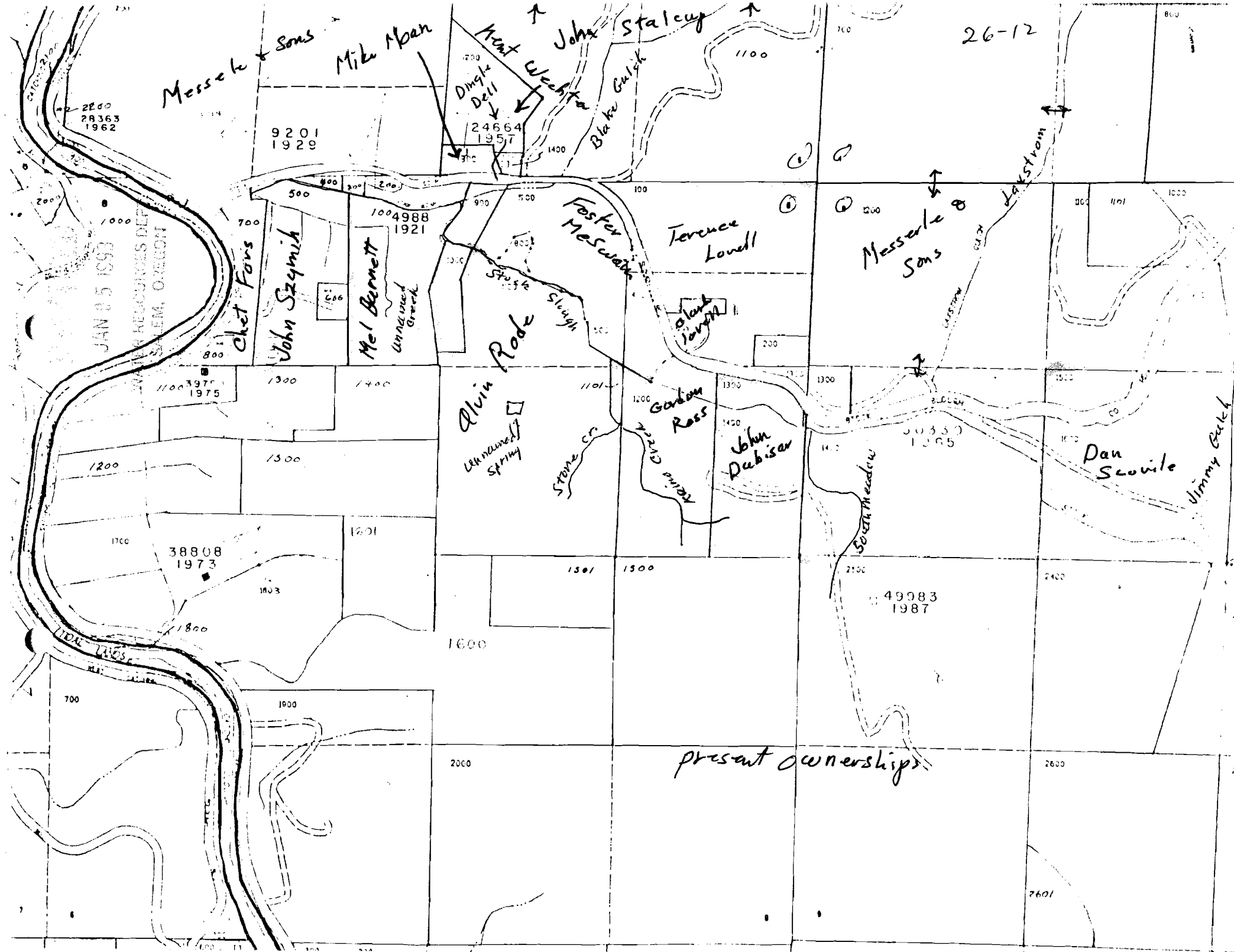

John Colver  
1900

Dingh Bell  
↓  
24664  
1957

Blake Gulch  
↙  
↘

T.M. Colver  
1900

W.A. Colver  
1900

Johannah Hillston  
1900

Emil  
1900  
Unnamed Spring

Henry  
Mariah  
Kaino

Ownership of Stock Slough  
1900.

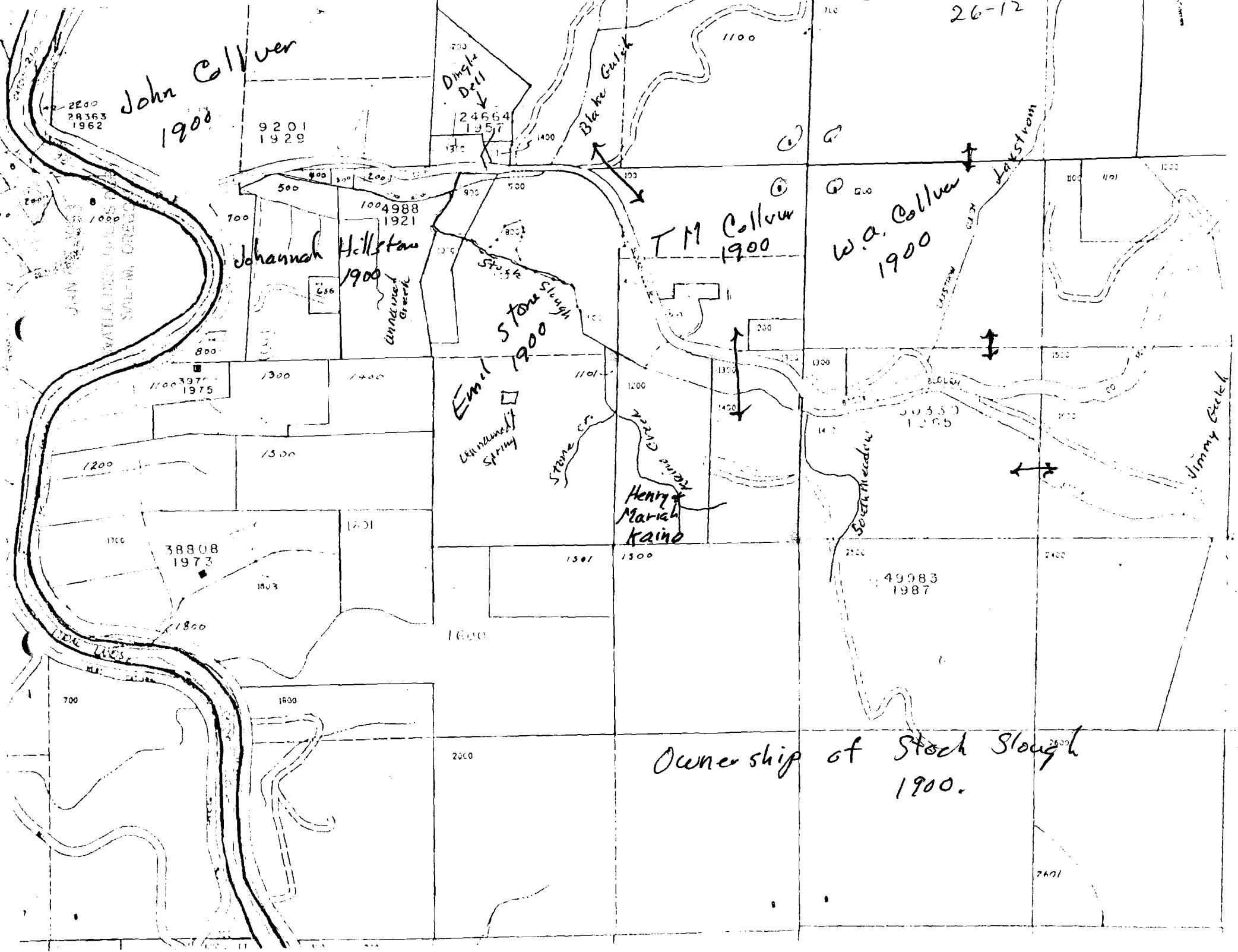

B.F. Ross

26-12

W.A. Collier  
1880s

Dingle Dell

Blake Gulch

Lakstrom

William Williams

Moses

Johannah Hill Stone Stack 1700

Eli Stone 1880s  
unnamed Spring 1900s

Uncle Billy Bonebrake's place - 1890s  
Kate J. A Bonebrake

Jimmy Becht

Ownership of Stack Slough 1880-90s

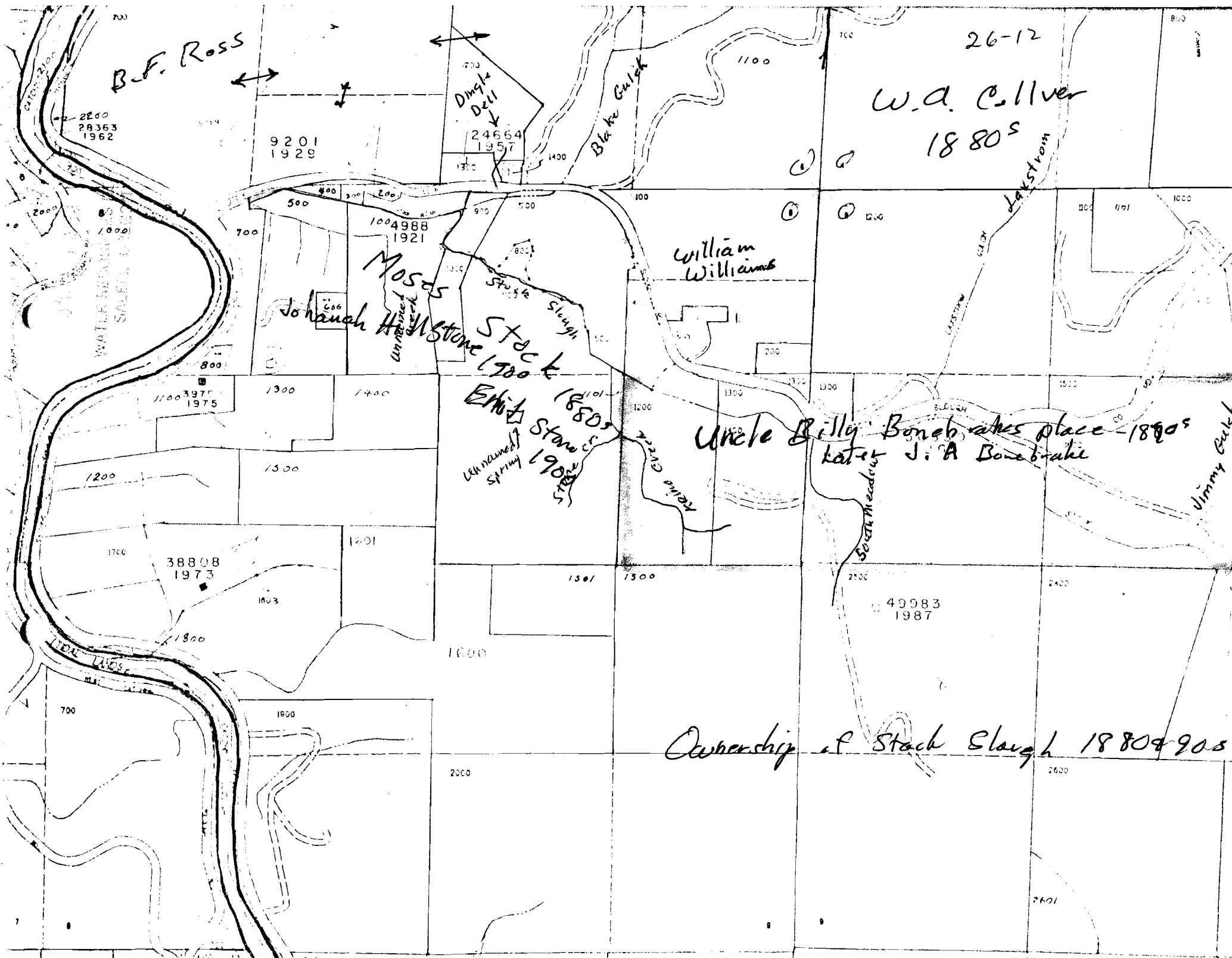



COOS COUNTY, OREGON  
 ABSTRACT OF  
 ASSESSMENT & TAX ROLL

Tax Year	Assess&Tax/ Pers. Prop. Roll	Assess&Tax Roll	Personal Property Roll	Vol. No.	Pg. No.	NAME	School Dist.	Sec	Twsp.	Range	LAND DESCRIPTION						
1906	✓			1	119	T.M. Colver	12	5 8	26 26	12 12	W 1/2 of SE + N.E 1/4 of NE 1/4 5/26/12 8/26/12						
# Acres Tillable Land	\$ of Tillable Land	# Acres Non-Till. Land	\$ of Non-Till. Land	\$ of Bldg & Other Imp.	\$ of Rolling Stock	\$ of Steamboats, Sailboats, Stationery Engines & Manufact'g Machinery	\$ of Merch'ndise & Stock in Trade	Farming Implements Wagons, Carriages Etc.	Household Furniture, Watches, Jewelry Etc.	# of Horses & Mules	\$ of Horses & Mules	# of Cattle	\$ of Cattle	# of Sheep & Goats	\$ of Sheep & Goats	# of Swine	\$ of Swine
6	5600 48072	80 13 12	410 45 215	500				60	100	2	50	13	160			20	25

Date 12/28/92 Supervisor J. Anglin

RECEIVED  
 JAN 05 1993  
 WATER RESOURCES DEPT  
 SALEM, OREGON

COOS COUNTY, OREGON  
 ABSTRACT OF  
 ASSESSMENT & TAX ROLL

Tax Year	Assess&Tax/ Pers. Prop. Roll	Assess&Tax Roll	Personal Property Roll	Vol. No.	Pg. No.	NAME	School Dist.	Sec	Twsp.	Range	LAND DESCRIPTION						
1906	✓			1	118	John Colver	12	5	26	12	SE + of SW 1/4 Lot 7						
# Acres Tillable Land	\$ of Tillable Land	# Acres Non-Till. Land	\$ of Non-Till. Land	\$ of Bldg & Other Imp.	\$ of Rolling Stock	\$ of Steamboats, Sailboats, Stationery Engines & Manufact'g Machinery	\$ of Merch'ndise & Stock in Trade	Farming Implements Wagons, Carriages Etc.	Household Furniture, Watches, Jewelry Etc.	# of Horses & Mules	\$ of Horses & Mules	# of Cattle	\$ of Cattle	# of Sheep & Goats	\$ of Sheep & Goats	# of Swine	\$ of Swine
30	2400	59 201	540 80	1000				35	100	2	50	27	439				

Date 12/28/92 Supervisor J. Anglin

COOS COUNTY, OREGON  
 ABSTRACT OF  
 ASSESSMENT & TAX ROLL

Tax Year	Assess&Tax/ Pers. Prop. Roll	Assess&Tax Roll	Personal Property Roll	Vol. No.	Pg. No.	NAME	School				LAND DESCRIPTION						
							Dist.	Sec	Twsp.	Range							
1906	✓			1	119	W.A. Collier	12	4 9	26 26	12 12	SE + 9 SW# 1st 7 SE + 9 NW# 1st 1 & 2						
Acres Tillable Land	\$ of Tillable Land	# Acres Non-Till. Land	\$ of Non-Till. Land	\$ of Bldg & Other Imp.	\$ of Rolling Stock	\$ of Steamboats, Sailboats, Stationery Engines & Manufact'g Machinery	\$ of Merch'ndise & Stock in Trade	Farming Implements Wagons, Carriages Etc.	Household Furniture, Watches, Jewelry Etc.	# of Horses & Mules	\$ of Horses & Mules	# of Cattle	\$ of Cattle	# of Sheep & Goats	\$ of Sheep & Goats	# of Swine	\$ of Swine
20	1600	210	650	800		35			100	2	40	31	484			1	2

Date 12/28/92 Supervisor J. Anglin

RECEIVED  
 JAN 6 5 1993  
 WATER RESOURCES DEPT.  
 SALEM, OREGON

COOS COUNTY, OREGON  
 ABSTRACT OF  
 ASSESSMENT & TAX ROLL

Tax Year	Assess&Tax/ Pers. Prop. Roll	Assess&Tax Roll	Personal Property Roll	Vol. No.	Pg. No.	NAME	School				LAND DESCRIPTION						
							Dist.	Sec	Twsp.	Range							
1909			✓	1	198	Emil Stone	12										
Acres Tillable Land	\$ of Tillable Land	# Acres Non-Till. Land	\$ of Non-Till. Land	\$ of Bldg & Other Imp.	\$ of Rolling Stock	\$ of Steamboats, Sailboats, Stationery Engines & Manufact'g Machinery	\$ of Merch'ndise & Stock in Trade	Farming Implements Wagons, Carriages Etc.	Household Furniture, Watches, Jewelry Etc.	# of Horses & Mules	\$ of Horses & Mules	# of Cattle	\$ of Cattle	# of Sheep & Goats	\$ of Sheep & Goats	# of Swine	\$ of Swine
										2	120	10	185				

Date 12/25/92 Supervisor J. Anglin

WOOS COUNTY, OREGON  
 ABSTRACT OF  
 ASSESSMENT & TAX ROLL

Tax Year	Assess&Tax/ Pers. Prop. Roll	Assess&Tax Roll	Personal Property Roll	Vol. No.	Pg. No.	NAME	School Dist.	Sec	Twsp.	Range	LAND DESCRIPTION						
1906	✓			2	84	Mrs Maria Kaino	12	8	26	12	W <sup>2</sup> of SE <sup>+</sup> of NE <sup>+</sup>						
# Acres Tillable Land	\$ of Tillable Land	# Acres Non-Till. Land	\$ of Non-Till. Land	\$ of Bldg & Other Imp.	\$ of Rolling Stock	\$ of Steamboats, Sailboats, Stationery Engines & Manufact'g Machinery	\$ of Merch'ndise & Stock in Trade	Farming Implements Wagons, Carriages Etc.	Household Furniture, Watches, Jewelry Etc.	# of Horses & Mules	\$ of Horses & Mules	# of Cattle	\$ of Cattle	# of Sheep & Goats	\$ of Sheep & Goats	# of Swine	\$ of Swine
✓	640	12	95	265					35	1	20	7	80				

Date 12/28/92 Supervisor J. Anglin

RECORDED  
 JAN 05 1893  
 TAILOR & BROS DEPT.  
 SALEM, OREGON

WOOS COUNTY, OREGON  
 ABSTRACT OF  
 ASSESSMENT & TAX ROLL

Tax Year	Assess&Tax/ Pers. Prop. Roll	Assess&Tax Roll	Personal Property Roll	Vol. No.	Pg. No.	NAME	School Dist.	Sec	Twsp.	Range	LAND DESCRIPTION						
# Acres Tillable Land	\$ of Tillable Land	# Acres Non-Till. Land	\$ of Non-Till. Land	\$ of Bldg & Other Imp.	\$ of Rolling Stock	\$ of Steamboats, Sailboats, Stationery Engines & Manufact'g Machinery	\$ of Merch'ndise & Stock in Trade	Farming Implements Wagons, Carriages Etc.	Household Furniture, Watches, Jewelry Etc.	# of Horses & Mules	\$ of Horses & Mules	# of Cattle	\$ of Cattle	# of Sheep & Goats	\$ of Sheep & Goats	# of Swine	\$ of Swine

Date \_\_\_\_\_ Supervisor \_\_\_\_\_



COOS COUNTY, OREGON  
 ABSTRACT OF  
 ASSESSMENT & TAX ROLL

Tax Year	Assess&Tax/ Pers. Prop. Roll	Assess&Tax Roll	Personal Property Roll	Vol. No.	Pg. No.	NAME	School Dist.	Sec	Twp.	Range	LAND DESCRIPTION
882	✓			1	68	M. J. Stock		8	26	12	Lot 1 NE 1/4 of N.W. 1/4 + W 1/2 of NE 1/4

# Acres Tillable Land	\$ of Tillable Land	# Acres Non-Till. Land	\$ of Non-Till. Land	\$ of Bldg & Other Imp.	\$ of Rolling Stock	\$ of Steamboats, Sailboats, Stationery Engines & Manufact'g Machinery	\$ of Merch'ndise & Stock in Trade	Farming Implements Wagons, Carriages Etc.	Household Furniture, Watches, Jewelry Etc.	# of Horses & Mules	\$ of Horses & Mules	# of Cattle	\$ of Cattle	# of Sheep & Goats	\$ of Sheep & Goats	# of Swine	\$ of Swine
133	1100					140		15	20	2	40	21	270			12	24

Date 12/28/92 Supervisor J. Anglin

RECEIVED  
 JAN 05 1993  
 WATER RESOURCES DEPT.  
 SALEM, OREGON

COOS COUNTY, OREGON  
 ABSTRACT OF  
 ASSESSMENT & TAX ROLL

Tax	Assess&Tax/ Pers. Prop. Roll	Assess&Tax Roll	Personal Property Roll	Vol. No.	Pg. No.	NAME	School Dist.	Sec	Twp.	Range	LAND DESCRIPTION

# Acres Tillable Land	\$ of Tillable Land	# Acres Non-Till. Land	\$ of Non-Till. Land	\$ of Bldg & Other Imp.	\$ of Rolling Stock	\$ of Steamboats, Sailboats, Stationery Engines & Manufact'g Machinery	\$ of Merch'ndise & Stock in Trade	Farming Implements Wagons, Carriages Etc.	Household Furniture, Watches, Jewelry Etc.	# of Horses & Mules	\$ of Horses & Mules	# of Cattle	\$ of Cattle	# of Sheep & Goats	\$ of Sheep & Goats	# of Swine	\$ of Swine

Date \_\_\_\_\_ Supervisor \_\_\_\_\_

COOS COUNTY, OREGON  
 ABSTRACT OF  
 ASSESSMENT & TAX ROLL

Tax Year	Assess&Tax/ Pers. Prop. Roll	Assess&Tax Roll	Personal Property Roll	Vol. No.	Pg. No.	NAME	School Dist.	Sec	Twsp.	Range	LAND DESCRIPTION								
1870	✓			1	138	Moss Stock													
# Acres Tillable Land	\$ of Tillable Land	# Acres Non-Till. Land	\$ of Non-Till. Land	\$ of Bldg & Other Imp.	\$ of Rolling Stock	\$ of Steamboats, Sailboats, Stationery Engines & Manufact'g Machinery	\$ of Merch'ndise & Stock in Trade	Farming Implements Wagons, Carriages Etc.	Household Furniture, Watches, Jewelry Etc.	# of Horses & Mules	\$ of Horses & Mules	# of Cattle	\$ of Cattle	# of Sheep & Goats	\$ of Sheep & Goats	# of Swine	\$ of Swine		
											1	4 cows 3 yearlings	\$130.						

Date 12/30/92 Supervisor J. Anglin

RECEIVED  
 JAN 05 1993  
 WATER RESOURCES DEPT  
 SALEM, OREGON

COOS COUNTY, OREGON  
 ABSTRACT OF  
 ASSESSMENT & TAX ROLL

Tax Year	Assess&Tax/ Pers. Prop. Roll	Assess&Tax Roll	Personal Property Roll	Vol. No.	Pg. No.	NAME	School Dist.	Sec	Twsp.	Range	LAND DESCRIPTION								
1870	✓			1	138	William G. Bonebrake													
# Acres Tillable Land	\$ of Tillable Land	# Acres Non-Till. Land	\$ of Non-Till. Land	\$ of Bldg & Other Imp.	\$ of Rolling Stock	\$ of Steamboats, Sailboats, Stationery Engines & Manufact'g Machinery	\$ of Merch'ndise & Stock in Trade	Farming Implements Wagons, Carriages Etc.	Household Furniture, Watches, Jewelry Etc.	# of Horses & Mules	\$ of Horses & Mules	# of Cattle	\$ of Cattle	# of Sheep & Goats	\$ of Sheep & Goats	# of Swine	\$ of Swine		
									25	3	120	3	75						

Date 12/30/92 Supervisor J. Anglin

WOODS COUNTY, OREGON  
 ABSTRACT OF  
 ASSESSMENT & TAX ROLL

Tax Year	Assess&Tax/ Pers. Prop. Roll	Assess&Tax Roll	Personal Property Roll	Vol. No.	Pg. No.	NAME	School Dist.	Sec	Twsp.	Range	LAND DESCRIPTION
1908	acreage	✓		2	104	Emile Stone	56 12	8	26	12	60 acrs of land described in Book 41 page 8 - records & dates of Cross Co.

# Acres Tillable Land	\$ of Tillable Land	# Acres Non-Till. Land	\$ of Non-Till. Land	\$ of Bldg & Other Imp.	\$ of Rolling Stock	\$ of Steamboats, Sailboats, Stationery Engines & Manufact'g Machinery	\$ of Merch'ndise & Stock in Trade	Farming Implements Wagons, Carriages Etc.	Household Furniture, Watches, Jewelry Etc.	# of Horses & Mules	\$ of Horses & Mules	# of Cattle	\$ of Cattle	# of Sheep & Goats	\$ of Sheep & Goats	# of Swine	\$ of Swine
16	1280	44	250	300													

Date 12/30/92 Supervisor J. Anglin

RECEIVED  
 JAN 05 1893  
 WATER RESOURCES DEPT.  
 SALEM, OREGON

WOODS COUNTY, OREGON  
 ABSTRACT OF  
 ASSESSMENT & TAX ROLL

Tax Year	Assess&Tax/ Pers. Prop. Roll	Assess&Tax Roll	Personal Property Roll	Vol. No.	Pg. No.	NAME	School Dist.	Sec	Twsp.	Range	LAND DESCRIPTION
1908			✓	1	178	Emile Stone	12				

# Acres Tillable Land	\$ of Tillable Land	# Acres Non-Till. Land	\$ of Non-Till. Land	\$ of Bldg & Other Imp.	\$ of Rolling Stock	\$ of Steamboats, Sailboats, Stationery Engines & Manufact'g Machinery	\$ of Merch'ndise & Stock in Trade	Farming Implements Wagons, Carriages Etc.	Household Furniture, Watches, Jewelry Etc.	# of Horses & Mules	\$ of Horses & Mules	# of Cattle	\$ of Cattle	# of Sheep & Goats	\$ of Sheep & Goats	# of Swine	\$ of Swine
										3	100	14	240				

Date 12/30/92 Supervisor J. Anglin

COOS COUNTY, OREGON  
 ABSTRACT OF  
 ASSESSMENT & TAX ROLL

Tax Year	Assess&Tax/ Pers. Prop. Roll	Assess&Tax Roll	Personal Property Roll	Vol. No.	Pg. No.	NAME	School Dist.	Sec	Twsp.	Range	LAND DESCRIPTION
1907		✓		1	96	Emil Stone	12	8	26	12	Land described Vol. 41 page 8 Coos Co. Records

# Acres Tillable Land	\$ of Tillable Land	# Acres Non-Till. Land	\$ of Non-Till. Land	\$ of Bldg & Other Imp.	\$ of Rolling Stock	\$ of Steamboats, Sailboats, Stationery Engines & Manufact'g Machinery	\$ of Merch'ndise & Stock in Trade	Farming Implements Wagons, Carriages Etc.	Household Furniture, Watches, Jewelry Etc.	# of Horses & Mules	\$ of Horses & Mules	# of Cattle	\$ of Cattle	# of Sheep & Goats	\$ of Sheep & Goats	# of Swine	\$ of Swine
6	1280	44	250	300													

Date 12/30/92 Supervisor J. Anglin

RECEIVED  
 JAN 05 1993  
 WATER RESOURCES DEPT.  
 SALEM, OREGON

COOS COUNTY, OREGON  
 ABSTRACT OF  
 ASSESSMENT & TAX ROLL

Tax Year	Assess&Tax/ Pers. Prop. Roll	Assess&Tax Roll	Personal Property Roll	Vol. No.	Pg. No.	NAME	School Dist.	Sec	Twsp.	Range	LAND DESCRIPTION
1907			✓	1	155	Emile Stone	12				

# Acres Tillable Land	\$ of Tillable Land	# Acres Non-Till. Land	\$ of Non-Till. Land	\$ of Bldg & Other Imp.	\$ of Rolling Stock	\$ of Steamboats, Sailboats, Stationery Engines & Manufact'g Machinery	\$ of Merch'ndise & Stock in Trade	Farming Implements Wagons, Carriages Etc.	Household Furniture, Watches, Jewelry Etc.	# of Horses & Mules	\$ of Horses & Mules	# of Cattle	\$ of Cattle	# of Sheep & Goats	\$ of Sheep & Goats	# of Swine	\$ of Swine
									30	1	25	12	185				

Date 12/30/92 Supervisor J. Anglin

COOS COUNTY, OREGON  
 ABSTRACT OF  
 ASSESSMENT & TAX ROLL

Tax Year	Assess&Tax/ Pers. Prop. Roll	Assess&Tax Roll	Personal Property Roll	Vol. No.	Pg. No.	NAME	School Dist.	Sec	Twsp.	Range	LAND DESCRIPTION
1907	AAA	✓		1	96	Johanna Hill Stone	12	8	26	12	Land described in Vol 27 page 245 Records & Lead of Coos Co

# Acres Tillable Land	\$ of Tillable Land	# Acres Non-Till. Land	\$ of Non-Till. Land	\$ of Bldg & Other Imp.	\$ of Rolling Stock	\$ of Steamboats, Sailboats, Stationery Engines & Manufact'g Machinery	\$ of Merch'ndise & Stock in Trade	Farming Implements Wagons, Carriages Etc.	Household Furniture, Watches, Jewelry Etc.	# of Horses & Mules	\$ of Horses & Mules	# of Cattle	\$ of Cattle	# of Sheep & Goats	\$ of Sheep & Goats	# of Swine	\$ of Swine
2.	1260	37	505	300													

Date 12/30/92 Supervisor J. Anglin

RECEIVED  
 JAN 05 1993  
 WATER RESOURCES DEPT.  
 SALEM, OREGON

COOS COUNTY, OREGON  
 ABSTRACT OF  
 ASSESSMENT & TAX ROLL

Tax Year	Assess&Tax/ Pers. Prop. Roll	Assess&Tax Roll	Personal Property Roll	Vol. No.	Pg. No.	NAME	School Dist.	Sec	Twsp.	Range	LAND DESCRIPTION
1901			✓	1	74	Mrs Johanna Hillstone	12				

# Acres Tillable Land	\$ of Tillable Land	# Acres Non-Till. Land	\$ of Non-Till. Land	\$ of Bldg & Other Imp.	\$ of Rolling Stock	\$ of Steamboats, Sailboats, Stationery Engines & Manufact'g Machinery	\$ of Merch'ndise & Stock in Trade	Farming Implements Wagons, Carriages Etc.	Household Furniture, Watches, Jewelry Etc.	# of Horses & Mules	\$ of Horses & Mules	# of Cattle	\$ of Cattle	# of Sheep & Goats	\$ of Sheep & Goats	# of Swine	\$ of Swine
								66	75	1	20	18	285				

Date 12/30/92 Supervisor J. Anglin

**SURFACE WATER REGISTRATION CHECKLIST**

(received after July 18, 1990)

CHECK BASIN MAP DEC NAME South Coast # 17 UNADJUDICATED AREA ? YES  
RECEIPT # 95978 S W R NUMBER 602  
CHECK ENCLOSURES DEC PRELIMINARY DATA BASE ENTRY ONE  
ACKNOWLEDGEMENT LETTER DEC ENTER ON STREAM INDEX \_\_\_\_\_  
CHECK QUADRANGLE MAP \_\_\_\_\_ CHECK GLO PLATS \_\_\_\_\_  
WATERMASTER CHECKLIST \_\_\_\_\_ PUBLIC NOTICE PUBLICATION LCR

**FORM REVIEW**

\_\_\_\_\_ blanks filled in  
\_\_\_\_\_ signed  
\_\_\_\_\_ date received stamped

**MAP REVIEW**

#4 →  
✓ source and trib  
\_\_\_\_\_ diversion point location  
\_\_\_\_\_ conveyances (pipes, ditch, etc.)  
\_\_\_\_\_ place of use \_\_\_\_\_ 1/16<sup>th</sup> LINES  
✓ scale  
✓ township, range, section  
✓ north arrow  
✓ CWRE stamp  
✓ disclaimer  
✓ date survey was performed  
\_\_\_\_\_ P.O.B. of survey  
\_\_\_\_\_ dimensions and capacity of diversion system  
✓ "beneficial use" type title  
✓ "permanent-quality" paper

WATER RIGHT RECORD CHECK \_\_\_\_\_ FIELD INSPECTION \_\_\_\_\_  
FINAL FILE REVIEW \_\_\_\_\_ FINAL DATA BASE ENTRY \_\_\_\_\_  
ENTER ON PLAT CARDS \_\_\_\_\_

March 3, 1994

HARVEY WILCOX  
3190 N LAKE ROAD  
LAKESIDE OR 97449

RE: SWR-602

Dear Mr Wilcox,

This will acknowledge the receipt of map to support the pre-1909 vested water right claim in the name of STOCK SLOUGH LIVESTOCK PRODUCERS ASSOCIATION you returned with corrections and completions. I have added the map to the file. Thank you for your attention to this matter. If you have any questions, please give me a call.

Sincerely,

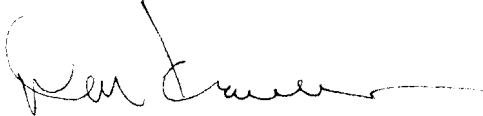

Don Knauer  
Adjudication Specialist

J:\WIS\16\SWR-0602.004



3850 Portland Rd NE  
Salem, OR 97310  
(503) 378-3739  
FAX (503) 378-8130

February 2, 1994

HARVEY WILCOX  
3190 N LAKE ROAD  
LAKESIDE OR 97449

RE: File# SWR-602

DEAR HARVEY WILCOX,

I am returning the map you prepared for Stock Slough Livestock Producers Association. You will find the item which requires completion or correction shown below. I have the description followed by the ORS or OAR site and paraphrased statute or rule.

place of use ( $\frac{1}{4}$   $\frac{1}{4}$ )

ORS 539.240 (2) (d) (B) "The location of place of use by quarter-quarter section..." You must show the 1/16th lines.

You must return the map before the claim can be processed. If you cannot have the map to the WRD within 60 days, please inform me as to when it can be expected. Please mark all correspondence with the file number.

As always, if you have any questions, please give me a call.

Sincerely,



Don Knauer  
Adjudication Specialist

Enclosures

J:\WP51\SWR\CLAIMANT\6\SWR-0602.00M





September 14, 1993

STOCK SLOUGH LIVESTOCK PRODUCERS ASSOC  
1050 STOCK SLOUGH  
COOS BAY OR 97420

RE: SWR-602

Dear Sir,

This will acknowledge the receipt of the map prepared by a Certified Water Right Examiner in support of your claim to a pre-1909 vested water right. I will add the map to your file for review in the future.

If you have any questions, please give me a call.

Sincerely,

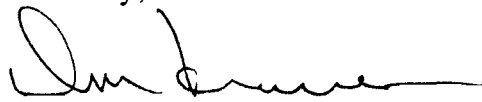

Don Knauer  
Adjudication Specialist

j:\w\slcl6\swr-0602.003



---

3850 Portland Rd NE  
Salem, OR 97310  
(503) 378-3739  
FAX (503) 378-8130

May 5, 1993

KEITH JEHNKE  
PO BOX 118  
COOS BAY OR 97420

RE: Surface Water Registration Map

Dear MR JEHNKE,

STOCK SLOUGH LIVESTOCK PRODUCERS ASSOCIATION has indicated to the Oregon Water Resources Department (WRD) that you have been hired to prepare the claim of beneficial use map for their Surface Water Registration Statement. Would you please inform me of your anticipated schedule of map preparation and submission to the WRD.

Please mark all correspondence related to this claim with the file number SWR-602.

Sincerely,



Don Knauer  
Adjudication Specialist

J:\WP51\SWR\CLAIMANT\6\SWR-0602.002

6-7-93: STUNTZNER ENGINEERING CALLED TO SAY  
WE CAN EXPECT THE MAP ABOUT THE  
1<sup>ST</sup> WEEK OF AUGUST, 1993. WDK



May 5, 1993

STOCK SLOUGH LIVESTOCK PRODUCERS ASSOC  
1050 STOCK SLOUGH  
COOS BAY OR 97420

Dear MR ROSS,

This will acknowledge that your Surface Water Registration Statement in the name of STOCK SLOUGH LIVESTOCK PRODUCERS ASSOC has been received by our office. The fees in the amount of \$200.00 have been received and our receipt #95978 is enclosed. Your registration statement has been numbered SWR-602.

Our office will review your form and map in the near future. If necessary we will schedule a meeting with you that will include a site inspection. If there are problems with your form we are usually able to take care of them during our visit. We will be able to answer any questions you might have about the adjudication process at that time.

Please feel free to contact this office if you have any questions.

Sincerely,



Don Knauer  
Adjudication Specialist

Enclosure

C:\WP51\SWR\CLAIMANT\SWR-0602.001



3850 Portland Rd NE  
Salem, OR 97310  
(503) 378-3739  
FAX (503) 378-8130

STATE OF OREGON  
**WATER RESOURCES DEPARTMENT**

RECEIPT # **95978**

3850 PORTLAND ROAD NE  
 SALEM, OR 97310  
 378-8455/378-8130 (FAX)

RECEIVED FROM: <u>Cherry Grove Dairy</u>	APPLICATION
BY:	PERMIT
	TRANSFER

CASH:  CHECK: #  24-22 OTHER: (IDENTIFY)

TOTAL REC'D \$ 200

**01-00-0 WRD MISC CASH ACCT**

842.010	ADJUDICATIONS	\$ <u>200</u>
831.087	PUBLICATIONS/MAPS	\$
830.650	PARKING FEES Name/month	\$
	OTHER: (IDENTIFY)	\$

**REDUCTION OF EXPENSE**

CASH ACCT.	\$
COST CENTER AND OBJECT CLASS	VOUCHER #

**03-00-0 WRD OPERATING ACCT**

<b>MISCELLANEOUS:</b>			
840.001	COPY FEES		\$
850.200	RESEARCH FEES		\$
880.109	MISC REVENUE: (IDENTIFY)		\$
520.000	OTHER (P-6): (IDENTIFY)		\$
<b>WATER RIGHTS:</b>		<b>EXAM FEE</b>	<b>RECORD FEE</b>
842.001	SURFACE WATER	\$	842.002
842.003	GROUND WATER	\$	842.004
842.005	TRANSFER	\$	842.006
<b>WELL CONSTRUCTION</b>		<b>EXAM FEE</b>	<b>LICENSE FEE</b>
842.022	WELL DRILL CONSTRUCTOR	\$	842.023
842.016	WELL DRILL OPERATOR	\$	842.019
	LANDOWNER'S PERMIT		842.024

**06-00-0 WELL CONST START FEE**

842.013	WELL CONST START FEE	\$	CARD #
	MONITORING WELLS	\$	CARD #

**45-00-0 LOTTERY PROCEEDS**

864.000	LOTTERY PROCEEDS	\$
---------	------------------	----

**07-00-0 HYDRO ACTIVITY**

		LIC NUMBER	
842.011	POWER LICENSE FEE(FW/WRD)		\$
842.115	HYDRO LICENSE FEE(FW/WRD)		\$
	HYDRO APPLICATION		\$

RECEIPT # **95978**

DATED: 1-6-93

BY: [Signature]