

**STATE OF OREGON  
WATER RESOURCES DEPARTMENT**

RECEIPT # **96026**

3850 PORTLAND ROAD NE  
SALEM, OR 97310  
378-8455/378-8130 (FAX)

RECEIVED FROM: Fat Elk Drainage District  
BY: \_\_\_\_\_

APPLICATION	
PERMIT	
TRANSFER	

CASH:  CHECK: #  96-292 OTHER: (IDENTIFY)

TOTAL REC'D \$ 2845.00

**01-00-0 WRD MISC CASH ACCT**

842.010	ADJUDICATIONS	\$ <u>2845.00</u>
831.087	PUBLICATIONS/MAPS	\$
830.650	PARKING FEES Name/month	\$
_____	OTHER: (IDENTIFY)	\$

**REDUCTION OF EXPENSE**

CASH ACCT. \$

COST CENTER AND OBJECT CLASS VOUCHER #

**03-00-0 WRD OPERATING ACCT**

**MISCELLANEOUS:**

840.001	COPY FEES	\$
850.200	RESEARCH FEES	\$
880.109	MISC REVENUE: (IDENTIFY)	\$
520.000	OTHER (P-6): (IDENTIFY)	\$

**WATER RIGHTS:**

842.001	SURFACE WATER	\$	842.002	\$
842.003	GROUND WATER	\$	842.004	\$
842.005	TRANSFER	\$	842.006	\$

**WELL CONSTRUCTION**

842.022	WELL DRILL CONSTRUCTOR	\$	842.023	\$
842.016	WELL DRILL OPERATOR	\$	842.019	\$
	LANDOWNER'S PERMIT		842.024	\$

**06-00-0 WELL CONST START FEE**

842.013	WELL CONST START FEE	\$	CARD #	
	MONITORING WELLS	\$	CARD #	

**45-00-0 LOTTERY PROCEEDS**

864.000	LOTTERY PROCEEDS	\$
---------	------------------	----

**07-00-0 HYDRO ACTIVITY**

842.011	POWER LICENSE FEE(FW/WRD)	LIC NUMBER	\$
842.115	HYDRO LICENSE FEE(FW/WRD)		\$
	HYDRO APPLICATION		\$

RECEIPT # **96026**

DATED: 4/6/93

BY: C. Engel

January 25, 1994

FAT ELK DRAINAGE DISTRICT  
C/O ELLIS FOSTER  
RT 1 BOX 3615  
COQUILLE OR 97423

RE: SWR-572

Dear Mr Foster,

I am sending a copy of the letter I sent to you on April 28, 1993. I have not heard anything from you in regards to the required map to support your pre-1909 vested water right claim. I am in the process of reviewing the maps and will pass your file by at this time. I cannot complete my review without the required map. You must send me a map submission date.

If you have any questions, please give me a call. The toll free number is 1-800-624-3199.

Sincerely,



Don Knauer  
Adjudication Specialist

J:\WIS\C\5\SWR-0572.002



---

3850 Portland Rd NE  
Salem, OR 97310  
(503) 378-3739  
FAX (503) 378-8130

**SURFACE WATER REGISTRATION CHECKLIST**

(received after July 18, 1990)

CHECK BASIN MAP JEX NAME SOUTH COAST # 17 UNADJUDICATED AREA ? YES  
RECEIPT # 96026 S W R NUMBER 572  
CHECK ENCLOSURES JEX PRELIMINARY DATA BASE ENTRY DUK  
ACKNOWLEDGEMENT LETTER WET ENTER ON STREAM INDEX \_\_\_\_\_  
CHECK QUADRANGLE MAP \_\_\_\_\_ CHECK GLO PLATS \_\_\_\_\_  
WATERMASTER CHECKLIST \_\_\_\_\_ PUBLIC NOTICE PUBLICATION SC90

**FORM REVIEW**

\_\_\_\_\_ blanks filled in  
\_\_\_\_\_ signed  
\_\_\_\_\_ date received stamped

**MAP REVIEW**

\_\_\_\_\_ source and trib  
\_\_\_\_\_ diversion point location  
\_\_\_\_\_ conveyances (pipes, ditch, etc.)  
\_\_\_\_\_ place of use  
\_\_\_\_\_ scale  
\_\_\_\_\_ township, range, section  
\_\_\_\_\_ north arrow  
\_\_\_\_\_ CWRE stamp  
\_\_\_\_\_ disclaimer  
\_\_\_\_\_ date survey was performed  
\_\_\_\_\_ P.O.B. of survey  
\_\_\_\_\_ dimensions and capacity of diversion system  
\_\_\_\_\_ "beneficial use" type title  
\_\_\_\_\_ "permanent-quality" paper

WATER RIGHT RECORD CHECK \_\_\_\_\_ FIELD INSPECTION \_\_\_\_\_  
FINAL FILE REVIEW \_\_\_\_\_ FINAL DATA BASE ENTRY \_\_\_\_\_  
ENTER ON PLAT CARDS \_\_\_\_\_

April 28, 1993

---

WATER  
RESOURCES  
DEPARTMENT

---

FAT ELK DRAINAGE DISTRICT  
C/O ELLIS FOSTER  
RT 1 BOX 3615  
COQUILLE OR 97423

Dear MR FOSTER,

This will acknowledge that your Surface Water Registration Statement in the name of FAT ELK DRAINAGE DISTRICT has been received by our office. The fees in the amount of \$2845.00 have been received and our receipt #96026 is enclosed. Your registration statement has been numbered SWR-572.

The map you submitted with your claim is not acceptable. ORS 539.240 (2) (d) requires the map be prepared by a Certified Water Right Examiner (CWRE). Within 60 days of this letter you must send a letter to this address indicating you have contracted with a CWRE to prepare your map. You should send your letter to my attention. In your letter you must identify the name of the CWRE who will prepare your registration statement map. We will contact the CWRE to arrange a map submittal deadline.

We will not be able to process your claim until we have received your map. If you have any questions regarding this process, please do not hesitate to give me a call.

Please feel free to contact this office if you have any questions.

Sincerely,



Don Knauer  
Adjudication Specialist

Enclosure

J:\WP51\SWR\CLAIMANT\5\SWR-0572.001



---

3850 Portland Rd NE  
Salem, OR 97310  
(503) 378-3739  
FAX (503) 378-8130

Don:

7-5-99

Please send:

Please send form for →  
SWR #30

Please send maps if any

#<sup>13</sup> 470

WAITING ON CURVE

~~297~~

585

583

432

WAITING ON CURVE

572

WAITING ON CURVE

508

WAITING ON CURVE

397

WAITING ON CURVE

Jim Simpson

Watermaster's Office  
District No. 19  
Coos County Courthouse  
Coquille, OR 97423

Receipt Name: Fat Elk Drainage Dist.

Date: December 31, 1992

Amount: \$ 2,845<sup>00</sup>.

Pre-1989 application form.

Received by: Terre L Woody

PI

Water rights  
Crammers map  
to follow

Ellis Foster



# TOWNSHIP 28 S., RANGE 13 W.W.M. COOS COUNTY ORE.

DATED NOV. 1975

MAPS

WASH.  
WASH.

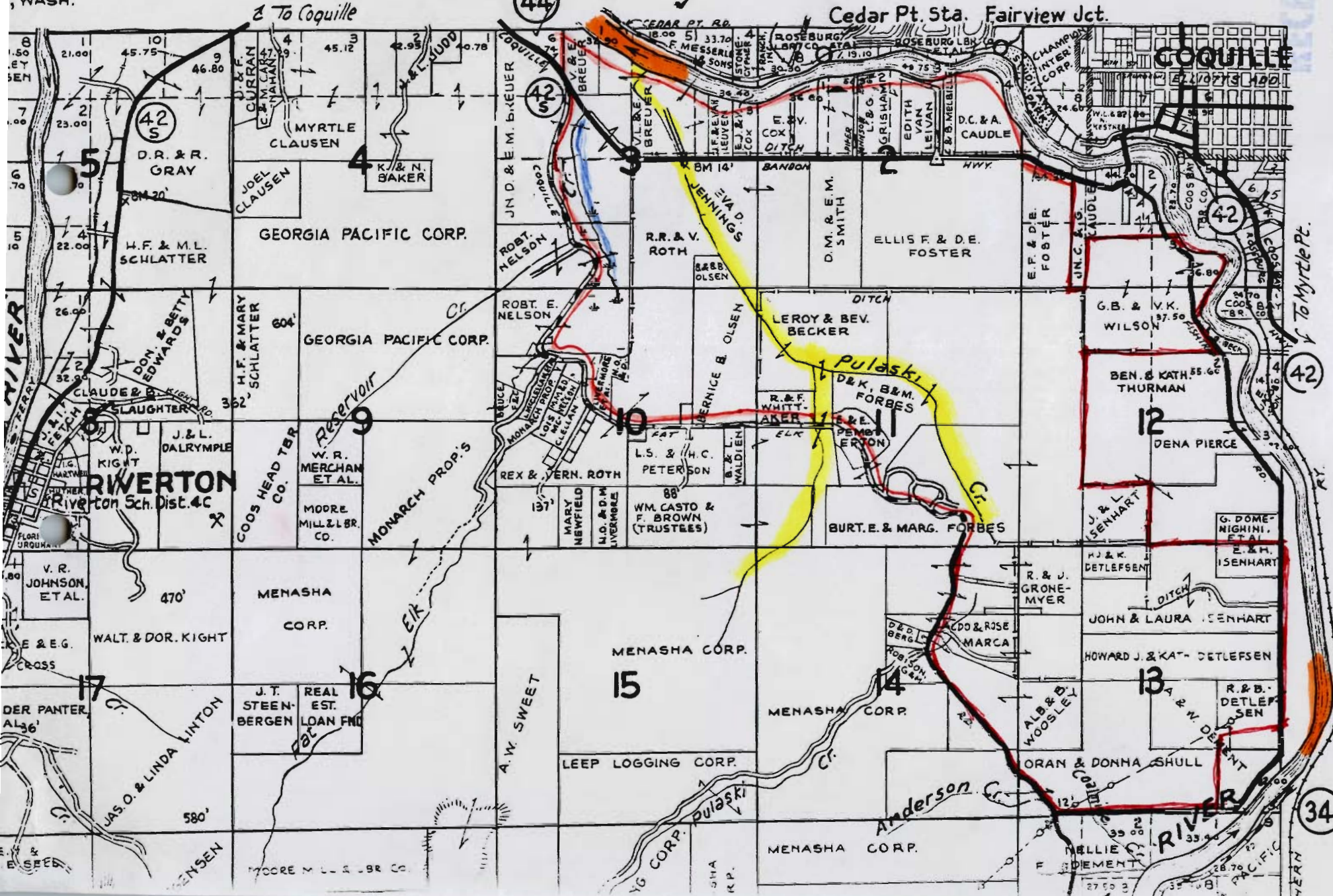

RECEIVED  
JAN 05 1993  
WATER RESOURCES DEPT.  
SALEM, OREGON

### SMALL TRACTS

- SEC. 1
  - 1. H.A. & M.L. SLACK, JR.
  - 2. J. ARTHUR & FLORENCE BERG
  - 3. KNOWLTON HTS.
  - 4. JOHN & MARY MULVIHILL
  - 5. PLEASANT VIEW
  - 6. G. EULETT
  - 7. CITY OF COQUILLE
- SEC. 2
  - 1. DOUGLAS FIR PLYWOOD CO.
- SEC. 7
  - 1. ROGER & DONNA RUSSELL
- SEC. 8
  - 1. G. P. KIGHT
  - 2. RIVERTON
  - 3. ELVTS ADDN.
  - 4. R. & V. JOHNSON
- SEC. 10
  - 1. NICKEY O. LIVERMORE, ETAL.
- SEC. 19
  - 1. WESTBROOK K TRADING
  - 2. HARLIS & FRANCES GARDNER
- SEC. 25
  - 1. CHAS. J. & MABEL LIEBELT
  - 2. ROBT. & COLLEEN DETLEPSEN
- SEC. 36
  - 1. W.A. & EULA J. ROBERTS
  - 2. PADGETT & SONS, INC.
  - 3. BUNNY DEE CAPANNA

- PULASKI CREEK
- FATELK CREEK
- COQUILLE RIVER
- BOUNDARY OF FAT ELK DRAW DISTRICT



RECEIVED

JAN 05 1993

WATER RESOURCES DEPT  
SALEM, OREGON

1  
2  
3 IN THE CIRCUIT COURT OF THE STATE OF OREGON,  
4 IN AND FOR THE COUNTY OF COOS.

5 In the Matter of the  
6 Fat Elk Drainage District. }

7  
8 TO THE HONORABLE CIRCUIT COURT FOR COOS COUNTY, OREGON:

9 This, the Petition of L. P. Branstetter, E. H. Hernden and  
10 W. E. Cross, respectfully shows:

11 I.

12 That your Petitioners are the duly elected, qualified and  
13 acting Board of Supervisors of the Fat Elk Drainage District of  
14 Coos County, Oregon.

15 II.

16 That on the 4th day of June, 1907, Z. Russ & Sons Co., Dick-  
17 son & Dickson, Andrew Meng, H. M. Tuttle, C. R. Gabler and eighteen  
18 other persons owning land in said Fat Elk Drainage District signed  
19 a Petition for the formation of said Fat Elk Drainage District  
20 and caused the same to be filed in the office of the County Clerk  
21 for Coos County, Oregon.

22 III.

23 That said Petition is in words and figures as follows:  
24  
25  
26  
27  
28  
29  
30  
31  
32

RECEIVED

JAN 05 1933

WATER RESOURCES DEPT  
SALEM, OREGON

To the Honorable County Court for Coos County, Oregon:

We, the undersigned persons hereby petition your Honorable Body and respectfully show the following:

That we comprise more than one half the owners, and own and represent more than one third of the following described body or basin of land to wit:

Begin at a point 2.00 chains south of the  $\frac{1}{4}$  section corner between sections 1 and 2, Tp 28, S of R 13 W of the Willamette meridian and run thence S  $79^{\circ}$  W 3.00 chains, N  $65^{\circ}$  W. 4.00 chains, N.  $57^{\circ}$  W. 1.60 chains, W. 2.10 chains, N.  $36\frac{1}{2}^{\circ}$  W. 6.30 chains, N  $33\frac{1}{2}^{\circ}$  W. 7.20 chains, N.  $57^{\circ}$  W. 7.36 chains, N  $71\frac{1}{2}^{\circ}$  W. 6.40 chains, N  $46\frac{1}{2}^{\circ}$  W 8.76 chains, S  $74^{\circ}$  W 9.30 chains, S.  $25\frac{1}{2}^{\circ}$  W. 4.50 chains, S.  $45^{\circ}$  W. 3.54 chains, N.  $45^{\circ}$  W. 3.54 chains, N.  $31^{\circ}$  W. 4.00 chains, S.  $77\frac{1}{2}^{\circ}$  W. 7.05 chains, W. 8.50 chains, S. 9.50 chains, S.  $66^{\circ}$  W. 3.50 chains, S.  $17^{\circ}$  W. 3.00 chains, S. 1.30 chains, W. 20.70 chains, N.  $45^{\circ}$  W. 1.50 chains, N. 8.50 chains, N.  $5^{\circ}$  W. 6.00 chains, W. 1.00 chains, S.  $41^{\circ}$  W. 3.00 chains, N.  $71^{\circ}$  W. 1.85 chains, W. 4.00 chains, N.  $67\frac{1}{2}^{\circ}$  W. 3.50 chains, S.  $13^{\circ}$  E. 3.40 chains, S.  $21^{\circ}$  E. 6.00 chains, S.  $20^{\circ}$  W. 3.80 chains, N.  $70^{\circ}$  W. 1.50 chains, N.  $15^{\circ}$  W. 2.50 chains, N.  $72\frac{1}{2}^{\circ}$  W. 2.10 chains, N.  $85^{\circ}$  W. 2.50 chains, N. 1.60 chains, N.  $18^{\circ}$  W. 7.00 chains, S.  $75^{\circ}$  W. 1.50 chains, S.  $31\frac{1}{2}^{\circ}$  W. 5.70 chains, S. 2.20 chains, N.  $71^{\circ}$  W. 5.20 chains, N.  $71^{\circ}$  W. 5.20 chains, N.  $4\frac{1}{2}^{\circ}$  W. 2.00 chains, N.  $10^{\circ}$  E. 2.00 chains, N.  $17\frac{1}{2}^{\circ}$  E. 4.00 chains, N.  $2^{\circ}$  W. 3.30 chains, N.  $6^{\circ}$  E. 4.00 chains, N.  $35^{\circ}$  W. 6.00 chains, W. 2.00 chains, N.  $25\frac{1}{2}^{\circ}$  W. 4.00 chains, S.  $58^{\circ}$  W. 1.50 chains, S.  $22\frac{1}{2}^{\circ}$  E. 3.00 chains, S.  $12\frac{1}{2}^{\circ}$  E. 6.00 chains, S.  $11^{\circ}$  W. 4.00 chains, S.  $2^{\circ}$  E. 2.50 chains, S.  $10^{\circ}$  W. 3.50 chains, S.  $33\frac{1}{2}^{\circ}$  E. 6.30 chains, S.  $53^{\circ}$  E. 3.60 chains, S.  $36^{\circ}$  E. 4.00 chains, S.  $21^{\circ}$  E. 2.40 chains, S.  $10^{\circ}$  W. 2.10 chains, S.  $58^{\circ}$  W. 1.50 chains, N.  $33^{\circ}$  W. 2.40 chains, N.  $12\frac{1}{2}^{\circ}$  W. 1.30 chains, N.  $64^{\circ}$  W. 1.80 chains, N.  $25^{\circ}$  W. 2.50 chains, N.  $42\frac{1}{2}^{\circ}$  W. 11.40 chains, S.  $65^{\circ}$  W. 2.60 chains,



JAN 6 5 1933

WATER RESOURCES DEPT.  
SALEM, OREGON

1  
2  
3  
4  
5  
6  
7  
8  
9  
10  
11  
12  
13  
14  
15  
16  
17  
18  
19  
20  
21  
22  
23  
24  
25  
26  
27  
28  
29  
30  
31  
32

S. 10° W. 3.30 chains, S. 2.50 chains, S. 32° W. 4.00 chains,  
S. 59° W. 2.20 chains, S. 13° W. 3.89 chains, S. 20° E. 2.20 chains,  
S. 40° W. 1.20 chains, S. 24° E. 3.00 chains, S. 17° W. 2.50 chains,  
S. 51° E. 1.40 chains, S. 18° E. 3.00 chains, S. 24° E. 4.50 chains,  
S. 21° W. 2.40 chains, S. 31° E. 3.83 chains, S. 54° E. 7.50 chains,  
S. 18° E. 3.00 chains, S. 14° W. 2.50 chains, S. 31° W. 5.00 chains,  
S. 25½° W. 2.50 chains, S. 32° W. 3.50 chains, S. 38° W. 3.50 chains,  
S. 34° W. 5.00 chains, S. 17½° W. 2.00 chains, S. 8° W. 3.00 chains,  
S. 73½° E. 2.00 chains, S. 4° W. 6.50 chains, S. 50° W. 4.00 chains,  
S. 45° W. 3.50 chains, N. 7½° E. 1.50 chains, N. 87° E. 2.00 chains,  
S. 48½° E. 5.00 chains, S. 59° E. 2.80 chains, N. 32° E. 5.00 chains,  
N. 6½° E. 2.00 chains, N. 16° E. 7.00 chains, N. 7° E. 3.00 chains,  
N. 81½° E. 2.00 chains, S. 62½° E. 2.00 chains, S. 56½° E. 3.50 chains,  
S. 20° W. 3.50 chains, N. 50° E. 3.00 chains, S. 83° E. 1.00 chains,  
S. 66° E. 3.00 chains, S. 27° E. 1.50 chains, S. 50° E. 1.00 chains,  
S. 78° E. 1.40 chains, S. 54° E. 3.00 chains, S. 45° E. 1.00 chains,  
S. 45° W. 1.50 chains, S. 13½° W. 3.00 chains, S. 74½° E. 2.50 chains,  
N. 43° E. 90 chains, S. 59½° E. 2.00 chains, N. 85° E. 2.00 chains,  
S. 69½° E. 4.00 chains, N. 87° E. 8.25 chains, S. 85° E. 9.20 chains,  
S. 50½° E. 8.80 chains, N. 49½° E. 2.00 chains, N. 37° W. 5.50 chains,  
N. 68° E. 6.25 chains, S. 82½° E. 2.00 chains, S. 18½° E. 3.00 chains,  
N. 67½° E. 8.00 chains, S. 82½° E. 5.00 chains, S. 66° E. 4.00 chains,  
S. 11½° E. 4.50 chains, S. 4.00 chains, N. 4.00 chains, N. 13° E.  
2.00 chains, N. 62½° E. 3.00 chains, S. 70° E. 1.50 chains, S. 17°  
E. 1.50 chains, S. 72° E. 1.00 chains, S. 46½° E. 1.50 chains, S.  
27° E. 3.50 chains, S. 13° E. 4.50 chains, S. 45° W. 1.50 chains,  
S. 40° E. 4.50 chains, S. 74½° E. 2.00 chains, S. 65° E. 3.00 chains,  
S. 12° E. 5.00 chains, S. 65° E. 4.00 chains, S. 42° E. 12.00 chains,  
E. 4.00 chains, S. 32° E. 4.00 chains, S. 25° E. 5.00 chains, S. 27°  
E. 3.50 chains, S. 72½° E. 1.50 chains, S. 15° E. 7.00 chains, S. 14°  
W. 4.80 chains, S. 9½° E. 2.50 chains, S. 5.00 chains, S. 25° W. 1.50

RECEIVED

JAN 05 1933

WATER RESOURCES  
SALEM, OREGON

1  
2 chains, S.  $15\frac{1}{2}^{\circ}$  E. 2.00 chains, S.  $2\frac{1}{2}^{\circ}$  E. 5.00 chains, S.  $43\frac{1}{2}^{\circ}$  E.  
3 20.00 chains, S.  $23^{\circ}$  W. 11.00 chains, S.  $70\frac{1}{2}^{\circ}$  W. 9.00 chains, S.  $3$   
4  $31^{\circ}$  E. 6.00 chains, S.  $45^{\circ}$  E. 6.00 chains, S.  $26^{\circ}$  E. 1.50 chains,  
5 S.  $37\frac{1}{2}^{\circ}$  E. 8.00 chains, E. 6.50 chains, S.  $46\frac{1}{2}^{\circ}$  E. 5.50 chains, S.  
6  $25\frac{1}{2}^{\circ}$  E. 6.00 chains, S.  $2\frac{1}{2}^{\circ}$  W. 4.50 chains, S.  $36\frac{1}{2}^{\circ}$  E. 2.50 chains  
7 N.  $78^{\circ}$  E. 5.00 chains, N.  $10^{\circ}$  W. 6.50 chains, N.  $85^{\circ}$  E. 2.00 chains,  
8 E. 1.80 chains, S.  $30^{\circ}$  E. 8.00 chains, E. 5.00 chains, N.  $15^{\circ}$  E.  
9 5.00 chains, N. 1.00 chains, N.  $62^{\circ}$  W. 2.00 chains, N.  $11^{\circ}$  E. 5.00  
10 chains, N.  $85\frac{1}{2}^{\circ}$  E. 2.00 chains, N.  $34^{\circ}$  E. 2.50 chains, N.  $45^{\circ}$  W.  
11 2.00 chains, N.  $20\frac{1}{2}^{\circ}$  E. 4.00 chains, N.  $15^{\circ}$  W. 1.50 chains, N.  $2^{\circ}$   
12 W. 1.80 chains, N.  $27^{\circ}$  E. 3.50 chains, N.  $90^{\circ}$  E. 3.00 chains, N.  
13  $17\frac{1}{2}^{\circ}$  E. 10.00 chains, N.  $36\frac{1}{2}^{\circ}$  E. 13.00 chains, N. 3.00 chains, W.  
14 16.37 chains, N.  $77^{\circ}$  E. 12.00 chains, N.  $85^{\circ}$  E. 2.00 chains, N.  $62^{\circ}$   
15 E. 1.00 chains, N.  $72^{\circ}$  E. 3.00 chains, N.  $63\frac{1}{2}^{\circ}$  E. 2.00 chains, N.  
16  $59^{\circ}$  E. 2.50 chains, N.  $65^{\circ}$  E. 3.00 chains, S.  $74^{\circ}$  E. 4.50 chains,  
17 S.  $70^{\circ}$  E. 2.00 chains, S.  $46\frac{1}{2}^{\circ}$  E. 2.00 chains, S.  $43^{\circ}$  E. .95 chains,  
18 S.  $20^{\circ}$  W. 2.00 chains, S.  $57^{\circ}$  W. 5.50 chains, S.  $45^{\circ}$  W. 1.50 chains,  
19 E. 1.98 chains, N.  $62^{\circ}$  E. 6.00 chains, N.  $18^{\circ}$  E. 3.00 chains, N.  $45^{\circ}$   
20 W. 1.50 chains, N.  $20^{\circ}$  W. 1.36 chains, N.  $58^{\circ}$  W. 2.00 chains, N.  $68\frac{1}{2}^{\circ}$   
21 W. 2.70 chains, S.  $81\frac{1}{2}^{\circ}$  W. 5.30 chains, S.  $58^{\circ}$  W. 6.00 chains, S.  
22  $72\frac{1}{2}^{\circ}$  W. 5.00 chains, S.  $87^{\circ}$  W. 2.40 chains, N.  $85^{\circ}$  W. 2.20 chains, S.  
23  $73\frac{1}{2}^{\circ}$  W. 7.00 chains, S.  $45^{\circ}$  W. 4.00 chains, W. 6.00 chains, N.  $54\frac{1}{2}^{\circ}$   
24 E. 11.80 chains, E. 6.72 chains, N.  $45^{\circ}$  E. 1.42 chains, N.  $67\frac{1}{2}^{\circ}$  E.  
25 6.50 chains, N.  $45^{\circ}$  E. 2.00 chains, N.  $61\frac{1}{2}^{\circ}$  E. 5.50 chains, N.  $5^{\circ}$  E.  
26 2.20 chains, N.  $62^{\circ}$  E. 3.00 chains, N.  $29^{\circ}$  E. 10.14 chains, E. 2.95  
27 chains, N.  $60^{\circ}$  E. 8.00 chains, E. 1.00 chains, N. 4.50 chains, E.  
28 2.50 chains, N. .50 chains, N.  $28\frac{1}{2}^{\circ}$  W. 3.30 chains, N.  $71\frac{1}{2}^{\circ}$  W. 2.40  
29 chains, N. 6.33 chains, N.  $51\frac{1}{2}^{\circ}$  W. 5.00 chains, N.  $20^{\circ}$  W. 5.00 chains  
30 S.  $86^{\circ}$  W. 4.00 chains, S.  $80^{\circ}$  W. 2.50 chains, N.  $23^{\circ}$  W. 3.00 chains,  
31 N.  $12\frac{1}{2}^{\circ}$  E. 2.00 chains, N.  $64^{\circ}$  W. 1.80 chains, N.  $33\frac{1}{2}^{\circ}$  W. 4.00 chains  
32 N.  $78\frac{1}{2}^{\circ}$  W. 5.00 chains, N.  $4\frac{1}{2}^{\circ}$  E. 3.07 chains, N.  $14^{\circ}$  W. 2.00 chains.



RECEIVED

JAN 05 1993

WATER RESOURCES DEPT.  
SALEM, OREGON

1  
2 N. 2.30 chains, N. 5.00 chains, N.  $61\frac{1}{2}^{\circ}$  W. 4.00 chains, S.  $74^{\circ}$  W.  
3 2.00 chains, N.  $77^{\circ}$  W. 2.00 chains, N.  $2^{\circ}$  E. 2.00 chains, N.  $67^{\circ}$   
4 E. 5.80 chains, N.  $12^{\circ}$  E. 2.00 chains, N.  $82^{\circ}$  E. 3.00 chains, N.  $42\frac{1}{2}^{\circ}$   
5 E. 3.00 chains, S.  $29^{\circ}$  E. 3.00 chains, S.  $84\frac{1}{2}^{\circ}$  E. 3.00 chains, N.  $28^{\circ}$   
6 W. 4.00 chains, N. 6.50 chains, N.  $76^{\circ}$  W. 3.00 chains, N.  $55^{\circ}$  W. 4.00  
7 chains, N.  $43\frac{1}{2}^{\circ}$  W. 6.00 chains, N.  $7\frac{1}{2}^{\circ}$  E. 5.55 chains, N.  $3\frac{1}{2}^{\circ}$  E. 7.30  
8 chains, N.  $2^{\circ}$  W. 3.00 chains, N.  $9^{\circ}$  E. 4.40 chains, N.  $79^{\circ}$  W. 11.50  
9 chains, N.  $56\frac{1}{2}^{\circ}$  W. 3.00 chains, N.  $2\frac{1}{2}^{\circ}$  W. 3.00 chains, N.  $28\frac{1}{2}^{\circ}$  W.  
10 2.50 chains, E.  $86^{\circ}$  W. 4.00 chains, N.  $10^{\circ}$  W. 2.50 chains, N.  $43^{\circ}$   
11 E. 2.00 chains, S.  $70^{\circ}$  E. 3.00 chains, N.  $8\frac{1}{2}^{\circ}$  E. 5.5 chains, N.  
12  $66\frac{1}{2}^{\circ}$  W. 4.00 chains, S.  $17\frac{1}{2}^{\circ}$  W. 1.50 chains, W. 1.00 chains, N.  $4\frac{1}{2}^{\circ}$   
13 W. 3.50 chains, N.  $30^{\circ}$  E. 3.50 chains, S.  $76\frac{1}{2}^{\circ}$  W. 5.50 chains, S.  
14  $59\frac{1}{2}^{\circ}$  W. 2.00 chains, N.  $59^{\circ}$  W. 2.00 chains, N.  $28^{\circ}$  W. 4.00 chains,  
15 N.  $54^{\circ}$  W. 2.50 chains, S.  $71^{\circ}$  W. 2.50 chains, N.  $62^{\circ}$  W. 1.50 chains,  
16 W. 1.00 chains, S.  $26\frac{1}{2}^{\circ}$  W. 3.00 chains, S.  $61^{\circ}$  W. 5.00 chains, S.  
17  $24^{\circ}$  W. 3.00 chains, S.  $85^{\circ}$  W. 3.00 chains, N.  $11\frac{1}{2}^{\circ}$  E. 6.50 chains,  
18 E. 1.50 chains, N. 2.50 chains, N.  $70^{\circ}$  W. 6.00 chains, S.  $77\frac{1}{2}^{\circ}$  W.  
19 1.17 chains to the place of beginning. Also beginning 3.09 chains  
20 N. of the 1 section corner on E. boundary of Section 13, Tp. 28,  
21 BR 13 W. and run thence S.  $84^{\circ}$  E. 1.50 chains, E.  $25^{\circ}$  E. 1.50 chains,  
22 S.  $11^{\circ}$  E. 1.60 chains, S.  $21^{\circ}$  W. 2.50 chains, S.  $33^{\circ}$  W. 2.90 chains,  
23 S.  $79\frac{1}{2}^{\circ}$  W. 5.50 chains, S.  $60^{\circ}$  W. 5.50 chains, S.  $13^{\circ}$  E. 1.00 chains,  
24 E. 2.00 chains, S. 3.00 chains, N.  $48^{\circ}$  W. 3.30 chains, S.  $70^{\circ}$  W.  
25 5.50 chains, S.  $11^{\circ}$  W. 3.82 chains, W. 3.72 chains, N.  $60^{\circ}$  W. 3.00  
26 chains, N.  $60^{\circ}$  E. 3.00 chains, N. 3.00 chains, N.  $55^{\circ}$  W. 5.00 chains,  
27 W. 1.50 chains, S.  $50^{\circ}$  W. 2.00 chains, S.  $42\frac{1}{2}^{\circ}$  W. 3.50 chains, S.  
28  $45^{\circ}$  E. 1.00 chains, S.  $42\frac{1}{2}^{\circ}$  W. 2.50 chains, S.  $53^{\circ}$  W. 4.00 chains, N.  
29  $45^{\circ}$  W. 1.00 chains, S.  $19^{\circ}$  W. 6.00 chains, W. 2.00 chains, N.  $12^{\circ}$  E.  
30 11.00 chains, N.  $20^{\circ}$  E. 9.50 chains, N.  $23^{\circ}$  E. 3.500 chains, N.  $28\frac{1}{2}^{\circ}$   
31 E. 3.75 chains, N.  $38\frac{1}{2}^{\circ}$  E. 10.10 chains, S.  $83\frac{1}{2}^{\circ}$  E. 2.50 chains, N.  
32  $60^{\circ}$  E. 3.00 chains, N. 3.00 chains, N.  $60^{\circ}$  E. 3.00 chains, N. 2.50

5

RECEIVED

JAN 05 1993

WATER RESOURCES DEPT.  
SALEM, OREGON

1 chains, N. 81° E. 3.00 chains, S. 73½° E. 3.00 chains, N. 13° E.  
2 1.00 chains, S. 59° E. 2.50 chains, N. 2.50 chains, S. 50° E. 2/00  
3 chains, S. 5½° W. 3.00 chains, S. 13° E. .40 chains, S. 31½° E. 2.00  
4 chains, S. 40° E. 3.00 chains, N. 2.00 chains, E. 2.00 chains, S.  
5 2.00 chains, W. 1.00 chains, S. 32° W. 3.50 chains, S. 32° E. 3.50  
6 chains, to the place of beginning and containing 2239.98 acres of  
7 land, more or less.  
8

9 *CH* II.

10 That said lands are all situated in Coos County, Oregon, and  
11 are susceptible of one mode of drainage.

12 III.

13 That we desire to adopt measures to drain the same; that the  
14 number of acres in said proposed drainage district is 2239.98 acres;  
15 that said proposed drainage district contains 38 separate tracts, and  
16 the number of acres in each tract and the owners thereof are as follows:

17 Maggie Nedean, .92 acres, J. W. Lawrence - 3.19 acres, C. A.  
18 Iverden- 8.3 acres, T. A. Iverden-- 9.64 acres, Alfred Flanders--  
19 13.56 acres, H. H. Tyrrell-- 12.78, C. A. Webb--23.84, R. S. Knowlton  
20 --16.02 acres, John Hartley--4.51 acres, Z. Russ & Sons--1031.63 acres  
21 Geo. Robinson--10.57 acres, C. R. Gabeler--76.60 acres, H. M. Tuttle--  
22 3.15 acres, H.G.Hathaway--52.70 acres, Erminia Disher--17.47 acres,  
23 Nelson Lamme--51.88 acres, Geo. Conger--47.74 acres, Samuel Olsen--  
24 24.16 acres, R.O.Dickson & W.F.Dickson--184.50, B.F.Smith, John Smith,  
25 Harvey Smith, Alfred Smith and Ebel Humphrey, being heirs at law of  
26 Samuel Smith, deceased,--19.30, William Norris--46.02, acres, Thos. An-  
27 derson--23.78 acres, Janey Laird--21.11 acres, A.P.King--53.02 acres,  
28 A.J.Sherwood 34.18 acres, T.A.Willard--4.30 acres, Edward Johnson--  
29 43.54 acres, J.L.Roy 31.68 acres, B.F.Collier--19.39 acres, Charles M  
30 Self, Arthur Self, and Emma Self, heirs of G. B.Self, deceased,--36.28  
31 acres, J.W.Mast--57.84 acres, Elizabeth Gilman--37 acres, William Wheel-  
32 er--4.25 acres, Susan F.Leneve--.99 of an acre, J.P.Johnson 22.03/acre



RECEIVED

JAN 05 1993

WATER RESOURCES DEPT  
SALEM, OREGON

1  
2 acres, C. D. Banning--18.25 acres, Wm. Clark-- 80 acres, Unknown--  
3  
4 40 acres.

4 IV.

5 That C. A. Gabeler, Wm. Russ and Edward Johnson are three  
6 persons and three petitioners who desire to serve as trustees for  
7 the first year from the date of the formation of said drainage dis-  
8 trict.

9 S. Russ & Son Co, a corporation, by W. L. Kistner, its Attorney  
in fact.

10 Dickson and Dickson, by W. L. Kistner, their Attorney in fact.

11 Andrew Meng, by W. L. Kistner, his agent.

12 H. K. Tuttle.

13 C. A. Gabeler.

14 A. J. Sherwood.

15 W. E. Disher.

16 S. M. Olsen.

17 Wm. Wheeler.

18 C. H. Kenning.

19 Geo. Conger.

20 H. Lamney.

21 Ed. Johnson.

22 James W. East.

23 J. W. Laird.

24 J. F. Johnson, by D. H. Johnson.

25 P. W. Laird.

26 H. K. Tyrroll.

27 John I. Hartley.

28 Thomas Anderson.

29 William Morris.

30 B. F. Collier.

31 C. W. Webb.

RECEIVED

JAN 05 1933

WATER RESOURCES DEPT.  
SALEM, OREGON

1  
2 STATE OF OREGON )  
3 COUNTY OF COOS ) ss.

4 I, A. J. Sherwood, being first duly sworn, depose and say  
5 that I am one of the petitioners in the foregoing petition ask-  
6 ing the County Court for Coos county, Oregon to form a drainage dis-  
7 trict in what is known as the Fat Elk Basin in Coos county, Oregon;  
8 that I have read and am acquainted with the contents of the fore-  
9 going petition and the same is true as I verily believe.

10  
11 A. J. Sherwood.

12 Subscribed and sworn to before me  
13 this 9th day of April, 1907.

14 O. C. Sanford.

15 (Seal)

16 Notary Public  
17 for Oregon.

18 The foregoing petition for a Drainage District, by order of  
19 the County Court, for Coos county, Oregon, is hereby approved 23  
20 day of May, 1907.

21 John F. Hall.  
22 County Judge for Coos county,  
23 Oregon.

24 Attest:

25 James Watson.  
26 County Clerk for Coos county, Oregon.  
27 (Seal) By Robt. R. Watson, Deputy.

28 Indorsed:

29 # 6. Petition for Drainage District in Fat Elk Basin.  
30 State of Oregon, County of Coos, ss. I hereby certify that the with-  
31 in instrument was filed for record June 4, 1907, at \_\_\_\_\_ o'clock and  
32 \_\_\_\_\_ minutes \_\_\_\_\_ .M., and recorded June 4, 1907, in book 8 of  
33 Co. Court Journal in page 593.

34 James Watson.  
35 County Clerk.

RECEIVED

JAN 05 1993

WATER RESOURCES DEPT.  
SALEM, OREGON

1  
2  
3  
4  
5  
6  
7  
8  
9  
10  
11  
12  
13  
14  
15  
16  
17  
18  
19  
20  
21  
22  
23  
24  
25  
26  
27  
28  
29  
30  
31  
32

IV.

That prior to the filing of said Petition and on the 23d day of May, 1907, the County Court for Coos County, Oregon, duly made and caused to be entered of record an order approving said Petition, which said order of approval is in words and figures as follows:

In the Matter of the Petition for a  
Drainage District in Fat Elk Basin, in  
Coos County, Oregon.

The above entitled matter coming on to be heard and it appearing to the court that all the lands included in said proposed drainage district are susceptible of one mode of drainage; that said district contains thirty-eight separate tracts, and that each tract contains the number of acres as stated in said petition.

That more than one-half the owners representing more than one-third the area of lands in said district have signed said petition.

That said petition is duly verified by A. J. Sherwood, one of said petitioners.

That said petition has been published four weeks in a newspaper published in Coos County, Oregon, the county in which said lands are situated.

That all the statements made in said petition are correct, and that no land is improperly included or excepted from said district.

It is therefore ordered that said petition be and the same is hereby approved; that said approval be noted upon said petition, that John F. Hall, county judge for Coos county Oregon, is hereby ordered to sign said approval, and James Watson, county clerk for Coos county Oregon, is hereby ordered to attest the same.

?



RECEIVED

JAN 05 1933

WATER RESOURCES DIVISION  
SALEM, OREGON

1  
2  
3  
4  
5  
6  
7  
8  
9  
10  
11  
12  
13  
14  
15  
16  
17  
18  
19  
20  
21  
22  
23  
24  
25  
26  
27  
28  
29  
30  
31  
32

Indorsed:

No. 6. In the Court of the State of Oregon, in and for  
the County of Coos.

In the Matter of Fat Elk Drainage District.

Order approving Petition.

Filed May 23, 1907. James Watson, Clerk. Robt. R. Watson, Deputy.

And upon said 23d day of May, 1907, in compliance with said  
order of approval the County Judge for Coos County, Oregon in-  
dorsed said approval upon said Petition and the same is duly at-  
tested by the County Clerk.

V.

That said Petition was duly verified by the Affidavit of  
one of the Petitioners and said Petitioners caused said Petition  
to be published in the Coquille Herald, a newspaper published in  
Coos County, Oregon, and in the County in which said lands con-  
tained in said District were situated as will appear by the Affi-  
davit of publication made by D. F. Dean, printer of said Coquille  
Herald, a copy of which Affidavit of proof of publication is in  
words and figures as follows:

1  
2  
3  
4  
5  
6  
7  
8  
9  
10  
11  
12  
13  
14  
15  
16  
17  
18  
19  
20  
21  
22  
23  
24  
25  
26  
27  
28  
29  
30  
31  
32

RECEIVED

JAN 05 1993

WATER RESOURCES DEPT  
SALEM, OREGON

AFFIDAVIT OF PUBLICATION.

STATE OF OREGON )  
                          ) SW.  
COUNTY OF COOS )

I, D. F. Dean, being first duly sworn, say that I am the printer of the Coquille Herald.

That said Coquille Herald is a weekly newspaper, published and issued weekly and regularly in the County of Coos, State of Oregon, and is of general circulation in said county and state. That the notice, of which the one hereto attached is a true and correct copy, was published in said newspaper not less than once a week for 5 weeks, being published 6 times; the first on the 10th day of April, 1907, and the last on the 15th day of May, 1907.

That said notice was published in the regular and entire issue of said paper not less than once a week during the said period and times of publication.

And that the said notice was published in the newspaper proper and not in a supplement.

D. F. Dean.

Subscribed and sworn to before me this 23 day of May, 1907.

(Seal)

A. J. Sherwood.  
Notary Public in Oregon.