

ATTACHMENT FOR SURFACE WATER REGISTRATION STATEMENT

Charlie H. and Sharon K. Waterman

Page 1: R. Davis Homestead

Question

2. Source of water:	Reservoir	Davis Creek & Ram Creek	Spring
Tributary to:	Davis Creek		Davis Ck
3. Purpose:	Livestock & Domestic (including garden and lawn)	Livestock	Livestock
4. Priority Date:			
a. First Use:	13Jan08	13Jan08	13Jan08
b. First Initiated:	13Jan08	13Jan08	13Jan08
c. Name of Party:	-----Rollie Davis-----		
5. Amount Claimed:	5 gpm	3 gpm	1 gpm
6. Locations:	--Section 18, Township30S, Range 14W--		
	S 1/2 of the NW 1/4 and the W 1/2 of the NE 1/4 of Section 18		
Water Source Map#	4	6	5

RECEIVED

AUG 20 1993

WATER RESOURCES DEPT.
SALEM, OREGON

ATTACHMENT FOR SURFACE WATER REGISTRATION STATEMENT

Charlie H. and Sharon K. Waterman

Page 2: F. Davis Homestead

Question

2. Source of water:	Spring	Conners Creek	Spring
Tributary to:	Conners Creek	New River	Ram Creek
3. Purpose:	Livestock, Domestic (Lawn & Garden)	Livestock	Livestock
4. Priority Date:			
a. First Use:	13Jan1908	13Jan1908	13Jan1908
b. First Initiated:	13Jan08	13Jan08	13Jan08
c. Name of Party:	-----Flora Davis-----		
5. Amount Claimed:	1 gpm	1 gpm	0.5 gpm
6. Locations:	Section 7 Township 30S Range 14	Section 7 and 18 Township 30 Range 14	
	S 1/2 of the SW 1/4 and SW 1/4 of the SE 1/4 of Section 7 and the NW 1/4 of the NW 1/4 of Section 18		
Water Source Map#	2	6	3

RECEIVED

AUG 20 1993

WATER RESOURCES DEPT.
SALEM, OREGON

ATTACHMENT FOR SURFACE WATER REGISTRATION STATEMENT

Charlie H. and Sharon K. Waterman

Page 3: Gerber Homestead

Question

2. Source of water:	Spring	Gerber Creek
Tributary to:	FourMile Ck.	FourMile Creek
3. Purpose:	Livestock	Livestock
4. Priority Date:		
a. First Use:	1908	1908
b. First Initiated:	1908	1908
c. Name of Party:	-----John H. Gerber-----	
5. Amount Claimed:	1 gpm	1 gpm
6. Locations:	Sections 7,8,17,18, Township 30S, Range 14W	
	SE 1/4 of the SE 1/4 of Section 7, the SW 1/4 of the SW 1/4 of Section 8, the NW 1/4 of the NW 1/4 of Section 17, and the NE 1/4 of the NE 1/4 of Section 18	
Water Source Map#	1	6

RECEIVED

AUG 20 1993

WATER RESOURCES
SALEM, OREGON

ATTACHMENT FOR SURFACE WATER REGISTRATION STATEMENT

Charlie H. and Sharon K. Waterman

Page 4: Haynes Homestead

Question

2. Source of water:	Spring	Ram Creek
Tributary to:	Ram Creek	Davis Creek
3. Purpose:	Livestock	Livestock
4. Priority Date:		
a. First Use:	1908	1908
b. First Initiated:	1908	1908
c. Name of Party:	--Flora M. Davis Haynes--	
5. Amount Claimed:	1/2 gpm	2 gpm
6. Locations:	Section 18, Township30S, Range 14W Government Lot 7 of Section 18	
Water Source Map#	4	6

RECEIVED
AUG 20 1993
WATER RESOURCES DEPT.
SALEM, OREGON

T. 30 S, R. 14 W. Sec. 7, 8, 17+18

Overlay of Charlie Waterman Map
Showing original Homestead Ownership

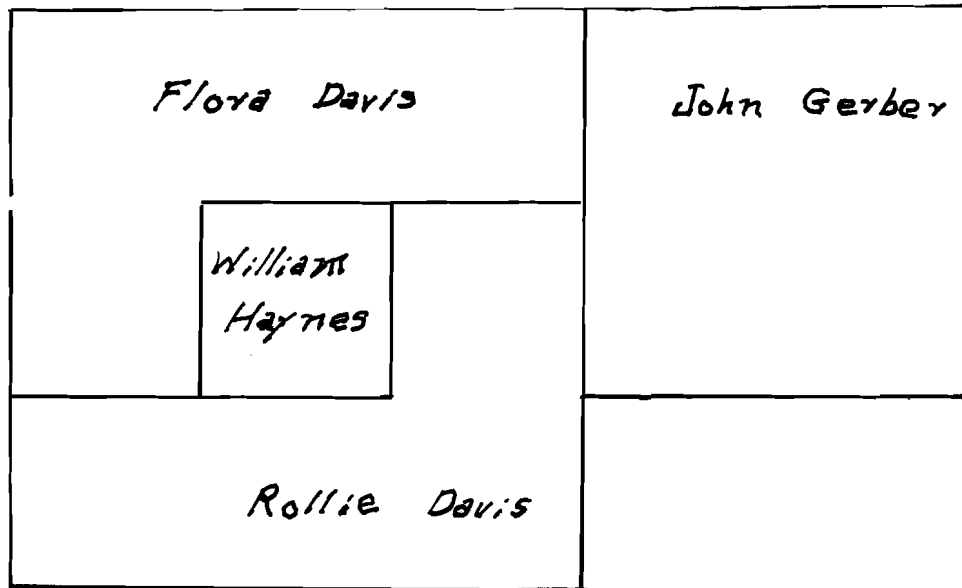

RECEIVED

AUG 28 1993

WATER RESOURCES DEPT.
SALEM, OREGON

REGISTRATION STATEMENT CLAIM OF BENEFICIAL USE

INFORMATION: Charlie H. Waterman and his family are the owners and residents of this ranch. Their address is Route 1, Box 1518-B, Bandon OR. 97411. Their phone number is 347-3453. The land use is for livestock pasture. The ownership is in one block. About three forties are in the Fourmile Creek drainage and nine forties are in the Davis Creek drainage area. The ranch consists of four old homestead claims. The water requested in this Registration is for 640 head of livestock and for domestic use for one family.

SOURCES: South Fourmile Creek which runs into the ocean sometimes directly and sometimes via New River; depending on the action of the sand dunes at the beach. And Conner Creek and Davis Creek which flow into Croft Lake then into New River and the ocean.

DIVERSION POINTS: POD 1, is in the SW $\frac{1}{2}$ SW $\frac{1}{2}$ of Section 8 is a 3 ft. by 3 ft. deep concrete tile dug into the ground at a spring. 1,050 ft. of plastic 1" in diameter carries the water to two watering troughs 50 ft. below the POD.

POD 2 is in the SW $\frac{1}{2}$ SE $\frac{1}{2}$ Section 7 and is a 3 ft. by 3 ft. deep concrete tile dug into the ground along side an unnamed stream, a tributary of Conner Creek. From the POD the water flows by gravity to a near by holding tank from which it is pumped to a 1 500 gal. reservoir tank which is about 50 feet higher than both POD and the place of use. About 1600 ft. of 1 $\frac{1}{2}$ " plastic pipe, underground, is used from the holding tank to the house and barn. A 3/4 hp Coulds electric motor, 220 volts, moves the water to the reservoir. Gravity power mives it from thereon.

POD 3 is in the NW $\frac{1}{2}$ NE $\frac{1}{2}$ Section 18 and is 2 $\frac{1}{2}$ ft. by 3 ft. deep concrete tile dug into the ground at a spring. Fifty ft. of 1" plastic pipe carries the water to a watering trough about 15 ft. below the POD.

POD 4 is in the NW $\frac{1}{2}$ NE $\frac{1}{2}$ of Section 18. It is a sump about 30 ft. in diameter and about 8 ft. deep. It was dug into the hillside at the source of a tributary of Davis Creek. A 3/4 hp motor pumps the water through about 1,100 ft. of 1" plastic pipe to a watering trough at his barn. This source is also supplement- at to his domestic needs from POD 2. This place of use is about 100 ft. above the POD.

POD 5 is in the SW $\frac{1}{2}$ NW $\frac{1}{2}$ of Section 18. It is a small sump hole to catch the water from a spring. Thirty ft. of 1" plastic pipe carries the water to a watering trough about 10 ft. below the POD.

Diversion 6 is for stream bank watering from any stream within the Charlie Waterman ownership as shown on the accompanying Pre-1909 Surface Water Registration Map.

CALCULATIONS: Water Resources Dept guidelines have been followed in figuring the water needs for this ranch, i.e. 0 005 CFS for one family use and 0.005CFS per 100 head of livestock.

See Page 2.

RECEIVED
AUG 20 1993
WATER RESOURCES DEPT.
SALEM, OREGON

use

This final proof survey and inspection of the/as found to be completed under the terms and conditions of the pre-1909 Water Registration Act was completed by me on June 9, 1993 and the facts contained in this report and accompanying Pre-1909 Surface Water Registration Map are correct to the best of my knowledge.

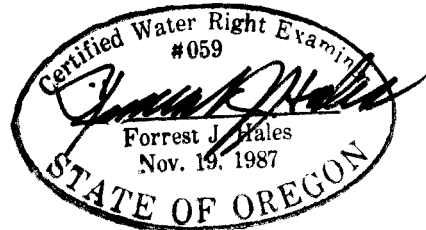

I Charlie Waterman agree to the findings of the CWRE and do submit this site report and map as my Claim of Beneficial Use of the water as provided under the terms and conditions of the Pre-1909 Surface Water Registration Act.

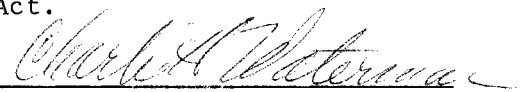
Charlie H. Waterman

RECEIVED

AUG 20 1993

WATER RESOURCES DEPT
SALEM, OREGON

Watermaster's Office
District No. 19
Coos County Courthouse
Coquille, OR 97423

Receipt *Charlie + Sharon Waterman*

Date: December 31, 1992

Amount: \$ 800⁰⁰

Fee-1909 application form. (2)

Received by:

James King
Asst. Watermaster Dict 19

JAN 05 1993

COOS COUNTY
COQUILLE, OR

Pre 1909 Water Rights (Revised)

Charlie H. Waterman

Rt 1 Box 1578B

Bandon, Or 97411

Coos County

Walker Place

Rolice Davis Homestead

Flora Davis Homestead

John H. Berber Homestead

Haynes Homestead

August 18, 1993

RECEIVED
AUG 20 1993
WATER RESOURCES DEPARTMENT
SALEM, OREGON

Don Knauer, Adjudication Specialist
Oregon Water Resources Department
3850 Portland Rd. NE
Salem, Oregon

Dear Mr. Knauer:

I am returning our Pre-1907 Water Right Applications to you. I have set the same priority date on the applications as you requested. Hopefully, the water source map that was completed by Mr. Hales is what you want.

All the properties on both our places and on Ray and Bessie's are contiguous properties.

I have also included in the packets on the River Ranch several additional affidavits.

I hope all is in order now, if not, please contact us. Thank you so much for you time and assistance. I apologize for not getting these to you sooner but Mr. Hales took quite some time to get the map revisions to us and that put us in the middle of the "work season."

Sincerely,

Sharon Waterman

Sharon Waterman
Route 1 Box 15186
Bandon, Oregon 97411
503-347-3453

P.S. Please note some revisions on the original application attachments!

April 27, 1993

CHARLIE H & SHARON K WATERMAN
ROUTE 1 BOX 1518B
BANDON OR 97411

RECEIVED

AUG 20 1993

WATER RESOURCES DEPT.
SALEM, OREGON

Dear Mr & Mrs Waterman,

I am returning the surface water registration statements and supporting documentation you sent to the Water Resources Department. You have included claims to beneficial use of water with various priority dates on the same claim forms. I am sending the instructions for filling out the forms and have highlighted #3 which reads, "You may list more than one beneficial use if all the uses started on the same date before 1909 (have the same priority date) and are on contiguous property." I am also sending a supply of claim forms.

On your attachments you have identified various homesteads. You will need to give the legal description on the attachment. You will also need to have those homesteads identified on your supporting maps by the Certified Water Right Examiner (CWRE). I have also included one of our map checklists and claim to beneficial use data sheets for your CWRE. The maps must be revised to show the required data.

Enclosed you will find receipt #96024 covering \$800.00 in fees.

If you have any questions, please give me a call.

Sincerely,

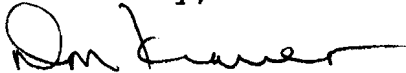

Don Knauer
Adjudication Specialist

J:\W\S\C\6\SWR-0609.001
WATERMAN.C&S



March 18, 1993

Water Resources Department
3350 Portland Road N. E.
Salem, Oregon 97310

Water Rights Examiner:

Enclosed you will find the Final Proof statements from the original paperwork completed for the people who filed claims on our land via the Homestead Act. We have the complete files on the Homestead Act claim made by the original owners of our properties. Should you want more than the Final Proof statements from these files, please contact us. We felt the Final Proof statement by the claimant held the information you would need.

We would like you to make one change in our original water right claim on the homestead of John H. Gerber. The original date of water usage needs to be changed to April 1, 1908 as per the information we received in the Homestead Act File from Suitland, Maryland.

We still have a number of affidavits from people validating use of water on our lands. They will be in your office sometime in the future. If you have a specific date that you need them, please contact us.

Sincerely,



Charlie Waterman
Route 1 Box 1518B
Bandon, Oregon 97411
Coos County

RECEIVED

MAR 23 1993

WATER RESOURCES DEPT
SALEM, OREGON

RECEIVED

AUG 20 1993

WATER RESOURCES DEPT
SALEM, OREGON

December 23, 1992

Oregon Water Resources Department
3850 Portland Rd. NE
Salem, Oregon 97310

To Whom It May Concern:

I have completed my documentation for Pre 1909 Water Rights. I have given to you an overall view of the history of my property. I have not included all the documents because that would mean sending you reams of paper. I have given you the document number and where they were found. I also have all the back taxes from the time I owned the places for which I am applying for water rights. Ray Waterman also has back taxes for the land which I purchased from him. If you want any of this documentation, please contact me and I will send you the Schedule F's and property taxes for the years you want.

We are presently trying to get the original homestead application from the Archives at Suitland, Maryland as they will document improvements and living on the places at the time of the homestead. We need these to date back two pieces of property as you will notice in your review. It is our understanding, after researching the conditions of the Homestead Act, that they must live on the property for 5 years and make certain improvements before receiving a deed. We have contacted one source in order to get them to you on a more timely basis but have not got a confirmation from them. If this source falls through, it will be two months before these documents will be in our hands as there is a tremendous waiting list for these materials.

I also am in the process of getting several affidavits. Three will deal with the River Ranch. Mr. Kistner, Mr. Edwards, and Mr. Deftleson will attest to the fact that cattle were run on that ranch. I also will have an affidavit from one of the DeHaven children who lived on the Walker place in the 1930's.

If you feel at any point there are voids not covered by affidavits, documentation, etc., please contact us and we will try to fill them for you.

Sincerely,

Charlie H. Waterman

Charlie H. Waterman
Route 1 Box 1510B
Bandon, Oregon 97411
Phone # 347-3453

RECEIVED

AUG 20 1993

**WATER RESOURCES DEPT.
SALEM, OREGON**

JAN 05 1993

SPRING DESCRIPTION SHEET

Section 8 Walker/Gerber Spring

WATER RESOURCES DEPT.
SALEM, OREGON

APPLICATION _____

1. Is the spring on property owned by applicant? Yes
2. If not, give name and address of legal owner: n/a
3. Have you secured consent of owner to appropriate water from this spring and for construction of pipeline or other works? n/a
4. If you do not have such consent, do you expect to secure right-of-way through condemnation? n/a
5. What is the maximum flow from the spring in gallons per minute or cubic feet of water per second? 3 gallons per minute
 What is the minimum flow? 1 gallon per minute
 Is flow measured or estimated? Estimated
6. Does the stream flowing from the spring form a well defined natural channel? Yes
About 25' down the hill
7. Does the water flow off the lands on which it first arises? Yes, only in winter month
8. Give the name of the stream or other body of water into which water from the spring flows: FourMile Creek
9. If the water from the spring sinks or evaporates before reaching other water, give distance water flows from spring before vanishing Only 350' in summer months
10. Remarks: _____

RECEIVED

AUG 20 1993

WATER RESOURCES DEPT.
SALEM, OREGON

Charlie H. Waterman
Signature

Signature

JAN 9 5 1993

2 SPRING DESCRIPTION SHEET

Section 7: Davis/Walker Place ALFA, OREGON

APPLICATION _____

1. Is the spring on property owned by applicant? Yes
2. If not, give name and address of legal owner: n/a
3. Have you secured consent of owner to appropriate water from this spring and for construction of pipeline or other works? n/a
4. If you do not have such consent, do you expect to secure right-of-way through condemnation? n/a
5. What is the maximum flow from the spring in gallons per minute or cubic feet of water per second? 3 gallons per minute
 What is the minimum flow? 1/5 gallons per minute
 Is flow measured or estimated? Estimated
6. Does the stream flowing from the spring form a well defined natural channel? Yes
after 20 ft.
7. Does the water flow off the lands on which it first arises? Yes, only in winter months
8. Give the name of the stream or other body of water into which water from the spring flows: Conners Creek
9. If the water from the spring sinks or evaporates before reaching other water, give distance water flows from spring before vanishing: Only 10' in the summer months
10. Remarks: _____

RECEIVED

AUG 20 1993

WATER RESOURCES DEPT.
SALEM, OREGON

Charlie H. Waterman
Signature

Signature

2 SPRING DESCRIPTION SHEET

Section 18: Haynes/Walker Place

APPLICATION _____

1. Is the spring on property owned by applicant? Yes
2. If not, give name and address of legal owner: n/a

3. Have you secured consent of owner to appropriate water from this spring and for construction of pipeline or other works? n/a
4. If you do not have such consent, do you expect to secure right-of-way through condemnation? n/a
5. What is the maximum flow from the spring in gallons per minute or cubic feet of water per second? 2 gallons per minute
 What is the minimum flow? 0 gallons per minute
 Is flow measured or estimated? Estimated
6. Does the stream flowing from the spring form a well defined natural channel? yes
after traveling 600'
7. Does the water flow off the lands on which it first arises? Only in winter months
8. Give the name of the stream or other body of water into which water from the spring flows: Ram Creek/ Davis Creek
9. If the water from the spring sinks or evaporates before reaching other water, give distance water flows from spring before vanishing: Doesn't flow in the summer and early fall months
10. Remarks: _____

RECEIVED

AUG 20 1993

WATER RESOURCES DEPT.
SALEM, OREGON

JAN 05 1993

WATER RESOURCES DEPT.
SALEM, OREGON

Charlie H. Waterman
Signature

Signature

JUL 6 5 1993

SPRING DESCRIPTION SHEET

WATER RESOURCES DEPT.
SALEM, OREGON

Section 18: R. Davis/Walker Place

APPLICATION _____

1. Is the spring on property owned by applicant? Yes
2. If not, give name and address of legal owner: n/a
3. Have you secured consent of owner to appropriate water from this spring and for construction of pipeline or other works? n/a
4. If you do not have such consent, do you expect to secure right-of-way through condemnation? n/a
5. What is the maximum flow from the spring in gallons per minute or cubic feet of water per second? 2 gallons per minute
 What is the minimum flow? 0 gallons per minute
 Is flow measured or estimated? Estimated
6. Does the stream flowing from the spring form a well defined natural channel? Yes
After traveling 400'
7. Does the water flow off the lands on which it first arises? Yes, only in winter mont
8. Give the name of the stream or other body of water into which water from the spring flows: Davis Creek
9. If the water from the spring sinks or evaporates before reaching other water, give distance water flows from spring before vanishing: Doesn't flow in late summer
and early fall months
10. Remarks: _____

RECEIVED

AUG 20 1993

WATER RESOURCES DEPT.
SALEM, OREGON

Charles Waterman
Signature

Signature

STATE OF OREGON

ss,

County of Coos

I, Ray S. Waterman, Being duly sworn, depose, and say that I purchased the place that Charlie H. Waterman presently owns from John H. Walker in 1959. During the time that I owned the property, I ran sheep and cattle on it. They got their water from the springs and the creek on the place. John Walker had sheep on the place. Walker bought the place from Wyss. Wyss also ran sheep on the place. I hauled sheep for Wyss and he wanted me to buy the place. Wyss purchased the place from Les Brown and the Wilsons. Brown had a livestock on the place and lived here. He had a ram in the creek and that's how Ram Creek was named. Ted Wilson had a house and barn and raised livestock and horses. I can remember that DeHaven lived here. Haynes ran the hardware in Bandon and Tracy leased the place and ran sheep on it.

Ray S. Waterman
x *Ray S. Waterman*

Subscribed and sworn to before me

December 21, 19*92*

Marcy Patridge

Notary Public for OREGON - Coos County
My Commission expires 3-24-95

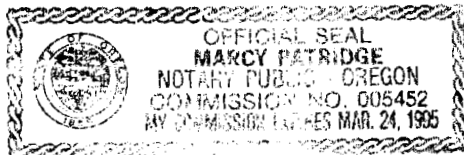

RECEIVED

AUG 20 1993

WATER RESOURCES DEPT.
SALEM, OREGON

STATE OF OREGON

55,

County of Coos

I, Charlie H. Waterman, being duly sworn, depose and say that I remember the ranch known as the Walker Place has been raising livestock since 1958 to date. It had remnant of and/or standing buildings on all four homesteads as I remember while riding horse back through the ranch to Paul Smith's for 4-H Club meetings when I was a kid. Before I bought the Walker Place in 1970, I worked closely with my father, Ray, running livestock, clearing land, and cleaning up old homesteads. The stock drank from the unnamed streams, Ram and Davis Creek, and springs located on the ranch. House water was and is being taken from Ram Creek and the spring applied for in the application.

In regard to the Coquille River Ranch, I also helped Dad and Chuck King raise cattle on this place for 19 years beginning in the fall of 1970. The cattle drank from the ditches, unnamed streams, Beaver Slough, and the spring. Water was and is pumped to various troughs on the place. The farm house used spring water for the garden, lawn, and home.

I lived on the south fork of FourMile with my parents, Ray and Bessie Waterman, until college and marriage. I came back to this area after college and still worked for Dad on a part-time basis. As a child, I fished and explored the ranch. I remember the Sis Mitchell house and barn. (Dad is getting water from her spring for his house, garden and lawn now.) There were buildings on the Welch, Tucker, Wilson, and Harper places. I even lived in my Granddad's (C. F. Waterman) place after returning from college. Water was taken from the spring on the hill for garden, lawn, and household use the same as it was when I was a child in the 1950's when Grandpa lived there. I used to go to Sunday School at Abbie Mecum's in the 1950's. That house is still there and the water that was used for the lawn, garden, and house came from an unnamed stream which flows from the hill across the road. They traded Dad pasture for livestock for Dad tilling their garden. The Lower Place (James Abbott) has been our hay field. When the haying is done, livestock are placed in this field and remain there until we want the hay crop to start growing. The old house there gets its water from a spring north of the house. There has been continuous livestock and domestic use on the FourMile Ranch, Walker Place, and River Ranch from springs, unnamed streams, and creeks listed in Dad's and my Pre 1909 Water application. From the time that I can remember the FourMile Ranch and Walker Place have run livestock.

RECEIVED

AUG 26 1993

WATER RESOURCES DEPT.
SALEM, OREGON

Charlie H. Waterman

Subscribed and sworn to before me

December 29, 1992

Cynthia Gant

Notary Public for Coos County, Oregon

My Commission expires 10-26-96
0925



RECEIVED

AUG 20 1993

WATER RESOURCES DEPT.
SALEM, OREGON

STATE OF OREGON

ss,

County of Coos

I, Sharon K. Waterman, being duly sworn, depose and say that I can attest to the fact that the Walker Place has been a working ranch with livestock on it since I first came to Bandon to visit the Waterman's in 1968. I used to go with Ray and Charlie when they fed the livestock during my visits. The livestock in this area got their drinking water from the streams and/or creeks and the springs.

I married Charlie in 1971. He had purchased the Walker Place the year before from his father. We have always ran livestock on this place and still do. Our home is also on this land.

The first year of our marriage, I helped Ray in the hay at the River Ranch. He, Chuck King, and Charlie were the owners at that time. They ran cattle on the place. We purchased the place in 1989. We have continued to run cattle on the ranch as well as sheep in the late summer, early fall. The house on the place has been a rental house not only under our ownership but also when it was owned by Waterman-King. The cattle drink from the drainage ditches, creek, and spring on that place. The house water comes from the spring.

Sharon K. Waterman

Subscribed and sworn to before me

December 29, 1992

Cynthia Gant

Notary Public for Coos County Oregon
My Commission expires 10-25-96

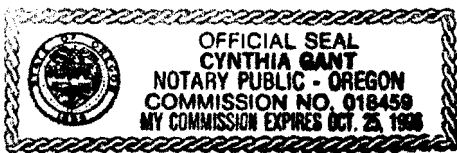

RECEIVED

AUG 20 1993

WATER RESOURCES DEPT.
SALEM, OREGON

RECEIVED

AUG 28 1993

WATER RESOURCES DEPT.
SALEM, OREGON

DESCRIPTION AND TITLE INFORMATION
Walker Place: Rollie Davis Homestead

Property Description: S 1/2 of the NW 1/4 and the W 1/2 of the NE 1/4 of section 18, T 30, R14, Coos County, Oregon.

Tax Lot Numbers: 100 (160 acres of this tax lot)

The following information validates water for livestock and domestic use prior to 1909 and continued to date:

Date	Document	Description
1907	PP Tax Vol 1 Pg 38	R. R. Davis Household Items and Livestock
17Jun08	51D263	Rollie Davis Homestead
1908	R/E Vol 3 Pg 186	Rollie Davis Real Estate
1910	PP Tax Vol 1 Pg 50	R. R. Davis Farm Implements, Household Items, & livestock
1915	PP Tax Vol 1 Pg 49	R. R. Davis Farm Implements & Livestock
1915	R/E Tax Vol 3 Pg 257	Rollie Davis Farmland
1921	PP Tax Vol 1 Pg 102	R. R. Davis Farm Implements & livestock
1928	R/E Tax Vol 3 Pg 162	Rollie Davis Real estate and Bldgs & Improvements
10Feb30	110D166	W. B. Haynes et al
1933	R/E Tax Vol 3 Pg 170	W. B. Haynes Farmland and Bldgs and Improvements
1937/38	R/E Tax Vol 3 Pg 156	W. B. Haynes Farmland and Bldgs and Improvements
28Mar40	135D633	Haynes to T.J. Wilson
1941/42	R/E Tax Vol 3 Pg 155	T. J. Wilson Farmland and Bldgs and Improvements

RECEIVED

AUG 20 1993

WATER RESOURCES DEPT.
SALEM, OREGON

-2-

9Jul40	79M70	Mortgage to Maude McAdams
13Oct49	193D552	John Gasner: release of livestock including 40 ewes and 2 bucks
11Dec50	204D659	Otto W. Wyss: deed
11Dec50	105M50	Leslie J. Brown: Mortgage
21Dec51	214D510	Lewis Kiekhoefer: deed
21Dec51	214D512	John H. Walker: deed
9Aug54	131M735	John H. Chenoweth: Mortgage
15Feb55	CM26927	Southern Oregon Production Credit: Chattel Mortgage for livestock and crops
20Oct59	274D177	Ray S. Waterman
16Sept63	303D627	Ray S. Waterman
28Oct70	70-10-52916	Charlie H. Waterman

The above documentation is located at the Clerk's Office and the Coos County Treasurer's Archives at the Coos County Courthouse, Coquille, Oregon.

the said Carol E. Bedillion and Robert E.L. Bedillion, do hereby covenant to and with Rollie Davis, his heirs and assigns that they are the owners in fee simple of said land; that they are free from all incumbrances and that they will warrant and defend the same from all lawful claims whatsoever.

IN WITNESS WHEREOF, we have hereunto set our hands and seals this 21st day of November,

in presence of:
Harrington, C.T. Blumenrother.

Caroline E. Bedillion, (seal)
R.E.L. Bedillion, (seal)

State of Oregon:
County of Coos: ss On the 21st day of November, 1905, personally came before me, a notary public in and for said county and state, the within named Caroline E. Bedillion and Robert E.L. Bedillion, "her husband", to me personally known to be the identical persons described in and who executed the within instrument, and who each personally and severally acknowledged to me that they executed the same freely and voluntarily for the uses and purposes therein named and without fear or compulsion from any one.

WITNESS my hand and seal this 21st day of November, 1905.

Recorded June 17, 1908, 9:45 A.M.:

Charles T. Blumenrother.

James Watson, County Clerk: (seal)

Notary Public for Oregon.

THE UNITED STATES OF AMERICA.

TO ALL TO WHOM THESE PRESENTS SHALL COME, GREETING.:

Homestead Certificate No. 6018:
Application 9686:

WHEREAS, There has been deposited in the GENERAL LAND OFFICE of the United States a certificate of the Register of the Land Office at Roseburg, Oregon, whereby it appears that, pursuant to the Act of Congress approved 20th May, 1862, "To secure Homesteads to Actual Settlers on the Public Domain, and the acts supplemental thereto, the claim of Rollie Davis has been established and duly consummated, in conformity to law, for the south half of the northwest quarter and the west half of the northeast quarter of section eighteen in township thirty south of range fourteen west of the Willamette Meridian, Oregon, containing one hundred sixty acres, according to the Official plat of the survey of the said Land, returned to the GENERAL LAND OFFICE by the Surveyor General:

NOW KNOW YE, That there is, therefore, granted by the UNITED STATES unto the said Rollie Davis the tract of Land above described; TO HAVE AND TO HOLD the said tract of land, with the appurtenances thereof, unto the said Rollie Davis and to his heirs and assigns forever; subject to any vested and accrued water rights for mining, agricultural, manufacturing, or other purposes, and rights to ditches and reservoirs used in connection with such water rights, as may be recognized and acknowledged by the local customs, laws, and decisions of courts, and also subject to the right of the proprietor of a vein or lode to extract and remove his ore therefrom, should the same be found to penetrate or intersect the premises hereby granted, as provided by law. And there is reserved from the lands hereby granted, a right of way thereon for ditches or canals constructed by the authority of the United States.

IN TESTIMONY WHEREOF, I, Theodore Roosevelt, President of the United States of America, have caused these letters to be made Patent, and the seal of the General Land Office to be hereunto affixed.

51 D 263
Rollie Davis
17 June 08

RECEIVED
AUG 26 1993
WATER RESOURCES DEPT.
SALEM, OREGON

GIVEN under my hand, at the city of Washington, the thirtieth day of January, in the year of our Lord one thousand nine hundred and eight and of the Independence of the United States the one hundred and thirty second.

Recorded Vol 720, page 269:

By the President: Theodore Roosevelt,

Recorded June 17, 1908, 9:45 P.M.

By M.U.Young, Secretary,

James Watson, County Clerk: (seal)

H.W.Sanford, Recorder of the General Land office.

THE UNITED STATES OF AMERICA.

TO ALL TO WHOM THESE PRESENTS SHALL COME, GREETING:

Homestead Certificate No. 6026:

Application 9756.

WHEREAS, There has been deposited in the GENERAL LAND OFFICE of the United States a certificate of the Register of the Land Office at Roseburg, Oregon, whereby it appears that, pursuant to the Act of Congress approved 20th May, 1862, "To secure Homesteads to Actual Settlers on the Public Domain", and the acts supplemental thereto, the claim of Flora M. Davis, widow of Fred S. Davis, has been established and duly consummated, in conformity to law, for the south half of the southwest quarter and the southwest quarter of the southeast quarter of section seven and the northwest quarter of the northwest quarter of Section eighteen in township thirty south of range fourteen west of the Willamette Meridian, Oregon, containing one hundred sixty acres. according to the official plat of the survey of the said land, returned to the GENERAL LAND OFFICE by the Surveyor General:

NOW KNOW YE, That there is, therefore, granted by the UNITED STATES unto the said Flora M. Davis, the tract of land above described; TO HAVE AND TO HOLD the said tract of land, with the appurtenances thereof, unto the said Flora M. Davis, and to her heirs and assigns forever; subject to any vested and accrued water rights for mining, agricultural, manufacturing, or other purposes, and rights to ditches and reservoirs used in connection with such water rights, as may be recognized and acknowledged by the local customs, laws, and decisions of courts, and also subject to the right of the proprietor of a vein or lode to extract and remove his ore therefrom, should the same be found to penetrate or intersect the premises hereby granted, as provided by law. And there is reserved from the lands hereby granted, a right of way thereon for ditches or canals constructed by the authority of the United States.

IN TESTIMONY WHEREOF, I, Theodore Roosevelt, President of the United States of America, have caused these letters to be made Patent, and the seal of the General Land Office to be hereunto affixed.

GIVEN under my hand, at the city of Washington, the thirtieth day of January, in the year of our Lord one thousand nine hundred and eight and of the Independence of the United States the one hundred and thirty second.

Recorded Vol 720, page 275.

By the President, Theodore Roosevelt,

By M.U.Young, Secretary,

James Watson, County Clerk: (seal)

H.W. Sanford, Recorder of the General Land Office.

RECEIVED

AUG 20 1993

WATER RESOURCES DEPT.
SALEM, OREGON

RECEIVED

AUG 20 199.

WATER RESOURCES DEPT.
SALEM, OREGON

MAR 19 1988
MAR 19 1988
SALEM, OREGON

HOMESTEAD PROOF TESTIMONY OF CLAIMANT.

Rollie Davis being called as a witness in his own behalf in support of homestead entry, No. 9686 for W $\frac{1}{2}$ of NE $\frac{1}{4}$ S $\frac{1}{2}$ NW $\frac{1}{4}$ S. 18 T. 30 S. R. 14 W. testifies as follows:

Question 1.—What is your name, age, and post-office address?
Answer.... Rollie Davis; age 27 years; P.O. Langlois, Curry Co. Oregon.

Ques. 2.—Are you a *native-born* citizen of the United States, and if so, in what State or Territory were you born?
Ans. Native of California

Ques. 3.—Are you the identical person who made homestead entry, No. 9686 at the Roseburg, Oregon land office on the 13 day of January, 1990 and what is the true description of the land now claimed by you?
Ans. I am..... W $\frac{1}{2}$ of NE $\frac{1}{4}$ S $\frac{1}{2}$ of NW $\frac{1}{4}$ S. 18 T. 30 S. R. 14 W.

Ques. 4.—When was your house built on the land and when did you establish actual residence therein? (Describe said house and other improvements which you have placed on the land, giving total value thereof.)
Ans. House was built in 1899, moved into the house in 1899.
Size of house 12 by 16, one story, built of lumber, barn 24 by 42 ft and other outbuildings, orchard, about 20 acres cleared and seeded to grass, 1 mile lumber fence, 3/4 mile brush fence, all of the probable value of \$800.00

Ques. 5.—Of whom does your family consist; and have you and your family resided continuously on the land since first establishing residence thereon? (If unmarried, state the fact.)
Ans. Wife and two children. Absent temporarily.

Ques. 6.—For what period or periods have you been absent from the home used since making settlement, and for what purpose; and if temporarily absent, did your family reside upon and cultivate the land during such absence?
Ans. Absent temporarily, working for wages for support of family. Family resided on place most of the time in my absence. Cultivated some of the land every season since settling.

Ques. 7.—How much of the land have you cultivated each season, and for how many seasons have you raised crops thereon? If used for grazing only, describe fencing, state number and kind of stock grazed thereon, and by whom owned.
Ans. of cattle, 2 horses kept on the place all the time, kept about 4 to 12 head

Ques. 8.—Is your present claim within the limits of an incorporated town or selected site of a city of town used in any way for trade and business?
Ans. No.

Ques. 9.—What is the character of the land? Is it timber, mountainous, prairie, grazing, or ordinary agricultural land? State its kind and quality, and for what purpose it is most valuable.
Ans. Hill land, suitable for grazing only. Brush land.

Ques. 10.—Are there any indications of coal, salines, or minerals of any kind on the land? (If so, describe what they are, and state whether the land is more valuable for agricultural than for mineral purposes.)
Ans. None that I know of.

Ques. 11.—Have you ever made any other homestead entry? (If so, describe the same.)
Ans. No.

Ques. 12.—Have you sold, conveyed, or mortgaged any portion of the land; and if so, to whom and for what purpose?
Ans. No.

Ques. 13.—Have you any personal property of any kind elsewhere than on this claim? (If so, describe the same, and state where the same is kept.)
Ans. No.

Ques. 14.—Describe by legal subdivisions, or by number, kind of entry, and office where made, any other entry or filing (not mineral) made by you since August 30, 1890.
Ans. Never made any other entry.

(Sign plainly with full christian name.) Rollie Davis

*In case the party is of foreign birth a certified transcript from the court records of his declaration of intention to become a citizen, or of his naturalization, or a copy thereof, certified by the officer taking this proof, must be filed with this application. Exemptions of naturalization wholly required in final (five year) homestead cases.)

I HEREBY CERTIFY that the foregoing testimony was read to the claimant before being subscribed and sworn to before me this 20th day of July, 1906 at Coquille City, Coos County, Oregon.

[SEE NOTE BELOW.]

James Watson
County Clerk, ex-officio Clerk of the County Court of the State of Oregon, for Coos County.

Note.—The officer before whom the testimony is taken should call the attention of the witness to the following section of the Revised Statutes, and state to him that it is the purpose of the Government, if it be ascertained that he testifies falsely, to prosecute him to the full extent of the law.

Title LXX.—CRIMES.—Ch. 4.

SEC. 332. Every person who, having taken an oath before a competent tribunal, officer, or person, in any case in which a law of the United States authorizes an oath to be administered, that he will testify, declare, depose, or certify truly, or that any written testimony, declaration, deposition, or certificate by him subscribed is true, willfully and contrary to such oath states or subscribes any material matter which he does not believe to be true, is guilty of perjury, and shall be punished by a fine of not more than two thousand dollars, and by imprisonment, at hard labor, not more than five years, and shall, moreover, thereafter be incapable of giving testimony in any court of the United States until such time as the judgment against him is reversed. (See §1750.)

HOMESTEAD PROOF.

Rollie Davis
LAND OFFICE AT
Roseburg, Oregon.

Original Application No. 9686

Final Certificate No. 6018

Approved: Benjamin L. Edley, Register
J. M. Lawrence, Receiver.

E. E. Moore & Co., Legal Blank Publishers, Salem, Or.

FILED
JUL 22 1906
Benjamin L. Edley

RECEIVED

AUG 20 1903

WATER RESOURCES DEPT.
SALEM, OREGON

FINAL AFFIDAVIT REQUIRED OF HOMESTEAD CLAIMANTS.

Section of the Revised Statutes of the United States.

I, Rollie Davis, having made a Homestead entry of the W 1/2 of NE 1/4, S 1/4 of NW 1/4 S. 18, Section No. 18, in Township No. 30, S. of Range No. 14 W. subject to entry at Roseburg, Oregon, under section No. 2289 of the Revised Statutes of the United States, do now apply to perfect my claim thereto by virtue of section No. 2290 of the Revised Statutes of the United States; and for that purpose do solemnly SWEAR that I am a native citizen of the United States; that I have made actual settlement upon and have cultivated and resided upon said land since the day of in year 1899 to the present time; that no part of said land has been alienated, except as provided in Section 2288 of the Revised Statutes, but that I am the sole bona fide owner as an actual settler; that I will bear true allegiance to the Government of the United States; and, further, that I have not heretofore perfected or abandoned an entry made under the homestead laws of the United States, except

(Sign plainly with full christian name.)

Rollie Davis

I, James Watson, County Clerk of Coos County, Oregon, do hereby certify that the above affidavit was subscribed and sworn to before me this 20th day of July, 1906, at my office at Coquille City, Coos County, Oregon.

James Watson
County Clerk, ex-officio Clerk of the County Court of the State of Oregon, for Coos County.

DESCRIPTION AND TITLE INFORMATION
Walker Place Part 2: Flora M. Davis Homestead

Property Description: S 1/2 of the SW 1/4 and SW 1/4 of the SE 1/4 of Section 7 and the NW 1/4 of the NW 1/4 of Section 18 in T30, R 14, Coos County, Oregon.

Tax Lot numbers: 700, part in 100 at 160 acres

The following information validates water for livestock and domestic use prior to 1909 and continued to date:

Date	Document	Description
17Jun08	51D264	Flora M. Davis Homestead
1908	R/E Tax Vol 3 Pg 186	Flora M. Davis Real estate
1909	PP 7 R/E Tax Vol 1 Pg 85	Flora M. (Davis) Haynes Real Estate, Household items and livestock
1911	R/E Tax Vol 3 Pg 181	Flora M. Haynes Real estate and Bldgs and Improvements
1914	R/E Tax Vol 3 Pg 236	Flora M. (Davis) Haynes Real estate and Bldgs and Improvements
1916	R/E Tax Vol 3 Pg 257	Flora M. Haynes Real estate and Bldgs and Improvements
1920	R/E Tax Vol 3 Pg 147	Flora M. Haynes Real estate and Bldgs and Improvements
1925	R/E Tax Vol 3 Pg 150	Flora M Haynes Real estate and Bldgs and Improvements
1928	R/E Tax Vol 3 Pg 160	Flora M. Haynes Real Estate and Bldgs and Improvements
1933	R/E Tax Vol 3 Pg 169	Same as above
1937/38	R/E Tax Vol 3 Pg 156	Same as above
26Nov40	138D24	Leslie J. Brown et al: deed

RECEIVED

AUG 20 1993

WATER RESOURCES DEPT.
SALEM, OREGON

15Aug47	172D75	Timber Conservation Company Notation: refers to sufficient gates and/or cattle guard at interior fences.
13Oct49	193D552	John Gasner: Release
11Dec50	204D659	Otto W. Wyss: deed
25Feb57	256D609	John H. Walker: deed
20Oct59	274D177	Ray S. Waterman
28Oct70	70-10-52916	Charlie H. Waterman

You will find all these records in the Clerk's Office and the Coos County Treasurer's Archives in the Coos County Courthouse, Coquille, Oregon.

RECEIVED

AUG 20 1993

**WATER RESOURCES DEPT.
SALEM, OREGON**

year of our Lord one thousand nine hundred and eight and of the Independence of the United States the one hundred and thirty second.

Recorded Vol 720, page 269:

By the President: Theodore Roosevelt,

Recorded June 17, 1908, 9:45 P.M.

By M.U.Young, Secretary,

James Watson, County Clerk:

(seal)

H.W.Sanford, Recorder of the General Land office.

THE UNITED STATES OF AMERICA.

TO ALL TO WHOM THESE PRESENTS SHALL COME, GREETING:

Homestead Certificate No. 6026:

Application 9756.

WHEREAS, There has been deposited in the GENERAL LAND OFFICE of the United states a certificate of the Register of the Land Office at Roseburg, Oregon, whereby it appears that, pursuant to the Act of Congress approved 20th May, 1862, "To secure Homesteads to Actual Settlers on the Public Domain", and the acts supplemental thereto, the claim of Flora M.Davis, widow of Fred S.Davis, has been established and duly consummated, in conformity to law, for the south half of the southwest quarter and the southwest quarter of the southeast quarter of section seven and the northwest quarter of the northwest quarter of Section eighteen in township thirty south of range fourteen west of the Willamette Meridian, Oregon, containing one hundred sixty acres. according to the official plat of the survey of the said land, returned to the GENERAL LAND OFFICE by the Surveyor General:

NOW KNOW YE, That there is, therefore, granted by the UNITED STATES unto the said Flora M.Davis, the tract of land above described; TO HAVE AND TO HOLD the said tract of land, with the appurtenances thereof, unto the said Flora M.Davis, and to her heirs and assigns forever; subject to any vested and accrued water rights for mining, agricultural, manufacturing, or other purposes, and rights to ditches and reservoirs used in connection with such water rights, as may be recognized and acknowledged by the local customs, laws, and decisions of courts, and also subject to the right of the proprietor of a vein or lode to extract and remove his ore therefrom, should the same be found to penetrate or intersect the premises hereby granted, as provided by law. And there is reserved from the lands hereby granted, a right of way thereon for ditches or canals constructed by the authority of the United States.

IN TESTIMONY WHEREOF, I, Theodore Roosevelt, President of the United States of America, have caused these letters to be made Patent, and the seal of the General Land Office to be hereunto affixed.

GIVEN under my hand, at the city of Washington, the thirtieth day of January, in the year of our Lord one thousand nine hundred and eight and of the Independence of the United States the one hundred and thirty second.

Recorded Vol 720, page 275.

By the President, Theodore Roosevelt,

Recorded June 17, 1908, 9:45 A.M.:

By M.U.Young, Secretary,

James Watson, County Clerk:

(seal)

H.W. Sanford, Recorder of the General Land Office.

RECEIVED

AUG 20 1993

WATER RESOURCES DEPT.
SALEM, OREGON

RECEIVED

AUG 28 1993

MAR 19 1993

WATER RESOURCES DEPT.

HOMESTEAD PROOF-TESTIMONY CLAIMANT

Flora M. Davis, widow of Fred S. Davis, deceased, being called as a witness in her own behalf in support of homestead entry, No. 9756, for S 1/2 of SW 1/4, SW 1/4 or SE 1/4 S. 7; NW 1/4 of NW 1/4 Sec 18 T. 30 N. R. 14 W.

Question 1.—What is your name, age, and post office address? Answer..... Flora M. Davis, age 25 years; P.O. Langlois, Curry Co: Ore

Ques. 2.—Are you a native-born citizen of the United States, and if so, in what State or Territory were you born? Ans..... Native of Kansas .

Ques. 3.—Are you the identical person who made homestead entry, No. 9756, at the Roseburg, Oregon land office on the 24 day of February, 1900 and what is the true description of the land now claimed by you?

Ans.... I am the widow of Fred S. Davis, deceased, who made the above entry; S 1/2 of SW 1/4, SW 1/4 of SE 1/4 S. 7; NW 1/4 of NW 1/4 S. 18 T. 30 S.R. 14 W.

Ques. 4.—When was your house built on the land and when did you establish actual residence therein? (Describe said house and other improvements which you have placed on the land, giving total value thereof.)

Ans. Built small house prior to filing; Built a larger one about April 1900. Size of last house 16 by 24 ft full story; barn, about 16 by 24 ft other out buildings, fruit trees; 7 acres cleared and under fence; all of the probable value of \$700.00 Moved into the house as soon as completed.

Ques. 5.—Of whom does your family consist; and have you and your family resided continuously on the land since first establishing residence thereon? (If unmarried, state the fact.)

Ans..... Widow, Family consists of self and one child 3 years old; Previous to husbands death lived on the premises all the time.

Ques. 6.—For what period or periods have you been absent from the homestead since making settlement, and for what purpose; and if temporarily absent, did your family reside upon and cultivate the land during such absence?

Ans..... He was absent working for wages temporarily, Family lived on the place in his absence. Had no other home or place of residence. Since his death, I have had to live other places, being unable to live alone with my little child on the lonely premises.

Ques. 7.—How much of the land have you cultivated each season, and for how many seasons have you raised crops thereon? If used for grazing only, describe fencing, state number and kind of stock grazed thereon and by whom owned.

Ans..... A small garden has been grown each season, 7 acres in grass, from 5 to 10 head of cattle of our own on the land all the time.

Ques. 8.—Is your present claim within the limits of an incorporated town or affected site of a city or town, and used in any way for trade and business?

Ans..... No.

Ques. 9.—What is the character of the land? Is it timber, mountainous, prairie, grazing, or ordinary agricultural land? State its kind and quality, and for what purpose it is most valuable.

Ans..... Mountainous, Brush land; most valuable for stock raising.

Ques. 10.—Are there any indications of coal, salines, or minerals of any kind on the land? (If so, describe what they are, and state whether the land is more valuable for agricultural than for mineral purposes.)

Ans..... No Sir.

Ques. 11.—Have you ever made any other homestead entry? (If so, describe the same.)

Ans..... No.

Ques. 12.—Have you sold, conveyed, or mortgaged any portion of the land; and if so, to whom and for what purpose?

Ans..... No.

Ques. 13.—Have you any personal property of any kind elsewhere than on this claim? (If so, describe the same, and state where the same is kept.)

Ans..... No.

Ques. 14.—Describe by legal subdivisions, or by number, kind of entry, and office where made, any other entry or filing (not mineral) made by you since August 30, 1890.

Ans..... Never made an other entry.

(Sign plainly with full christian name)

Flora M. Davis

(In case the party is of foreign birth a certified transcript from the court records of his declaration of intention to become a citizen, or of his naturalization, or a copy thereof, certified by the officer taking this proof, must be filed with the case. Evidence of naturalization is only required in final (five year) homestead cases.)

I HEREBY CERTIFY that the foregoing testimony was read to the claimant before being sworn to before me this 20th day of July, 1906 at Coquille City in Coos County, Oregon.

[SEE NOTE BELOW.]

James Watson
County Clerk, ex-officio Clerk of the County Court of the State of Oregon, for Coos County.

NOTE.—The officer before whom the testimony is taken should call the attention of the witness to the provisions of section of the Revised Statutes, and state to him that it is the purpose of the Government, if it be ascertained that he testifies falsely, to prosecute him to the full extent of the law.

Title LXX.—CRIMES.—Ch. 1.

SEC. 5302. Every person who, having taken an oath before a competent tribunal, officer, or person, in any case in which the United States authorizes an oath to be administered, that he will testify, declare, depose, or certify truly, or that any declaration, deposition, or certificate by him subscribed is true, willfully and contrary to such oath states or subscribes any matter which he does not believe to be true, is guilty of perjury, and shall be punished by a fine of not more than two thousand dollars, and by imprisonment, at hard labor, not more than five years, and shall, moreover, thereafter be incapable of giving evidence in any court of the United States until such time as the judgment against him is reversed. (See §1750.)

Flora M. Davis

HOMESTEAD PROOF

Flora M. Davis

Fred S. Davis

Original Application No. 9756

Final Certificate No. 6026

Approved: *Benjamin L. Edley* Register

J. H. Lawrence Receiver

Benjamin L. Edley Register
J. H. Lawrence Receiver

E. E. Mares & Co., Legal Blank Publishers, Salem, Or.

FILED
JUL 23 1906
Benjamin L. Edley

FINAL AFFIDAVIT REQUIRED OF HOMESTEAD CLAIMANT

Section.....of the Revised Statutes of the United States.

I, Flora M. Davis, widow of Fred S. Davis, deceased, having made a Homestead entry of the

SE $\frac{1}{4}$ S. 7, NW $\frac{1}{4}$ of NW $\frac{1}{4}$ S. Section No. 18 in Township No. 30 S. of Range

subject to entry at Roseburg, Oregon, under Section No. 2288

Statutes of the United States, do now apply to perfect my claim thereto by virtue of Section No. 2288

of the Revised Statutes of the United States; and for that purpose do solemnly SWEAR

that I am a native a citizen of the United States;

actual settlement upon and have cultivated and resided upon said land since the

of April, 1900 to the present time; that no part of said land has been

as provided in Section 2288 of the Revised Statutes, but that I am the sole bona fide owner as

that I will bear true allegiance to the Government of the United States; and, further, that I have

perfected or abandoned an entry made under the homestead laws of the United States, ~~except~~

(Sign plainly with full christian name.)

Flora M. Davis

I, James Watson, County Clerk, Coos County,

do hereby certify that the above affidavit was subscribed and sworn to before me this

July, 1906 at my office at Coquille City

County, Oregon.

James Watson
County Clerk, ex-officio Clerk of the County Court of the State of Oregon, for Coos County.

DESCRIPTION AND TITLE INFORMATION
Walker Place Part 3: John Gerber Homestead

Property Description: SE 1/4 of the SE 1/4 of Section 7, the SW 1/4 of the SW 1/4 of Section 8, the NW 1/4 of the NW 1/4 of Section 17 and the NE 1/4 of the NE 1/4 of Section 18 in T 30, R 14 Coos County, Oregon. 160 acres

Tax Lots Numbers: 500 in Section 8, 2500 in Section 17, and parts of 100 and 700

The following information validates water use for livestock prior to 1909 and continued to date:

Date	Document	Description
29 Mar 15 1 Apr. 1908	71D123	John H. Gerber Homestead <i>Homestead</i>
1916	PP Tax Vol 1 Pg 72	John and Geo Gerber Livestock
21 Apr 21	85D6	Ben B. Parks: deed
1923	PP Tax Vol 1 Pg 103	Ben B. Parks Livestock
1924	PP Tax Vol 1 Pg 109	Ben B. Parks Livestock
1928	R/E Tax Vol 3 Pg 162	Ben B. Parks Farmland and Bldgs and Improvements
9 Jul 28	105D454	R.R. Davis: deed
1928	R/E Tax Vol 3 Pg 162	Rollie Davis Real estate and Bldgs and Improvements
25 Jul 30	111D379	A.M. DeHaven: deed
1933	R/E Tax Vol 3 Pg 170	A. M. DeHaven Farmland and Bldgs and Improvements
12 Sept 34	121D490	T.L. Wilson: deed
1936/37	PP Tax Vol 1 Pg 37	T. L. Wilson Livestock
1936/37	R/E Tax Vol 3 Pg 156	T. L. Wilson Farmland and Bldgs and Improvements

JUN 28 1933
 RECEIVED
 AUG 20 1993
 WATER RESOURCES DEPT.
 SALEM, OREGON

1941/42	R/E Tax Vol 3 Pg 155	T. L. Wilson Farmland and Bldgs and Improvements
1942/43	PP Tax Vol 1 Pg 106	T. L. Wilson Farm Implements & livestock
26Feb48	178D625	Manford A. Martin; deed
26Feb48	178D627	John Gasner et al
11Dec50	204D656	Otto W. Wyss, deed
25Feb57	256D609	Deed to John H. Walker et al
20ct59	274D177	Ray S. Waterman
28Oct70	70-10-52916	Charlie H. Waterman

All documentation is located in Clerk's Office and the Coos County Treasurer's Archives at the Coos County Courthouse, Coquille, Oregon.

RECEIVED

AUG 20 1993

WATER RESOURCES DEPT.
SALEM, OREGON

is reserved from the lands hereby granted, a right of way thereon for ditches or canals constructed by the authority of the United States.

IN TESTIMONY WHEREOF, I, Woodrow Wilson, President of the United States of America, have caused these letters to be made Patent, and the seal of the General Land Office to be hereunto affixed.

Given under my hand, at the City of Washington, the fifteenth day of December in the year of our Lord one thousand nine hundred and Fourteen and of the Independence of the United States the one hundred and thirty-ninth.

Recorded: patent Number 449045.

By the President: Woodrow Wilson,
BY M. P. Le Roy, Secretary,
L. Q. C. Lamar,
Recorder of the General Land Office.
(Seal: United States General Land Office.)

Recorded March 29, 1915, 8 A.M.
Robt. R. Watson, County Clerk.

RECEIVED

AUG 20 1933

WATER RESOURCES DEPT.

SALEM, OREGON

8927. THIS INDENTURE, Made the 24th day of November in the year of our Lord, 1914 between John Lamont (a widower unmarried) of the County of Coos and State of Oregon party of the first part and grantor and Letta M. Schellhamer of the aforesaid County and State, the party of the second part,

WITNESSETH, That the said party of the first part, for and in consideration of the sum of Four Hundred and Fifty Dollars, lawful moneys of the United States of America, to him in hand paid by the said party of the second part, the receipt whereof is hereby acknowledged, have granted, bargained, sold, conveyed and confirmed, and by these presents does grant, bargain, sell, convey and confirm unto the said party of the second part, and to her heirs and assigns, forever, the following described real property, to-wit:

Beginning at the North-east corner of Lot Four (4) in Section Six. (6) Township Twenty-nine (29) South of Range Fourteen (14) West of the Willamette Meridian in Coos County State of Oregon, and running thence South along the East line of said Lot 4 Thirteen hundred and Twelve and one half (1312½) feet: Thence West along the South line of said Lot 4, Three Hundred and Eighteen (318) feet: Thence North on a line parallel with said East line of said lot, Thirteen Hundred and twelve and one half (1312½) feet to the North line thereof,: Thence East along the north line of said lot, three Hundred and Eighteen (318) feet to the place of beginning.

Provided However and the parties hereto agree to reserve a strip of land Twenty (20) feet wide off the North end of the above described tract for a road, to be used by the parties hereto or their heirs or assigns and the public, until such time as a better or more suitable road shall be provided; Further provided that in case of the closing of aforesaid road as above provided, or the vacation thereof by process of law, then the said strip of land shall revert to the grantee herein her heirs or assigns.

Together with all and singular the tenements, hereditaments and appurtenances thereunto belonging, or in anywise appertaining, and the reversion and reversions, remainder and remainders, rents, issues and profits thereof; and also all the estate, right, title, interest, property, possession, claim and demand whatsoever, as well in law as in equity, of the said

DEPARTMENT OF THE INTERIOR.

HOMESTEAD ENTRY

Roseburg, Oregon

No. 14873

1391928

Receipt No. 124193-9

RECEIVED

AUG 20 1993

WATER RESOURCES DEPT. SALEM, OREGON

FINAL PROOF.

TESTIMONY OF CLAIMANT.

24

your full name, age, and post-office address?

ANSWER. John H. Gerber, 33 years, LeClain, Oregon

QUESTION 2. Are you a native-born citizen of the United States, and if so, in what State or Territory were you born? (If foreign born, see Note 1.)

ANSWER. Yes, was born in Nebraska

Serial No. 04455

QUESTION 3. Are you the same person who made Homestead Entry No. 14813, at the Roseburg

Oregon Land Office on the 24th day of March

1908, for the SE 1/4 SE 1/4 Sec. 7, SW 1/4 SW 1/4 Sec. 8, and NE 1/4 NW 1/4 Sec. 17, and NE 1/4 NE 1/4, Section 18, Township 30 South Range 14 West, Willamette Meridian?

ANSWER. Yes

QUESTION 4. (a) Are you married or single? ANSWER. Single

(b) If married, of whom does your family consist?

ANSWER.

(c) If a married woman, state whether your husband now has an unperfected homestead entry, and during what time he has resided on this land with you?

ANSWER.

QUESTION 5. (a) When did you first establish actual residence upon this land?

ANSWER. About April 1, 1908

(b) When was your house built on this land?

ANSWER. There was a house on the land when I went there, and I built an addition to it during the latter part of April, 1908

(c) Have either you or your family ever been absent from the homestead since establishing residence?

ANSWER. No, excepting for short periods when I was working to make a living.

(d) If there has been such absence, give the dates covered by each absence; and as to each absence state whether you, your family, or both, were thus absent and the reason for each such absence?

ANSWER. I do not remember the exact dates, but I have been absent not longer than three months at any one time, on several occasions working for wages that I might live on the land the rest of the time and improve it. I do not remember the exact dates of such absences, if absences they were, and I have made the land my home at all times to the exclusion of any other home.

QUESTION 6. Describe the land embraced in above entry by legal subdivisions, showing fully the character of same, and kind and amount of timber, if any.

ANSWER.

Subdivision.	Acres Cultivable Bench Land.	Acres Timbered, all suitable for cultivation when cleared.	Net Timber, suitable for
SE 1/4 SE 1/4			
The three following subdivisions are similar to the above, being bench land, mostly covered with brush, nearly all of which would be suitable for cultivation when cleared. It has no timber.			

QUESTION 7. State by subdivisions the number of acres cultivated, kind of crop planted, and amount harvested, each year. How many acres of the claim are now cleared, or broken, and under cultivation? If used for grazing only, state number and kind of stock grazed each year and by whom owned.

ANSWER. SE 1/4 SE 1/4 no improvements. SW 1/4 SE 1/4 no improve-
ments. NE 1/4 NW 1/4 2 acres slashed, burned and seeded to tame grass. NE
1/4 NE 1/4 about 35 acres slashed, burned and seeded to tame grass.
About 1/2 acre plowed on which I have raised grain hay and garden veg-
etables, and which is planted to an orchard. Have four head of cattle
pastured on the place owned by myself.

QUESTION 8. Describe fully and in detail the amount and kind of improvements on each subdivision. State total value of improvements on the claim.

ANSWER.

Subdivision.	Character of Improvements.
NE 1/4 NE 1/4	35 acres slashed, homestead & 20 ft fence, 1/4 mile road, orchard, with buildings, etc.
NW 1/4 NW 1/4	2 acres slashed and seeded, 1/2 mile good fence.
Total value	\$1000.00

QUESTION 9. Is your present claim within the limits of an incorporated town or selected site of a city or town, or used in any way for trade or business?

ANSWER. No

QUESTION 10. Are there any indications of coal, salines, or minerals of any kind on the land? If so, describe what they are.

ANSWER. No

RECEIVED

AUG 20 1993

WATER RESOURCES DEPT
SALEM, OREGON

QUESTION 11. Have you ever made any other homestead entry? If so, describe the same.

ANSWER.

QUESTION 12. Have you sold, conveyed, or agreed to sell or convey any portion of the land, if so, to whom and for what purpose?

ANSWER. NO

QUESTION 13. Have you optioned, mortgaged, or agreed to option or mortgage, or convey (this land) or any part thereof; if so, when, to whom, and for what purpose and in what amount?

ANSWER. NO

QUESTION 14. Have you any personal property of any kind elsewhere than on this claim? If so, describe the same, and state where the same is kept.

ANSWER. NO

RECEIVED

AUG 20 1993

WATER RESOURCES DEPT.
SALEM, OREGON

QUESTION 15. Describe by legal subdivisions, or by number, kind of entry, and office where made, any other entry or filing (not mineral) made by you since August 30, 1890.

ANSWER. Have made none

James H. Stewart
(Sign plainly, with full Christian name.)

NOTE 1.—If applicant is alien born, he should state the fact and file evidence of citizenship in due form, either a certificate of his own naturalization in a court of competent jurisdiction, or, if claiming to be a citizen by virtue of his father's naturalization and his own minority and residence in the United States at the date thereof, or, if a married woman claiming citizenship by virtue of her husband's nativity or naturalization, then record evidence of the naturalization of the father, or husband, or an affidavit as to the nativity of the latter.

NOTE 2.—The officer before whom the proof is made will see that all answers are complete and responsive to the questions.

NOTE 3.—The officer before whom the deposition is taken should call the attention of the witness to Section 5392 of the Revised Statutes (over), and state to him that it is the purpose of the Government, if it be ascertained that he testifies falsely, to prosecute him to the full extent of the law.

I HEREBY CERTIFY that the deponent was examined separately and apart from the other witnesses in the case; that the foregoing deposition was read to or by deponent in my presence before deponent affixed signature thereto; that deponent is to me personally known (~~or has been satisfactorily identified before me by~~);
(Give full name and post-office address.)

that I verily believe deponent to be the identical person hereinbefore described, and that said deposition was duly subscribed and sworn to before me at my office, in PORT OREGON,
(Town)
Curry County, Oregon, within the ROXBURG, OREGON land district,
(County and State.)
this 17th day of August, 19 14

Harvey Stewart
U. S. COMMISSIONER
(Official designation of officer.)

DESCRIPTION AND TITLE INFORMATION
Walker Place Part 4: Haynes Homestead

Property Description: Government Lot 7 of Section 18, T 30, R14,
Coos County, Oregon. 40 acres

Tax Lot Numbers: Part of 100 pg Section 18

The following information validates water use for livestock prior
to 1909 and continued to date:

Date	Document	Description
19Jul19	BOD373	William B. Haynes Homestead
1920	R/E Tax Vol 3 Pg 149	William B. Haynes Real estate and Bldgs and Improvements
1921	PP Tax Vol 1 Pg 102	William B. Haynes Farm Implements & livestock
1926	R/E Tax Vol 3 Pg 155	W. B. Haynes Farmland and Bldgs & Improvements
1931	R/E Tax Vol 3 Pg 160	W. B. Haynes Farmland and Bldgs & Improvements
1935-36	R/E Tax Vol 3 Pg 157	W. B. Haynes Farmland and Bldgs & Improvements
1939-40	R/E Tax Vol 3 Pg 155	W. B. Haynes Farmland and Bldgs & Improvements
26Nov40	138D24	Leslie J. Brown: deed
1941/42	R/E Tax Vol 3 Pg 155	Leslie J. Brown Bldgs and Improvements

The property from this point on has been consolidated. You may
refer to the Walker Place Part 2: Flora Davis Homestead Informa-
tion Sheet.

The above information may be found in the Clerk's Office and the
Coos County Treasurer's Office at the Coos County Courthouse,
Coquille, Oregon.

RECEIVED

AUG 26 1993

WATER RESOURCES DEPT.
SALEM, OREGON

k. 80

Vo 80/373

purposes therein named and without fear or compulsion from anyone.

WITNESS my hand and seal this 5th day of June, 1919.

Recorded July 19, 1919, 10 A.M.
W. Oddy, County Clerk. (Seal: E. F. Wolverton, Notary Public, State of Oregon.)

E. F. Wolverton,
Notary Public for Oregon.
My Commission expires Feb. 7, 1921.

JAN 15 1933

514. THE UNITED STATES OF AMERICA,

ROSEBURG O10116. TO ALL TO WHOM THESE PRESENTS SHALL COME, GREETING:

WHEREAS, a Certificate of the Register of the Land Office at Roseburg, Oregon, has been deposited in the General Land Office, whereby it appears that, pursuant to the Act of Congress of May 20, 1862, "To Secure Homesteads to Actual Settlers on the Public Domain," and the acts supplemental thereof, the claim of William B. Haynes has been established and duly consummated, in conformity to law, for the Lot seven of Section eighteen in Township thirty south of Range four east of the Tlamette Meridian, Oregon, containing forty and ninety-four-hundredths acres, according to the Official Plat of the Survey of the said Land, returned to the General Land Office by the Surveyor-General;

NOW KNOW YE, That there is, therefore, granted by the United States unto the said claimant the tract of Land above described;

TO HAVE AND TO HOLD the said tract of Land, with the appurtenances thereof, unto the said claimant and to the heirs and assigns of the said claimant forever; subject to the vested and accrued water rights for mining, agricultural, manufacturing, or other purposes, and rights to ditches and reservoirs used in connection with such water rights, which may be recognized and acknowledged by the local customs, laws, and decisions of courts; there is reserved from the lands hereby granted, a right of way thereon for ditches and canals constructed by the authority of the United States.

IN TESTIMONY WHEREOF, I, Woodrow Wilson, President of the United States of America, have caused these letters to be made Patent, and the seal of the General Land Office thereunto affixed.

GIVEN under my hand, in the District of Columbia, the seventh day of June in the year of our Lord one thousand nine hundred and nineteen and of the Independence of the United States the one hundred and forty-third.

RECORDED: Patent Number 684003.

By the President: Woodrow Wilson,
By M.P. Le Roy, Secretary.
L.Q.C. Lamar,
Register of the General Land Office.
United States General Land Office.)

Recorded July 19, 1919, 11 A.M.
W. Oddy, County Clerk. (Seal: E. F. Wolverton, Notary Public, State of Oregon.)

RECORDED

AUG 26 1933

WATER RESOURCES DEPT.
SALEM, OREGON

GREETING:
Roseburg, Oregon.

... pursuant to t

60
... therein named and without fear or compulsion from anyone.

... WITNESS my hand and seal this 5th day of June, 1919.

... July 19, 1919, 10 A.M.
... County Clerk. (Seal: E.F. Wolverton, Notary Public, State of Oregon.)
E. F. Wolverton,
Notary Public for Oregon.
My Commission expires Feb. 7, 1921.

THE UNITED STATES OF AMERICA,

... TO ALL TO WHOM THESE PRESENTS SHALL COME, GREETING:

... a Certificate of the Register of the Land Office at Roseburg, Oregon, has
... in the General Land Office, whereby it appears that, pursuant to the Act
... of May 20, 1862, "To Secure Homesteads to Actual Settlers on the Public
... and the acts supplemental thereto, the claim of William E. Haynes has been establi
... consummated, in conformity to law, for the
... of Section eighteen in Township thirty south of Range fourteen west of the
... Meridian, Oregon, containing forty and ninety-four hundredths acres.

... the Official Plat of the Survey of the said Land, returned to the General
... the Surveyor-General;

... That there is, therefore, granted by the United States unto the said
... tract of Land above described;

... AND TO HOLD the said tract of Land, with the appurtenances thereof, unto
... claimant and to the heirs and assigns of the said claimant forever; subject to
... accrued water rights for mining, agricultural, manufacturing, or other
... and rights to ditches and reservoirs used in connection with such water rights,
... recognized and acknowledged by the local customs, laws, and decisions of courts;
... reserved from the lands hereby granted, a right of way thereon for ditches
... constructed by the authority of the United States.

... WILSON WHEREOF, I, Woodrow Wilson, President of the United States of America,

... these letters to be made Patent, and the seal of the General Land Office to
... affixed.

... under my hand, in the District of Columbia, the seventh day of June in the ye
... one thousand nine hundred and nineteen and of the Independence of the United
... one hundred and forty-third.

... Patent Number 684003. By the President: Woodrow Wilson,
By M.P. Le Roy, Secretary.
L.Q.C. Lamar,
July 19, 1919, 11 A.M. Recorder of the General Land Office.
... County Clerk. (Seal: United States General Land Office.)

THE UNITED STATES OF AMERICA,

... THESE PRESENTS SHALL COME, GREETING:

... Register of the Land Office at Roseburg, Oregon,
... in the General Land Office, whereby it appears that, pursuant to the

RECEIVED
AUG 20 1993
WATER RESOURCES DEPT.
SALEM, OREGON

JUN 26 1919

STATE OF OREGON

SS

COUNTY OF COOS

I, hereby certify that the documentation for Charlie Waterman bearing signatures of Janice Anglin or Rosie Kimball or Mary Barton were abstracted from the original Coos County Assessment and Tax/Personal Property, Assessment and Tax or Personal Property Rolls in the custody of the Coos County Tax Department and that this documentation is a true and correct abstract of said original.

Dated this 29th day of December, 1992.

COOS COUNTY TAX DEPARTMENT

BY Carolyn Sunstine

RECEIVED
AUG 20 1993
WATER RESOURCES DEPT.
SALEM, OREGON

JAN 05 1993

SALEM, OREGON

SURFACE WATER REGISTRATION CHECKLIST

(received after July 18, 1990)

CHECK BASIN MAP See NAME S. Coast # 17 UNADJUDICATED AREA ? YES
 RECEIPT # 96024 S W R NUMBER 609
 CHECK ENCLOSURES See PRELIMINARY DATA BASE ENTRY See
 ACKNOWLEDGEMENT LETTER See ENTER ON STREAM INDEX _____
 CHECK QUADRANGLE MAP _____ CHECK GLO PLATS _____
 WATERMASTER CHECKLIST _____ PUBLIC NOTICE PUBLICATION _____

FORM REVIEW

- _____ blanks filled in
- _____ signed
- _____ date received stamped

\$400 = SWR-609
\$400 = SWR-610

Total = 800

MAP REVIEW

- source and trib
- diversion point location
- conveyances (pipes, ditch, etc.)
- place of use
- scale
- township, range, section
- north arrow
- CWRE stamp
- disclaimer
- date survey was performed
- P.O.B. of survey
- dimensions and capacity of diversion system
- "beneficial use" type title
- "permanent-quality" paper

WATER RIGHT RECORD CHECK _____ FIELD INSPECTION _____

FINAL FILE REVIEW _____ FINAL DATA BASE ENTRY _____

ENTER ON PLAT CARDS _____

August 26, 1993

CHARLIE H & SHARON K WATERMAN
ROUTE 1 BOX 1518B
BANDON OR 97411

Dear MR & MRS WATERMAN,

This will acknowledge that your Surface Water Registration Statement in the name of CHARLIE H & SHARON K WATERMAN has been received by our office. The fees in the amount of \$800 have been received and our receipt #96024 was sent in the past. Your registration statement has been numbered **SWR-609**.

Our office will review your form and map in the near future. If necessary we will schedule a meeting with you that will include a site inspection. If there are problems with your form we are usually able to take care of them during our visit. We will be able to answer any questions you might have about the adjudication process at that time.

Please feel free to contact this office if you have any questions.

Sincerely,



Don Knauer
Adjudication Specialist

Enclosure

J:\WP51\SWR\CLAIMANT\6\SWR-0609.002



C & S WATERMAN
Oregon

April 27, 1993

WATER
RESOURCES
DEPARTMENT

CHARLIE H & SHARON K WATERMAN
ROUTE 1 BOX 1518B
BANDON OR 97411

Dear Mr & Mrs Waterman,

I am returning the surface water registration statements and supporting documentation you sent to the Water Resources Department. You have included claims to beneficial use of water with various priority dates on the same claim forms. I am sending the instructions for filling out the forms and have highlighted #3 which reads, "You may list more than one beneficial use if all the uses started on the same date before 1909 (have the same priority date) and are on contiguous property." I am also sending a supply of claim forms.

On your attachments you have identified various homesteads. You will need to give the legal description on the attachment. You will also need to have those homesteads identified on your supporting maps by the Certified Water Right Examiner (CWRE). I have also included one of our map checklists and claim to beneficial use data sheets for your CWRE. The maps must be revised to show the required data.

Enclosed you will find receipt #96024 covering \$800.00 in fees.

If you have any questions, please give me a call.

Sincerely,

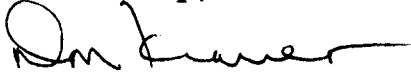
Don Knauer
Adjudication Specialist

J:\W\S\C\6\SWR-0609.001
WATERMAN-C&S



3850 Portland Rd NE
Salem, OR 97310
(503) 378-3739
FAX (503) 378-8130

JAN 05 1993

WATER RESOURCES DEPT.
SALEM, OREGON

**STATE OF OREGON
WATER RESOURCES DEPARTMENT**

**SURFACE WATER REGISTRATION STATEMENT
PRE-1909 VESTED WATER RIGHT CLAIM**

1. Name of Registrant: Charlie H & Sharon K. Waterman
Mailing Address: Route 1 Box 1518B
Bandon, Oregon Telephone No: 347-3453

2. Source of water: See Attachment
Tributary to: See Attachment

3. Purpose(s) for which water is used: See Attachment
(Irrigation, Stockwater, Domestic, Hydroelectric power, Industrial, Etc.)
If irrigation, total number of acres irrigated: _____

4. Priority Date
a) Date of first use: See Attachment
b) Date water use development first initiated: See Attachment
c) Name of party who initiated development: See Attachment

5. Amount of water claimed: See Attachment, in CFS of GPM
(Water put to beneficial use)

6. Location of place of use: See Attachment
_____ Sections, Township _____ N/S, Range _____ E/W.
_____ Sections, Township _____ N/S, Range _____ E/W.
(Attach additional pages if necessary)

7. Usual period of use: Jan ___ / 1 ___ to Dec ___ / 31 ___
month day month day

ATTACHMENT FOR SURFACE WATER REGISTRATION STATEMENT

Charlie H. and Sharon K. Waterman

Page 1: R. Davis Homestead

RECEIVED

JAN 05 1003

WATER RESOURCES DIVISION
SALEM, OREGON

Question

2. Source of water:	Reservoir	Davis Creek & Ram Creek	Spring
Tributary to:	Davis Creek		Davis Ck
3. Purpose:	Livestock & Domestic (including garden and lawn)	Livestock	Livestock
4. Priority Date:			
a. First Use:	13Jan08	13Jan08	13Jan08
b. First Initiated:	13Jan08	13Jan08	13Jan08
c. Name of Party:	-----Rollie Davis-----		
5. Amount Claimed:	5 gpm	3 gpm	1 gpm
6. Locations:	Section 7 & 18, Township30S, Range 14W-		

ATTACHMENT FOR SURFACE WATER REGISTRATION STATEMENT

Charlie H. and Sharon K. Waterman

Page 3: Gerber Homestead

Question

2. Source of water:	Spring	Unnamed Stream
Tributary to:	FourMile Ck.	FourMile Creek
3. Purpose:	Livestock	Livestock
4. Priority Date:		
a. First Use:	1908	1908
b. First Initiated:	1908	1908
c. Name of Party:	-----John H. Gerber-----	
5. Amount Claimed:	1 gpm	1 gpm
6. Locations:	Sections 7,8,17,18, Township 30S, Range 14W	

RECEIVED

JAN 05 1983

WATER RESOURCES DEPT
SALEM, OREGON

T. 30 S., R. 14 W. Sec. 7, 8, 17+18

Map for a pre-1909 Surface Water Registration
 Scale: 1" = 1320ft. Survey date: Dec. 2, 1992

This map is not the result of a property survey
 and is not to be used as such.

For: Charlie H. Waterman.

Note: All coordinates shown on this map were measured
 from A. Photo No. O-86-ACBC 4-6-78 (BLM 12)

All creeks shown are tributary to New River to the Pac. Ocean.

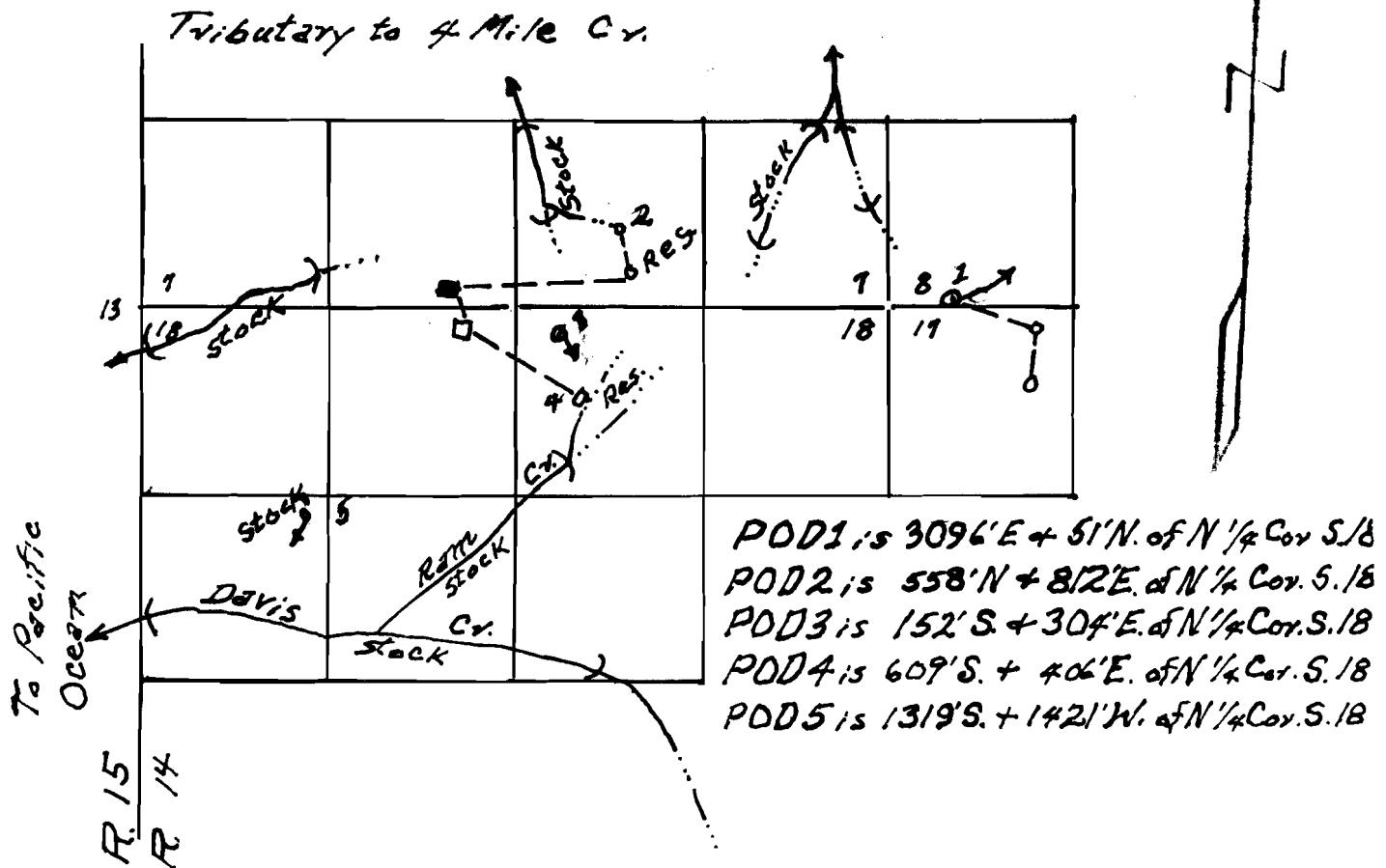
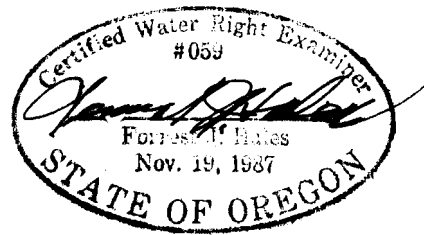

RECEIPT # **96024**STATE OF OREGON
WATER RESOURCES DEPARTMENT3850 PORTLAND ROAD NE
SALEM, OR 97310
378-8455/378-8130 (FAX)RECEIVED FROM: Charlie Walman

BY:

APPLICATION

PERMIT

TRANSFER

CASH:

CHECK: #

96-455

OTHER: (IDENTIFY)

TOTAL REC'D

\$ 800.00**01-00-0 WRD MISC CASH ACCT**

842.010 ADJUDICATIONS

\$ 800.00

831.087 PUBLICATIONS/MAPS

\$

830.650 PARKING FEES Name/month

\$

OTHER: (IDENTIFY)

\$

REDUCTION OF EXPENSE

CASH ACCT.

\$

COST CENTER AND OBJECT CLASS

VOUCHER #

03-00-0 WRD OPERATING ACCT**MISCELLANEOUS:**

840.001 COPY FEES

\$

850.200 RESEARCH FEES

\$

880.109 MISC REVENUE: (IDENTIFY)

\$

520.000 OTHER (P-6): (IDENTIFY)

\$

WATER RIGHTS:

842.001 SURFACE WATER

EXAM FEE

\$

842.002

RECORD FEE

\$

842.003 GROUND WATER

\$

842.004

\$

842.005 TRANSFER

\$

842.006

\$

WELL CONSTRUCTION**EXAM FEE**

842.022 WELL DRILL CONSTRUCTOR

\$

842.023

LICENSE FEE

\$

842.016 WELL DRILL OPERATOR

\$

842.019

\$

LANDOWNER'S PERMIT

842.024

\$

06-00-0 WELL CONST START FEE

842.013 WELL CONST START FEE

\$

CARD #

MONITORING WELLS

\$

CARD #

45-00-0 LOTTERY PROCEEDS

864.000 LOTTERY PROCEEDS

\$

07-00-0 HYDRO ACTIVITY

LIC NUMBER

842.011 POWER LICENSE FEE(FW/WRD)

\$

842.115 HYDRO LICENSE FEE(FW/WRD)

\$

HYDRO APPLICATION

\$

RECEIPT #

96024DATED: 1/6/93BY: C. Engel

Distribution—White Copy-Customer, Yellow Copy-Fiscal, Blue Copy-File, Buff Copy-Fiscal