

**CLAIM OF  
BENEFICIAL USE  
for Transfers  
Place of Use Only**



**Oregon Water Resources Department**  
725 Summer Street NE, Suite A  
Salem, Oregon 97301-1266  
(503) 986-0900  
[www.oregon.gov/OWRD](http://www.oregon.gov/OWRD)

**A fee of \$345 must accompany this form for transfers where the application was submitted on July 9, 1987, or later.**

**Enter the date the transfer application was submitted:**

**10/11/2012**

**A separate form shall be completed for each transfer.**

This form is subject to revision. **Begin each new claim** by checking for a new version of this form at:  
<https://www.oregon.gov/OWRD/Forms/Pages/default.aspx>

The completion of this form is required by OAR 690-014-0100(1) and 690-014-0110(4).

Please type or print in dark ink. If this form is found to contain errors or omissions, it may be returned to you. **Every item must have a response.** If any requested information does not apply to the claim, insert "NA." **Do not delete or alter any section of this form unless directed by the form.** The Department may require the submittal of additional information from any water user or authorized agent.

"Section 7" of this form is intended to aid in the completion of this form and should not be submitted.

A claim of beneficial use includes both this report and a map. If the map is being mailed separately from this form, please include a note with this form indicating such.

If you have questions regarding the completion of this form, please call 503-986-0900.

The Department has a program that allows it to enter into a voluntary agreement with an applicant for expedited services. Applicants interested in an estimate of the cost and timeline for expedited processing must submit a Reimbursement Authority Estimate Application and required fee. The form and additional information on this program see:  
<https://www.oregon.gov/OWRD/programs/WaterRights/RA/Pages/default.aspx>

**SECTION 1**

**GENERAL INFORMATION**

**Type of Authorized Change**

This Claim is being submitted for a transfer where the only authorized change was a change in place of use.

**YES**

*If additional changes were authorized, you will need to select a different form.*

**1. File Information**

APPLICATION #  
**T-11480**

**Received**  
**APR 27 2026**  
**OWRD**

2. Property Owner (current owner information)

APPLICANT/BUSINESS NAME <b>21581 SW Scholls LLC; Attn: Cameron Anderson</b>		PHONE NO. <b>503-221-4590</b>	ADDITIONAL CONTACT NO.
ADDRESS <b>7128 SW Gonzaga Street, Suite 100</b>			
CITY <b>Portland</b>	STATE <b>OR</b>	ZIP <b>97223</b>	E-MAIL <b>cam@blacktailstudio.com</b>

If the current property owner is not the transfer holder of record, it is recommended that an assignment be filed with the Department. ***Each transfer holder of record must sign this form.***

3. Transfer holder of record (this may, or may not, be the current property owner)

TRANSFER HOLDER OF RECORD <b>21581 SW Scholls LLC; Attn: Cameron Anderson</b>		
ADDRESS <b>7128 SW Gonzaga Street, Suite 100</b>		
CITY <b>Portland</b>	STATE <b>OR</b>	ZIP <b>97223</b>

TRANSFER HOLDER OF RECORD <b>Roger Berryhill Nursery</b>		
ADDRESS <b>21400 SW Scholls-Sherwood Road</b>		
CITY <b>Sherwood</b>	STATE <b>OR</b>	ZIP <b>97140</b>

4. Date of Site Inspection:

<b>1/26/2026</b>
------------------

5. Person(s) interviewed and description of their association with the project:

NAME	DATE	ASSOCIATION WITH THE PROJECT
<b>Diane Berryhill</b>	<b>2/5/2014</b>	<b>Roger Berryhill Nursery</b>
<b>Julie Vachon</b>	<b>1/26/2026</b>	<b>Former property owner of tax lot 2S2140000715</b>
<b>Cameron Anderson</b>	<b>1/26/2026</b>	<b>Current property owner of tax lot 2S2140000715</b>

6. County:

<b>Washington</b>
-------------------

**Received**  
**APR 27 2026**  
**OWRD**

7. If any property described in the place of use of the transfer final order is excluded from this report, identify the owner of record for that property (ORS 537.230(5)):

OWNER OF RECORD <b>Tax Lot 2S2230000304</b> <b>Berryhill Nursery LLC</b>		
ADDRESS <b>21400 SW Scholls-Sherwood Road</b>		
CITY <b>Sherwood</b>	STATE <b>OR</b>	ZIP <b>97140</b>

Add additional tables for owners of record as needed

OWNER OF RECORD <b>Tax Lot 2S2140001400</b> <b>Brian A. and Elizabeth M. Upton</b>		
ADDRESS <b>17988 SW Belton Road</b>		
CITY <b>Sherwood</b>	STATE <b>OR</b>	ZIP <b>97140</b>

Add additional tables for owners of record as needed

Received  
APR 27 2026  
OWRD

SECTION 2  
 SIGNATURES

CWRE Statement, Seal and Signature

The facts contained in this Claim of Beneficial Use are true and correct to the best of my knowledge.



CWRE NAME <b>Theodore R. Ressler</b>		PHONE NO. <b>503-967-7050 x204</b>	ADDITIONAL CONTACT NO.	
ADDRESS <b>Summit Water Resources, LLC; 4784 SE 17<sup>th</sup> Avenue, Suite 111</b>				
CITY <b>Portland</b>	STATE <b>OR</b>	ZIP <b>97202</b>	E-MAIL <b>tressler@summitwr.com</b>	

Transfer Holder(s) of Record Signature or Acknowledgement

**Each** transfer holder of record must sign this form in the space provided below.

The facts contained in this Claim of Beneficial Use are true and correct to the best of my knowledge. I request that the Department issue a water right certificate.

SIGNATURE	PRINT OR TYPE NAME	TITLE	DATE
	Cameron Anderson	owner	3-1-26

**SECTION 3**  
**EXTENT OF CHANGE COMPLETED**

**1. Claim Summary:**

If Irrigation or Nursery Use:

THE # OF ACRES ALLOWED	THE # OF ACRES DEVELOPED
<b>13.9</b>	<b>7.63</b>

If the use(s) was not irrigation or nursery:

WAS THE NEW PLACE OF USE DEVELOPED TO THE FULL EXTENT AUTHORIZED UNDER THE ORDER? (INCLUDE THE LOCATION OF THE DEVELOPED PLACE USE ON THE CLAIM MAP)
<b>NO</b>

**2. Variations:**

Was the use developed differently from what was authorized by the transfer final order? **YES**

If yes, describe below.

(e.g. "The order authorized a change in place of use for 40 acres. The water user only developed 38 acres.")

**Place of use. Only the 7.63-acre portion of the place of use located on tax lot 2S2140000715 (portion held by 21581 SW Scholls LLC) is included in this COBU.**

**Received**  
**APR 27 2026**  
**OWRD**

**SECTION 4  
CONDITIONS**

All conditions contained in the transfer, or any extension final order shall be addressed. Reports that do not address all performance related conditions will be returned.

**1. Time Limits:**

Describe how the water user has complied with each of the development timelines established in the transfer final order and any extensions of time issued for the transfer:

	DATE FROM TRANSFER	DATE THE AUTHORIZED CHANGE WAS COMPLETED *THIS DATE MUST FALL BETWEEN THE "ISSUANCE DATE" AND THE "COMPLETENESS DATE"
ISSUANCE DATE	<b>3/29/2013</b>	
COMPLETENESS DATE FROM ORDER (C)	<b>10/1/2017</b>	<b>Irrigation season of 2014 (See Attachment 3)</b>

\* MUST BE WITHIN PERIOD BETWEEN TRANSFER FINAL ORDER, OR ANY EXTENSION FINAL ORDER ISSUANCE AND THE DATE TO COMPLETE THE CHANGE

**2. Is there an extension final order(s)?**

**NO**

If "NO", you may delete the following table.

If for a transfer extension order, provide the following information:

VOLUME	PAGE	DATE EXTENDED TO

**3. Measurement Conditions:**

a. Does the transfer final order require the installation of a meter or approved measuring device?

**Received**  
**APR 27 2026** **YES**

If "NO", items b through f relating to this section may be deleted.

**OWRD**

**Reminder: If a meter or approved measuring device was required, the COBU map must indicate the location of the device in relation to the point of diversion or appropriation.**

b. Has a meter been installed?

**YES**

c. Meter Information

POD/POA NAME OR #	MANUFACTURER	SERIAL #	CONDITION (WORKING OR NOT)	CURRENT METER READING	DATE INSTALLED
<b>POD 1</b>	<b>Hersey</b>	<b>Not Available</b>	<b>Working when installed; needs to be replaced</b>	<b>0 (when installed)</b>	<b>Fall 2013</b>

If a meter has been installed, items d through f relating to this section may be deleted.

**4. Other conditions required by the transfer final order:**

a. Other conditions?

**NO**

If "YES" to any of the above, identify the condition and describe the water user's actions to comply with the condition(s):

--

**SECTION 5**  
**ATTACHMENTS**

Provide a list of any additional documents you are attaching to this report:

ATTACHMENT NAME	DESCRIPTION
<b>Attachment 1</b>	<b>Maps</b>
<b>Attachment 2</b>	<b>Water Right Information</b>
<b>Attachment 3</b>	<b>Supporting Documentation of Beneficial Use</b>

Received  
APR 27 2026  
OWRD

## SECTION 6 CLAIM OF BENEFICIAL USE MAP

For the purpose of this Claim, the map must identify the developed new place of use. The existing point(s) of diversion or point(s) of appropriation are required to be included on the Claim map, based on the locations described in the transfer final order.

In order to properly examine your claim, the Department must have an accurate map that meets the criteria described in OAR 690-014-0170 and OAR 690-305-0010, which are provided below for your convenience:

### **OAR 690-014-0170 Minimum Requirements for Maps for Permit or Transfer Final Order Claims of Beneficial Use**

- (1) Maps submitted by a CWRE as part of the Claim of Beneficial Use shall meet the standards
- (2) in OAR chapter 690, division 305. In addition, the map shall meet the following criteria:
  - (a) Horizontal accuracy is required only to ten feet for the purpose of locating and quantifying water rights. Maps shall be developed from any standard survey method. Traverse closures are not required.
  - (b) Maps shall clearly designate the place of use and point of diversion or appropriation for each source and use.
  - (c) The map shall indicate by description, in relation to the point of diversion or appropriation, the location of any fish screens, by-pass devices, and measuring devices required by the permit or transfer final order.
  - (d) The following statement shall be placed on the map: "This map is not intended to provide legal dimensions or locations of property ownership lines."
- (3) A CWRE may make a written request to the Director for a waiver of one or more mapping
- (4) standards. The Director will determine whether the waiver shall be allowed and will respond to such requests in writing.

### **OAR 690-305-0010 General Map Criteria**

Each map submitted to the Department shall meet the following general criteria in addition to any specific criteria identified in the rules for the relevant water right transaction:

- (1) Drawing
  - (a) The map shall be drafted on paper or polyester film with ink or otherwise printed in an indelible form with sufficient clarity so as to be easily reproduced or scanned. Maps may be submitted electronically in portable document format (pdf) and must be prepared consistent with, and include the same information as, a paper map.
  - (b) The preferred paper size is 8.5 inches by 11 inches and should be no larger than 30 inches by 30 inches. A map greater than 30 inches by 30 inches may be submitted if the Department grants, by mail or electronic means, advance approval of the larger size.
  - (c) Beginning April 1, 2029, regardless of whether the map is submitted electronically, on paper, or on polyester film, for any map that OAR chapter 690 requires be prepared by a Certified Water Right Examiner, a digital file containing the coordinate system and geospatial features of the map as specified by the Department shall be submitted in addition to the map, unless

the Department provides a waiver. The digital file shall be submitted as a shapefile or other approved format in a manner required by the Department.

- (d) A platted and recorded subdivision map, deed description survey map, or county assessor map may be submitted as the application map if all of the required information included in sections (2) and (3) of this rule is clearly shown.
  - (e) An aerial image may be provided in addition to the map to aid the Department in understanding the proposal.
  - (f) The map submitted under subsection (a) shall be the official record of the water right. An aerial image or digital file shall not be the official record of the water right.
- (2) Scale
- (a) The map shall be drawn to a standard, even-numbered scale and one-inch shall not exceed 1320 feet.
  - (b) The map scale may exceed 1320 feet per inch if the Department grants, by mail or electronic means, advance approval of the requested scale.
  - (c) Notwithstanding subsection (a) and (b), for maps identifying the location of a municipal use place of use, one-inch can exceed 1320 feet; provided that the scale is sufficient to identify the quarter-quarters involved in the place of use.
- (3) Features: Features shall be clearly identified and labeled. Unless otherwise indicated in rule, the following features must be included in each map submitted to the Department:
- (a) Mapping scale.
  - (b) North directional symbol.
  - (c) Legend.
  - (d) General location of main canals, ditches, flumes, pipelines, pumps, or other water delivery features used to transport water from the point(s) of diversion or appropriation to the place use and to include the delivery features at the place of use.
  - (e) Other topographical features such as rivers, creeks, streams, lakes, reservoirs, ponds, roads, or railroads that may be helpful to clarify and identify the location of points of diversion, wells, dams, and places of use.
  - (f) Location and flow direction of the water way if the source is surface water. If multiple water ways exist in the area of the proposed diversion and use, the map must identify the location and flow direction of the additional water ways.
  - (g) Township, range, section, quarter-quarter, and tax lot(s), donation land claims, or government lots where water will be or has been diverted, conveyed, and used. If the map is for municipal use the map:
    - (A) Must identify but does not need to label the quarter-quarters,
    - (B) Does not need to identify or label tax lots, donation land claims, or government lots.
  - (h) Location of each proposed or developed diversion point, well (point of appropriation), or dam by reference to a recognized public land survey corner. For a reservoir without a dam, the center of the reservoir shall be referenced to a recognized public land survey corner.
    - (A) The locations shall be shown by distance and bearing, or by coordinates (distance north or south and distance east or west from the corner). In

Received

APR 27 2026

OWRD

addition, they shall also include latitude and longitude as established by a global positioning system.

(B) Latitude and longitude coordinates shall be expressed as degrees-decimal with five or more digits after the decimal (e.g., 42.53764<sup>o</sup>). The datum used to establish the coordinates shall be indicated on the map. Examples of datums include NAD 83, NAD 27 and WGS84.

(i) Location of the proposed or developed place of use by township, range, section, and nearest quarter-quarter section.

(A) For irrigation or nursery use, the map shall additionally indicate the place of use in each quarter-quarter of a section by shading or hatching and indicate the number of acres in each quarter-quarter section, donation land claim, government lot, or other recognized public land survey lines.

(B) For places of use that are limited to a point, such as a stock watering tank, the location may also be identified by distance and bearing, or by coordinates (distance north or south and distance east or west from the corner). In addition, they shall include latitude and longitude as established by a global positioning system.

(C) Latitude and longitude coordinates shall be expressed as degrees-decimal with five or more digits after the decimal (e.g., 42.53764<sup>o</sup>). The datum used to establish the coordinates shall be indicated on the map. Examples of datums include NAD 83, NAD 27 and WGS84.

(D) Where more than one point of diversion or well is included, the map must clearly identify the place(s) of use served by each point of diversion or well.

(j) If for a supplemental irrigation application or claim of beneficial use, the location and water right reference number of the underlying primary right, registration or claim.

(k) Any other information the Department requests and considers necessary to evaluate the water right transaction.

Received

APR 27 2026

OWRD

Received

APR 27 2026

OWRD

## Attachment 1

### Claim of Beneficial Use Map

---

Township 2 South, Range 2 West

[https://www.blm.gov/or/landrecords/landsurvey/qPlatView1\\_2.php?path=POR&name=t020s02](https://www.blm.gov/or/landrecords/landsurvey/qPlatView1_2.php?path=POR&name=t020s02)

Ow 002.jpg&tr=002-OS002-0W

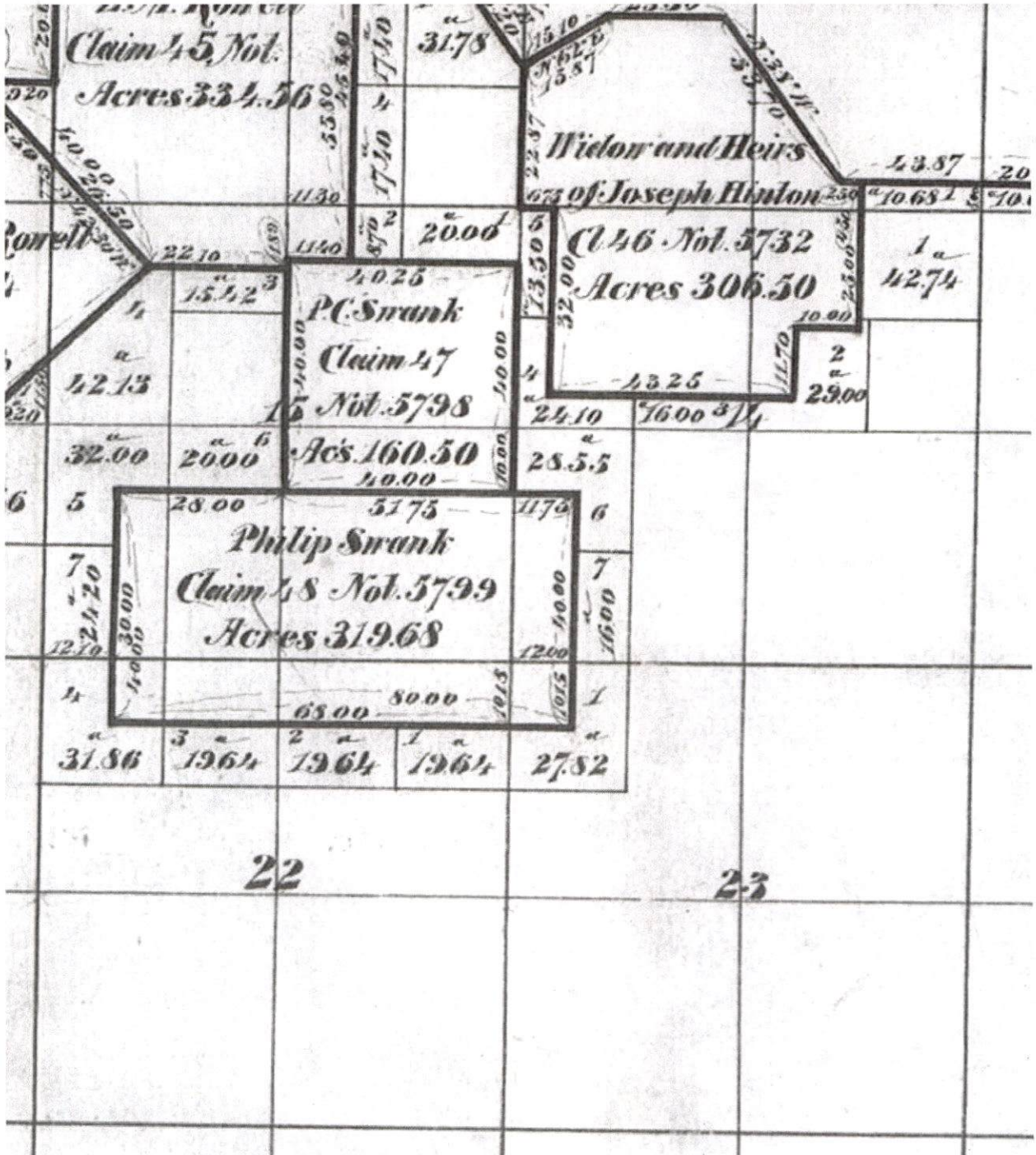

Received

APR 27 2026

OWRD

Received

APR 27 2026

OWRD

**Attachment 2**

**Water Right Information**

---



# Oregon

Tina Kotek, Governor

## Water Resources Department

North Mall Office Building  
725 Summer St NE, Suite A  
Salem, OR 97301  
Phone 503 986-0900  
Fax 503 986-0904  
[www.oregon.gov/owrd](http://www.oregon.gov/owrd)

June 3, 2025

Aubertine Law Group LLC  
7128 SW Gonzaga St. Suite 100  
Portland, OR 97223

Reference: Transfer T-11480

The partial assignment by proof from Roger Berryhill Nursery to 21581 SW Scholls LLC has been recorded in the records of the Water Resources Department.

The Departments records will now show Roger Berryhill Nursery and 21581 SW Scholls LLC as the transfer holders of record.

Our records have been changed accordingly and the original request is enclosed. Receipt number 145286 covering the recording fee is also enclosed.

A transfer is not a perfected water right and has conditions and timelines that must be satisfied prior to a Certificate of Water Right being issued. Please review the transfer to be familiar with the conditions and timelines contained in the transfer.

Sincerely,

Mary F. Bjork  
Water Rights Program Analyst  
Water Right Services Division

Enclosure: Original Request and Receipt #145286

cc: Cameron Brooks Anderson – 21581 SW Scholls Sherwood Rd, Sherwood, OR 97140  
Roger Berryhill Nursery, LLC – 21400 SW Scholls Sherwood Rd, Sherwood, OR 97140  
Data Center, OWRD (cover letter, request & map)  
File

Received  
APR 27 2026  
OWRD

# Request for Assignment By Proof of Ownership (If Water Right Holder is Not Available)



Oregon Water Resources Department  
725 Summer Street NE, Suite A  
Salem, Oregon 97301-1266  
(503) 986-0900  
[www.oregon.gov/owrd](http://www.oregon.gov/owrd)

If the Department determines that the application is incomplete, fees have not been paid, or the required documents are not acceptable, the application and all fees submitted will be returned to the applicant.

If for multiple rights, a separate form and fee for each right will be required.

I, Cameron Brooks Anderson, on behalf of and as member of 21581 SW Scholls LLC  
(Name of Party Requesting Assignment)

7128 SW Gonzaga St. Ste 100 Portland OR 97223 503-221-4590  
(Mailing Address) (City) (State) (Zip) (Phone #)

- hereby request assignment of an entire application/permit/transfer order /limited license/groundwater statement;
- hereby request assignment of a portion of application/permit/transfer order/limited license/groundwater statement;  
(You must include a map showing the portion of the application/permit/ transfer order /limited license/groundwater statement to be assigned.)

Application # T-11480 ; Permit # \_\_\_\_\_ ; Transfer Order # \_\_\_\_\_ ;

Limited License # \_\_\_\_\_ ; Groundwater Statement # \_\_\_\_\_ ;

Roger Berryhill Nursery Attn: Arda C. Berryhill  
(Name of Current Holder of Record)

21400 SW Scholls Streetwood Rd. Shedd, OR 97140  
(Mailing Address) (City) (State) (Zip) (Phone #)

Note: Write the initials (first letters) of your first and last names at the spots indicated below \_\_\_\_\_.

- 1) CB I certify that I am the current owner of the property described in this application, permit, transfer order, limited license, or groundwater statement. I have attached proof of ownership that may include but not be limited to: a copy of the deed to the land, a copy of a land sales contract, a court order or decree, documentation of survivorship of property held jointly. The Department cannot accept a copy of a tax statement.
- 2) CB I have the legal right to request assignment under OAR 690-310-0280 and 690-320-0060.
- 3) CB I have not been able to contact the owner(s) of record for the above referenced transaction. I have attached proof acceptable to the Department that notice of the assignment has been given or attempted for each identified property owner not a party to the assignment. ORS 537.220(2) Failure to submit this proof will result in the return of your request. (Proof may include but not be limited to: a copy of returned certified mailing, copy of a Death Certificate, or a court order.)
- 4) CB I further certify that the information provided herein is true and correct to the best of my knowledge.

Witness my hand this \_\_\_\_\_ day of 5/27/2025, 20\_\_\_\_\_.  
(Day) (Month) (Year)

Signature of Party Requesting Assignment CB

Failure to provide any of the required information will result in the return of your application.

Part Assigm by Proof - Approve  
MSB 6-3-2025

This certifies assignment and record change at Oregon Water Resources Department effective 8:00 a.m. on date of receipt at Salem, Oregon.  
Fee receipt # 145286  
For Director by Mary F. Bjork. Program Analyst in Water Rights Division. MBJ

The completed "Request for Assignment" form must be submitted to the Department along with the recording fee of \$120.

Received  
MAY 29 2025

OWRD  
Received  
APR 27 2026

OWRD

Application for a Water Right Transfer  
To Lands  
Certificate 72228  
Township 2 South, Range 2 West (W.M.)

Certified Water Rights Examiner Stamp  
Certified Water Rights Examiner  
#78185WRE  
*Theodore R. Ressler*  
Theodore R. Ressler  
June 29, 2007  
STATE OF OREGON  
EXPIRES: 12-31-2012

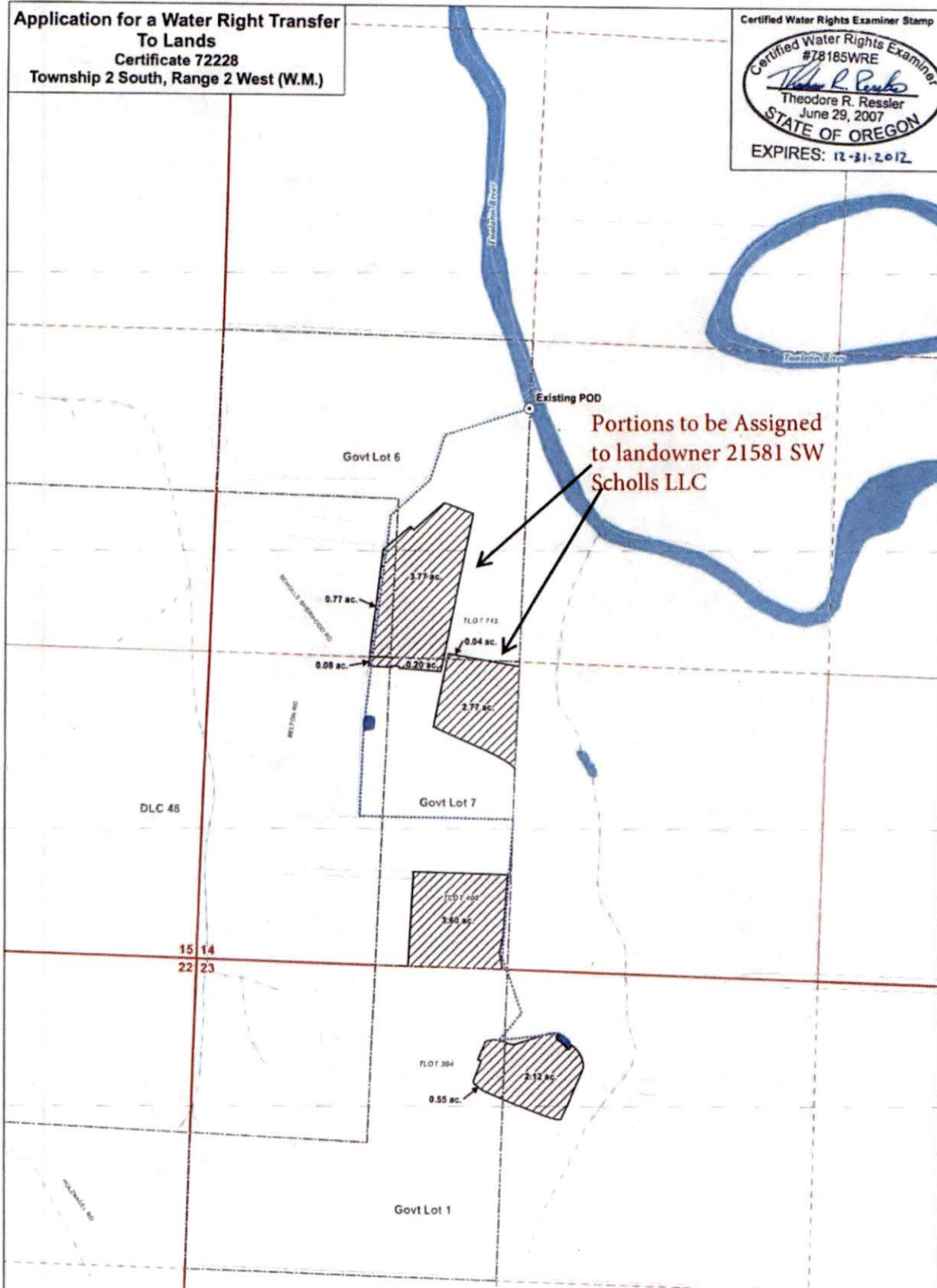

Received  
APR 27 2026

OWRD

Received  
MAY 29 2025

OWRD

**BEFORE THE WATER RESOURCES DEPARTMENT  
OF THE  
STATE OF OREGON**

In the Matter of Transfer Application            )     FINAL ORDER APPROVING A  
T-11480, Washington County                    )     CHANGE IN PLACE OF USE

**Authority**

ORS 540.505 to 540.580 establishes the process in which a water right holder may submit a request to transfer the point of diversion, place of use, or character of use authorized under an existing water right. OAR Chapter 690, Division 380 implements the statutes and provides the Department's procedures and criteria for evaluating transfer applications.

**Applicant**

ROGER BERRYHILL NURSERY  
ATTN: ARDA C. BERRYHILL  
21400 SW SCHOLLS SHERWOOD RD  
SHERWOOD, OR 97140

Received  
APR 27 2026  
OWRD

**Findings of Fact**

**Background**

1. On October 11, 2012, Roger Berryhill Nursery filed an application to change the place of use under Certificate 72228. The Department assigned the application number T-11480.
2. The applicant is also the receiving landowner, who will be responsible for completion of the changes.
3. The portion of the right to be transferred is as follows:

**Certificate:** 72228 in the name of R. E. SCHORZMAN (perfected under Permit S-14610)  
**Use:** IRRIGATION of 13.9 ACRES  
**Priority Date:** SEPTEMBER 7, 1940  
**Rate:** 0.174 CUBIC FOOT PER SECOND  
**Limit/Duty:** The amount of water used for irrigation, together with the amount secured under any other right existing for the same lands, is limited to a diversion

This final order is subject to judicial review by the Court of Appeals under ORS 183.482. Any petition for judicial review must be filed within the 60-day time period specified by ORS 183.482(1). Pursuant to ORS 536.075 and OAR 137-003-0675, you may petition for judicial review or petition the Director for reconsideration of this order. A petition for reconsideration may be granted or denied by the Director, and if no action is taken within 60 days following the date the petition was filed, the petition shall be deemed denied.

of ONE-EIGHTIETH of one cubic foot per second, or its equivalent for each acre irrigated, and shall be further limited to a diversion of not to exceed 2.5 acre-feet per acre for each acre irrigated during the irrigation season of each year.

**Source:** TUALATIN RIVER, tributary to the WILLAMETTE RIVER

**Authorized Point of Diversion:**

Twp	Rng	Mer	Sec	Q-Q	GLot
2 S	2 W	WM	14	NW SW	6

**Authorized Place of Use:**

IRRIGATION							
Twp	Rng	Mer	Sec	Q-Q	GLot	DLC	Acres
2 S	2 W	WM	14	NW SW		48	0.10
2 S	2 W	WM	14	NW SW	6		9.00
2 S	2 W	WM	14	SW SW		48	0.20
2 S	2 W	WM	14	SW SW	7		4.60

4. Certificate 72228 does not describe the location of the point of diversion by measurements from a section corner, however information is available from the transfer application map, indicating that the point of diversion is located nearly on the quarter-quarter line between Government Lot 6 and NE SW, as follows:

Twp	Rng	Mer	Sec	Q-Q	GLot	Measured Distances
2 S	2 W	WM	14	NW SW	6	2370 FEET NORTH AND 1325 FEET EAST FROM THE SW CORNER OF SECTION 14

5. Application T-11480 proposes to change the place of use of the right to:

IRRIGATION								
Twp	Rng	Mer	Sec	Q-Q	GLot	DLC	Tax Lot	Acres
2 S	2 W	WM	14	NW SW		48	715	0.77
2 S	2 W	WM	14	NW SW	6		715	3.81
2 S	2 W	WM	14	SW SW		48	715	0.08
2 S	2 W	WM	14	SW SW	7		715	2.97
2 S	2 W	WM	14	SW SW	7		400	3.60
2 S	2 W	WM	23	NE NW			304	2.12
2 S	2 W	WM	23	NW NW	1		304	0.55

Received  
APR 27 2026  
OWRD

6. Water Right Application G-17472 (filed June 17, 2011, proposing irrigation from groundwater) covers 2.5 of the acres to which T-11480 proposes to move the right evidenced by Certificate 72228. The applicant proposes to cancel Application G-17472 upon issuance of a Final Order approving T-11480, instead of diminishing Application G-17472 to supplemental irrigation.
7. Notice of the application for transfer was published on October 16, 2012, pursuant to OAR 690-380-4000. No comments were filed in response to the notice.

8. On December 19, 2012, the Department sent a copy of the draft Preliminary Determination proposing to approve Transfer Application T-11480 to the applicant. The draft Preliminary Determination cover letter set forth a deadline of January 19, 2013, for the applicant to respond. The applicant requested that the Department proceed with issuance of a Preliminary Determination and provided the necessary information to demonstrate that the applicant is authorized to pursue the transfer.
9. On February 14, 2013, the Department issued a Preliminary Determination proposing to approve Transfer Application T-11480 and sent a copy to the applicant. Additionally, notice of the Preliminary Determination for the transfer application was published on the Department's weekly notice on February 19, 2013, pursuant to ORS 540.520 and OAR 690-380-4020. No protests were filed in response to the notice.

***Transfer Review Criteria [OAR 690-380-4010(2)]***

10. Water has been used within the last five years according to the terms and conditions of the right. There is no information in the record that would demonstrate that the right is subject to forfeiture under ORS 540.610.
11. A pump, pipeline, and sprinkler system sufficient to use the full amount of water allowed under the existing right were present within the five-year period prior to submittal of Transfer Application T-11480.
12. The proposed change would not result in enlargement of the right.
13. The proposed change would not result in injury to other water rights.

Received

APR 27 2026

OWRD

**Conclusions of Law**

The change in place of use proposed in Transfer Application T-11480 is consistent with the requirements of ORS 540.505 to 540.580 and OAR 690-380-5000.

**Now, therefore, it is ORDERED:**

1. The change in place of use proposed in application T-11480 approved.
2. The right to the use of the water is restricted to beneficial use at the place of use described, and is subject to all other conditions and limitations contained in Certificate 72228 and any related decree.
3. Water right certificate 72228 is cancelled. A new certificate will be issued describing that portion of the right not affected by this transfer.
4. Water use measurement conditions:
  - a. **Before water use may begin** under this order, the water user shall install a totalizing flow meter, or, with prior approval of the Director, another suitable measuring device, at the point of diversion.

- b. The water user shall maintain the meter or measuring device in good working order.
- c. The water user shall allow the Watermaster access to the meter or measuring device; provided however, where the meter or measuring device is located within a private structure, the Watermaster shall request access upon reasonable notice.
5. The former place of use of the transferred portion of the right shall no longer receive water under the right.
6. Full beneficial use of the water shall be made, consistent with the terms of this order, on or before **October 1, 2017**. A Claim of Beneficial Use prepared by a Certified Water Right Examiner shall be submitted by the applicant to the Department within one year after the deadline for completion of the change and full beneficial use of the water.
7. After satisfactory proof of beneficial use is received, a new certificate confirming the right transferred will be issued.

Dated at Salem, Oregon this 29<sup>th</sup> day of March, 2013.

*E. Timothy Wall for*

Dwight French, Water Right Services Administrator, for  
PHILLIP C. WARD, DIRECTOR

Mailing date: APR 03 2013

Received  
APR 27 2026  
OWRD

Received  
APR 27 2026  
OWRD

**Attachment 3**  
**Supporting Documentation of Beneficial Use**

---







# Claim of Beneficial Use

## Transfer T-11480

A Water Right held by 21581 SW Schools LLC  
Washington County



### LEGEND

-  Point of Diversion (POD)
-  Place of Use (POU)
-  Mainlines\_T11480
-  Bulges
-  Perennial Watercourse
-  Intermittent Watercourse

### POD Location Description

**POD 1**  
Located 2,370 feet North and 1,325 feet East from the SW corner of Section 14, Township 2 South, Range 2 West, W.M. (45.39604702, -122.90384608, WSG84)

**Aerial Photo Date: 4/17/2014**  
**Source: GoogleEarth**

Received  
APR 27 2026  
OWRD

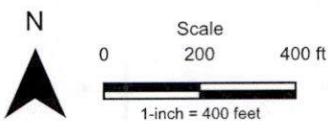

Date: 4/22/2026  
Data Sources: BLM, OWRD, USGS, Washington County.  
Project CRS: EPSG 2269 - NAD83 / Oregon North (ft)  
Disclaimer: This map is not intended to provide legal dimensions or property ownership lines.



**Ressler, Ted**

---

**From:** Arda Berryhill <arda.berryhill@frontier.com>  
**Sent:** Wednesday, February 5, 2014 8:35 AM  
**To:** Ted Ressler  
**Cc:** diane berryhill  
**Subject:** water rights certificate

*Hi Ted,  
Happy New Year to you as well, and thank you for the follow up email.*

*We bought the metering device from Consolidated Supply last fall, and had it installed with the pump in the river.  
The pipe/pump/meter is out of the river for the winter, but we will reinstall it in April, probably.*

*Would we move forward with the certificate at that point?*

*Diane Berryhill  
Berryhill Nursery  
503-628-1293 office  
503-628-3950 fax  
dianeberryhill@frontier.com*

Received  
APR 27 2026  
OWRD



**Consolidated  
Supply Co.**

**QUESTIONS ON THIS INVOICE  
503-620-7050**

**\*\* INVOICE \*\***

INVOICE DATE      INVOICE NUMBER  
07/18/13      S6475245.001  
REMIT TO:      PAGE NO.  
PO BOX 5788  
PORTLAND, OR 97228      1

BILL TO:  
BERRYHILL NURSERY  
21400 SW SCHOLLS SHERWOOD RD  
SHERWOOD, OR 97140

SHIP TO:  
BERRYHILL NURSERY  
21400 SW SCHOLLS SHERWOOD RD  
SHERWOOD, OR 97140

CUSTOMER NUMBER	CUSTOMER ORDER NUMBER	ORDERED BY	WHSE	SALESMAN		
5173			1	HOWTIG	Prc Br: 1	
WRITER	SHIP VIA		DATE SHIPPED	ORDER DATE		
RUNSTU	WC13 WC 1:30 PM		07/18/13	06/13/13	Shp Br: 1	
	DESCRIPTION	QTY ORD	QTY SHIP	U/M	NET UNIT PRICE	NET AMOUNT
	HISTORY CONVERSION PRODUCT	1ea	1ea	ea	606.250ea	606.25
** This is a special order item **						
**Tagged Item**						

Prior Deposit on 08/07/13 - Payment # C2089721.001      -606.25

**Received**  
**APR 27 2026**  
**OWRD**

\*\* Reprint \*\* Reprint \*\* Reprint \*\* Reprint \*\*

Subtotal	0.00
Freight	0.00
Tax	0.00
Amount	
Due	0.00

Invoice is due by 08/31/13.

Received  
APR 27 2026

OWRD

**Attachment 4**  
**Documentation of Signatory Authority**

---

# Business Registry Business Name Search

[New Search](#)

## Business Entity Data

Registry Nbr	Entity Type	Entity Status	Jurisdiction	Registry Date	Next Renewal Date	Renewal Due?
2146909-92	DLLC	ACT	OREGON	07-14-2023	07-14-2026	
<b>Entity Name</b>	21581 SW SCHOLLS LLC					
<b>Foreign Name</b>						

[New Search](#)

## Associated Names

Type	PPB PRINCIPAL PLACE OF BUSINESS					
<b>Addr 1</b>	7128 SW GONZAGA ST STE 100					
<b>Addr 2</b>						
<b>CSZ</b>	PORTLAND	OR	97223	<b>Country</b>	UNITED STATES OF AMERICA	

Please click [here](#) for general information about registered agents and service of process.

Type	AGT REGISTERED AGENT			Start Date	Resign Date
<b>Of Record</b>	<a href="#">890727-98</a> AUBERTINE LAW GROUP, PC				
<b>Addr 1</b>	7128 SW GONZAGA ST STE 100				
<b>Addr 2</b>					
<b>CSZ</b>	PORTLAND	OR	97223	<b>Country</b>	UNITED STATES OF AMERICA

Type	MAL MAILING ADDRESS					
<b>Addr 1</b>	7128 SW GONZAGA ST STE 100					
<b>Addr 2</b>						
<b>CSZ</b>	PORTLAND	OR	97223	<b>Country</b>	UNITED STATES OF AMERICA	

Type	MEM MEMBER				Resign Date
<b>Name</b>	CAM	ANDERSON			
<b>Addr 1</b>	21581 SW SCHOLLS SHERWOOD RD				
<b>Addr 2</b>					
<b>CSZ</b>	SHERWOOD	OR	97140	<b>Country</b>	UNITED STATES OF AMERICA

[New Search](#)



## Name History





Business Entity Name	Name Type	Name Status	Start Date	End Date
21581 SW SCHOLLS LLC	EN	CUR	03-27-2025	
19000 SW PACIFIC HWY LLC	EN	PRE	07-14-2023	03-27-2025

Please [read](#) before ordering [Copies](#).

[New Search](#)

## Summary History

Image Available	Action	Transaction Date	Effective Date	Status	Name/Agent Change	Dissolved By
	AMNDMT TO ANNUAL RPT/INFO STATEMENT	01-13-2026		FI		
	AMNDMT TO ANNUAL RPT/INFO STATEMENT	12-23-2025		FI		
	AMENDED ANNUAL REPORT	07-08-2025		FI		

	AMNDMT TO ANNUAL RPT/INFO STATEMENT	04-09-2025		FI		
	ARTICLES OF AMENDMENT	03-27-2025		FI	Name	
	AMENDED ANNUAL REPORT	08-19-2024		FI		
	ARTICLES OF ORGANIZATION	07-14-2023		FI	Agent	

© 2026 Oregon Secretary of State. All Rights Reserved.

Received  
APR 27 2026  
OWRD



April 22, 2026

Ms. Kerry Kavanagh  
Reimbursement Authority  
Oregon Water Resources Department  
725 Summer Street NE, Suite A  
Salem, Oregon 97301-1271

**Subject:** Claim of Beneficial Use for Transfer T-11480 and Request for Reimbursement Authority Processing

Ms. Kavanagh:

On behalf of the permit holder, please find enclosed a Claim of Beneficial Use (COBU) report for Transfer T-11480. The permit holder would like to use Reimbursement Authority processing for the COBU and Reimbursement Authority Estimate Application is enclosed. Please also find enclosed as check in the amount of \$740 for payment of the \$345 filing for the COBU and \$125 for payment of the Reimbursement Authority Estimate fee.

If you have any questions regarding this submittal, please call me at 503-967-7050 x204. Thank you for your assistance and I look forward to hearing from you soon.

Respectfully submitted,

Theodore Ressler, RG, CWRE  
Summit Water Resources LLC

Cc: Cam Anderson – 21581 SW Scholls LLC

Enclosures:

Claim of Beneficial Use for Transfer T-11480  
Certificate Reimbursement Authority Estimate Application for Transfer T-11480  
Check #149 in the amount of \$470

Received  
APR 27 2026  
OWRD