

KEVIN BATES
11020 NORTH APPLGATE RD
GRANTS PASS, OR 9727

CLAIM OF BENEFICIAL USE
APPLICATION NO. S-87911
PERMIT NO. S-54865

SITUATED IN
SECTION 26, TOWNSHIP 37S,
RANGE 5W, W.M.
JOSEPHINE COUNTY, OREGON

LEGEND

● BATES POD, METER, FISH
SCREEN
1040' NORTH AND 120' EAST OF
SOUTHWEST CORNER
SECTION 26
43.32028, -123.26833 WGS84

□ PLACE OF USE
SW SW- 1.25 ACS

--- PIPELINES

NORTHSIDE DITCH POD
RE-DIVERSION OF APPLGATE
LAKE RELEASE
750' N 750' E FROM
SW CORNER SECTION 6
T38S R4W
42.289770 -123.22710 WGS84

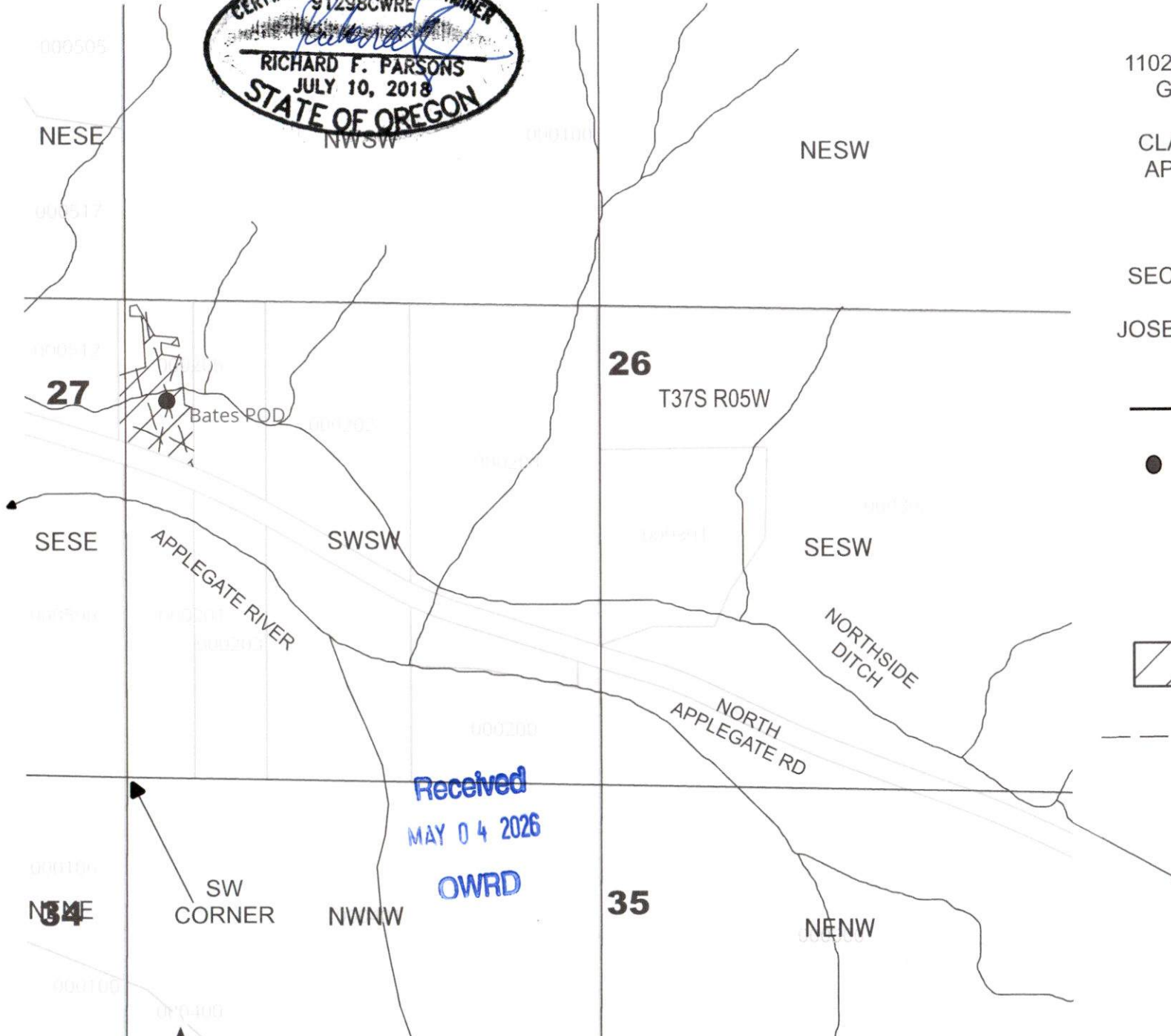

Received
MAY 04 2026
OWRD



This map is not intended to provide
legal dimensions or locations of
property ownership lines

ParsonsWater Consulting LLC
rick.parsons@parsonwater.com
541.499.0257 303.667.5067