

May 5, 1997

W WAYNE & DORIS M HANSEN  
90107 GREENWOOD DR  
LEABURG OR 97489

RE: File SWR-631

Dear Mr. & Mrs. Hansen,

This is in reply to your inquiry regarding your pre-1909 water right claim, SWR-631.

As we discussed today in our office, although your claim will not constitute a perfected water right until adjudicated, your claim **does** allow you and your property's future owners the right to legally continue using water for the purpose described in your claim, irrigation of 3/4 acre garden & yard irrigation. The Watermaster will not regulate for or against your use until the adjudication occurs.

If you have further questions regarding your claim and adjudicated water rights, please contact Reed Marbut, Adjudication Specialist, at 503-378-8455, extension 292.

Sincerely,



Mr. Cory C. Engel  
Water Rights Processing Technician



Commerce Building  
158 12th Street NE  
Salem, OR 97310-0210  
(503) 378-3739  
FAX (503) 378-8130

# IMPORTANT MESSAGE

FOR MON. DATE 4-7 TIME 3:20 AM. ~~P.M.~~

M MRS WAYNE HANSON

OF \_\_\_\_\_

PHONED

PHONE

FAX  
 MOBILE

541-896-3450

RETURNED  
YOUR CALL

MESSAGE

REG.  
SWR 631 DWIGHT

PLEASE CALL

WILL CALL  
AGAIN

CAME TO  
SEE YOU

WANTS TO  
SEE YOU

SIGNED

 FORM 4006

RECEIVED

APR 10 1997

April 8, 1997 WATER RESOURCES DEPT.  
SALEM, OREGON

Wayne & Doris Hansen  
90107 Greenwood Dr.  
Leaburg, OR 97489

Ph 541-896-3450

Water Resources Department  
158 12th Street NE  
Salem, OR 97310-0210

Since the message phone system has not been successful I am writing to ask you if you please could send us a simple letter or memo stating we indeed do have on file water rights for account #SWR 631.

Some time in 1995 we were assured by phone that "yes" we had been granted rights but we would like some kind of documentation.

Thank you for your cooperation and a timely response.

Sincerely,

*Doris Hansen*

Wayne & Doris Hansen  
90107 Greenwood Dr.  
Leaburg, OR 97489

#SWR 631

W. Wayne Hansen  
90107 Greenwood Dr.  
Leaburg, OR. 97489-9604



974 P&DF EUGENE, OR 04/08/97 19:54

WATER RESOURCES DEPARTMENT

158 12th Street NE

Salem, OR 97310-0210

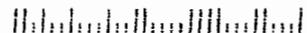

**RECEIVED**

**NOV 15 1994**

WATER RESOURCES DEPT.  
SALEM, OREGON

Nov.. 14, 1994

OREGON WATER RESOURCES DEPT.  
3850 Portland Rd. N.E.  
Salem, OR 97310

RE: Wayne & Doris Hansen Claim # SWR-631

Dear Mr. French,

As per our phone conversation during the summer of 1994, you suggested we pursue obtaining additional proof of water useage prior to 1909.

Enclosed is the revised proof of the J. Cogswell homestead of which our property was a part. This information was taken from "JOSEPH KOCK'S MAP OF LANE CO." Made in 1892-1893. This information is on file in the Map & Aerial Photo Library at the University of Oregon.

Please send a confirmation that we indeed do have water rights granted to us for our personal file.

Sincerely,



Wayne Hansen  
90107 Greenwood Dr.  
Leaburg, OR 97489

Phone: (503) 896-3450

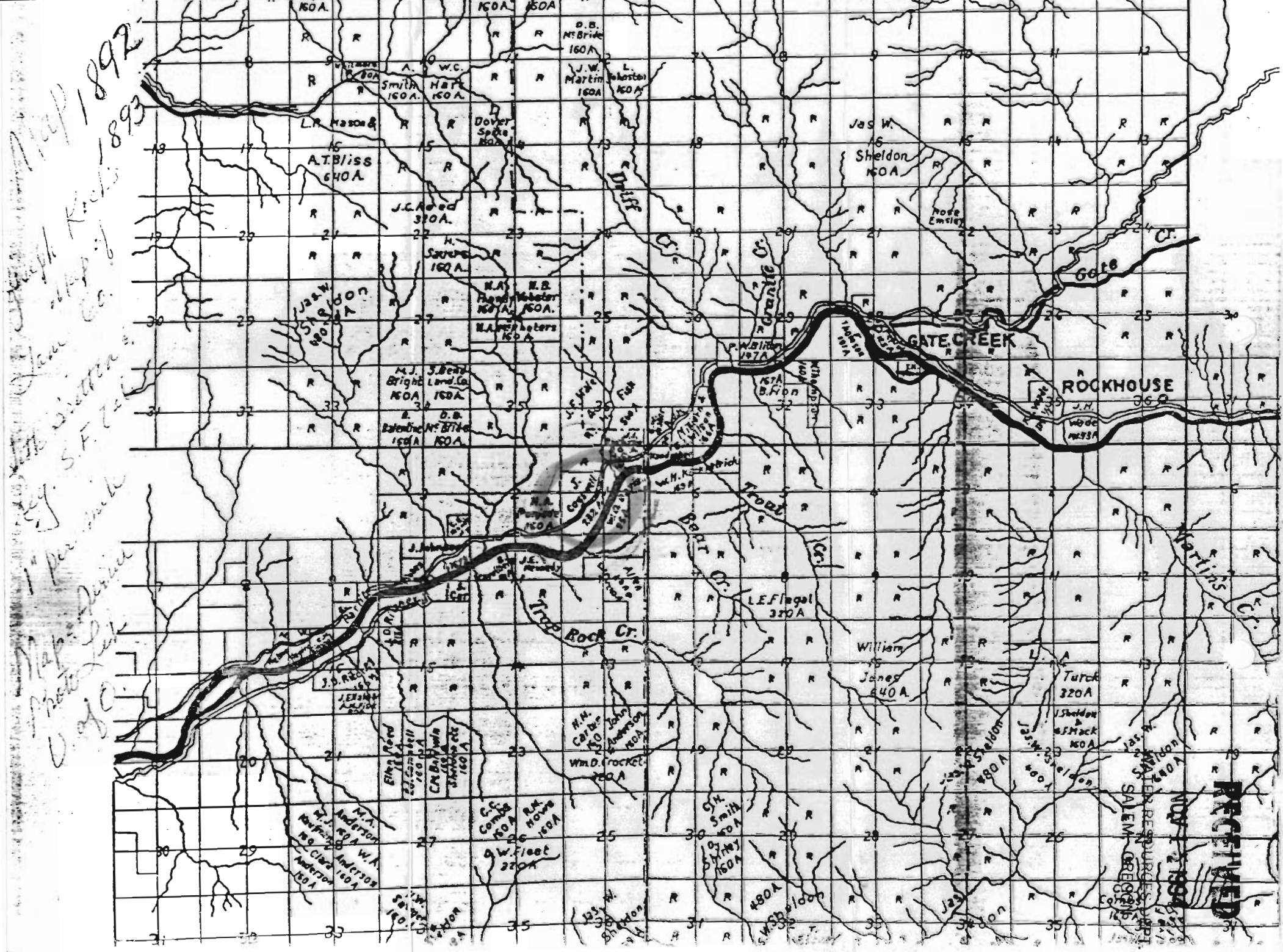

Map of the District of Salem, Oregon  
1892  
1" per inch  
S.F. Zeller

RECEIVED  
NOV 1 1892  
U.S. GEOLOGICAL SURVEY  
S.A. GREEN

JAN 18 1994

WATER RESOURCES DEPT.  
SALEM, OREGON

**STATE OF OREGON  
WATER RESOURCES DEPARTMENT**

**SURFACE WATER REGISTRATION STATEMENT  
PRE-1909 VESTED WATER RIGHT CLAIM**

1. Name of Registrant: W. WAYNE & DORIS M. HANSEN  
Mailing Address: 70107 GREENWOOD DR  
LEABERG CR 71481 Telephone No: 896-3450

2. Source of water: EWEB POWER CANAL  
Tributary to: McKENZIE RIVER

3. Purpose(s) for which water is used: IRRIGATION - GARDEN/YARD  
(Irrigation, Stockwater, Domestic, Hydroelectric power, Industrial, Etc.)  
If irrigation, total number of acres irrigated: 3/4 acre

4. Priority Date  
a) Date of first use: Prior to 1928 agreement with EWEB  
b) Date water use development first initiated: 3/12/28  
c) Name of party who initiated development: Marion Eston

5. Amount of water claimed: 20  
(Water put to beneficial use)

6. Location of place of use:  
01 Sections, Township 17 N/S, Range 15 E/W.  
\_\_\_\_ Sections, Township \_\_\_\_ N/S, Range \_\_\_\_ E/W.  
(Attach additional pages if necessary)

7. Usual period of use: MAY 1 1 to OCT 1 15  
month day month day

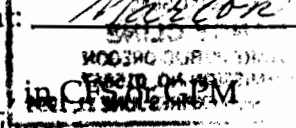





# FORD ■ NESS ■ FASSBENDER

LAND SURVEYING ■ CONSTRUCTION SUPERVISION ■ WATER RIGHTS EXAMINATIONS

1120 Bailey Hill Road, No. 1 Eugene, Oregon 97402-3048 (503) 344-1852 FAX (503) 344-9923

May 9, 1994

Oregon Water Resources Department  
Commerce Building  
158 12th Street NE  
Salem, Or 97310

RE: SWR-629,630 & 631

Mr. Don Knauer,

In response to your letters dated April 12, 1994. This one letter will address the questions you have on all three of the SWR's noted above. I will also enclose two copies of this letter for your records on the other two SWR's.

The pipe size from the diversion point to the end of the delivery system is a 6" diameter plastic pipe. The diversion point system is a valve at the toe of the slope of the Eugene Water and Electric Board (EWEB), canal. When the canal was built Cogswell creek was the source of water for those properties these water rights are addressing. The canal construction diverted Cogswell creek into the canal. EWEB installed a valve system to divert water from the canal to the properties formerly using Cogswell creek for their supply of water. The Valve size is a 10" diameter valve and pipe from the canal leading into said 6" diameter pipe leading to said properties.

If you have any questions feel free to inquire.

Respectfully,



H. Timothy Fassbender, PLS, CWRE  
1120 Bailey Hill Rd #1  
Eugene, Or 97402

April 2, 1994

**RECEIVED**

**APR - 4 1994**

**WATER RESOURCES DEPT.  
SALEM, OREGON**

Oregon Water Resources Dept.  
3850 Portland Rd NE  
Salem, OR 97310

RE: Alvie & Beverly Yarbrough Claim # SWR-629  
Don Carnes & Paula Madaglia SWR-630  
Wayne & Doris Hansen SWR-631

Dear Mr. Knauer,

The enclosures are the final papers needed to complete the application for Water Rights for the three families on a common line. You already are in possession of our original forms and documentation.

The remaining papers needed were the map prepared by a Certified Water Examiner and the depositions showing water use pre-1909.

Sincerely submitted,

*W. Wayne Hansen*

Alvie E. Yarbrough  
90074 Greenwood Dr.  
Leaburg, OR 97437

Don J. Carnes & Paula Madaglia  
90108 Greenwood Dr.  
Leaburg, OR 97437

W. Wayne Hansen & Doris Hansen  
90107 Greenwood Dr.  
Leaburg, OR 97437

March 4, 1994

The below information was taken from a 1 hour 45 minute afternoon visit with George and Eva Easton at their home in Leaburg, on Feb. 28, 1994.

George has an incredible mind and great wit. He has kept a daily diary since 1915 to 1972 which was shown to us.

Signed,

*Lris M. Hansen*

I, George Easton of Leaburg, having been born in 1897 in the Walterville area and living my entire life in the surrounding area. I remember the John Cogswells farm starting at Greenwood Cemetery going east to the Curry Stagecoach Stop. Cogswell Creek ran thru the property with an open gravity-flow ditch to divert the water for irrigation. This would have been during years 1905-1908

Mr. Cogswell later sold that property to J.W. Elston.

Signed,

*George M. Easton*

*George W. Elston*  
-----  
Witness

**RECEIVED**

**APR - 4 1994**

**WATER RESOURCES DEPT.  
SALEM, OREGON**

RECEIVED

APR - 4 1994

WATER RESOURCES DEPT.  
SALEM, OREGON

32653

Ida D. Ward, being first duly sworn on oath, says that she is and has been practically all of her life a resident of Leaburg, Lane County, State of Oregon, with the exception of a short period of time subsequent to the year 1909, that she is familiar with lands located in the South-west Quarter of Section 1, Township 17 South, Range 1 East, W. M., that she is familiar with the lands formerly owned by J. W. and Rachel Alice Elston, husband and wife, part of which lands are now owned by C. L. and Nellie L. Kelly, husband and wife, and also lands now being purchased by Otis J. and Alice Fisher, husband and wife, and Trueman R. and Juliet Fisher, husband and wife, that she is and has been practically all of her life familiar with the flow of water in Cogswell Creek, and that lands now owned by C. L. and Nellie L. Kelly, husband and wife, and also lands now being purchased by Otis J. and Alice Fisher, husband and wife, and Trueman R. and Juliet Fisher, husband and wife, on land contract were irrigated by water from the aforesaid Cogswell Creek and that said water was used for irrigation purposes on said lands prior to the year A. D. 1909.

Ida D. Ward

Subscribed and sworn to before me this 7 day  
June, 1937.

L. V. Johnson  
Notary Public for Oregon

My commission expires March 6, 1941.

82662

*These affidavits are very  
very important. You can not  
obtain new ones as the old  
people have passed away.*

Annie Craft, first being duly sworn on oath says that she is a resident of Leaburg, Lane County, State of Oregon, and has been a resident of said county and state since the year 1908, that she is familiar with land located in the S. W. 1/4 of Section 1, Township 17 South, Range 1 East, W. M., and particularly with that portion of said quarter section formerly owned by J. W. and Rachel Alice Elston, Husband and wife, which lies in a generally Southern position from the Eugene Water Board canal.

The Affiant further says that she has during all of this period of time resided in the neighborhood above described and is familiar with the flow of water in Cogswell Creek, and that a portion of the water from said Cogswell Creek was used for irrigation purposes prior to the year A. D. 1909, and that a part of the land above referred to and formerly owned by J. W. and Rachel Alice Elston, husband and wife, a part of which is now owned by C. L. and Nellie L. Kelly, husband and wife, and also lands now being purchased under land contract by Otis J. and Alice Fisher, husband and wife, and Trueman R. and Juliet Fisher, husband and wife, are included in and a part of the lands irrigated by the waters of said Cogswell Creek prior to the year A. D. 1909.

**RECEIVED**

APR - 4 1994

*Annie Craft*

WATER RESOURCES DEPT. described and sworn to before me this 7<sup>th</sup> day  
SALEM, OREGON, 1937,

*H. J. [Signature]*

Notary Public for Oregon

My Commission expires March 6th, 1941

NOV - 4 1993

WATER RESOURCES DEPT.  
SALEM, OREGON

BOOK 413 PAGE 020

E A S E M E N T

THIS INDENTURE WITNESSETH:

THAT WHEREAS, WALTER W. CARTER and ELENOR M. CARTER  
are the owners of the following described property:

Beginning at a point South 40° 12' West 472.3 feet from a point 378.4 feet North of an iron pipe set for the center of Section One (1) Township 17 South Range 1 East of the Willamette Meridian, and running thence South 40° 12' West 552 feet; thence North 49° 48' West 451.2 feet to the Southerly right of way line of the Mc Kensie Highway; thence North 51° 48' East along said right of way line 563.5 feet; thence leaving the right of way line South 49° 48' East 337.9 feet to the place of beginning containing 5.00 acres more or less in Lane County, State of Oregon.

Also,

All of that part of the West 1/2 of Section 1, Township 17 South, Range 1 East of Willamette Meridian, Lane County Oregon, which lies North of the right of way of the Mc Kensie State Highway and South of the right of way of the City of Eugene Power Canal, containing 6.02 acres of land.

THAT WHEREAS, W. E. MILLS and RUTH MILLS, his wife,  
are the owners of a tract of land described as follows:

Beginning at an iron pipe which is center of Section 1, Township 17 South Range 1 East of Willamette Meridian, thence North 378.4 feet to iron pipe, thence South 40° 12' West 777.3 feet to iron pipe, thence S. 49° 48' East 923 feet to iron pipe, thence N. 24° 08' East 310.7 feet, to iron pipe, thence N. 25° 32' East 233.3 feet to iron pipe, thence North 50° 50' West 188.8 feet to iron pipe, thence South 59° 20' West 40 feet to iron pipe, thence North 50° 50' West 345.8 feet to iron pipe, place of beginning, Lane County, Oregon.

THAT WHEREAS, HOWARD M. LEE and CARRIE S. LEE, his wife  
are the owners of the following described tract of land:

Beginning at an iron pipe, which pipe is 777.3 feet South 40° 12' West of a point which is 378.4 feet North of a point which is the center of Section 1, and which point is marked by an iron pipe, and a Stone, in Township 17 South Range 1 East of the Willamette Meridian, in Lane County, Oregon, running thence South 49° 48' East 923.0 feet to an iron pipe, thence South 24° 08' West 133.0 feet to an iron pipe, thence North 49° 48' West 178 feet to an iron pipe, in the center of the County Road, thence along the center line of the County road, South 40° 12' West 126 feet to an iron pipe, thence North 49° 48' West 778.8 feet to an iron pipe, thence North 40° 12' East 247 feet to the place of beginning in Lane County, Oregon.

RECEIVED

NOV - 4 1993

WATER RESOURCES DEPT.  
SALEM, OREGON

BOOK 415

THAT WHEREAS, all of the above described tracts of land were once owned by MARY and MARION ELSTON, and the said Elstons entered into an agreement with the City of Eugene, which agreement is dated the 12th of March, 1928, and is recorded in Volume 155, Page 609, Deed Records, Lane County, Oregon,

WHEREAS by virtue of said agreement, the City of Eugene agreed to provide water to the land of said Elstons, which land included all of the above described properties.

WHEREAS the Elstons and their mesne grantees have constructed irrigation ditches and other means of distributing this water over the several properties above described which means have varied from time to time in location and capacity,

THAT WHEREAS all the parties to this instrument recognize the right of each of the above described lands to obtain a portion of the water furnished by the City of Eugene under the above referred to agreement with MARY and MARION ELSTON,

AND WHEREAS the several parties to this agreement are now desirous of determining the location of the ditches, pipelines, irrigation boxes and other means of distribution of the water furnished by the City of Eugene to these lands.

NOW, THEREFORE, IN CONSIDERATION of the premises and of the mutual covenants and agreements hereinafter set forth, WALTER W. CARTER and ELENOR M. CARTER, his wife, give, grant, and demise to HOWARD M. LEE and CARRIE S. LEE, his wife, and to W. E. MILLS and RUTH MILLS, his wife, a right of way over, upon, and across the following described premises:

Beginning at a point South  $40^{\circ} 12'$  West 472.3 feet from a point 374.8 feet North of an iron pipe set for the center of Section One (1) Township 17 South Range 1 East of the Willamette Meridian, and running thence South  $40^{\circ} 12'$  West 552 feet; thence North  $49^{\circ} 48'$  West 451.2 feet to the Southerly right of way line of the Mc Kenzie Highway; thence North  $51^{\circ} 48'$  East along said right of way line 563.5 feet; thence leaving the right of way line South  $49^{\circ} 48'$  East 337.9 feet to the place of beginning containing 5.00 acres more or less in Lane County, State of Oregon.

RECEIVED

NOV - 4 1993

WATER RESOURCES DEPT.  
SALEM, OREGON

BOOK

413 028

Which Easement shall more particularly be described as follows:

Commencing at a point 578.4 feet North and 774.3 feet South 40° 12' West of an iron pipe marking the center of Section 1, Township 17 South, Range 1 East of the Willamette Meridian (which said beginning point is 250 feet North 40° 12' East of the Northwest corner of that tract of land Deeded to Howard M. and Carrie S. Lee November 30, 1943, and Recorded in Volume 258, Page 429, Deed Records, Lane County, Oregon), and running thence North 65° West 442 feet more or less to a culvert lying under the Mc Kenzie Highway.

The said Easement shall also extend over and across the premises described as follows:

All of that part of the West 1/2 of Section 1, Township 17 South, Range 1 East of Willamette Meridian, Lane County Oregon, which lies North of the right of way of the Mc Kenzie State Highway and South of the right of way of the City of Eugene Power Canal, containing 6.02 acres of land.

This said Easement shall be for the purpose of laying an irrigation pipe below the surface of the ground of the said premises at a depth of not less than 18 inches below said surface, and said Easement shall also include the right on the part of the grantees to enter into and upon said lands to maintain and repair said irrigation line.

The said grantees shall also have the right to construct and maintain the boxes and ditches which are necessary to supply water to said Irrigation Pipeline.

The said Easement shall be perpetual and shall run with the land of the grantees hereinabove named and to their heirs and assigns.

NOW IN CONSIDERATION of the grant of an Easement by WALTER W. and ELENOR M. CARTER, hereinabove set forth, the said grantees, W. E. MILLS and RUTH MILLS, his wife, and HOWARD M. LEE and CARRIE S. LEE, his wife, for themselves, their heirs, and assigns, hereby forever give up, release, and quit all claim to any easements, or rights of way held by them across the grantors' land previous to the date of this agreement.

AND FURTHER, IN CONSIDERATION of the mutual covenants and agreements hereinabove set forth, W. E. MILLS and RUTH MILLS, his wife, grant, demise, and convey unto HOWARD M. LEE and CARRY S. LEE,  
EASEMENT---Page 3



RECEIVED

NOV - 4 1993

WATER RESOURCES DEPT.  
SALEM, OREGON

BOOK 413 1053

his wife, their heirs and assigns, the right or easement over the Mills property to enable the Lees to obtain water from the box at the Southerly terminus of the above described irrigation pipe line.

IN WITNESS WHEREOF, we have hereunto set our hands this 22 day of March, 1950.

Walter W. Carter

Elenor M. Carter

W. E. Mills

Ruth Mills

Howard M. Lee

Carrie S. Lee

STATE OF OREGON }  
COUNTY OF LANE } ss.

Be it remembered that on this 22 day of March, 1950, personally came before me, a Notary Public in and for said county, the within named WALTER W. CARTER and ELENOR M. CARTER; W. E. MILLS and RUTH MILLS, his wife; and HOWARD M. LEE and CARRIE S. LEE, his wife, to me personally known to be the identical persons described in and who executed the within instrument, and acknowledged to me that they executed the same freely and voluntarily for the uses and purposes therein named.

Witness my hand and seal this day and year last above written.  
My Commission Expires 9-13-53

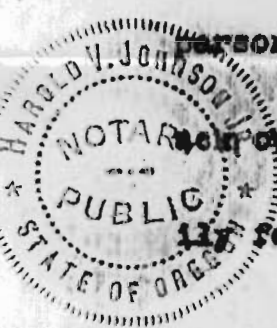

Harold V. Johnson  
Notary Public for Oregon 200

RECEIVED

NOV - 4 1993

WATER RESOURCES DEPT.  
SALEM, OREGON

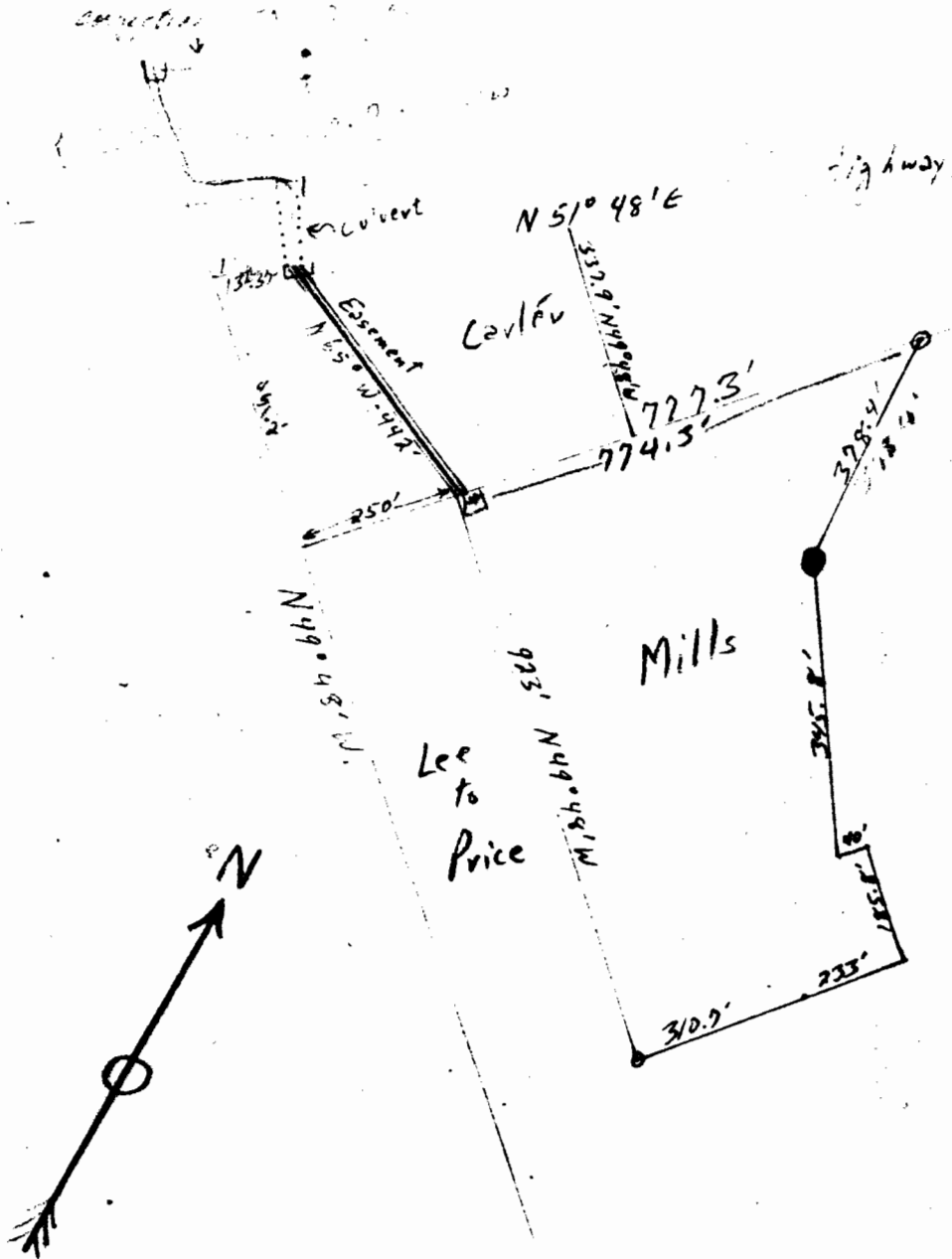

RECEIVED

NOV - 4 1993

WATER RESOURCES DEPT.  
SALEM, OREGON

# Last of Elston Property Sold At Leaburg

n  
ll  
tir  
nd  
ed

LEABURG -- The last of the property owned by the Elston family, prominent residents of this area since 1924, has been sold.

Mrs. Francis Elston has sold her home on Greenwood drive and has purchased a home at 8414 Southwest 10th St., in Portland, to be near her daughter.

The Elstons first came to the area more than 40 years ago when John William Elston purchased 282 acres, which included all the property from Greenwood cemetery on the west to the old Curry place on the upper end of Greenwood drive, extending across the highway and canal.

In 1928 he sold all land north of the highway to the Eugene Water and Electric Board. At this time, also, the new McKenzie highway was built.

The father built the house formerly owned by Mr. and Mrs. Albert Wooley, known as the Blueberry farm, now occupied by Mr. and Mrs. Charles Merrill.

He gave each of four sons 50 acres. Francis built the home now owned by Mr. and Mrs. Lester Yenne and one across the road which Mrs. Elston recently sold to William Knuth of San Francisco, who had previously purchased another tract in the area.

Marion Elston built the house formerly owned by Mr. and Mrs. W. E. Mills and then sold to the Walter T. Hansen family, who are now in Haiti, where Hansen is in government service. The house is now occupied by Robert Marquardt Sr.

Ira Elston constructed the house formerly owned by Ed Yenne on Cogswell creek and later sold to Cliff Morgan. The fourth son, Clarence, built the house on the highway now owned by Loren McPherson.

Mrs. Elston will move to her new home sometime next spring.

Pleasant Hill area residents  
turn in items for the Spring-  
News to Alice Hammitt,  
7500.



McKENZIE  
December  
Mr. an  
er, 714 N  
Mr. an  
8235 East  
girl  
December  
Mr. an  
N. 1st St.  
December  
Mr. an  
son, 1431  
a girl  
Mr. an  
penter, 1  
a girl.

SACRED  
Decemb  
Mr.  
Bridge  
girl  
Mr.  
son,  
Decem  
Mr.  
1070 S  
Mr.  
wards,

with

ability of the Seller's title, or liens or encumbrances thereof, excepting matters contained in usual printed exceptions in such title insurance policies, easements, conditions and restrictions of record and encumbrances herein specified, if any.

8. Covenants of Title. Sellers covenant that they are the owners of the within described property free of all encumbrances, except those of record on the date hereof, to-wit: An easement recorded on April 27, 1950, in Book 413 on Page 626 through 630, of Lane County Deed Records, Lane County Courthouse, Eugene, Oregon.

9. Reservation of Water Right. Sellers hereby reserve an easement for water rights for the benefit and use of the remaining land which the Sellers are not conveying to Buyer. The parties understand and agree that the terms and conditions of this reservation will be fully and completely described in a separate instrument after the survey of the within described premises has

HARRY O. GILDEA  
ATTORNEY AT LAW  
PUBLIC PROFESSIONAL BLDG.  
435 EAST PARK STREET  
EUGENE, OREGON 97401

Original Merged  
PAGE 3

**RECEIVED**

NOV - 4 1993

WATER RESOURCES DEPT.  
SALEM, OREGON

been completed and said easement can be identified correctly.

10. Delivery of Deed. Upon the execution hereof, and upon execution and delivery to the Sellers of the Note and Mortgage herein provided for, Buyer shall be entitled to a good and sufficient deed conveying the within described premises free and clear of liens and encumbrances, except as above provided. The parties agree, however, that delivery of said deed shall not occur until after the survey of the premises is completed. Promptly upon receiving from the surveyor an accurate description of said premises, Sellers agree to execute

pg 4

XERO COPY

XERO COPY

XERO COPY

XERO COPY

**RECEIVED**

**NOV - 4 1993**

**WATER RESOURCES DE  
SALEM, OREGON**

October 31, 1993

TO: Director of Water Resources Dept: Don Knauber or  
Dwight French

FROM: W. Wayne & Doris M. Hansen  
90107 Greenwood Dr.  
Leaburg, OR 97489-9604

SUBJECT: Petition for Late Claim for Surface Water Registration

The water right dispute first came into evidence during Aug. 1993 while the State Highway 126 was being widened to provide a passing lane and our water supply was shut off. Our irrigation water supply comes from the EWEB canal taken from the McKenzie River.

I (Doris) had grown up on the property since 1942, presently owned by Don Carnes & Paula Medaglia. My parents, W.E. Mills & Ruth in 1966 sold us 1.03 acres (Tax rolls: Acct #546133, 17-15-01-3-00102) and later in 1980 their home at 90107 Greenwood Dr., (Acct. #546117, 17-15-01-3-00100) with Ruth E. Mills retaining a Life Tenancy clause which she (a recognized local Historian) capably and efficiently lived out her life until April 1993. We moved into the 90107 home on Aug. 29, 1993. Never once was it ever pointed out to her that there was any need to file for water rights. Recorded in Lane County records was the fact clearly spelled out that water rights truly did exist. She had careful documentation of which are enclosed copies or excerpts from various documents.

Enclosures: LAND SALES CONTRACT <sup>JULY</sup> Sept. 7, 1965 paragraph #9  
RESERVATION OF WATER RIGHTS

EASMENT Bk 413 pg 626-630 Jan. 2, 1966 LAND SALES  
CONTRACT

Newspaper clipping

Late filing fee: \$45.00 check #3383

Respectfully submitted,

*Doris M. Hansen*  
*Dr. Wayne Hansen*

January 4, 1995

WAYNE & DORIS HANSEN  
90107 GREENWOOD DR  
LEABURG OR 97489

re: SWR-631

Dear Mr & Mrs Hansen,

This will acknowledge the receipt of the "REVISED" form and copy of map you submitted in support of the pre-1909 vested water right claim in your names. Due to personnel and duty changes the information will not be reviewed at this time. I will add it to the file for future review.

If you have any questions, please give me a call. The toll free number is 1-800-624-3199.

Sincerely,

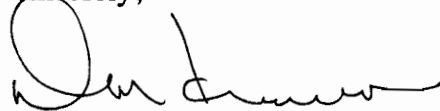

Don Knauer  
Adjudication Specialist

jwls1c161swr-0631.006



Commerce Building  
158 12th Street NE  
Salem, OR 97310-0210  
(503) 378-3739  
FAX (503) 378-8130

SURFACE WATER REGISTRATION CHECKLIST

(received after July 18, 1990)

CHECK BASIN MAP JEK NAME Willamette # \_\_\_\_\_ UNADJUDICATED AREA ? YES  
RECEIPT # 106619 S W R NUMBER 631  
CHECK ENCLOSURES JEK PRELIMINARY DATA BASE ENTRY DF  
ACKNOWLEDGEMENT LETTER JEK ENTER ON STREAM INDEX \_\_\_\_\_  
CHECK QUADRANGLE MAP \_\_\_\_\_ CHECK GLO PLATS \_\_\_\_\_  
WATERMASTER CHECKLIST \_\_\_\_\_ PUBLIC NOTICE PUBLICATION \_\_\_\_\_

**FORM REVIEW**

\_\_\_\_\_ blanks filled in  
\_\_\_\_\_ signed  
\_\_\_\_\_ date received stamped

**MAP REVIEW**

✓ source and trib  
✓ diversion point location  
✓ conveyances (pipes, ditch, etc.)  
✓ place of use  
✓ scale  
✓ township, range, section  
✓ north arrow  
✓ CWRE stamp  
✓ disclaimer  
\_\_\_\_\_ date survey was performed  
✓ P.O.B. of survey  
✓ dimensions and capacity of diversion system  
✓ "beneficial use" type title  
✓ "permanent-quality" paper  
✓ 1/10th acre

#12  
WATER RIGHT RECORD CHECK \_\_\_\_\_ FIELD INSPECTION \_\_\_\_\_  
FINAL FILE REVIEW \_\_\_\_\_ FINAL DATA BASE ENTRY \_\_\_\_\_  
ENTER ON PLAT CARDS \_\_\_\_\_

May 11, 1994

TIM FASSBENDER  
c/o STEPHEN H FORD INC  
1120 BAILEY HILL RD #1  
EUGENE OR 97402

RE: SWR-629, SWR-630, SWR-631

Dear Mr Fassbender,

This will acknowledge the receipt of the information to support the pre-1909 vested water right claims in the names of YARBROUGH, CARNES & MEDAGLIA, AND HANSEN. I have added the information to the files. Thank you for your attention to this matter. If you have any questions, please give me a call.

Sincerely,

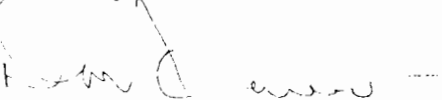

Don Knauer  
Adjudication Specialist

J:\WS\IC\6\SWR-0629.005



---

Commerce Building  
158 12th Street NE  
Salem, OR 97310-0210  
(503) 378-3739  
FAX (503) 378-8130



April 12, 1994

H. TIMOTHY FASSBENDER  
STEPHEN H FORD INC  
1120 BAILEY HILL ROAD # 1  
EUGENE OR 97402-3048

RE: File# SWR-631

DEAR H. TIMOTHY FASSBENDER,

I am not returning the map you prepared for WAYNE AND DORIS HANSEN. You can address the request in the form of a letter or report. You will find the item which requires completion or correction shown below. I have the description followed by the ORS or OAR site and paraphrased statute or rule.

conveyance	ORS 539.120 "...the location of .... and each ditch, canal, pipeline or other means of conveying the water..." The pipe size is the necessary information.
diversion point size	OAR 690-28-025-(4)-(c) "The dimensions and capacity of any existing diversion systems."

You must submit the information before the claim can be processed. If you cannot have it to the WRD within 60 days, please inform me as to when it can be expected. Please mark all correspondence with the file number.

As always, if you have any questions, please give me a call.

Sincerely,



Don Knauer  
Adjudication Specialist

Enclosures

J:\WP51\SWR\CLAIMANT\6\SWR-0631.00M



Commerce Building  
158 12th Street NE  
Salem, OR 97310-0210  
(503) 378-3739  
FAX (503) 378-8130

3-11-94

MR HANSEN CALLED  
TO SAY HE, CARNEZ  
AND YAR BROUGHT HAVE  
HIDDEN CURBS

STEPHEN H. FOERD CO  
WHO WILL START THE  
WORK IN A FEW  
WEEKS.

WEEK

February 8, 1994

Oregon

WATER  
RESOURCES  
DEPARTMENT

WAYNE & DORIS HANSEN  
90107 GREENWOOD DR  
LEABURG OR 97489

RE: SWR-631

Dear Mr & Mrs Hansen,

I am sending a copy of the order accepting your surface water registration claiming a pre-1909 vested water right. It has been filed in the records of the Water Resources Department (WRD). Your claim has been numbered SWR-631 and you should refer to that number in any correspondence.

Your claim form shows the priority date of March 12, 1928. I want to remind you that this program is to put on record water use begun prior to February 24, 1909. You should continue to think along that line. Did my water use begin before 1909 and what can I use to show that?

You have the requirement of a map prepared by a Water Right Examiner. I am sending a list of those certified by the State to do this kind of mapping. You must contract with one of the Water Right Examiners and let me know who that is as soon as possible. Nothing more can be done with your file until the required map is received by the WRD.

If you have any questions, please give me a call. The toll free number is 1-800-624-3199.

Sincerely,

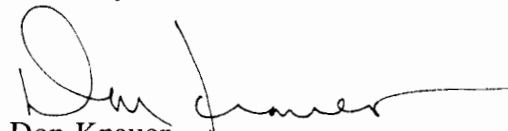

Don Knauer  
Adjudication Specialist

j:\wis\cl6\swr-631.004



3850 Portland Rd NE  
Salem, OR 97310  
(503) 378-3739  
FAX (503) 378-8130

BEFORE THE DIRECTOR OF THE  
OREGON WATER RESOURCES DEPARTMENT  
SALEM, OREGON

IN THE MATTER OF THE )  
SURFACE WATER REGISTRATION ) ORDER ACCEPTING  
STATEMENT TO BE FILED IN THE ) SURFACE WATER  
NAME W WAYNE & DORIS M HANSEN ) REGISTRATION  
) STATEMENTS  
) (Late filing)  
)

---

The above entitled matter comes before the Director for authorization to file a Surface Water Registration Statement after the filing deadline of December 31, 1992.

It appears that the claimed use of water has not been abandoned, that water has been applied to beneficial use and that the use of water by the claimant is subject to registration pursuant to ORS 539.240(4).

NOW, THEREFORE, it is hereby ORDERED that the Department accept for filing Surface Water Registration Statement in the name of

W WAYNE & DORIS M HANSEN  
90107 GREENWOOD DR  
LEABURG OR 97489

January 31, 1994.

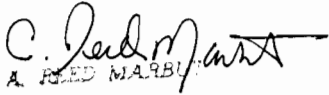
  
A. REED MARBUT  
Martha O. Pagel, Director

January 20, 1994

Oregon

---

WATER  
RESOURCES  
DEPARTMENT

---

W WAYNE & DORIS M HANSEN  
90107 GREENWOOD DR  
LEABURG OR 97489

RE: pre-1909 vested water right claim

Dear Mr & Mrs Hansen,

This will acknowledge the receipt of the completed Surface Water Registration Statement form in your name. The Director can now decide on your petition. I will let you know the outcome as soon as a decision is made.

If your petition is allowed, you will be required to submit the required map prepared by a certified water right examiner. You will be notified of the requirement.

You should keep in mind that you are claiming a pre-1909 vested water right use. It will be necessary to substantiate that claim. Any evidence you can find to show the pre-1909 use would be to your benefit.

If you have any questions, please give me a call. The toll free number in Oregon is 1-800-624-3199.

Sincerely,



Don Knauer  
Adjudication Specialist

j:\w\sc\6\hansen.01



---

3850 Portland Rd NE  
Salem, OR 97310  
(503) 378-3739  
FAX (503) 378-8130

January 5, 1994

---

WATER  
RESOURCES  
DEPARTMENT

---

W WAYNE & DORIS HANSEN  
90107 GREENWOOD DR  
LWABURG OR 97489-9604

RE: Late Surface Water Registration Statement

Dear Mr & Mrs Hansen,

I have reviewed the correspondence in your file and I find that you have not yet returned a claim form as per the letter of Dwight French sent to you on November 16, 1993. I am sending a copy of his letter. You must submit the surface water registration statement form completed and with your signature notarized. We cannot continue to process your claim until the form is received.

If you have any questions, please give me a call. The toll free number is 1-800-624-3199.

Sincerely,

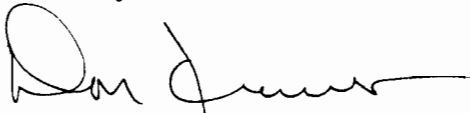

Don Knauer  
Adjudication Specialist

j:\w\slc\6\hansen.003



---

3850 Portland Rd NE  
Salem, OR 97310  
(503) 378-3739  
FAX (503) 378-8130

November 16, 1993

W WAYNE & DORIS M HANSEN  
90107 GREENWOOD DR  
LEABURG OR 97489-9604

RE: Late Surface Water Registration Statement

Dear W WAYNE & DORIS M HANSEN:

If you send in a completed Surface Water Registration (SWR) Statement we that indicates that this is a use of water that would be subject to registration under ORS 539, we will issue the required special order that allows us to accept the late filing. We will send you a copy of the order when it has been signed by the Director.

A blank SWR claim form is enclosed. Be sure to have the completed claim form notarized. Please be advised that although we will accept your claim, we will not initiate processing until we have received a map of your claimed use(s) prepared by a Certified Water Right Examiner.

Please call me if you have any questions about how to proceed. You may call toll free from within Oregon: 1 (800) 624-3199.

Sincerely,

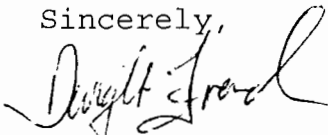

Dwight French  
Water Rights/Adjudication Division

Enclosure  
Surface Water Registration Statement claim form

J:\W\S\C\6\hansen.002



November 8, 1993

W WAYNE & DORIS M HANSEN  
90107 GREENWOOD DR  
LEABURG OR 97489-9604

RE: PETITION FOR LATE REGISTRATION STATEMENT FILING

Dear MR & MRS HANSEN

This will acknowledge your petition for a late registration statement filing, a Surface Water Registration Statement and the fees of \$45.00. Our receipt #106619 is enclosed.

I will begin to review and process your petition. I will let you know if there is anything else you need to do. If your petition is approved, the director will sign an order that allows us to file your claim. If this happens, I will send you a copy.

If you have any questions please give me a call.

Sincerely,

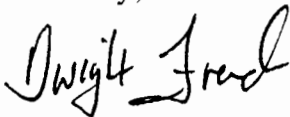

Dwight French  
Adjudication Section

enc

J:\W\S\C\6\HANSEN.1



---

3850 Portland Rd NE  
Salem, OR 97310  
(503) 378-3739  
FAX (503) 378-8130



**STATE OF OREGON**  
**WATER RESOURCES DEPARTMENT**  
 3850 PORTLAND ROAD NE  
 SALEM, OR 97310  
 378-8455/378-8130 (FAX)

RECEIPT # **106619**

RECEIVED FROM: W. Wayne Hansen  
 BY: Loris Hansen

APPLICATION	
PERMIT	
TRANSFER	

CASH:  CHECK: # 96-7449 OTHER: (IDENTIFY)

TOTAL REC'D \$ 45.00

**01-00-0 WRD MISC CASH ACCT**

842.010	ADJUDICATIONS	\$ <u>45.00</u>
831.087	PUBLICATIONS/MAPS	\$
830.650	PARKING FEES Name/month	\$
_____	OTHER: (IDENTIFY)	\$

**REDUCTION OF EXPENSE**

CASH ACCT.	\$
COST CENTER AND OBJECT CLASS	VOUCHER #

**03-00-0 WRD OPERATING ACCT**

<b>MISCELLANEOUS:</b>		
840.001	COPY FEES	\$
850.200	RESEARCH FEES	\$
880.109	MISC REVENUE: (IDENTIFY)	\$
520.000	OTHER (P-6) (IDENTIFY)	\$
<b>WATER RIGHTS:</b>		
842.001	SURFACE WATER	\$
842.003	GROUND WATER	\$
842.005	TRANSFER	\$
<b>WELL CONSTRUCTION</b>		
842.022	WELL DRILL CONSTRUCTOR	\$
_____	LANDOWNER'S PERMIT	\$
_____	OTHER (IDENTIFY)	\$

<b>EXAM FEE</b>		<b>RECORD FEE</b>
\$	842.002	\$
\$	842.004	\$
\$	842.006	\$
<b>EXAM FEE</b>		<b>LICENSE FEE</b>
\$	842.023	\$
	842.024	\$

**06-00-0 WELL CONST START FEE**

842.013	WELL CONST START FEE	\$	CARD #
_____	MONITORING WELLS	\$	CARD #

**45-00-0 LOTTERY PROCEEDS**

864.000	LOTTERY PROCEEDS	\$
---------	------------------	----

**07-00-0 HYDRO ACTIVITY**

842.011	POWER LICENSE FEE(FW/WRD)	LIC NUMBER	\$
842.115	HYDRO LICENSE FEE(FW/WRD)		\$
_____	HYDRO APPLICATION		\$

RECEIPT # **106619**

DATED: 11-4-93

BY: Loris Hansen