

SITE MAP

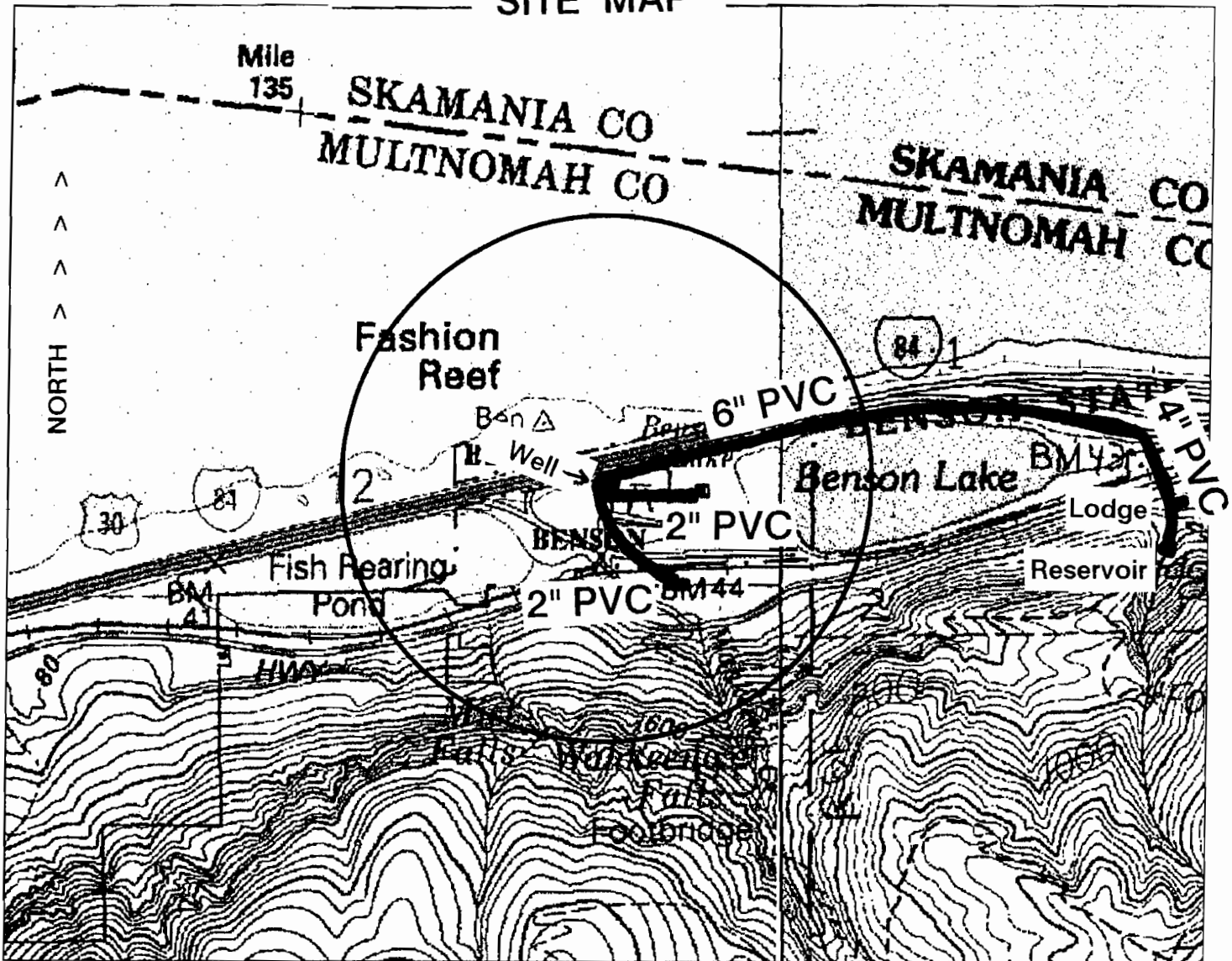

WELL T.1N., R.5E, Sec. 12 SE 1/4 SE 1/4

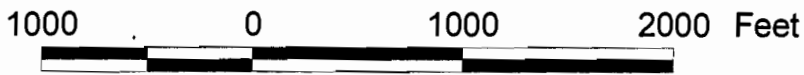

1:12,000

600' NORTH AND 1230' WEST FROM SE CORNER SEC. 12

Prepared by: K. Kelley
 Reviewed by: D. Nelson
 Date: 6/21/2000
 File #: 4192612
 Radius: 1500'

USGS Bridal Veil, OR Quadrangle
 USGS Multnomah Falls, OR Quadrangle
 (Part Section) 7.5 Series Topographic

GPS Well Data:
 45°34'40.6425
 122°7'43.8257
 GPS Elevation Data: 64.042'

RECEIVED

RECEIVED OVER THE COUNTER

MAY 02 2007

WATER RESOURCES DEPT SALEM, OREGON