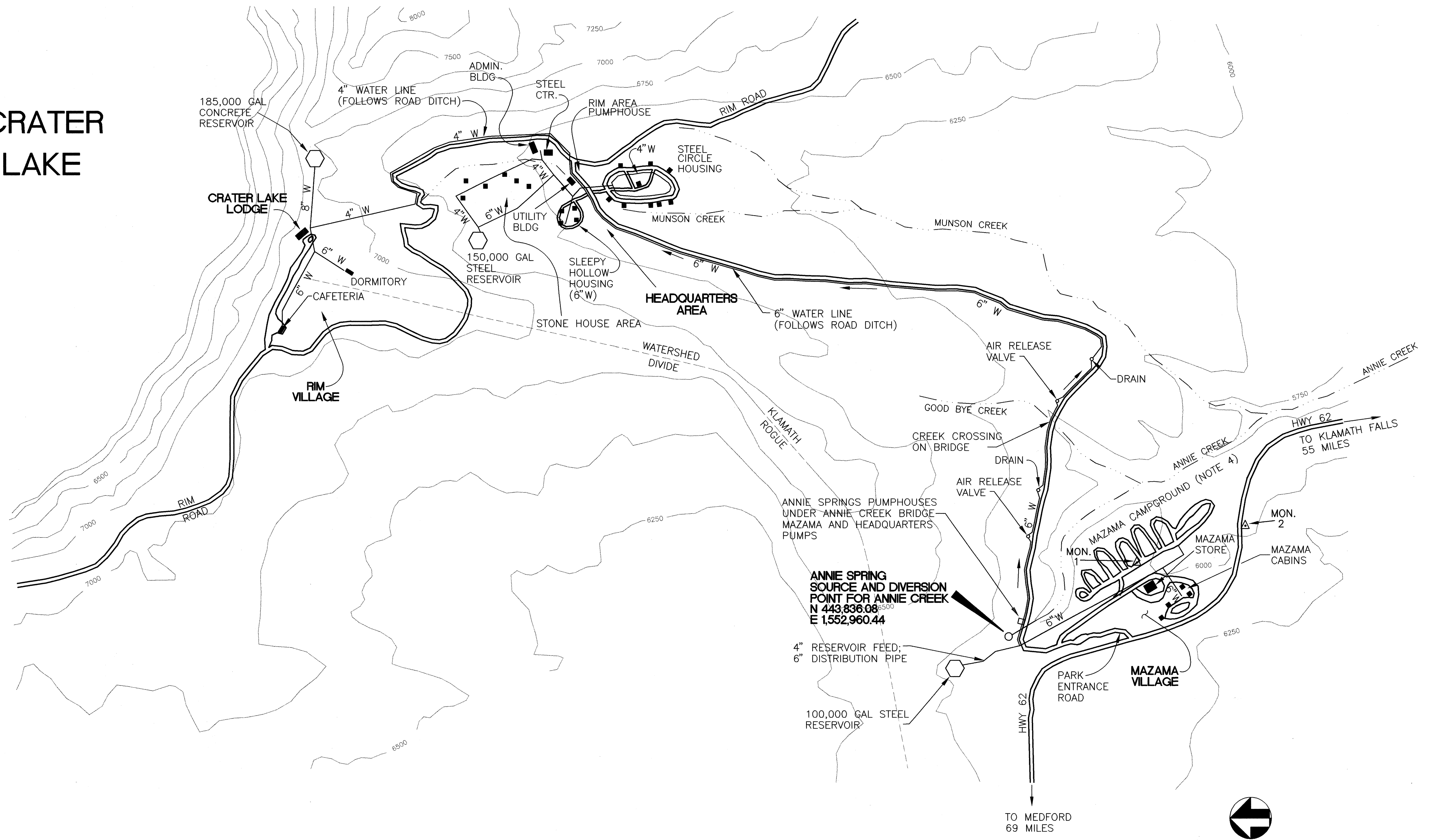

EXHIBIT A: MAP OF EXISTING USES FOR ANNIE CREEK OUT-OF-STREAM CLAIM

CRATER LAKE



- NOTE: 1) THIS MAP IS FOR THE PURPOSE OF IDENTIFYING THE LOCATION OF THE WATER USE ONLY AND IS NOT INTENDED TO PROVIDE LEGAL DIMENSIONS OR LOCATIONS OF PROPERTY OWNERSHIP LINES.
- 2) COORDINATES REFERENCED ARE OREGON STATE PLANE COORDINATES.
- 3) NO EXISTING TOWNSHIP OR RANGE FOR THIS AREA.
- 4) EACH CAMPGROUND LOOP CONTAINS A 1" OR 2" WATER SERVICE LINE.
- 5) WATER USE AREAS FOR THE SYSTEM ARE MAZAMA VILLAGE, HEADQUARTERS AREA, AND RIM VILLAGE.

CONTROL MONUMENTS				
MON #	DESCRIPTION	NORTHING	EASTING	ELEV.
1	NPS AL. CAP	441,927.65	1,553,996.63	6011.06
2	NPS BRASS CAP	439,434.71	1,555,311.70	5979.46

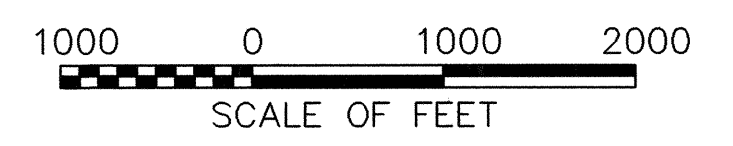

MAP PREPARED DECEMBER, 1996

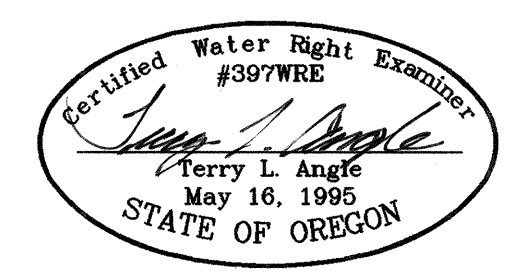

CRATER LAKE NATIONAL PARK

EXISTING USES UNDER ANNIE CREEK FEDERAL RESERVED WATER RIGHT CLAIM;
ANNIE SPRING WATER SUPPLY SYSTEM