

T. 25S., R. 31E., W. M.

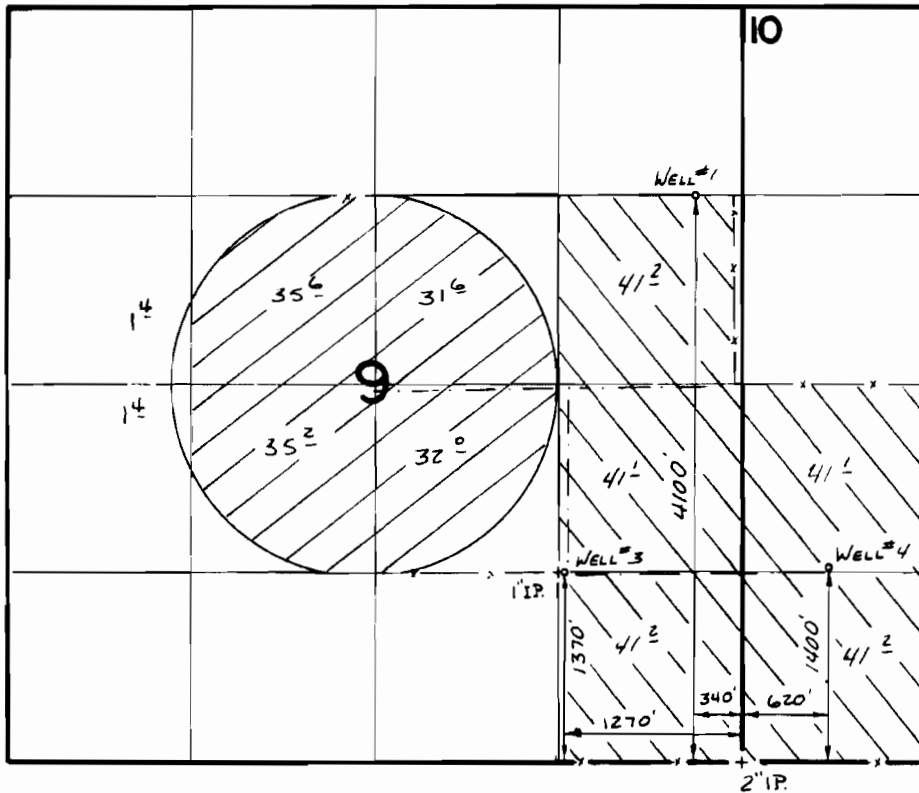

SCALE 1" = 1320'

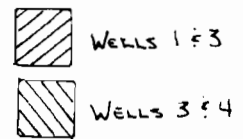

FINAL PROOF SURVEY
UNDER

Application No. ~~G:10688~~ Permit No. ~~G:9879~~
IN NAME OF

J.W. McCALLISTER & JETT C. BLACKBURN

Surveyed ...5:9..... 1988, by T.M. WARREN.....

RECEIVED

JUN 17 2008

WATER RESOURCES DEPT
SALEM, OREGON

PTS

SECTION PLAN

Section 10 & 16

Township 25-S

Range 31-E

County of Harney

State of OR

NORTH

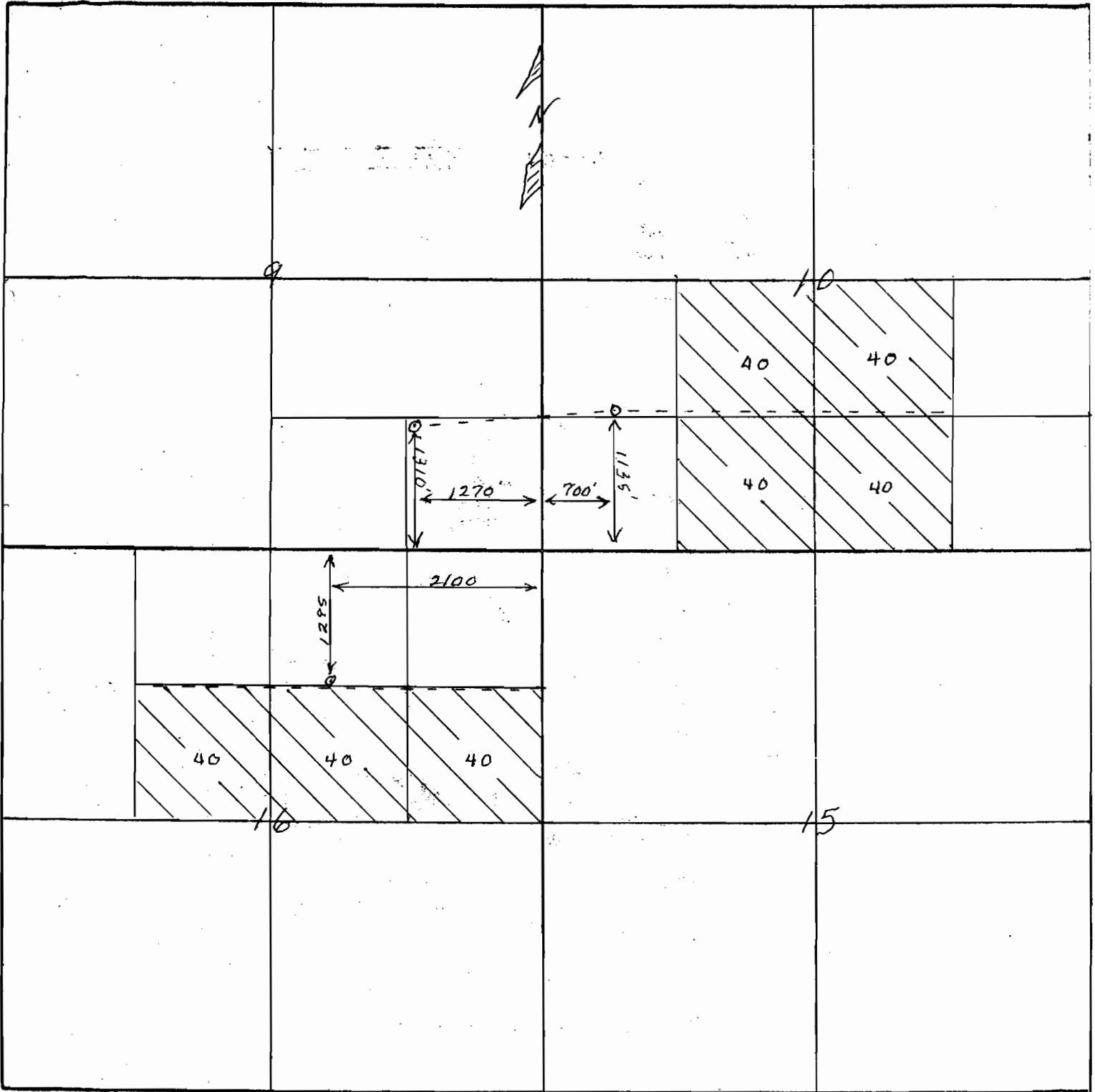

5

Remarks scale $\frac{1}{4}$ = 1 mile - 660' -

RECEIVED

JUN 17 2008

WATER RESOURCES DEPT
SALEM, OREGON