

AREA WITHIN WILLAMINA UGB NOT INCLUDED AS SERVICE AREA UNDER THIS APPLICATION

RECEIVED
 JUN 25 2008
 WATER RESOURCES DEPT
 SALEM, OREGON

This map is not intended to establish legal dimensions or locations of ownership lines.

	Grand Ronde Community Water Association PO Box 253 Grand Ronde, Oregon 97347		
	Service Area Boundary T 5 & 6 S, R 6, 7 & 8 W, WM POLK & YAMHILL COUNTIES, OREGON		
Design: JMB Drawn: JMB Chkd: CFR	Scale: 1" = 3000' Date: JUNE 25, 2008 Revised:	Job No. Sheet Boatwright Engineering, Inc. 2613 12th Street SE, SALEM, OREGON 97302 TEL: (503) 363-9225 • FAX: (503) 363-1051	1 of 1
EXPIRES 12/31/07			

T6S, R8W, WM

POLK COUNTY

RECEIVED

JUN 25 2008

WATER RESOURCES DEPT
SALEM, OREGON

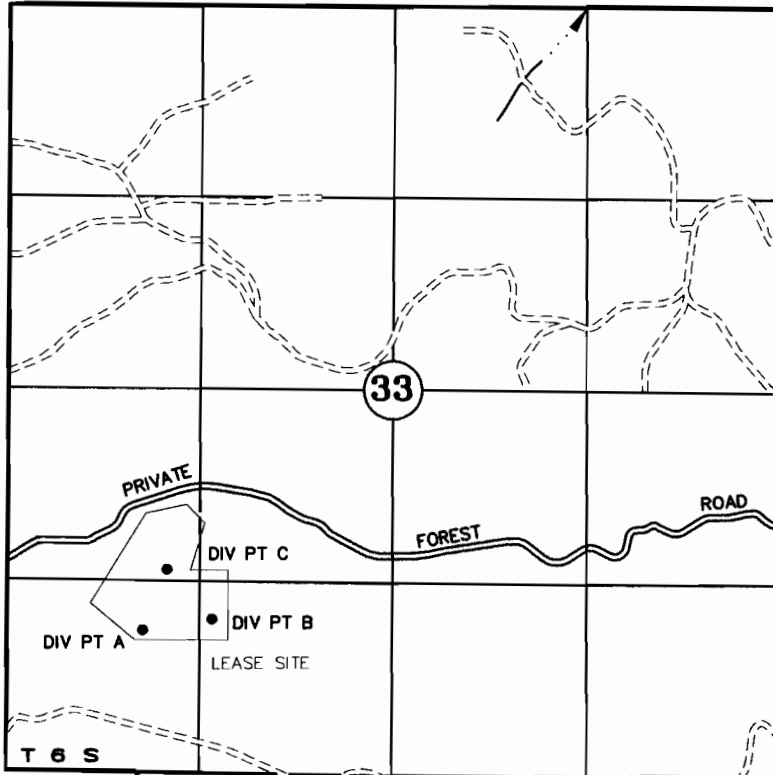

TAX LOT:
6 8W 1800

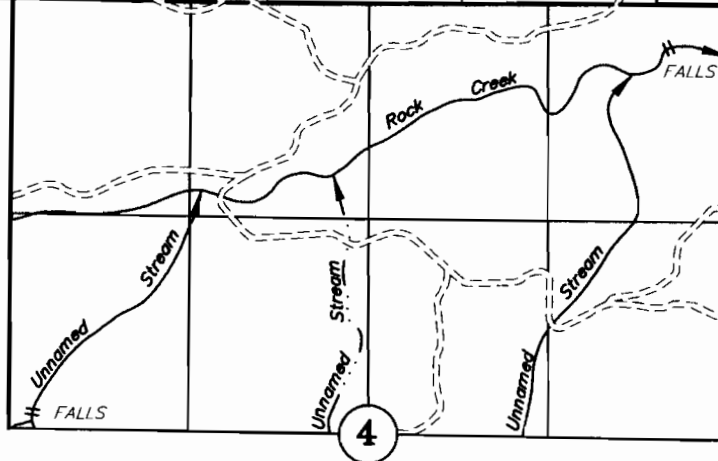

DIV PT A: 960' N & 945' E of SW Cor SEC 33
 DIV PT B: 1030' N & 1420' E of SW Cor SEC 33
 DIV PT C: 1375' N & 1115' E of SW Cor SEC 33

APPLICATION TO APPROPRIATE SURFACE WATER

UNDER

Application No. _____ Permit No. _____

IN THE NAME OF

Grand Ronde Community
Water Association

February 24, 2008

SCALE: 1" = 1320'

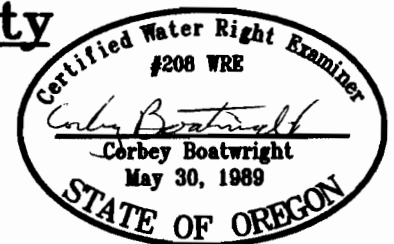

NOTE: This map is not intended to provide legal dimensions or locations of property ownership lines.

RENEWAL DATE 12-31-2009

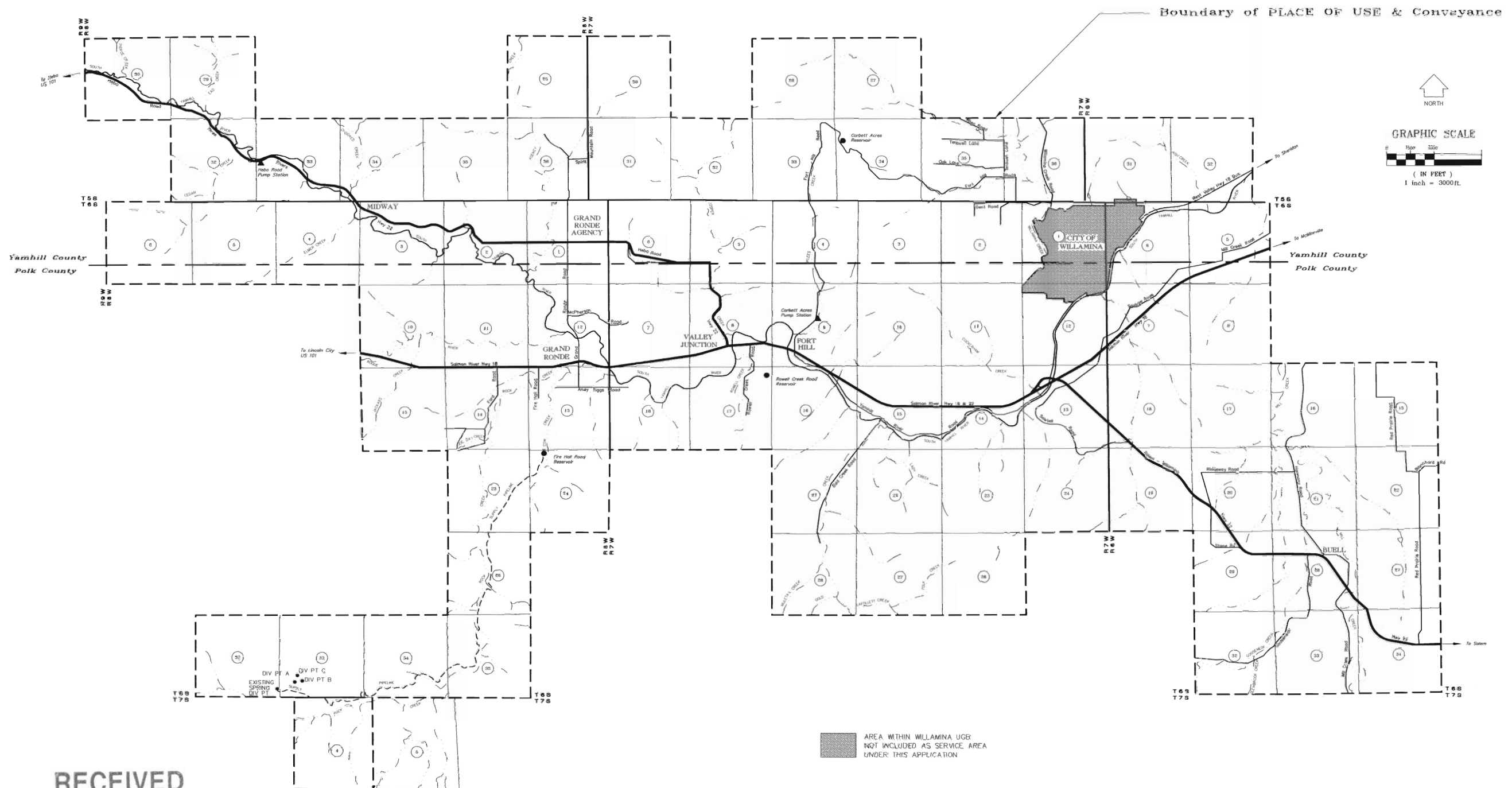

RECEIVED
 JUN 25 2008
 WATER RESOURCES DEPT
 SALEM, OREGON

REDUCTION
 Scale: 1" = 7000'

NOTE: This map is not intended to provide legal definitions or locations of property ownership lines.

	Grand Ronde Community Water Association PO Box 220, Grand Ronde, Oregon 97120			
	Service Area Boundary E.S. & S. R. 6, 7 & S.W. 1/4, POLK & YAMHILL COUNTIES, OREGON			
	Scale: 1" = 3000' Design: JMB Drawn: JMB Check: CFB	Date: JUNE 25, 2008 Revised: Boatwright Engineering, Inc. 2603 12th Street SE, SALEM, OREGON 97302 TEL: (503) 363-9225 • FAX: (503) 363-1051		Job No. _____ Sheet # _____ 1 of 1
	EXPIRES 12/31/07			