

T.4S., R.3W & R.4W, W.M.

RECEIVED

APR 23 2008
 WATER RESOURCES DEPT
 SALEM, OREGON

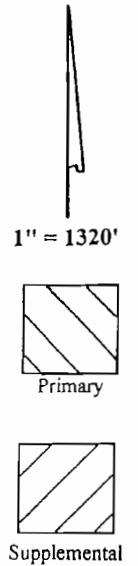
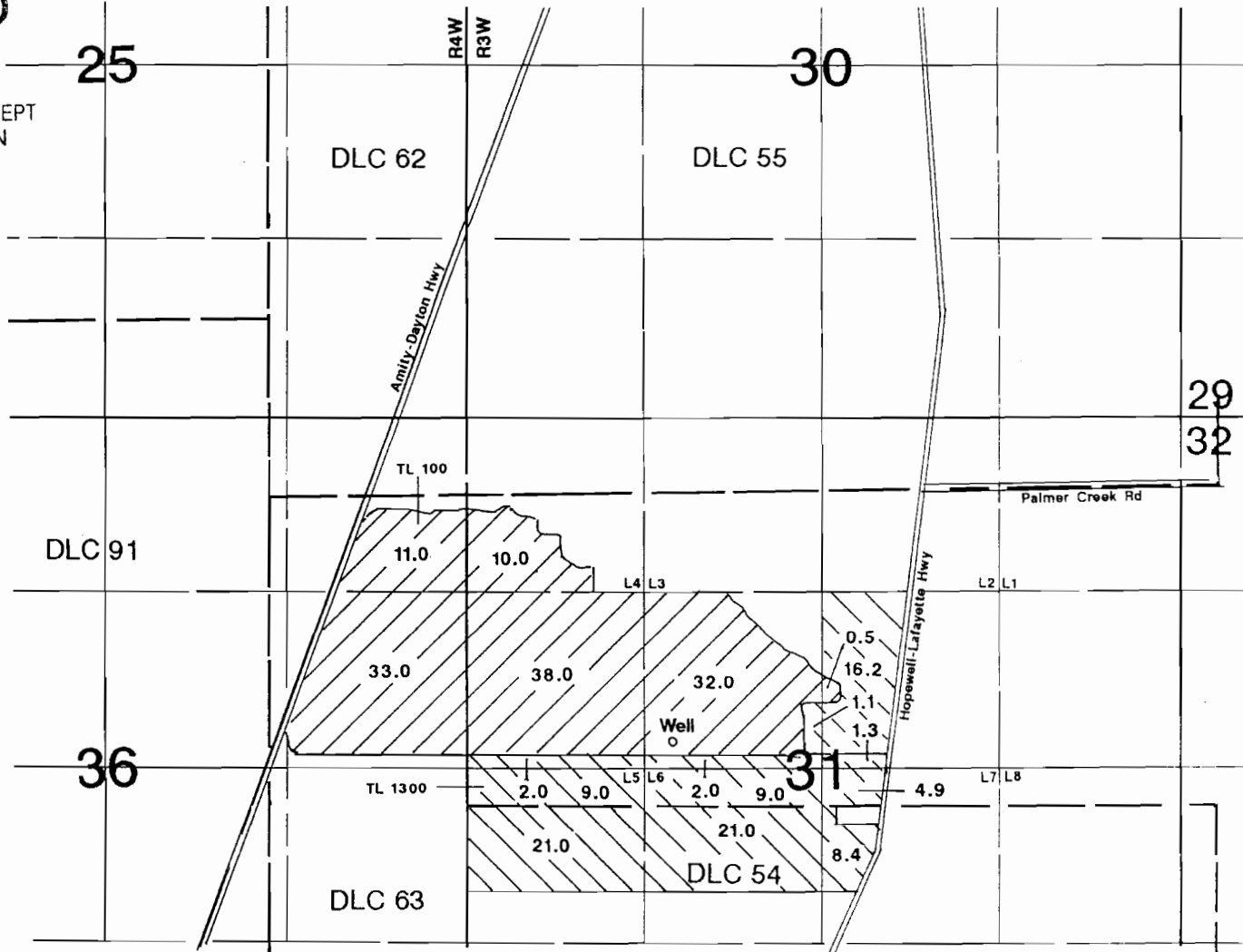

Well is located 200'N & 1100'W from the center of Section 31.

Application Map

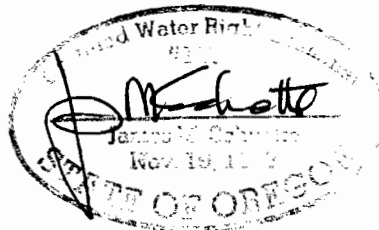

Timothy C. & Suzanne Kreder

Application #: *G-17043*

Permit #:

This Map was Prepared for the Purpose of Identifying the Location of a Water Right Only and is Not Intended to Provide Legal Dimensions or Location of Property Ownership Lines.

Tim Kreder Groundwater Application (1)
G-

T4S, R4W-Section		T4S, R4W- Section 25	
NW NW			
NE NW		Lot 4	10.0
SW NW			38.0
SE NW			32.0
NW NE	DLC 63	11.0	
NE NE			
SW NE			0.5
SE NE	DLC 63	33.0	
NW SW			
NE SW			
SW SW			
SE SW			
NW SE			
NE SE			
SW SE			
SE SE			

44.0		80.5	124.5
------	--	------	--------------

Supplemental

T4S, R3W, Section 31		T4S, R3W, Section 31	
NW NW			
NE NW			
SW NW		2.0	
SE NW		3.1	
NW NE			
NE NE			
SW NE		17.5	
SE NE			
NW SW	Lot 5	9.0	DLC 54 21.0
NE SW	Lot 6	9.0	DLC 54 21.0
SW SW			
SE SW			
NW SE	DLC 54	8.4	Lot 7 4.9
NE SE			
SW SE			
SE SE			

49.0		46.9	95.9
------	--	------	-------------

Primary

Total Acreage:	220.4
-----------------------	--------------

RECEIVED

APR 23 2008

WATER RESOURCES DEPT
SALEM, OREGON

G-17043

T4S R3W & R4W W.M.



SE Amity-Dayton Hwy

Palmer Creek Rd

R4W
R3W
25 30
36 31

tax lot 4436 00100

PRIMARY IRRIGATION

T4W R3W SECTION 31 SENW	9.2 a
T4W R3W SECTION 31 SWNE	12.2 a
T4W R3W SECTION 31 NWSW	29.0 a
T4W R3W SECTION 31 SWNW	2.0 a
T4W R3W SECTION 31 NESW	29.0 a
T4W R3W SECTION 31 NWSE	11.3 a
T4W R4W SECTION 36 SENE	0.4 a
T4W R4W SECTION 36 NESE	0.8 a
total	93.9 acres

2.0 a supplemental

9.2 a

12.2 a

well
o

2.0 a

0.4 a

31

36

tax lot 4331 01200

0.8 a

29.0 a

29.0 a

11.3 a

tax lot 4331 01300

SUPPLEMENTAL IRRIGATION

T4W R3W SECTION 31 SENW	2.0 a
total	2.0 acres

Primary

Supplemental

SE Lafayette Hwy

Well is located 200' N & 600' E from the center of Section 31

1" = 800'

revised map for Application G-17043

April 4, 2018