

# T.4S., R.3W & R.4W, W.M.

**RECEIVED**

APR 23 2008

WATER RESOURCES DEPT  
SALEM, OREGON

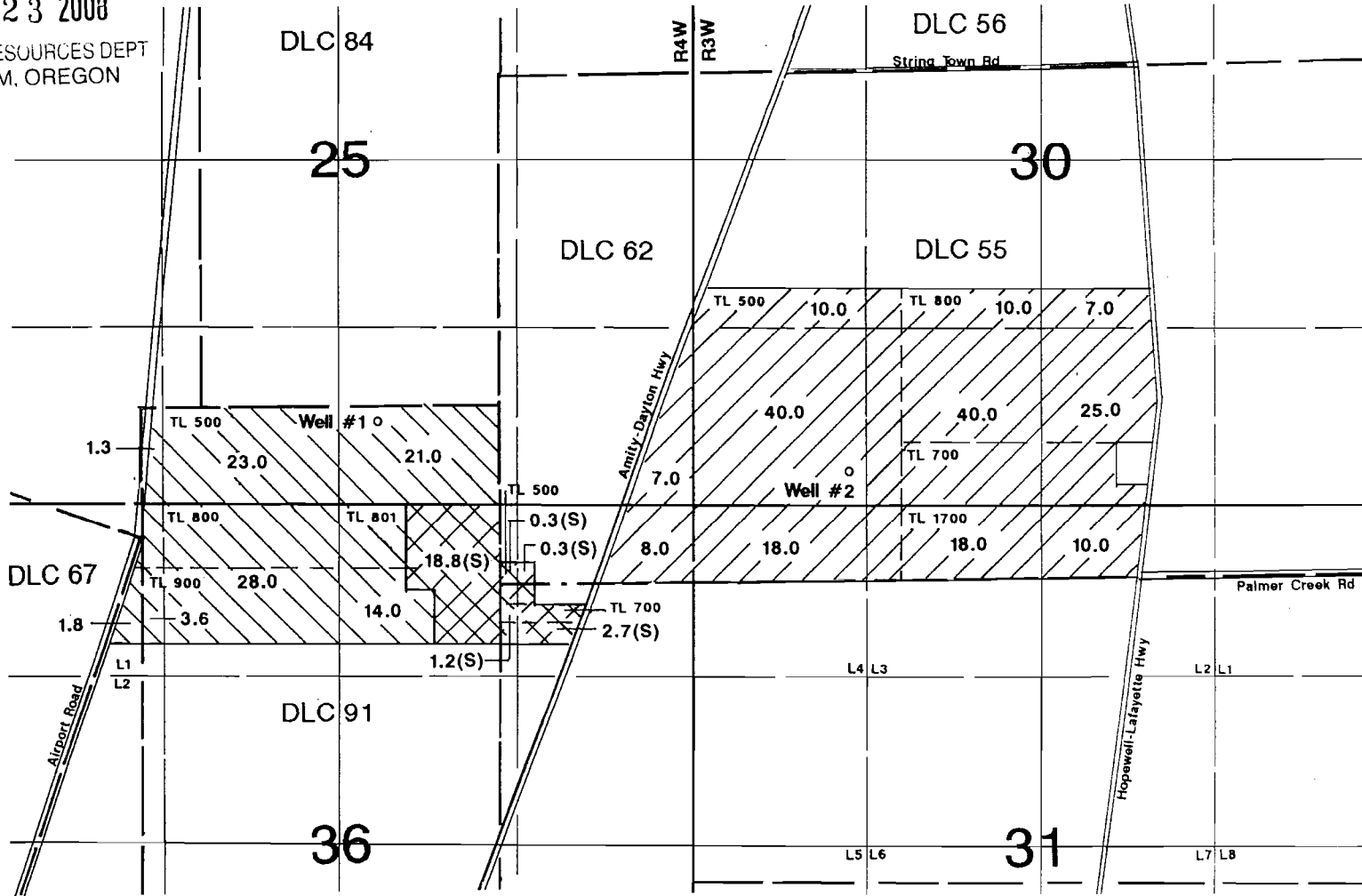

1" = 1320'

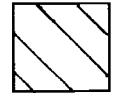

Primary Well #1



Supplemental Well #1



Primary Well #2

Well #1 is located 625'N & 2425'W  
Well #2 is located 250'N & 1180'E—both from the NE corner of Section 36.

## Application Map

# Timothy C. & Suzanne Kreder

Application #: *G-17044*

Permit #:

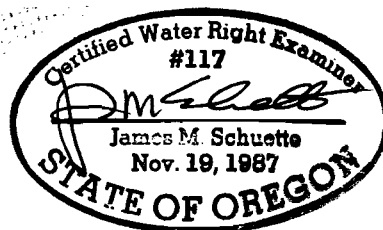

This Map was Prepared for the Purpose of Identifying the Location of a Water Right Only and is Not Intended to Provide Legal Dimensions or Location of Property Ownership Lines.

RECEIVED

APR 23 2000

WATER RESOURCES DEPT  
SALEM, OREGON

**Tim Kreder Groundwater Application (2)**  
G-

T4S, R4W-Section 25			T4S, R4W-Section 36	
NW NW			DLC 91	3.6
NW NW			Lot 1	1.8
NE NW			DLC 91	28.0
SW NW				
SE NW				
NW NE			DLC 91	14.0
NE NE			DLC 62	8.0
SW NE				
SE NE				
NW SW				
NE SW				
SW SW	DLC 91	1.3		
SE SW	DLC 91	23.0		
NW SE				
NE SE				
SW SE	DLC 91	21.0		
SE SE	DLC 62	7.0		

52.3		55.4	107.7
------	--	------	-------

			T4S, R4W-Section 36
NW NE	DLC 91	18.8	
NW NE	DLC 62	0.3	
NW NE	DLC 62	1.2	
NE NE	DLC 62	0.3	
NE NE	DLC 62	2.7	
		<b>23.3</b>	<b>Supplemental</b>

T4S, R3W-Section 31			T4S, R3W-Section 30	
NW NW	DLC 55	18.0		
NE NW	DLC 55	18.0		
SW NW				
SE NW				
NW NE				
NE NE	DLC 55	10.0		
SW NE				
SE NE				
NW SW			DLC 55	10.0
NE SW			DLC 55	10.0
SW SW			DLC 55	40.0
SE SW			DLC 55	40.0
NW SE				
NE SE			DLC 55	7.0
SW SE				
SE SE			DLC 55	25.0

46.0		132.0	178.0
------	--	-------	-------

<b>Total Primary Acreage</b>	<b>285.7</b>
<b>Total Supplemental Acreage</b>	<b>23.3</b>
<b>Total Acreage</b>	<b>309.0</b>

G-17044