

T6S R1E, WM

CLACKAMAS COUNTY

TAX LOT:
6S 1E 8 400

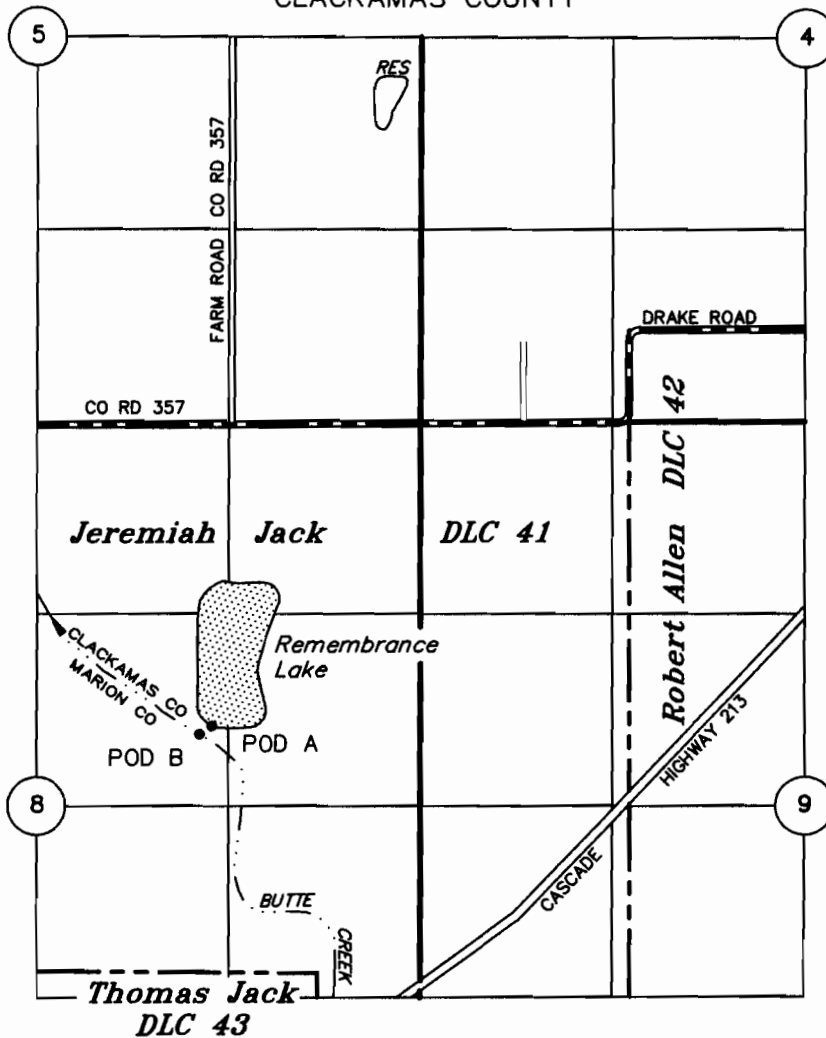

POD A: 2075' S & 1200' E OF N 1/4 COR SEC 8
POD B: 2110' S & 1120' E OF N 1/4 COR SEC 8

APPLICATION TO CONSTRUCT A RESERVOIR

UNDER

RECEIVED

AUG 27 2008

Application No. _____

Permit No. _____

WATER RESOURCES DEPT
SALEM, OREGON

IN THE NAME OF

VICTOR SCHNEIDER, JR.

JULY 22, 2008

SCALE: 1" = 1320'



NOTE: This map is not intended to provide legal dimensions or locations of property ownership lines.

EXPIRES 12-31-09