

T6S R1E, WM

CLACKAMAS COUNTY

TAX LOT:
 6S 1E 4 900
 6S 1E 4 1000
 6S 1E 5 1900
 6S 1E 5 2000
 6S 1E 8 101
 6S 1E 8 400

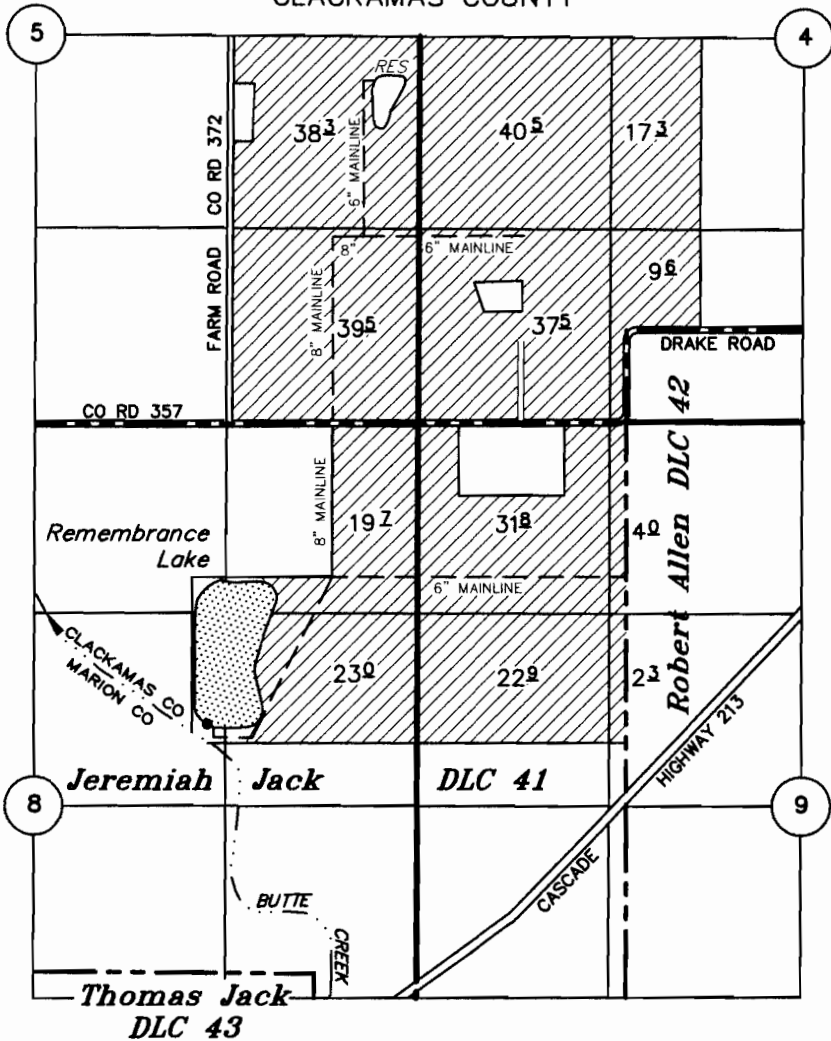

SUPPLEMENTAL

POD: 1,405' W & 1,920' S OF NE 1/4 COR SEC 8

APPLICATION TO APPROPRIATE SURFACE WATER (STORED WATER ONLY) UNDER

RECEIVED

AUG 27 2008

Application No. _____ Permit No. _____

WATER RESOURCES DEPT
 SALEM, OREGON

IN THE NAME OF

VIC SCHNEIDER

JULY 22, 2008

SCALE: 1" = 1320'



NOTE: This map is not intended to provide legal dimensions or locations of property ownership lines.

EXPIRES 12-31-09