

# T.6S. R.1E. Sec. 4, 5, 8, & 9

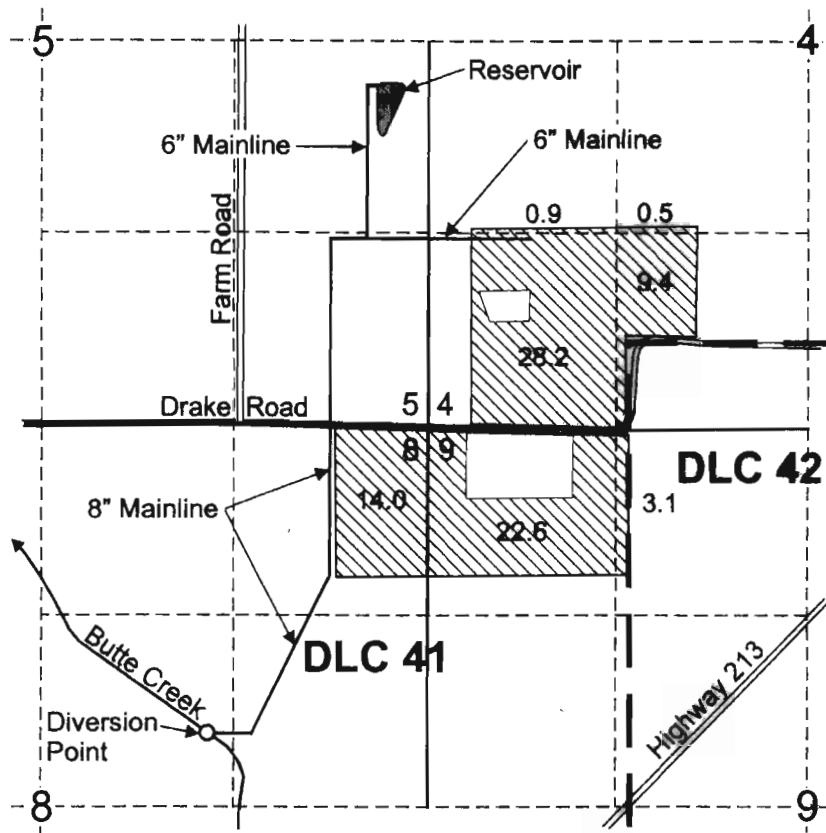

Point of Diversion is located 2,110 feet south and 1,120 feet east from the N 1/4 corner of Section 8.

 Area (78.7 Acres) irrigated under Application S-70192, Permit S-53124.

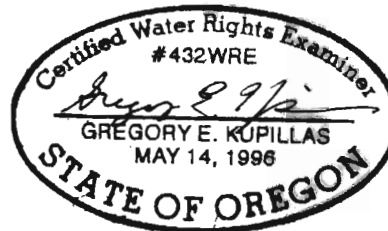
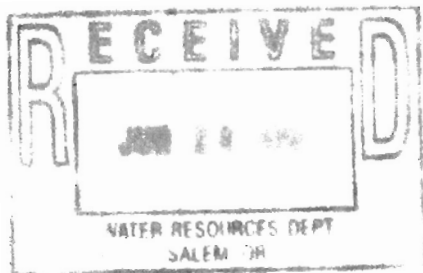

EXPIRATION DATE: 6/30/02

Scale: 1" = 1,320'

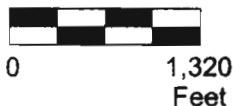

This map was prepared for the purpose of identifying the location of a water right only and is not intended to provide legal dimensions or location of property ownership lines.



## Claim of Beneficial Use Map



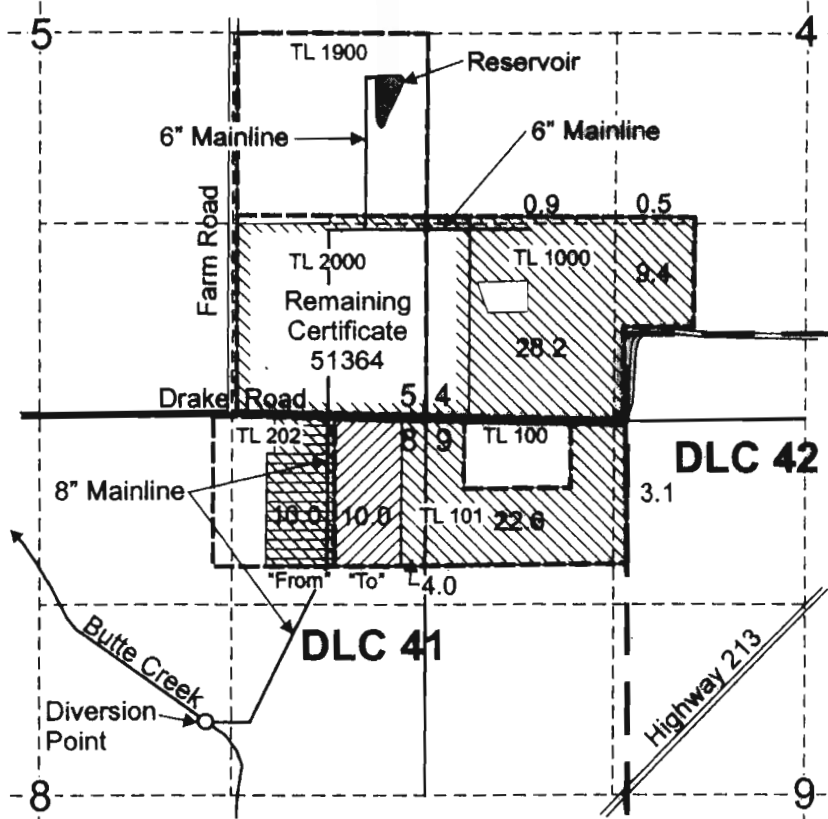

Pacific Hydro-Geology Inc.

Victor Schneider, Jr.  
T.6S. R.1E. Sec. 4, 5, 8, and 9

# T.6S. R.1E. Sec. 4, 5, 8, & 9



Point of Diversion is located 2,110 feet south and 1,120 feet east from the N 1/4 corner of Section 8.

-  Area (78.7 Acres) irrigated under Application S-70192, Permit S-53124.
-  "From" Area (10.0 Acres) for Transfer T-8117 (previously irrigated under Certificate 51364).
-  "To" Area (10.0 Acres) for Transfer T-8117.
-  Area (49.7 Acres) remaining under Certificate 51364, superceded by Certificate 76092.
-  Tax Lot Boundary

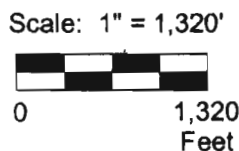
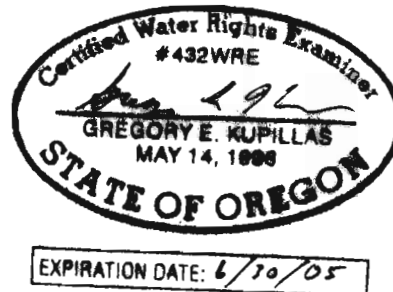
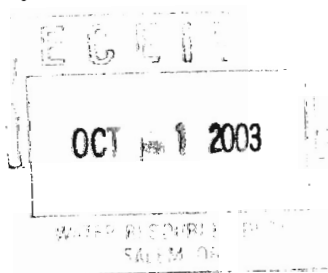

This map was prepared for the purpose of identifying the location of a water right only and is not intended to provide legal dimensions or location of property ownership lines.

**Claim of Beneficial Use Map**  
for Application S-70192 and Transfer T-8117

Pacific Hydro-Geology Inc.

Victor Schneider, Jr.  
T.6S. R.1E. Sec. 4, 5, 8, and 9

9/2003

SchS70192T8117.cdr