

# T.4S. R.1W. Section 8

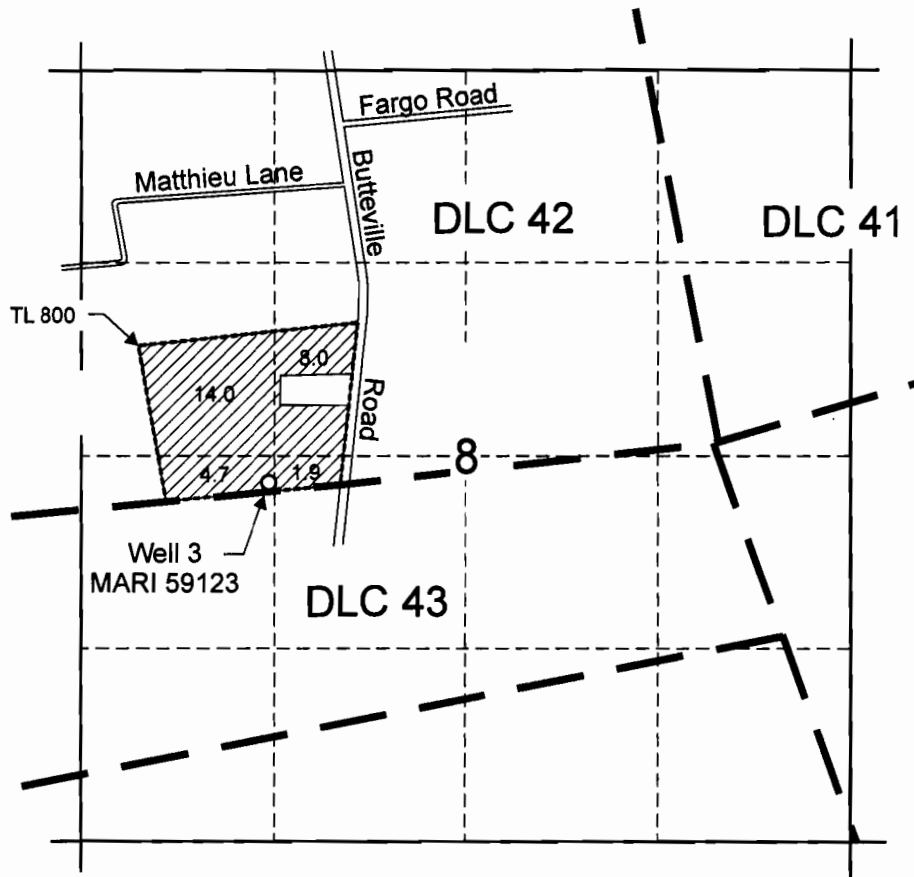

Well 3 (MARI 59123) is located 280 feet south and 3,090 feet west from the SE corner of DLC 42.

 Area (28.6 Acres) to be irrigated.

----- Tax Lot Boundary

**RECEIVED**

SEP 10 2008

WATER RESOURCES DEPT  
SALEM, OREGON

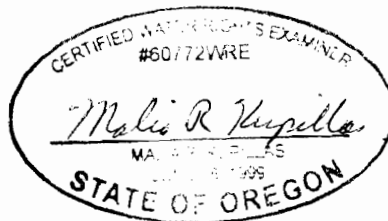

EXPIRATION DATE: 6/30/09

Scale: 1" = 1,320'



This map was prepared for the purpose of identifying the location of a water right only and is not intended to provide legal dimensions or location of property ownership lines.



Map to Accompany A Water Right Application

Richard Malone  
T.4S. R.1W. Section 8B, Tax Lot 800

Pacific Hydro-Geology Inc.

8/2008