

Township 14 South, Range 39 East, W.M.

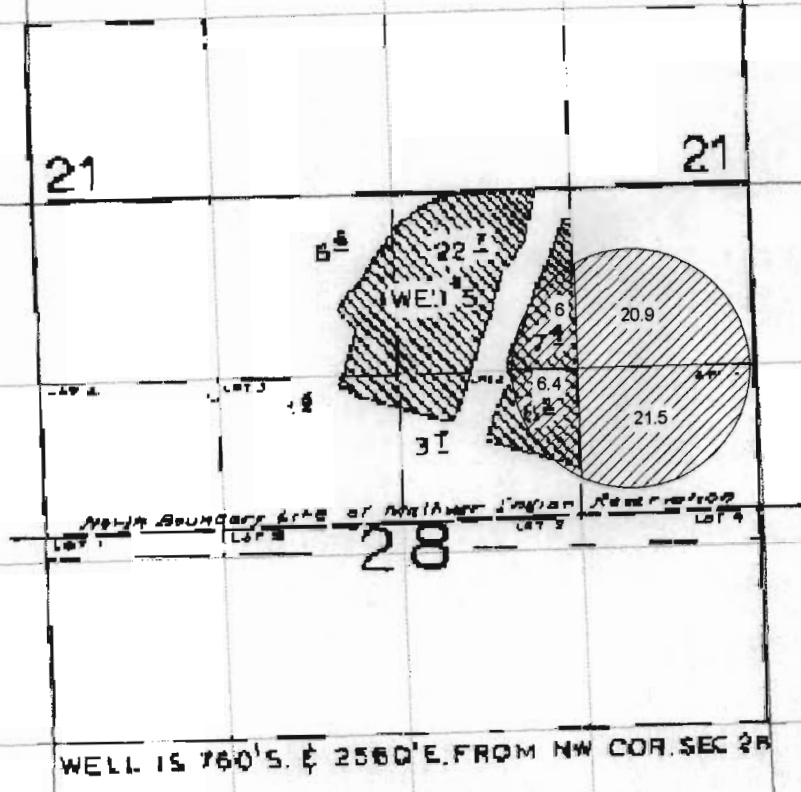

1 inch equals 0.25 miles



RECEIVED

SEP 15 2008

WATER RESOURCES DEPT
SALEM, OREGON

T.14 S.R. 39 E.W.M.

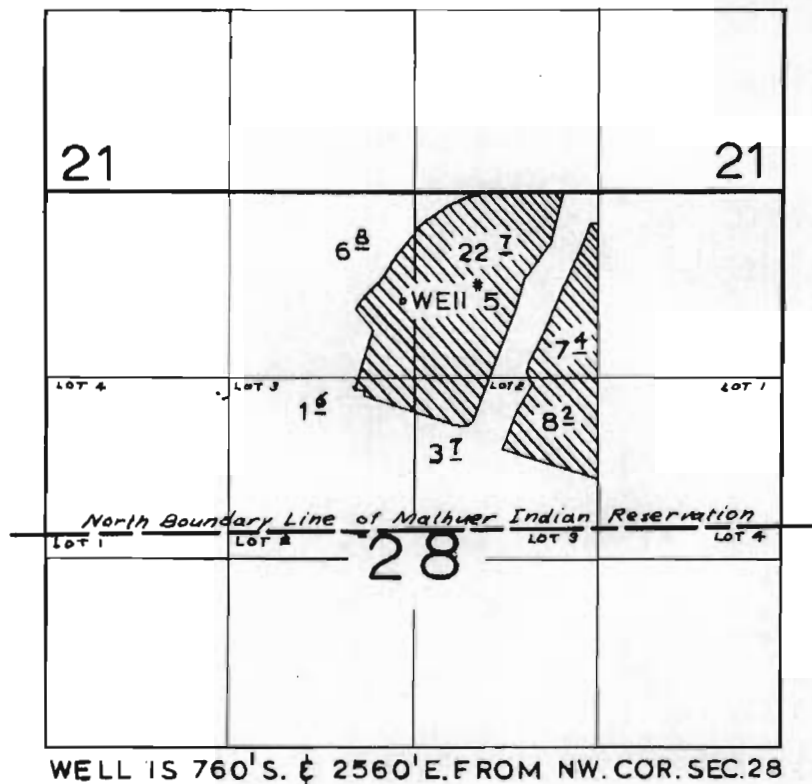

WELL IS 760' S. & 2560' E. FROM NW. COR. SEC. 28

FINAL PROOF SURVEY
UNDER

Application No. G-2286... Permit No. G-2251...
IN NAME OF

JOHN MOLTHAN

Surveyed OCT. 21, 1966, by F. ELFERING

RECEIVED

SEP 15 2008

WATER RESOURCES DEPT
SALEM, OREGON