

T6S, R4W, WM

POLK COUNTY

RECEIVED

SEP 22 2008

WATER RESOURCES DEPT
SALEM, OREGON

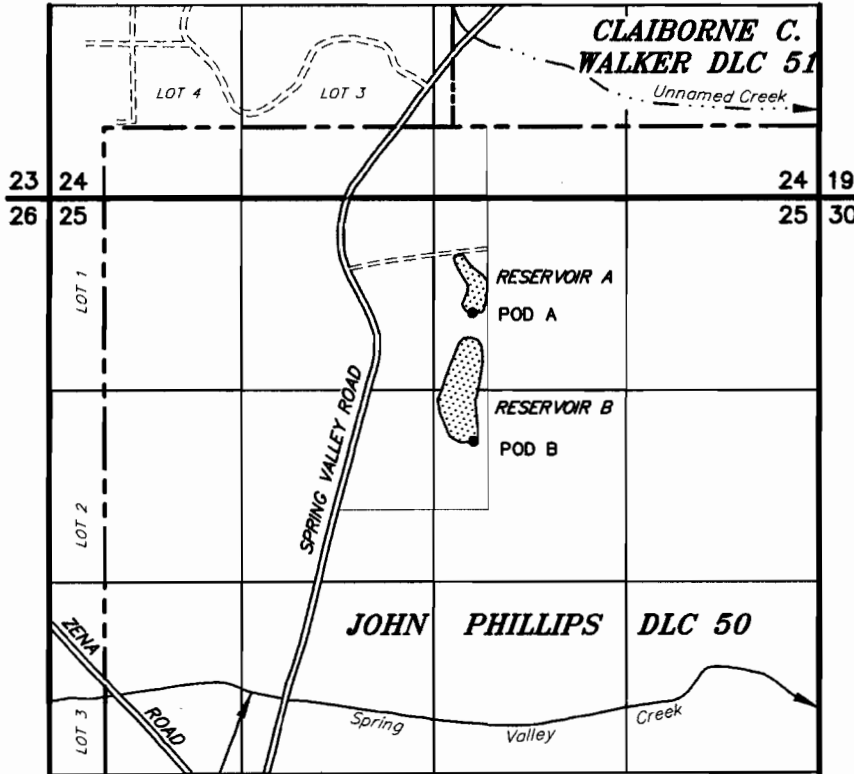

TAX LOT:
6 4 25 203

POD A: 1275' S & 135' E OF THE SW CORNER CLAIBORNE C. WALKER DLC 51
POD B: 2160' S & 145' E OF THE SW CORNER CLAIBORNE C. WALKER DLC 51

APPLICATION TO CONSTRUCT A RESERVOIR

UNDER

Application No. _____ Permit No. _____

IN THE NAME OF

DAVID KNIELING

September 8, 2008

SCALE: 1" = 1320'



NOTE: This map is not intended to provide legal dimensions or locations of property ownership lines.

Renewal Date 12-31-09