

58

UMPQUA BASIN WATER ASSOCIATION

DISTRICT BOUNDARY

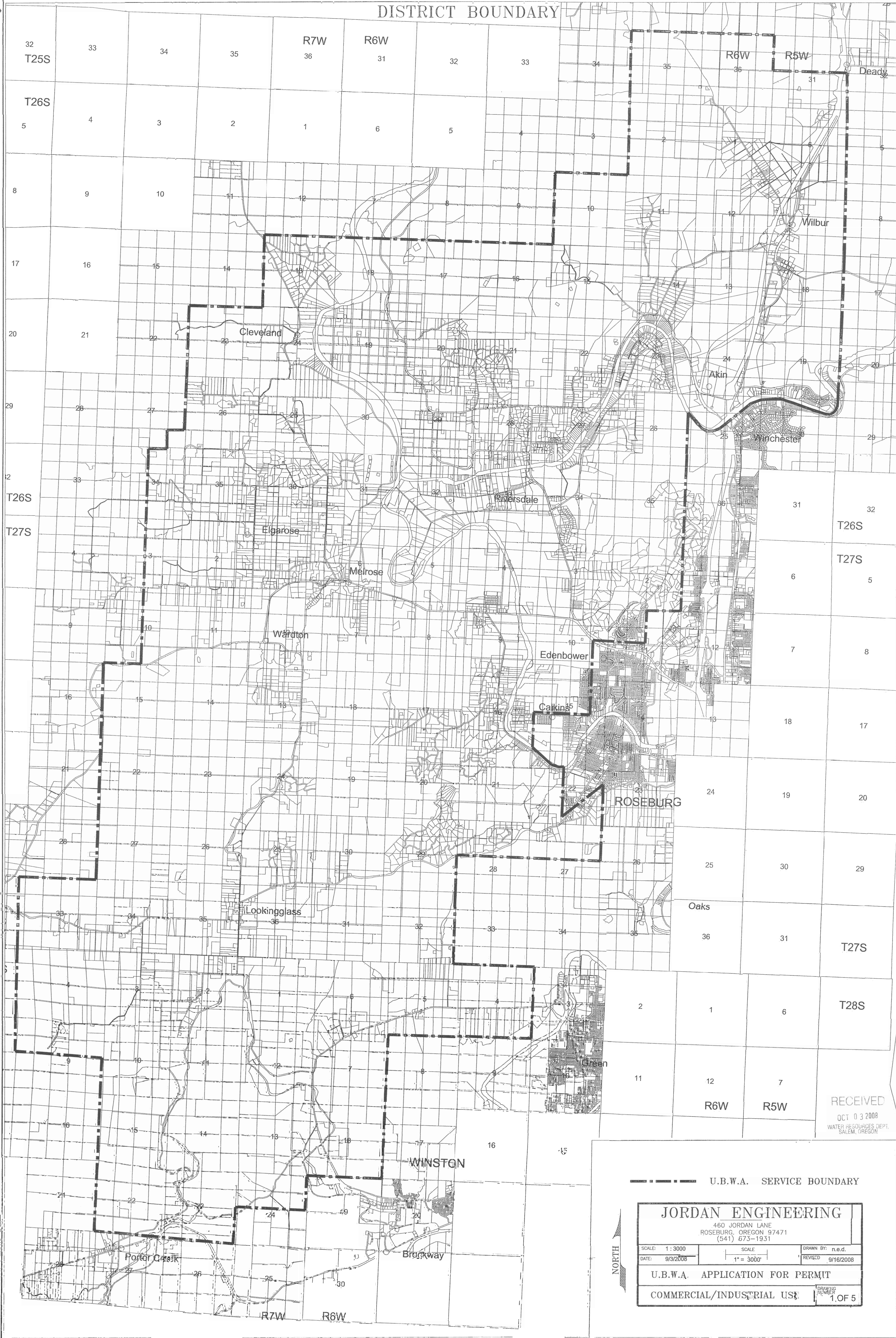

S 87299

RECEIVED
 OCT 03 2008
 WATER RESOURCES DEPT.
 SALEM, OREGON

--- U.B.W.A. SERVICE BOUNDARY

JORDAN ENGINEERING
 460 JORDAN LANE
 ROSEBURG, OREGON 97471
 (541) 673-1931

SCALE: 1:3000	SCALE: 1" = 3000'	DRAWN BY: n.e.d.
DATE: 9/3/2008		REVISED: 9/16/2008

U.B.W.A. APPLICATION FOR PERMIT
 COMMERCIAL/INDUSTRIAL USE

DRAWING NUMBER: 1 OF 5

828

UMPQUA BASIN WATER ASSOCIATION
 T.25S & T.26S, R.5W & 6W, W.M.
 DOUGLAS COUNTY OREGON

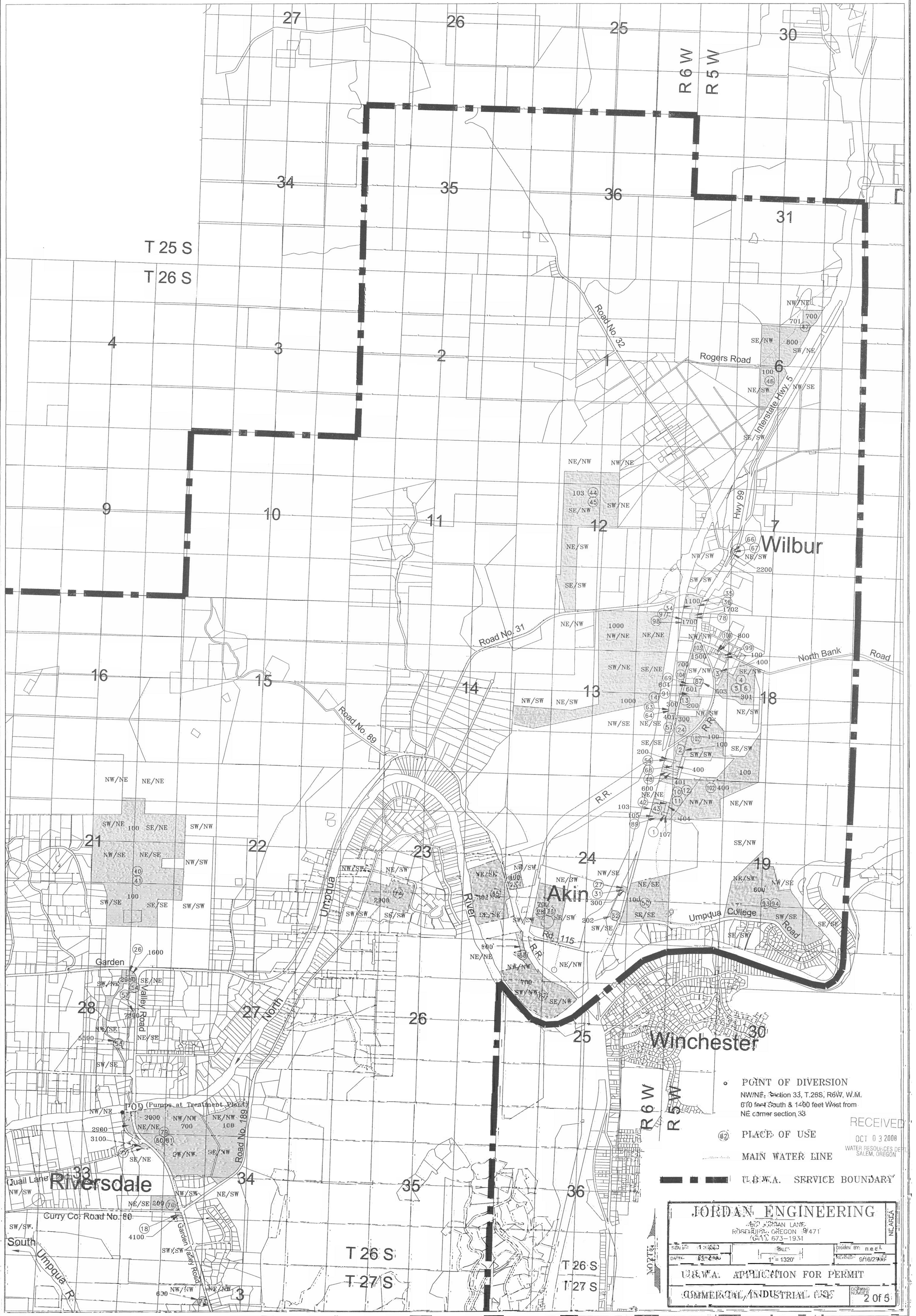

- POINT OF DIVERSION
NW/NE, Section 33, T.26S, R.6W, W.M.
670 feet South & 1400 feet West from
NE corner section 33
- ② PLACE OF USE
- MAIN WATER LINE
- U.B.W.A. SERVICE BOUNDARY

RECEIVED
 OCT 03 2009
 WATER RESOURCES DEPT.
 SALEM, OREGON

JORDAN ENGINEERING
 400 JORDAN LANE
 ROSEBURG, OREGON 97471
 (503) 673-1931

DATE: 11/24/09	SCALE: 1" = 1320'	DRAWN BY: necl
PROJECT: U.B.W.A.	REVISION: 01/02/09	CHECKED: g/02/09

U.B.W.A. APPLICATION FOR PERMIT
 COMMERCIAL/INDUSTRIAL USE
 SHEET NUMBER 2 of 5

S 87299

218

UMPQUA BASIN WATER ASSOCIATION
 T.26S & T.27S, R.6W & 7W, W.M.
 DOUGLAS COUNTY OREGON

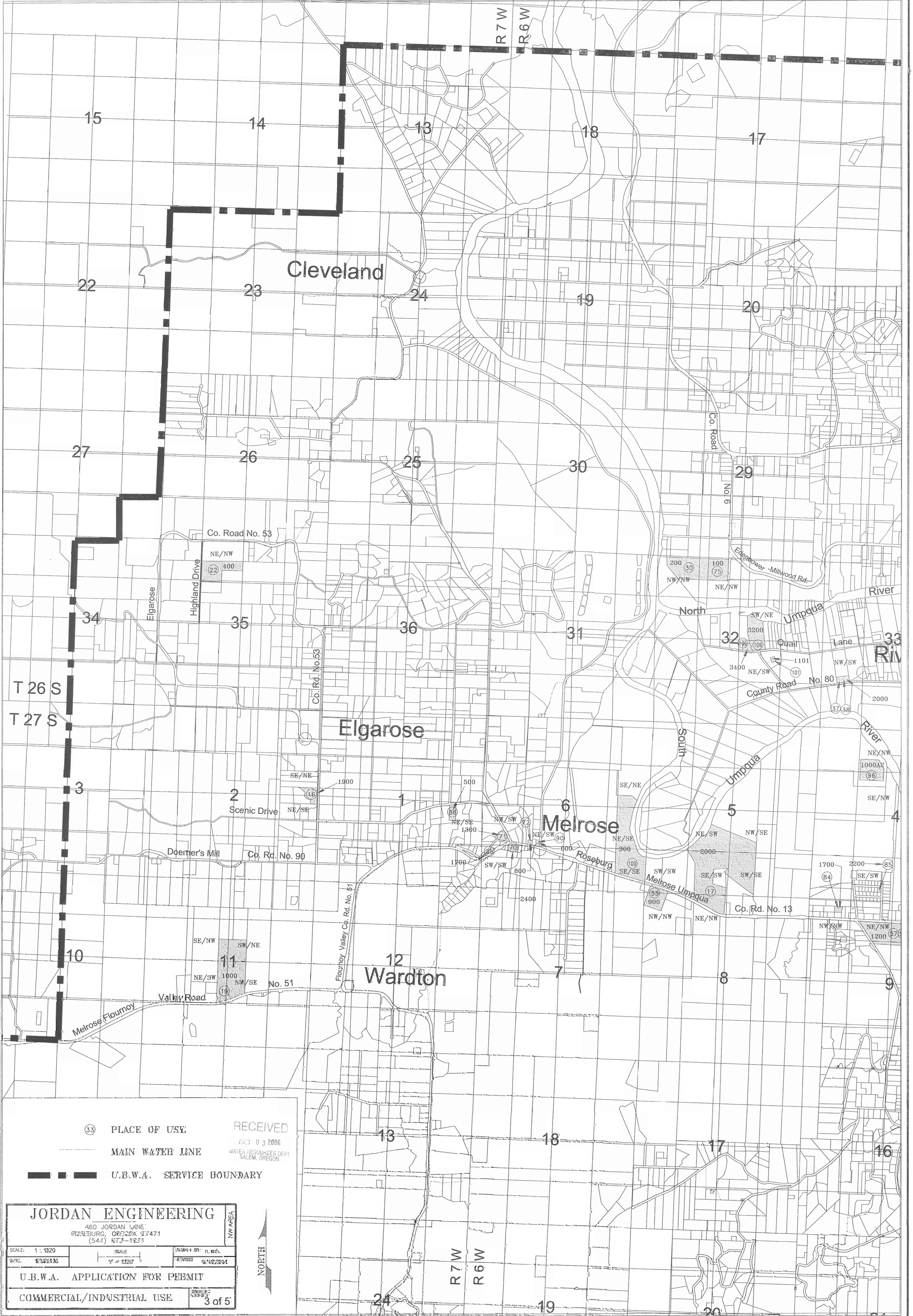

- (33) PLACE OF USE
- MAIN WATER LINE
- U.B.W.A. SERVICE BOUNDARY

RECEIVED
 OCT 03 2008
 WATER RESOURCES DEPT.
 SALEM, OREGON

JORDAN ENGINEERING
 460 JORDAN LANE
 ROSEBURG, OREGON 97471
 (541) 873-1831

SCALE: 1" = 1320'
 DATE: 9/26/13

U.B.W.A. APPLICATION FOR PERMIT
 COMMERCIAL/INDUSTRIAL USE

3 of 5

S 87299

238

UMPQUA BASIN WATER ASSOCIATION
 T.27S & T.28S, R.5W & 6W, W.M.
 DOUGLAS COUNTY OREGON

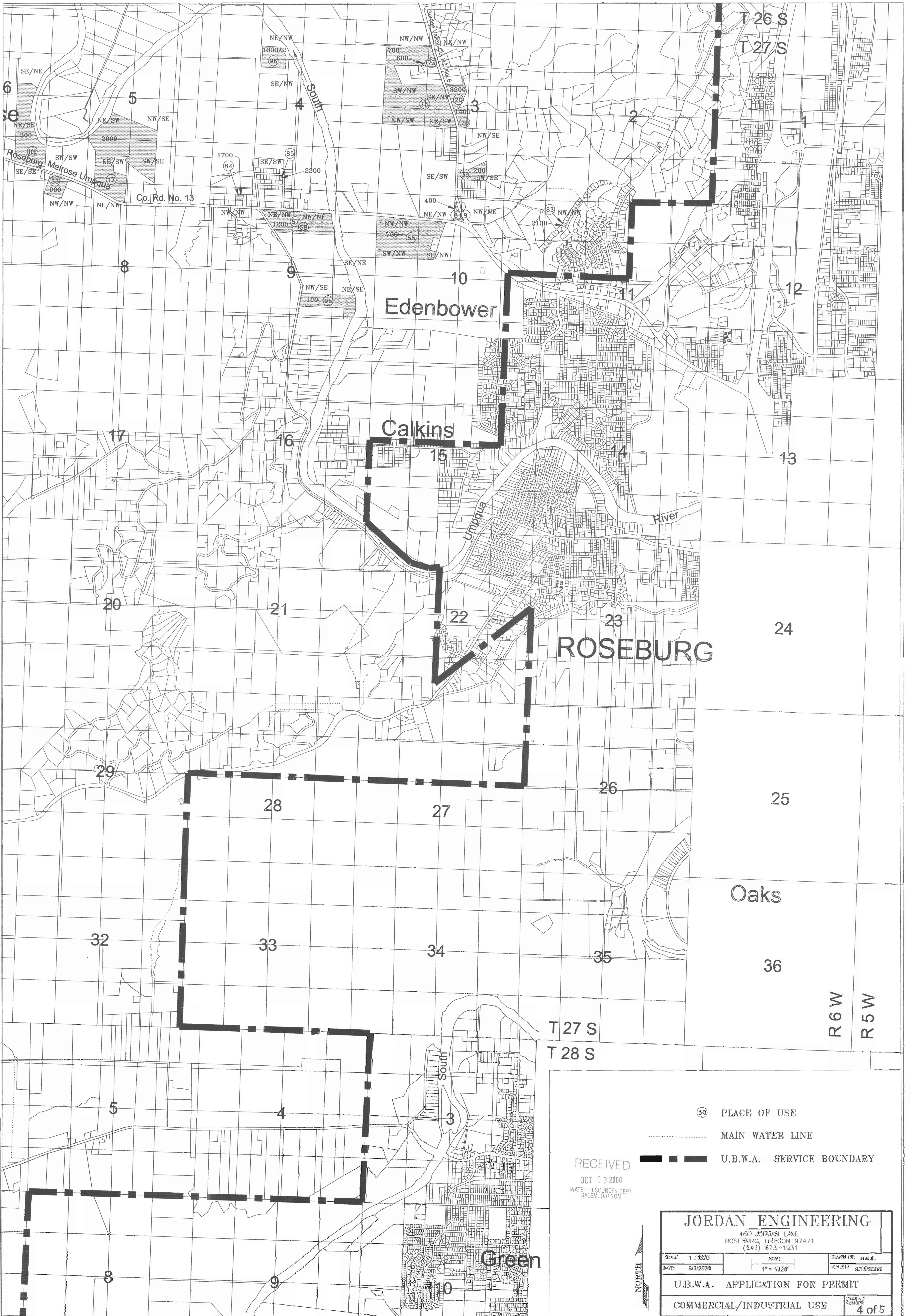

S 87299

RECEIVED
 OCT 03 2006
 WATER RESOURCES DEPT.
 SALEM, OREGON

- Ⓢ PLACE OF USE
- MAIN WATER LINE
- U.B.W.A. SERVICE BOUNDARY

JORDAN ENGINEERING		
460 JORDAN LANE ROSEBURG, OREGON 97471 (503) 673-1931		
SCALE: 1" = 125'	SCALE: 1" = 125'	DRAWN BY: n.e.g.
DATE: 9/2/2006	REVISION: 9/16/2006	
U.B.W.A. APPLICATION FOR PERMIT		
COMMERCIAL/INDUSTRIAL USE		DRAWING NUMBER: 4 of 5

238

UMPQUA BASIN WATER ASSOCIATION
 T.26S & T.27S, R.6W & 7W, W.M.
 DOUGLAS COUNTY OREGON

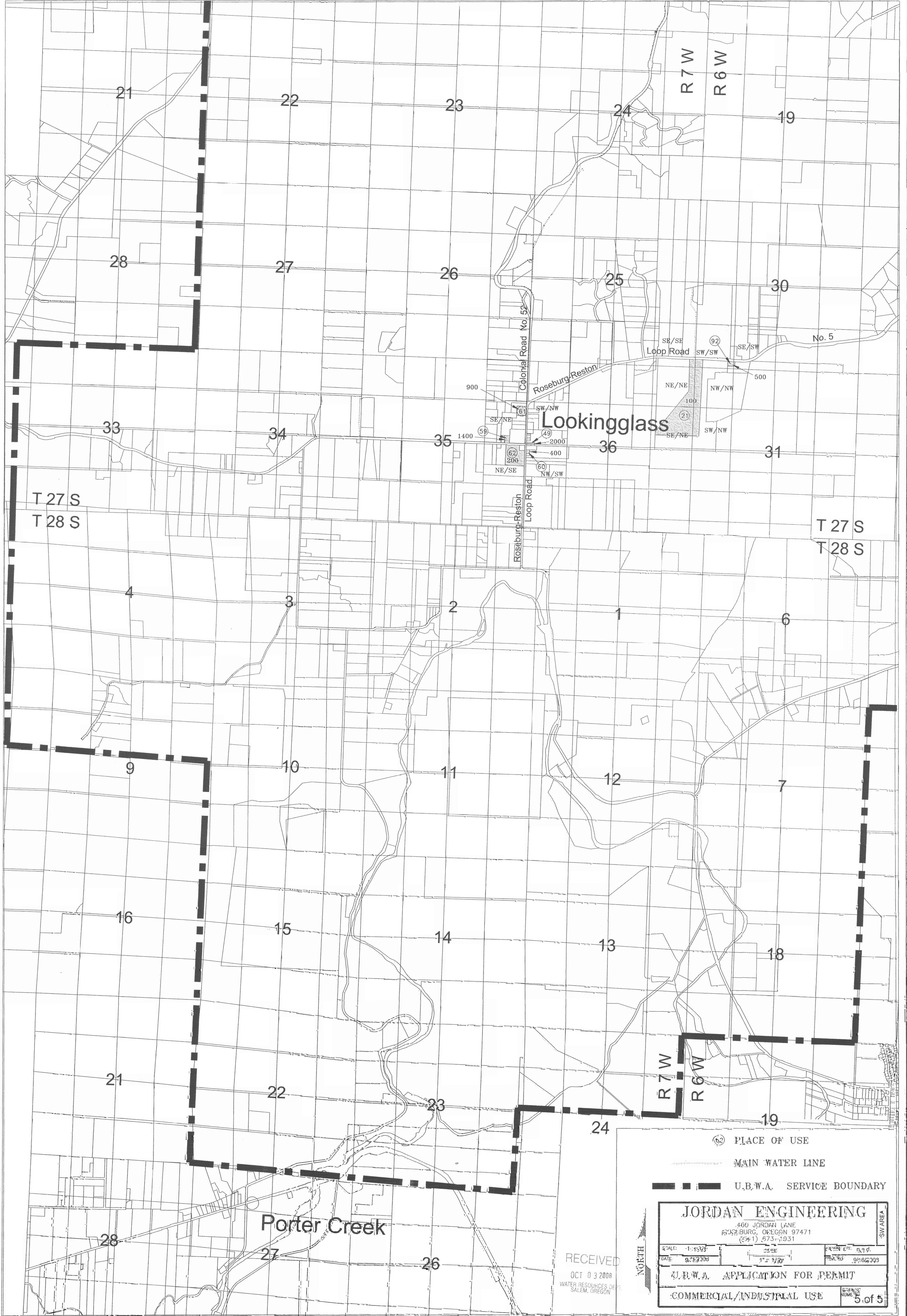

S87294

RECEIVED
 OCT 03 2009
 WATER RESOURCES DEPT.
 SALEM, OREGON

(62) PLACE OF USE
 MAIN WATER LINE
 U.B.W.A. SERVICE BOUNDARY

JORDAN ENGINEERING
 460 JORDAN LANE
 ROSEBURG, OREGON 97471
 (503) 573-1931

SCALE: 1" = 120'
 DATE: 9/23/09
 DRAWN BY: J.E.P.
 CHECKED BY: J.E.P.

U.B.W.A. APPLICATION FOR PERMIT
 COMMERCIAL/INDUSTRIAL USE

5 of 5