

T40S, R3W, W.M. Section 18 & 19

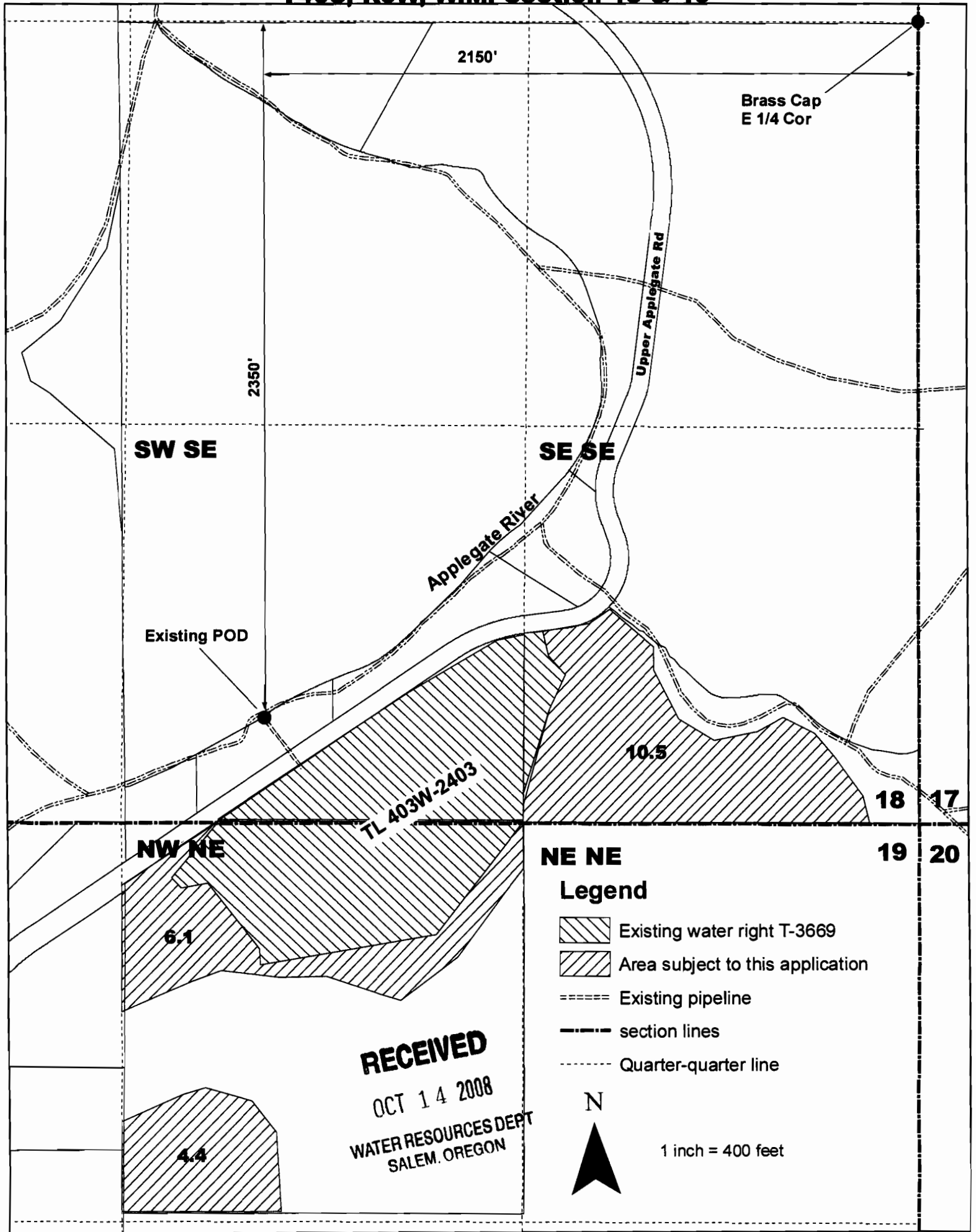

2150'

2350'

Brass Cap
E 1/4 Cor

SW SE

SE SE

Applegate River

Upper Applegate Rd

Existing POD

TL 403W-2403

10.5

18

17

NW NE





NE NE

19

20

6.1

Legend

-  Existing water right T-3669
-  Area subject to this application
-  Existing pipeline
-  section lines
-  Quarter-quarter line

RECEIVED
OCT 14 2008
WATER RESOURCES DEPT
SALEM, OREGON



1 inch = 400 feet

4.4