

T.5S. R.1E. Section 34

RECEIVED

OCT 30 2008

WATER RESOURCES DEPT
SALEM, OREGON

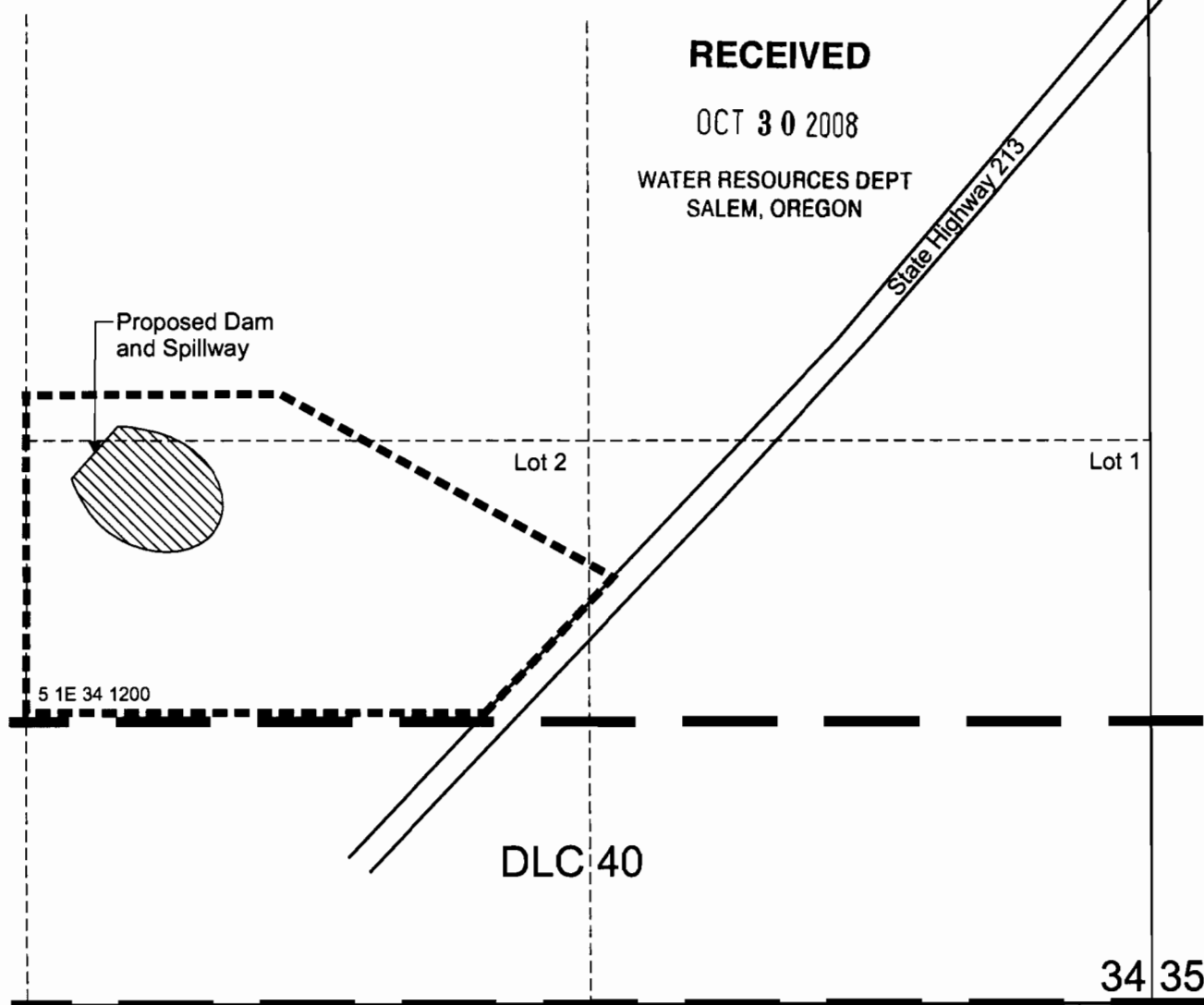

Center of proposed reservoir is located 1,280 feet north and 2,450 feet west from the SE corner, Section 34.

Center of proposed dam is located 1,300 feet north and 2,480 feet west from the SE corner, Section 34.

 Location of Proposed Reservoir

 Tax Lot Boundary

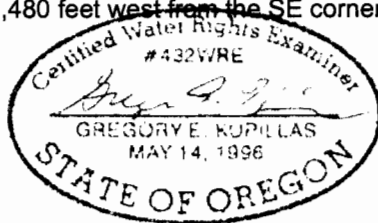

EXPIRATION DATE: 6/30/09

This map was prepared for the purpose of identifying the location of a water right only and is not intended to provide legal dimensions or location of property ownership lines.

Scale: 1" = 400'



Reservoir Permit Application Map

Bill and Jennifer Cameron
Tax Lot 5 1E 34 1200

Pacific Hydro-Geology Inc.

10/2008