

CLACKAMAS COUNTY
 1" = 400'
 25 March 1975

RECEIVED **RECEIVED**

JUN 20 1975 SEP 24 1975
 STATE ENGINEER WATER RESOURCES DEPT.
 SALEM, OREGON SALEM, OREGON

Application No. G-7002
 Permit No. G 6504

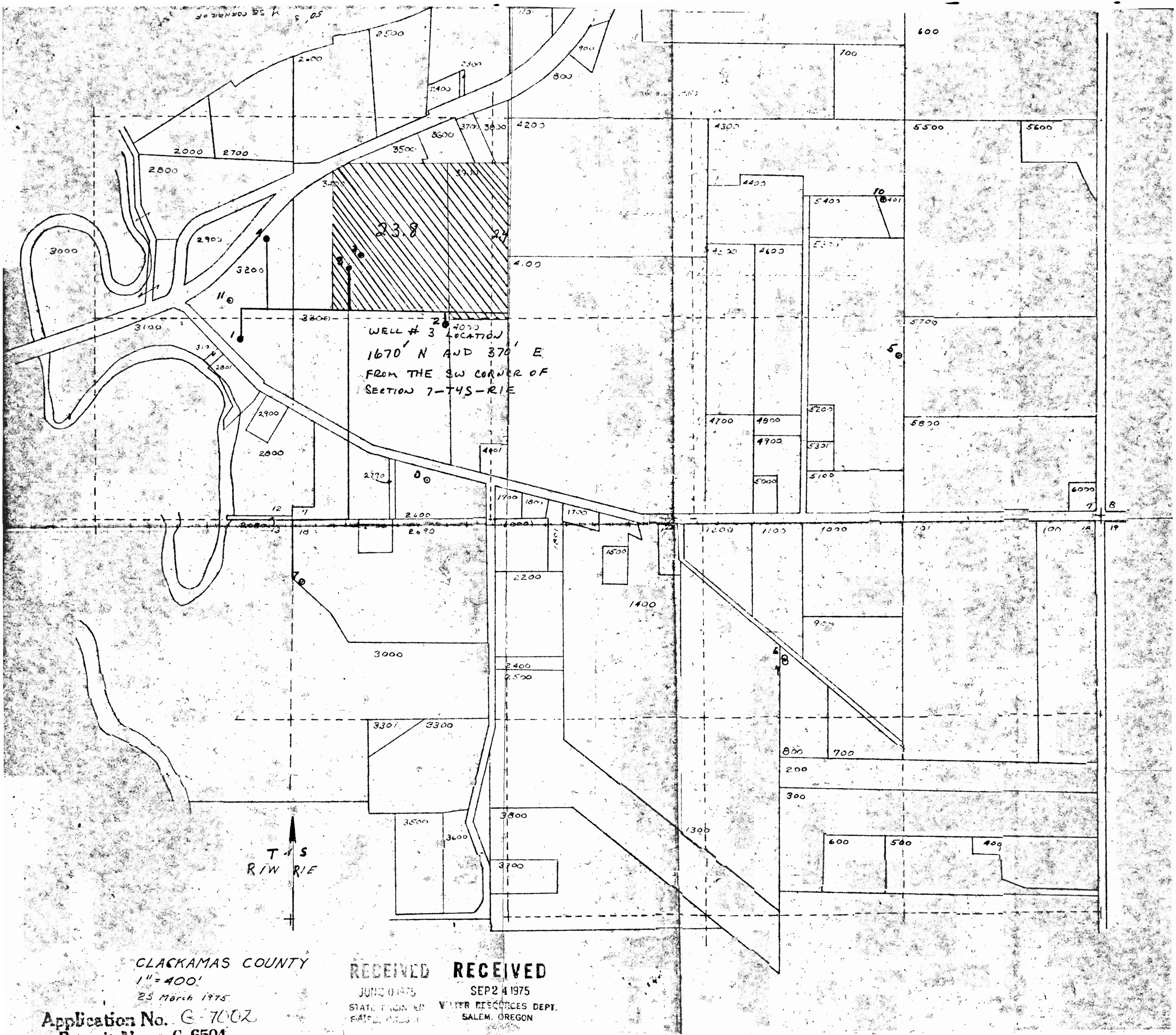

CLACKAMAS COUNTY
1" = 400'
25 March 1975

RECEIVED RECEIVED

JUN 20 1975 STATE ENGINEER
SEP 24 1975 WATER RESOURCES DEPT.
SALEM, OREGON

Application No. G-7002
Permit No. G 6504