

T.3S. R.1E. Sec. 23 & 26

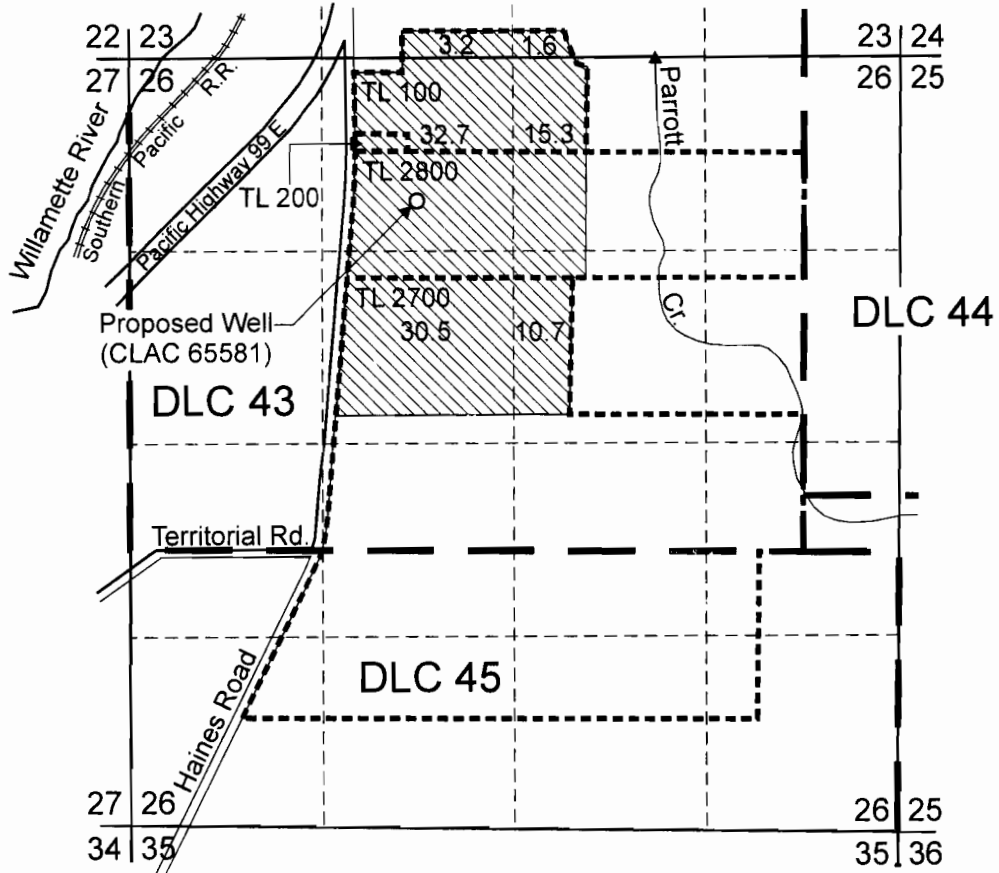

Proposed Well (CLAC 65581) is located 2,410 feet north and 2,650 feet west from the SE Corner of DLC 43.

 Area (94.0 Acres) proposed for nursery operations.

 Tax Lot Boundary

RECEIVED

DEC 31 2008

WATER RESOURCES DEPT
SALEM, OREGON



EXPIRATION DATE: 6/30/09

Scale: 1" = 1,320'



This map was prepared for the purpose of identifying the location of a water right only and is not intended to provide legal dimensions or location of property ownership lines.



Water Right Application Map

Rich and Nancy Birkemeier
T.3S. R.1W. Sec. 23 and 26

Pacific Hydro-Geology Inc.

12/2008