

R-87376

SECTION 26 T.3S R.1E WM

D.L.C.'S JOSEPH PARROTT NO. 43

3 IE 26

CLACKAMAS COUNTY

WALTER FISH NO. 45

This map was prepared for assessment purpose only

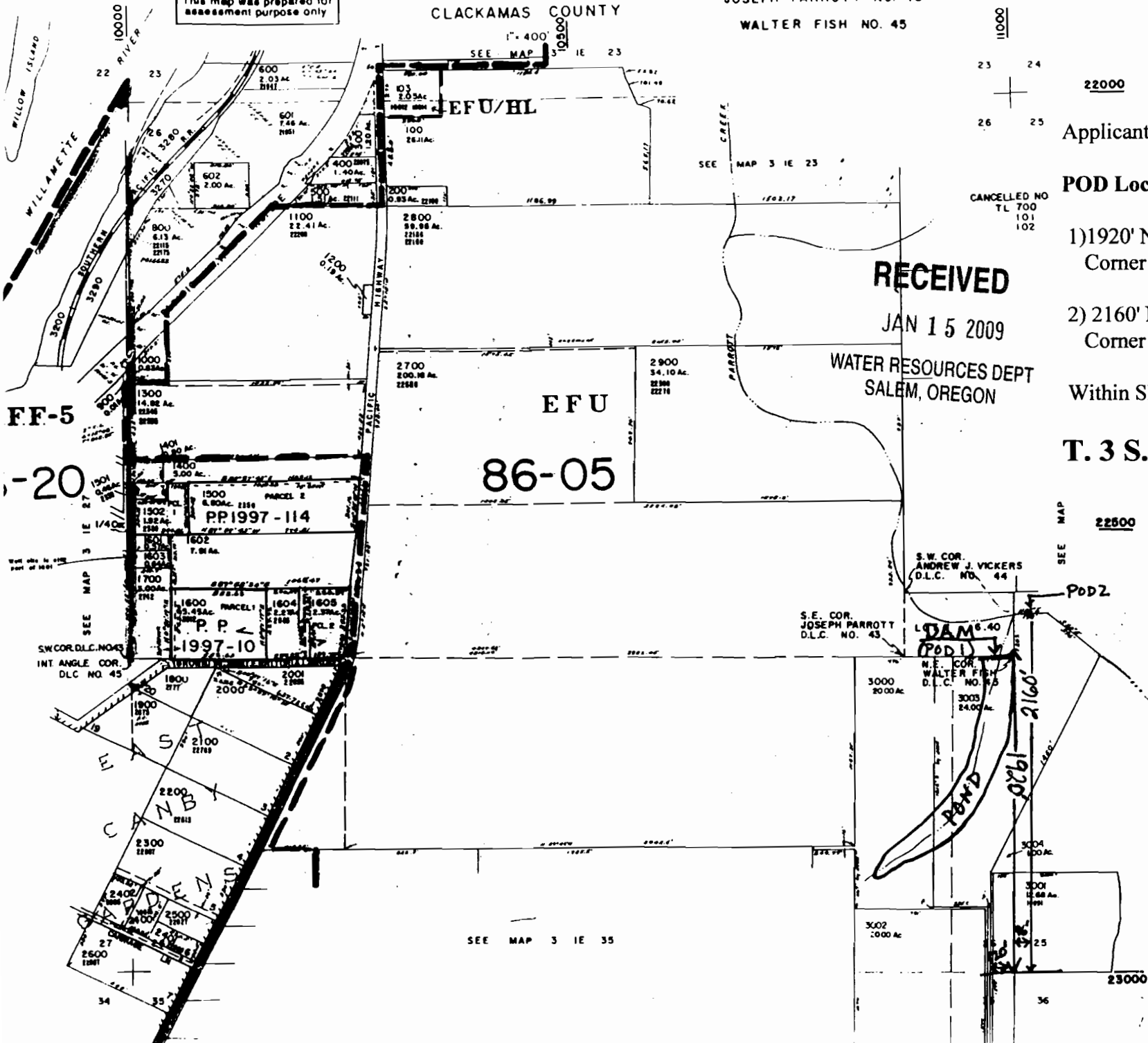

Applicant: Dave OBrist

POD Location:

1) 1920' North and 120' West from the SE Corner of Section 26, T. 3 S., R. 1 E.

2) 2160' North and 96' East from the SE Corner of Section 26, T. 3 S., R. 1 E.

Within SE1/4 SE1/4; Tax Lot 3003

T. 3 S. R. 1 E. Section 26

RECEIVED

JAN 15 2009

WATER RESOURCES DEPT SALEM, OREGON

22500



Scale: 1" = 800'

SEE MAP 3 IE 35

36