



Oregon Water Resources Department 725
 Summer Street NE, Suite A
 Salem Oregon 97301-1271
 (503) 986-0900
 www.wrd.state.or.us

Application for a Permit to Use Ground Water

Please type or print in dark ink. If your application is found to be incomplete or inaccurate, we will return it to you. If any requested information does not apply to your application, insert "n/a." Please read and refer to the instructions when completing your application. A summary of review criteria and procedures that are generally applicable to these applications is available at www.wrd.state.or.us/OWRD/PUBS/forms.shtml.

1. APPLICANT INFORMATION

A. Individuals

Applicant: Brad Lind
First Last

Mailing Address: 1093 Stevens Road
Eagle Point OR 97524
City State Zip

Phone: 541-830-8148 541-830-8148
Home Work Other

*Fax: 541-830-8148 *Email Address: xchusky@aim.com

B. Organizations

(Corporations, associations, firms, partnerships, joint stock companies, cooperatives, public and municipal corporations)

Name of Organization: _____

Name and Title of Person Applying: _____

Mailing Address or Organization: _____
City State Zip

Phone : _____
Day Evening

*Fax: _____ *Email Address: _____

RECEIVED
 JAN 26 2009
 WATER RESOURCES DEPT
 SALEM, OREGON

For Department Use		
App. No. <u>G-17169</u>	Permit No. _____	Date _____

RECEIVED

Last Updated: 11/24/2008

Ground Water/1

JAN 14 2009
 WATER RESOURCES DEPT
 SALEM, OREGON
 WR

2. PROPERTY OWNERSHIP

Yes (Please check appropriate box below then skip to section 3 'Ground Water Development')

- There are no encumbrances
This land is encumbered by easements, rights of way, roads or other encumbrances (please provide a copy of the recorded deed(s))

No (Please check the appropriate box below)

- I have a recorded easement or written authorization permitting access.
I do not currently have written authorization or easement permitting access.

Written authorization or an easement is not necessary, because the only affected lands I do not own are state-owned submersible lands, and this application is for irrigated and/or domestic use only (ORS 274.040).

RECEIVED

JAN 26 2009

WATER RESOURCES DEPT SALEM, OREGON

You must provide the legal description of: (1) the property from which the water is to be diverted, (2) any property crossed by the proposed ditch, canal or other work, and (3) any property on which the water is to be used as depicted on the map.

List the names and mailing addresses of all affected landowners.

[Empty box for listing names and mailing addresses of affected landowners]

3. GROUND WATER DEVELOPMENT

RECEIVED

A. Well Information

Number of well(s): One

Name of nearest surface water body: Little Butte Creek

Distance from well(s) to nearest stream or lake:

- 1) 1.5 Miles 2) 3) 4)

If distance from surface water is less than one mile, indicate elevation difference between nearest surface water and well head:

- 1) 2) 3) 4)

B. Well Characteristics

Wells must be constructed according to standards set by the Department for the construction and maintenance of water wells. If the well is already constructed, please enclose a copy of the well constructor's log and the well ID number, if available, for each well with this application. Identify each well with a number corresponding to the wells designated on the map and proceed to section 4 of the form. If the well has not been constructed, or if you do not have a well log, please complete the following:

Well(s) will be constructed by:

Rogue Valley Drilling , Scott Coffman wwc # 1705

Mailing Address: 3626 Catalpa

White City

City

OR

State

97503

Zip

Completion Date: 12/12/2005

Please provide a description of your well development. (Attach additional sheets if needed.)

Well No.	Diameter	Type and size of casing	No. of feet of casing	Intervals casing is perforated (in feet)	Seal depth	Est. depth to water	Est. depth to water bearing stratum	Type of access port or measuring device	Total well depth
1	10"	6" Steel	+1'- 42'	0	24'	30'			165'
1	4"	4" Plastic	165'	8"		30'			165'

Note: Well numbers in this listing must correspond to well locations(s) shown on accompanying map.
 If well log is not available, or well is not yet constructed, you must provide: proposed total depth, depth of casing and seal, and the anticipated perforation and open intervals.

C. Artesian Flows

If your water well is flowing artesian, describe your water control and conservation works:

4. WATER USE

Please read the instruction booklet for more details on "type of use" definitions, how to express how much water you need and how to identify the water source you propose to use. You must fill out a supplemental form for some uses as they require specific information for that type of use.

A. Type(s) of Use(s)

See list of beneficial uses provided in the instructions.

- If your proposed use is **domestic**, indicate the number of households to be supplied with water: _____
- If your proposed use is **irrigation**, please attach **Form I**
- If your proposed use is **mining**, attach **Form R**
- If your proposed use is **municipal or quasi-municipal**, attach **Form M**
- If your proposed use is **commercial/industrial**, attach **Form Q**

RECEIVED
 JAN 26 2009
 WATER RESOURCES DEPT
 SALEM, OREGON

RECEIVED

JAN 14 2009

WATER RESOURCES DEPT
 SALEM, OREGON

B. Amount of Water

Provide the production rate in gallons per minute (gpm) and the total annual amount of water you need from each well, from each source or aquifer, for each use. You do not need to provide source information if you are submitting a well log with your application.

Well No.	Source or aquifer	Type of use	Total rate of water requested (in gpm)	Total annual quantity (in gallons)	Production rate of well (in gpm)
1	Ground	*Irrigation	9.5	3072000	45
		*Nursery <i>BC</i>			

C. Maximum Rate of Use Requested

What is the maximum, instantaneous rate of water that will be used? 9.5 gpm
 (The fees for your application will be based on this amount.)

D. Period of Use

Indicate the time of year you propose to use the water: 3/1 - 10/31 year round for Nursery
 (For seasonal uses like irrigation give dates when water use would begin and end, e.g. March 1-October 31.) *BC*

E. Acreage

If you will be applying water to land, indicate the total number of acres where water will be applied or used: One
 (This number should be consistent with your application map.)

5. WATER MANAGEMENT

RECEIVED
 JAN 26 2009
 WATER RESOURCES DEPT
 SALEM, OREGON

A. Diversion

What method will you use to divert water from the source?

- Pump (give horsepower and pump type): 4" submersible balanced flow 3 HP
- other means (describe): _____

B. Transport

How will you transport water to your place of use?

- Ditch or canal (give average width and depth):

Width _____ Depth _____

Is the ditch or canal to be lined? Yes No

- Pipe (give diameter and total length):

Diameter 1-1/4", 1", 3/4" & 1/2" Length 290', 675', 720' & 1,825'

- other, describe: _____

RECEIVED

JAN 14 2009

WATER RESOURCES DEPT
 SALEM, OREGON

C. Application/Distribution Method

What equipment will you use to apply water to your place of use?

Electronic irrigation controller, 1" auto valves with pressure regulated drip tubing. pressure compensating drip emitters. Limited hose hand watering.

Irrigation or land application method (check all that apply):

- Flood
- Drip
- Hand Lines
- Siphon tubes or gated pipe with furrows
- other, describe: _____
- High pressure sprinkler
- Water Cannons
- Wheel Lines
- Low pressure sprinkler
- Center pivot system

RECEIVED
JAN 26 2009

Distribution method

- Direct pipe from source
- In-line storage (tank or pond)
- Open Canal

E. Conservation

What methods will you use to conserve water? Why did you choose this distribution or application method? Have you considered other methods to transport, apply, distribute or use water? For example, if you are using sprinkler irrigation rather than drip irrigation, explain. If you need additional space, attach a separate sheet.

Drip is most efficient for conservation. Produce to be grown in raised beds, with mulch top dressing. Nursery Stock to be close spacing, with mate disks in containers. Containers to be placed on landscape fabric with gravel topping.

6. PROJECT SCHEDULE

Indicate the anticipated dates that the following construction tasks should begin. If construction has already begun, or is completed, please indicate that date.

Proposed date construction will begin: 12/2005

Proposed date construction will be completed: 4/2010

Proposed date beneficial water use will begin: 4/2010

7. REMARKS

If you would like to clarify any information you have provided in the application, please do so here and reference the specific application question you are addressing.

1-1/2" double check valve to be in place to prevent ground water contamination

RECEIVED

8. MAP REQUIREMENTS

The Department cannot process your application without accurate information showing the source of water and location of water use. You must include a map with this application form that clearly indicates the township, range, section, and quarter/quarter section of the proposed well location and place of use. The map must provide tax lot numbers. See the map guidelines sheet for detailed map specifications.

9. SIGNATURE

By my signature below I confirm that I understand:

- I am asking to use water specifically as described in this application.
- Evaluation of this application will be based on information provided in the application packet.
- I cannot legally use water until the Water Resources Department issues a permit to me.
- If I get a permit, I must not waste water.
- If development of the water use is not according to the terms of the permit, the permit can be canceled.
- The water use must be compatible with local comprehensive land use plans.
- Even if the Department issues a permit, I may have to stop using water to allow senior water right holders to get water to which they are entitled.

I swear that all information provided in this application is true and correct to the best of my knowledge:



1-6-2009

Signature of Applicant (If more than one applicant, all must sign.)

Date



Before you submit your application be sure you have:

- Answered each question completely.
- Attached a legible map which includes township, range, section, quarter/quarter and tax lot number.
- Included a Land Use Information Form or receipt stub signed by a local official.
- Included the legal description of all the property involved with this application. You may supply a copy of the deed, land sales contract, or title insurance policy, to meet this requirement.
- Included a check payable to the Oregon Water Resources Department for the appropriate amount. The Department's fee schedule can be found at www.wrd.state.or.us or call (503) 986-0900.

RECEIVED
JAN 26 2009

WRD on the web:
www.wrd.state.or.us

RECEIVED

JAN 14 2009

WATER RESOURCES DEPT
SALEM, OREGON



Oregon Water Resources Department

FORM I
FOR IRRIGATION WATER USE

1. Please indicate whether you are requesting a primary or supplemental irrigation water right.

- Primary Supplemental

If supplemental, please indicate the number of acres that will be irrigated for each type of use.

Primary: one Acres

Secondary: _____ Acres

List the permit or certificate number of the primary water right: No. _____

JAN 26 2009
WATER RESOURCES DEPT
SALEM, OREGON

2. Please list the anticipated crops you will grow and whether you will be irrigating them for a full or partial season:

1. * Nursery Stock (Containers) Full season Partial season (from: 3/1 to 10/31)

2. Vegetable \ Produce Full season Partial season (from: 3/1 to 10/31)

3. *Nursery Stock (limited use, Freeze Protection) Full season Partial season (from: 12/1 to 2/29)

4. _____ Full season Partial season (from: _____ to _____)

3. Indicate the maximum total number of acre-feet you expect to use in an irrigation season:

_____ 10.6 _____ acre-feet

(1 acre-foot equals 12 inches of water spread over 1 acre, or 43,560 cubic feet, or 325,851 gallons.)

4. How will you schedule your applications of water? Will you be applying water in the evenings, twice a week, daily?

- | | |
|---|--|
| <input type="checkbox"/> Daily during daytime hours | <input type="checkbox"/> Daily during nighttime hours |
| <input type="checkbox"/> Two or three times weekly during daytime | <input checked="" type="checkbox"/> Two or three times weekly during nighttime |
| <input type="checkbox"/> Weekly, during daytime hours | <input type="checkbox"/> Weekly, during nighttime hours |
| <input type="checkbox"/> Other, explain: _____ | |

RECEIVED
JAN 14 2009
WATER RESOURCES DEPT
SALEM, OREGON

G-77169

0000000000

Receipt for Request for Land Use Information

Applicant name: Brad Lind

City or County: Jackson Staff contact: Tracie Nickel

Signature: Tracie Nickel Phone: 774-6951 Date: 12/8/08

RECEIVED

JAN 14 2009

WATER RESOURCES DEPT
SALEM, OREGON

For Local Government Use Only

The following section must be completed by a planning official from each county and city listed unless the project will be located entirely within the city limits. In that case, only the city planning agency must complete this form. This deals only with the local land-use plan. Do not include approval for activities such as building or grading permits.

Please check the appropriate box below and provide the requested information

Land uses to be served by proposed water uses (including proposed construction) are allowed outright or are not regulated by your comprehensive plan. Cite applicable ordinance section(s): 1, 2, 1.

Land uses to be served by proposed water uses (including proposed construction) involve discretionary land-use approvals as listed in the table below. (Please attach documentation of applicable land-use approvals which have already been obtained. Record of Action/land-use decision and accompanying findings are sufficient.)

If approvals have been obtained but all appeal periods have not ended, check "Being pursued".

Type of Land-Use Approval Needed (e.g. plan amendments, rezones, conditional-use permits, etc.)	Cite Most Significant, Applicable Plan Policies & Ordinance Section References	Land-Use Approval:	
		<input type="checkbox"/> Obtained <input type="checkbox"/> Denied	<input type="checkbox"/> Being pursued <input type="checkbox"/> Not being pursued
		<input type="checkbox"/> Obtained <input type="checkbox"/> Denied	<input type="checkbox"/> Being pursued <input type="checkbox"/> Not being pursued
		<input type="checkbox"/> Obtained <input type="checkbox"/> Denied	<input type="checkbox"/> Being pursued <input type="checkbox"/> Not being pursued
		<input type="checkbox"/> Obtained <input type="checkbox"/> Denied	<input type="checkbox"/> Being pursued <input type="checkbox"/> Not being pursued
		<input type="checkbox"/> Obtained <input type="checkbox"/> Denied	<input type="checkbox"/> Being pursued <input type="checkbox"/> Not being pursued

Local governments are invited to express special land-use concerns or make recommendations to the Water Resources Department regarding this proposed use of water below, or on a separate sheet.

Name: Saura Marshall Title: Planning Tech II
 Signature: Saura Marshall Phone: 541-774-6950 Date: 1/6/09
 Government Entity: Jackson Co. Development Services

Note to local government representative: Please complete this form or sign the receipt below and return it to the applicant. If you sign the receipt, you will have 30 days from the Water Resources Department's notice date to return the completed Land Use Information Form or WRD may presume the land use associated with the proposed use of water is compatible with local comprehensive plans.

RECEIVED

Receipt for Request for Land Use Information

JAN 14 2009

Applicant name: _____ WATER RESOURCES DEPT
 SALEM, OREGON

City or County: _____ Staff contact: _____
 Signature: _____ Phone: _____ Date: _____



Oregon Water Resources Department Land Use Information Form

THIS FORM IS NOT REQUIRED IF: 1) water is to be diverted, conveyed, and/or used only on federal lands; or 2) the application is for a water-right transfer, allocation of conserved water, exchange, permit amendment, or ground water registration modification, and all of the following apply: a) only the place of use is proposed for change, b) there are no structural changes, c) the use of water is for irrigation, and d) the use is located in an irrigation district or exclusive farm-use zone.

Applicant Name: Brad Lind
 Mailing Address: 1093 Stevens Road
 City: Eagle Point State: OR Zip: 97524 Day Phone: 541-830-8148

This application is related to a Measure 37 claim. Yes No

A. Land and Location

Please include the following information for all tax lots where water will be diverted (taken from its source), conveyed (transported), or used. Applicants for municipal use, or irrigation uses within irrigation districts may substitute existing and proposed service-area boundaries for the tax-lot information requested below.

Township	Range	Section	¼ ¼	Tax Lot #	Plan Designation (e.g. Rural Residential/RR-5)	Water to be:			Proposed Land Use:
36	1W	027	NW	500	RT / PC400	<input type="checkbox"/> Diverted	<input type="checkbox"/> Conveyed	<input checked="" type="checkbox"/> Used	
						<input type="checkbox"/> Diverted	<input type="checkbox"/> Conveyed	<input type="checkbox"/> Used	
						<input type="checkbox"/> Diverted	<input type="checkbox"/> Conveyed	<input type="checkbox"/> Used	
						<input type="checkbox"/> Diverted	<input type="checkbox"/> Conveyed	<input type="checkbox"/> Used	

List all counties and cities where water is proposed to be diverted, conveyed, or used. SACKSON

B. Description of Proposed Use

Type of application to be filed with the Water Resources Department:

- Permit to Use or Store Water
 Water-Right Transfer
 Exchange of Water
 Allocation of Conserved Water
 Limited Water Use License
 Permit Amendment or Ground Water Registration Modification

Source of water: Reservoir/Pond Ground Water Surface Water (name) _____

Estimated quantity of water needed: 9.5 cubic feet per second gallons per minute acre-feet

Intended use of water: Irrigation Commercial Industrial Domestic for _____ household(s)
 Municipal Quasi-municipal Instream Other _____

Briefly describe: Nursery stock & Produce

Note to applicant: *If the Land Use Information Form cannot be completed while you wait, please have a local government representative sign the receipt below and include it with the application filed with the Water Resources Department.*

Receipt for Request for Land Use Information

State of Oregon Water
Resources Department
725 Summer Street NE, Suite A
Salem, OR 97301-1266

RECEIVED

JAN 14 2009

WATER RESOURCES DEPT
SALEM, OREGON



G-77169

01/06/2009

APPLICATION TYPE: LUC (Land Use Compatibility Statement)

CASE STATUS: **Received**

DECISION:

USE CATEGORY: **Farm Uses**

ZONE USE ID:

ZONING: **EFU**

APPLICATION NO: **ZON2008-02134**

PROCESS: **Type 1**

MASTER NO: **ZON2008-02134**

SITE ADDRESS: **1093 STEVENS RD**

PROJECT NO: **ZON2008-02134**

PRIMARY PARCEL NUMBER: **36-1W-02D-500**

RECEIVED DATE: **12/08/2008**

ASSOCIATED LOTS:

ASSIGNED STAFF: **TLN**

People Associated With This Case

LIND BRADFORD W
1093 STEVENS RD
EAGLE POINT, OR 97524

Case Description

LUC water rights

COMMENTS:

12/8/08...WATER RIGHTS LUC FOR FARM USE. FARM USE AS DEFINED BY ORS 215-203 IS A TYPE 1 OUTRIGHT PERMITTED USE IN THE EFU ZONE. THIS LUC IS APPROVED FOR FARM USE...TN

1/6/2009: OWNER IN TO SUBMIT LUC DOCS SHOWING WATER QUANTITY. LM

ATTACHED DOCUMENTS:

Document: LUC SIGN-OFF SHEET.PDF

This decision is limited to the County's review of applicable zoning rules and land use law, as outlined in the Jackson County Comprehensive Plan, the Jackson County Land Development Ordinance, and the Oregon Administrative Rules and Revised Statutes relating to land use. Other County, State, and Federal agencies may have regulatory review authority for development projects. The decision rendered herein neither implies nor guarantees compliance with the requirements of any other regulatory agency. It is the applicant's responsibility to ensure compliance with the requirements of any other regulatory agency or provisions of law prior to initiating development.

Date:

1-6-09

JAN 26 2009

RECEIVED

JAN 14 2009

WATER RESOURCES DEPT
SALEM, OREGON

EXHIBIT A

PARCEL 1

Lot 4, EAGLE HEIGHTS FRUIT FARMS, in Jackson County, Oregon, according to the Official Plat thereof now of record. EXCEPTING THEREFROM the following: Commencing at the Quarter corner common to Sections 1 and 2, Township 36 South, Range 1 West, Willamette Meridian, Jackson County, Oregon; thence West, along the North boundary of EAGLE HEIGHTS FRUIT FARMS, in Jackson County, Oregon, 2624.00 feet, to the Northwest corner of Lot 4, said Eagle Heights Fruit Farms; thence South, 330 feet, along the West boundary of said Lot 4, to the true point of beginning; thence continue South, on the West boundary of said Lot 4, a distance of 330 feet, to the North boundary of Stevens (County) Road; thence East, along the North boundary of said Stevens Road, 300 feet; thence North, parallel with the West boundary of said Lot 4, a distance of 330 feet; thence West, parallel with the North boundary of said Eagle Heights Fruit Farms, 300 feet to the true point of beginning. ALSO EXCEPTING THEREFROM the following: Commencing at the Quarter corner common to Sections 1 and 2, Township 36 South, Range 1 West, Willamette Meridian, Jackson County, Oregon; thence West, along the North boundary of Eagle Heights Fruit Farms, in Jackson County, Oregon, 2624.00 feet, to the Northwest corner of Lot 4, said Eagle Heights Fruit Farms; thence South, along the West boundary of said Lot, 330.00 feet; thence continue South, along the West boundary of Lot 4, a distance of 300.18 feet, to the North boundary of Stevens (County) Road; thence East, along the North boundary of said Stevens Road, 300.00 feet; thence continue along the North boundary of said Stevens Road, 67 feet, to the true point of beginning; thence along said North boundary of said Stevens Road, 210 feet; thence North, parallel with the West boundary of said Lot 4, a distance of 210 feet; thence West, parallel with the North boundary of said Eagle Heights Fruit Farms, 210 feet; thence South, parallel with the West boundary of said Lot 4, a distance of 210 feet, to the true point of beginning.

PARCEL 2

Commencing at the Quarter corner common to Sections 1 and 2, Township 36 South, Range 1 West, Willamette Meridian, Jackson County, Oregon; thence West, along the North boundary of Eagle Heights Fruit Farms, in Jackson County, Oregon, 2624.00 feet, to the Northwest corner of Lot 4, said Eagle Heights Fruit Farms; thence South, along the West boundary of said lot, 330.00 feet; thence continue South, along the West boundary of Lot 4, a distance of 300.18 feet, to the North boundary of Stevens (County) Road; thence East, along the North boundary of said Stevens Road, 300.00 feet; thence continue along the North boundary of said Stevens Road, 67 feet, to the true point of beginning; thence along said North boundary of said Stevens Road, 210 feet; thence North, parallel with the West boundary of said Lot 4, a distance of 210 feet; thence West, parallel with the North boundary of said Eagle Heights Fruit Farms, 210 feet; thence South, parallel with the West boundary of said Lot 4, a distance of 210 feet, to the true point of beginning.

RECEIVED
JAN 26 2009
WATER RESOURCES DEPT
SALEM, OREGON

6-7769

Navigation				
Account Sequence	Map TL Sequence	Assessment Year 2008	Print Window	Close Window

Assessment Info for Account 1-023883-4 Map 361W02D Taxlot 500
 Report For Assessment Purposes Only Created December 07, 2008

Account Info		Tax Year 2008 Info			Land Info	
Account	1-023883-4	Tax Report	Details		Tax Code	9-16
Map Taxlot	361W02D 500	Tax Code 9-16			Acreage	6.24
Owner	LIND BRADFORD W	Tax Type	Due Date	Amount	Zoning	
Situs Address	STEVENS RD EAGLE POINT/COUNTY R	Advalorem	11/15/08	\$353.39	EFU	
Mailing Address	LIND BRADFORD W 1093 STEVENS RD EAGLE POINT OR, 97524	Tax Rate	10.1851		Land Class	
Associated Taxlots	1 Acct	District Rates	Details		RT 6.24 Ac	
9-03 R	1-077799-0 361W02D 700 ACTIVE	District Amounts	Details		Property Class	400
Appraiser	64	Tax Rate Sheet	Details		Stat Class	000
					Unit ID	129202-2
					Maintenance Area	1
					Neighborhood	000
					Study Area	02
					Account Status	ACTIVE
					Tax Status	Assessable
					Sub Type	NORMAL

Sales Data (ORCATS)			
Last Sale	Sale Date	Instrument Number	Sales History
\$ 0	Sep 13, 2005	2005-58345	Details

+ Value Summary Detail (For Assessment Year 2008)

- Market Value Summary (For Assessment Year 2008)

Code Area	Type	Acreage	RMV	M5	MAV	AV
9-16	LAND	6.24	\$ 131,220	\$ 131,220	\$ 32,670	\$ 32,670
Value History Details			Total:	\$ 131,220	\$ 131,220	\$ 32,670

Improvements

- Account Comments

(1) CREATE SEG TL 706 -1.01 ACRES (2) ACREAGE CHECK -.54 ACRES (3) REMAP <<< 8-3-05 CORRECTED THE 2004 TREND TABLES THAT WERE INCORRECT FOR THE PERIOD 2-05 THROUGH 8-05 PER #23 >>>

- Exemptions / Special Assessments / Notations / Potential Liability

Real Property Special Assessments				
Tax Year Applied	Code	Description	Amount	Acres
2008	41	FIRE PATROL GRAZING	\$20.64	6.24
Notations				
Description	Tax Amount	Year Added	Value Amount	
STATE FIRE PROTECTION		2006		

- Location Map

RECEIVED
 JAN 26 2009
 WATER RESOURCES DEPT
 SALEM, OREGON

RECEIVED
 JAN 14 2009
 WATER RESOURCES DEPT
 SALEM, OREGON

Tax lot # 500

Close Window

Print Window

Property Class	Description	SAL Group
400	VACANT H&B USE TRACT LAND, ZONING NOT SIGNIFICANT	4

Close Window

Print Window

Type #1 Land use

RECEIVED
 JAN 26 2009
 WATER RESOURCES DEPT
 SALEM, OREGON

RECEIVED
 JAN 14 2009
 WATER RESOURCES DEPT
 SALEM, OREGON

Eagle point
Municipal water supply

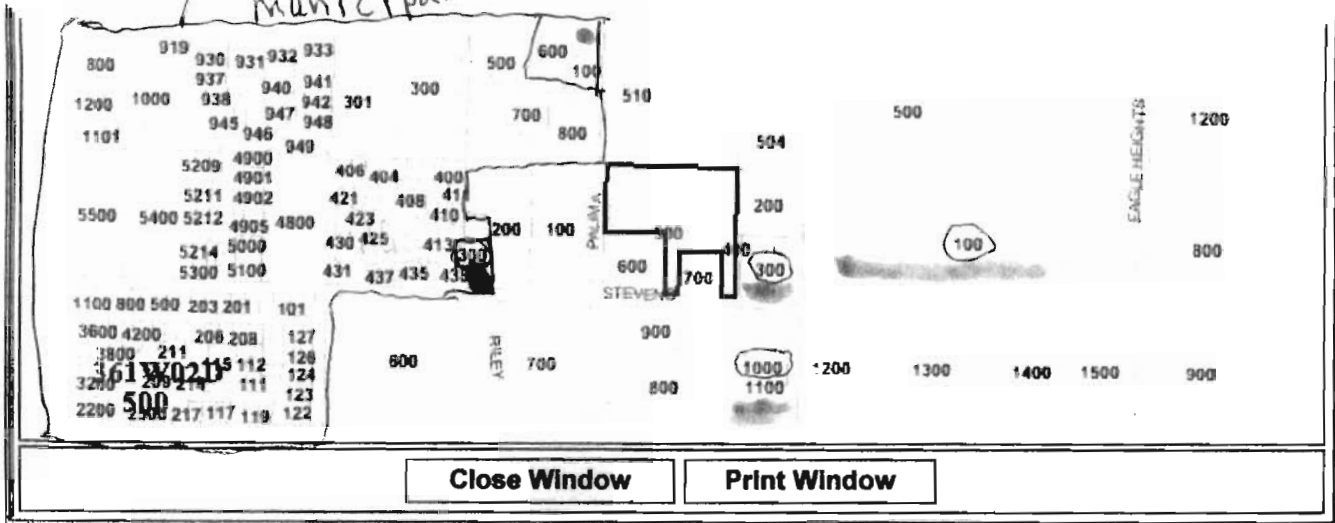

○ = medford municipal water supply

RECEIVED
JAN 26 2009
WATER RESOURCES DEPT
SALEM, OREGON

RECEIVED
JAN 14 2009
WATER RESOURCES DEPT
SALEM, OREGON

6-17169

FOR WATER RESOURCES DEPARTMENT USE ONLY

Date Postmarked _____
Date Hand-Delivered _____
Date Region Office Rec'd _____

W 176628
OWRD Receipt _____
Date Fee Received _____
Check No. _____

START CARD

NOTICE OF BEGINNING OF WELL CONSTRUCTION
(as required by ORS 537.762)

This form must be completed and the original mailed or delivered to the Water Resources Department, 725 Summer Street NE Suite A, Salem OR 97301-1271 for all new construction, conversion, alteration, deepening and abandonments. This original must be mailed or delivered before work is commenced. A \$125 fee shall accompany the original for all new well construction, conversion, and deepenings (make checks payable to the Water Resources Department). In addition, the constructor shall provide a legible copy of this notice to the region office within which the well is being constructed, converted, altered, deepened, or abandoned using one of the following methods: (a) by regular mail no later than three (3) calendar days (72 hours) prior to commencement of work; (b) by hand delivery, during regular office hours before work is commenced; or (c) by FAX before work is commenced. If method (c) is used, a legible copy of the start card shall also be mailed or delivered to the region office no later than the day work is commenced. The Water Resources Commission has authority to impose civil penalties for failure to submit the required \$125 fee with the start card, for failure to submit the \$125 fee in a timely manner, and for failure to timely submit start cards.

Owner's name and mailing address: BRAD LIND
Home Phone: (541) 830-8148 1093 STEVENS RD
Work Phone: (541) 830-8148 EAGLE POINT OR 97524

Type of work: Fee New Construction No Fee Alteration (Repair/Recondition)
Required: Conversion Required: Abandonment Orig. Start
 Deepening Orig. Start Card No. _____

Proposed Commencement Date: Dec 8 05

Existing or Proposed Well Depth: 150' Diameter: 6" Original Well I.D. Label Number: _____

Use: Domestic Community (Public System) Industrial Irrigation
 Thermal Injection Monitoring Other _____

Proposed Well Location:
County JACKSON Township 36 Range 1W Section 2D Tax Lot 500
1/4 NW 1/4 NW Or Latitude _____ Longitude _____

Street Address of well, if not assigned, nearest address:
1093 STEVENS Rd EAGLE POINT OR 97524

We have read the back of this form and the information provided is accurate to the best of our knowledge.

Owner/Agent Name _____ Bonded Water Supply/Monitor Well Constructor Name Boque Valley Drilling License No. 172
Date Signed _____ Company _____ Date Signed Dec 6 05

OWNER PLEASE NOTE: This is not a water right application. The owner is responsible for obtaining a water right through the Water Resources Department, if required. The Oregon Health Division requires plans to be submitted and approved prior to construction if the well is to be used as a public system.

ADDITIONAL IMPORTANT INFORMATION ON BACK.

RECEIVED

JAN 26 2009

WATER RESOURCES DEPT
SALEM, OREGON

RECEIVED

JAN 14 2009

WATER RESOURCES DEPT
SALEM, OREGON

STATE OF OREGON
WATER SUPPLY WELL REPORT
 (as required by ORS 537.765)

Instructions for completing this report are on the last page of this form.

617169
 WELL I.D. #1. 79105
 START CARD # 176628

(1) LAND OWNER - Well Number _____
 Name Brad Lind
 Address 1093 Stevens Rd
 City Eagle Point State OR Zip 97524

(2) TYPE OF WORK
 New Well Deepening Alteration (repair/recondition) Abandonment

(3) DRILL METHOD:
 Rotary Air Rotary Mud Cable Auger
 Other _____

(4) PROPOSED USE:
 Domestic Community Industrial Irrigation
 Thermal Injection Livestock Other _____

(5) BORE HOLE CONSTRUCTION:
 Special Construction approval Yes No Depth of Completed Well 165 ft.
 Explosives used Yes No Type _____ Amount _____

HOLE		SEAL			
Diameter	From To	Material	From To	Sacks or pounds	
10"	0	24' Bentonite	0	24	12 Sacks
6"	24'	165'			

How was seal placed: Method A B C D E
 Other Bentonite poured Dry
 Backfill placed from _____ ft. to _____ ft. Material _____
 Gravel placed from _____ ft. to _____ ft. Size of gravel _____

(6) CASING/LINER:

Diameter	From To	Gauge	Steel	Plastic	Welded	Threaded
Casing: 6"	0	42	250	<input checked="" type="checkbox"/>	<input type="checkbox"/>	<input type="checkbox"/>
Liner: 4"	0	165	160	<input type="checkbox"/>	<input checked="" type="checkbox"/>	<input type="checkbox"/>

Drive Shoe used Inside Outside None
 Final location of shoe(s) 42

(7) PERFORATIONS/SCREENS:

Perforations Method SAW
 Screens Type _____ Material _____

From	To	Slot size	Number	Diameter	Tele/pipe size	Casing	Liner
40'	165'	1/8"	24	4"	160	<input type="checkbox"/>	<input checked="" type="checkbox"/>

(8) WELL TESTS: Minimum testing time is 1 hour

Yield gal/min	Drawdown	Drill stem at	Time
45 gpm			1 hr.

Temperature of water 52.0 Depth Artesian Flow Found _____
 Was a water analysis done? Yes By whom _____
 Did any strata contain water not suitable for intended use? Too little
 Salty Muddy Odor Colored Other _____
 Depth of strata: _____

(9) LOCATION OF WELL by legal description:
 County Jackson Latitude _____ Longitude _____
 Township 36 N or S Range 1W E or W. WM.
 Section 20 NW 1/4 NW 1/4
 Tax Lot 500 Lot _____ Block _____ Subdivision _____
 Street Address of Well (or nearest address) 1093 Stevens Rd

(10) STATIC WATER LEVEL:
30' ft. below land surface. Date Dec 12, 05
 Artesian pressure _____ lb. per square inch Date _____

(11) WATER BEARING ZONES:
 Depth at which water was first found _____

From	To	Estimated Flow Rate	SWL
50'	52'	3.9 gpm	30'
153'	155'	42.9 gpm	30'

(12) WELL LOG:
 Ground Elevation _____

Material	From	To	SWL
Soil (Brown)	0'	3'	
Clay (Brown)	3'	12'	
Clay/Stone (Yellow)	12'	18'	
Clay Stone (Blue)	18'	26'	
Clay Stone (Grey)	26'	5.2'	30'
Clay Stone (Blue)	5.2'	165'	30'

Date started Dec 8, 05 Completed Dec 12, 05

(unbonded) Water Well Constructor Certification:
 I certify that the work I performed on the construction, alteration, or abandonment of this well is in compliance with Oregon water supply well construction standards. Materials used and information reported above are true to the best of my knowledge and belief.
 Signed Scott Coffey WWC Number 1705 Date Dec 12, 05

(bonded) Water Well Constructor Certification:
 I accept responsibility for the construction, alteration, or abandonment work performed on this well during the construction dates reported above. All work performed during this time is in compliance with Oregon water supply well construction standards. This report is true to the best of my knowledge and belief.
 Signed Jack N. Baertlein WWC Number 172 Date Dec 12, 05

