

November 29, 1994

JAMES L WALISER
RT 2 BOX 357B
MILTON-FREEWATER OR 97862

re: GR-2822

Dear Mr. Waliser,

This will acknowledge the receipt of your letter received on November 23, 1994, copy of a water well report and a map prepared by David L. Haddock. I will add this information to the file on GR-2822.

If you have any questions, please give me a call.

Sincerely,



Don Knauer
Adjudication Specialist



Commerce Building
158 12th Street NE
Salem, OR 97310-0210
(503) 378-3739
FAX (503) 378-8130

NOV 2 1984

To: Oregon Water Resources Dept.
Water Rights Division
158 12th ST. NE
Salem, OR 97310

To Whom it may concern:

This letter is to inform you that as of September 7, 1984, I have replaced my old well (certificate of registration # GR 2822 located in the SW, NW sec 33, T6N 2E) with a new well. The new well is located 125 feet from the old well. I am enclosing a copy of the new well's log to show that I believe the new source remains within the same aquifer as the old well. I am aware that use of the new well must adhere to the stipulations governing certificate of registration # 2822. When, upon completion of adjudication process (if approved will formally perfect the well's registration) I will file the proper papers for a point of diversion transfer allowed me under Oregon State Water Law.

Sincerely,

James J. Walser

OF OREGON
WELL REPORT
regulated by ORS 537.785)

PLEASE PRINT

NOV 7 1994

START CARD 63012 (For official use only)

OWNER: Jim Weliser
Address RT 2 Box 357-B
City Milton Freewater State Oregon

(2) TYPE OF WORK (check): 97862

New Well Deepening Reconditioning Abandon
If abandonment, describe material and procedure in Item 12.

(3) TYPE OF WELL: (4) PROPOSED USE (check):

Rotary Air Driven Domestic Industrial Municipal
Rotary Mud Dug Irrigation Thermal: Withdrawal ReInjection
Cable Bored Other Piezometric Grounding Test

(5) CASING INSTALLED: Steel Plastic
Threaded Welded
10 Diam. from 1 ft. to 30 ft. Gauge 0250
Diam. from _____ ft. to _____ ft. Gauge _____

LINER INSTALLED: Steel Plastic
Threaded Welded
8 Diam. from -22 ft. to 180 ft. Gauge SCH 40

(6) PERFORATIONS: Perforated? Yes No liner
Size of perforations _____ in. by _____ in.
6.72 perforations from 120 ft. to 182 ft.
perforations from _____ ft. to _____ ft.
perforations from _____ ft. to _____ ft.

(7) SCREENS: Well screen installed? Yes No
Manufacturer's Name _____ Model No. _____
Type _____ Diam. _____ Slot Size _____ Set from _____ ft. to _____ ft.
Diam. _____ Slot Size _____ Set from _____ ft. to _____ ft.

(8) WELL TESTS: Drawdown is amount water level is lowered below static level
Was a pump test made? Yes No If yes, by whom?
Yield: _____ gal./min. with _____ ft. drawdown after _____ hrs.
Air test 300 gal./min. with drill stem at 180 ft. 2 hrs.
Bailer test _____ gal./min. with _____ ft. drawdown after _____ hrs.
Artesian flow _____ g.p.m.
Temperature of water 54 Depth artesian flow encountered _____ ft.

(9) CONSTRUCTION: Special standards: Yes No
Well seal—Material used Bentinite
Well sealed from land surface to 29 ft.
Diameter of well bore to bottom of seal 1.5 1/4 in.
Diameter of well bore below seal 10 in.
Amount of sealing material 32 sacks pounds
How was cement grout placed? _____

Was pump installed? NO Type _____ HP _____ Depth _____ ft.
Was a drive shoe used? Yes No Plugs _____ Size: location _____ ft.
Did any strata contain unusable water? Yes No
Type of Water? _____ depth of strata _____
Method of sealing strata off _____
Was well gravel packed? Yes No Size of gravel: _____
Gravel placed from _____ ft. to _____ ft.

(10) LOCATION OF WELL by legal description:
County Umatilla SW 1/4 NW of Section 33 of
Township 6 NORTH, Range 35 East, W.M.
(Township is North or South) (Range is East or West)
Tax Lot _____ Lot _____ Block _____ Subdivision _____
MAILING ADDRESS OF WELL (or nearest address) County Road

(11) WATER LEVEL of COMPLETED WELL:
Depth at which water was first found 68 ft.
Static level 50 ft. below land surface. Date 9-7-94
Artesian pressure _____ lbs. per square inch. Date _____

(12) WELL LOG: Diameter of well below casing 10"
Depth drilled 192 ft. Depth of completed well 182 ft.
Formation: Describe color, texture, grain size and structure of materials; and show thickness and nature of each stratum and aquifer penetrated, with at least one entry for each change of formation. Report each change in position of Static Water Level and indicate principal water-bearing strata.

MATERIAL	From	To	SWL
Brown silt & Gravel	0	2	
Tan silt & Builders	2	12	
Loose Gravel Brown silt	12	16	
Brown silt cemented Gravel	16	22	
Tan silt cemented Gravel	22	68	
Brown silt cemented Gravel	68	128	50
Grey cemented Gravel			
Clean water bearing	128	180	50
Brown silt loose Gravel	180	192	50

Date work started 8-30-94 /completed 9-7-94
Date well drilling machine moved off of well 9-7 1994

(unbonded) Water Well Constructor Certification (if applicable):
This well was constructed under my direct supervision. Materials used and information reported above are true to my best knowledge and belief.

(Signed) _____ Date _____, 19 _____

(bonded) Water Well Constructor Certification:
Bond _____ Issued by: Aetna
(number) (Surety Company Name)
On behalf of Pro-Drill Inc
(type or print name of Water Well Constructor)

This well was drilled under my jurisdiction and this report is true to the best of my knowledge and belief:

(Signed) [Signature]
(Dated) 9-7-94
(Water Well Constructor)

T. 6N., R. 35E., W.M.

NOTE:

The information shown on this map is solely for Water Rights purposes. The data shown does not represent ownership information.



0 1320

Scale: 1"=1320'

N.W. Cor.
Sec. 33

R3

IP

Present Use
24.8 acres orchard
Pleasant View
Irrigation District
22 acres - 0.28 cfs
Permit GR 2822
Supplemental Well
to 25 acres - 350 gpm

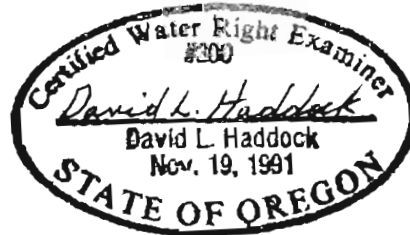
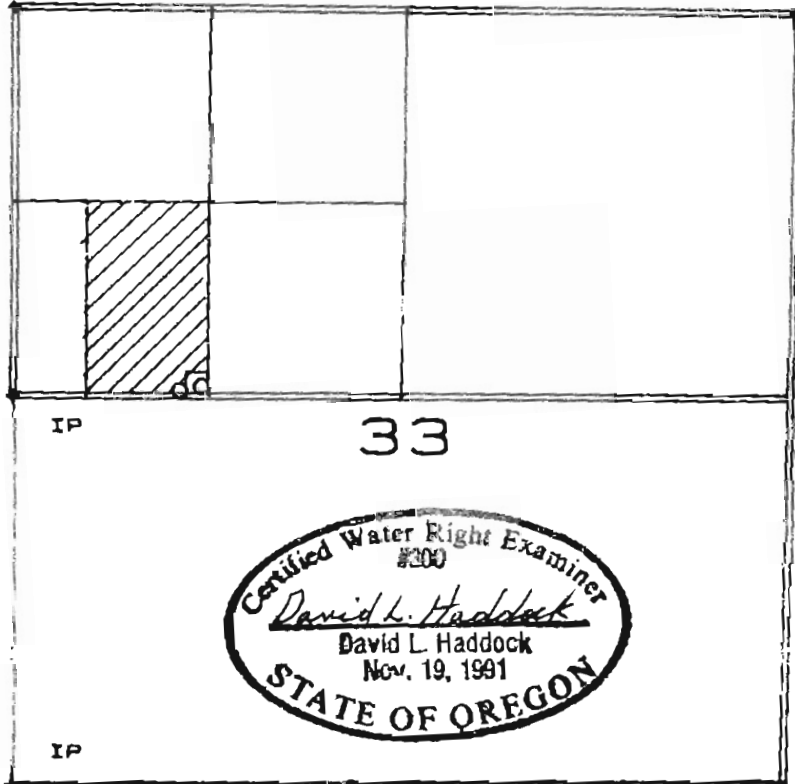

Old well 2608' S. and 1289' E. of N. W. Cor. Sec. 33
New well 2640' S. and 1139' E. of N. W. Cor. Sec. 33

Application No.
Permit. No. GR 2822
In Name of: S. Dunlap
Present Owner:
James Waliser
Route 2, Box 357B
Milton-Freswater, OR 97862
(503) 938-3149

Survey By:
CWRE 300
(renews 6-30-95)
David Haddock
P. O. Box 1574
Pendleton, OR 97801
(503) 276-2193
Date: September, 1994

GR-3015

October 24, 1994

WATER
RESOURCES
DEPARTMENT

JAMES L WALISER
RT 2, BOX 357-B
MILTON-FREEWATER OR 97862

Dear Mr. Waliser,

The Department has received your Application for Transfer of Water Right. Unfortunately, we cannot accept your application.

ORS 540.510 states that the owner of a "certificated" water right may transfer it. Because Groundwater Registrations (GR's) are claims only, and not certificated rights, they cannot be transferred.

Another option you may consider is to submit a new Application for a Permit to Appropriate Groundwater for irrigation from your new well. If you choose to do this, be sure to indicate in your application that you are not relinquishing any rights that may exist under your Groundwater Registration. This would allow you to legally use your new well, and you would retain the tentative priority date of your Groundwater Registration.

Your application, supporting data and check no. 10449 in the amount of \$85.00 are being returned. Also enclosed are permit application materials. Please feel free to contact the Water Rights Information Group at 378-3739 if you have any questions.

Sincerely,

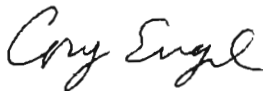

Mr. Cory C. Engel
Water Rights Research Assistant

enclosures

cc: general correspondence
Fiscal
CWRE: David Haddock



Commerce Building
158 12th Street NE
Salem, OR 97310-0210
(503) 378-3739
FAX (503) 378-8130

RECEIVED

OCT 24 1994

WATER RESOURCES DEPT.
SALEM, OREGON

State of Oregon
WATER RESOURCES DEPARTMENT
APPLICATION FOR TRANSFER OF WATER RIGHT

Applicant: James L. Waliser

Mailing Address: Rt 2 Box 357B

Hilton-Freewater Oregon 97862 (503) 938-3149
City or Town State Zip Phone

Type of Change: In location of well.
(In point of diversion; place of use; use heretofore made of the water)

1. WATER RIGHT

A) Is the water right in your name? No If not, list name below:
(Yes, No)

S. Dunlap

B) Was the water right determined by a court decree? No
(Yes, No)

1. If yes, list the title of the proceedings: _____

2. Case No. _____

C) Was the water right acquired by a water permit? Yes
(Yes, No)

1. If yes, list the Permit No. OP 2002

2. Case No. _____

D) Date of priority right: Prior to 1927

E) What are your reasons for the proposed changes? The existing well is being converted to domestic use only. The new well will replace the old well as a supplementary irrigation water source for 24.5 acres of orchard.

F) The water will be completely applied to the proposed use on or before: September, 1994.

2. LOCATION OF AUTHORIZED USE

A) What is the source of the water (river, stream, well)? A well supplementary to water from the Pleasant Hill Irrigation Co.

B) State the exact location of the source. A well located as described below.

Location of Reference to Survey Data: 1/4 Sec 14 of Section 17, T14N, R12E, S10E
1808' E. and 1235' E. of a railroad spine SE1/4 SW1/4 NW1/4 CO SN SEE
at the NE corner of Section 13.

RECEIVED

OCT 24 1994

WATER RESOURCES DEPT.
SALEM, OREGON

C) What is the name of the ditch used? N/A

D) What is the use to which the water is applied? Orchard Irrigation and temperature control.

E) Give the location of the authorized area irrigated or place of use other than for irrigation:

Township	Range	Section	1/4, 1/4 of Section	No. of acres irrigated
6N	35E	33	SW1/4 NW1/4	24.8 acres

F) Is the land within an irrigation district? No

If Yes, which district? _____

G) County Umatilla

3. LOCATION OF PROPOSED USE:

NOTE: Answer question A only if the application is for a change in the point of diversion.

A) Describe the proposed point of diversion: A new well located as described below.

Location or Reference to Survey Corner	1/4, 1/4 of Section	Section	Township	Range
1640' S. and 1195' E. of a railroad spike at the N.W. Cor. of Section 33.	SE1/4 SW1/4 NW1/4	33	6N	35E

NOTE: Answer questions B, C, D, and E only if the application is for a change in use or place of use.

B) Are the lands free which you propose to transfer your water right free of all encumbrances? Yes

C) If no, give the description below of existing encumbrances:

Encumbrance	Held By	Amount

D) What is the use to which the water will be applied? _____

E) Give the location of the area to be irrigated, or place of use if other than irrigation:

Township	Range	Section	1/4, 1/4 of Section	No. of acres irrigated

RECEIVED

OCT 24 1994

WATER
SALES

4. EXHIBITS

The following exhibits shall be attached to and made a part of the applications:

- A) A map prepared by a Certified Water Right Examiner showing the location of the present and proposed points of diversion, the authorized and proposed places of use and, if any, lands from the existing right that would not be subject to transfer.
- B) A copy of the current recorded deed to the subject lands.
- C) Affidavits from any other landowners or encumbrance holders with interest in the original water right stating that they have no objection to the proposed transfer.
- D) Evidence that the water has been used within the last five years.

5. NAME AND ADDRESS OF RECEIVING LANDOWNER(S) IF OTHER THAN APPLICANT:

6. REMARKS: _____

I, _____ applicant(s), hereby

swear that I/we have read the above application for transfer of water right and that the statements made

are true and correct. Dated and signed this 21st day of Oct, 1994.

STATE OF OREGON
County of Umatilla

James J. Waliser
Signature

[Signature]
Signature

Subscribed and sworn before me by James J. Waliser

Debbie Miller
Notary Public for Oregon

Notarial Seal.

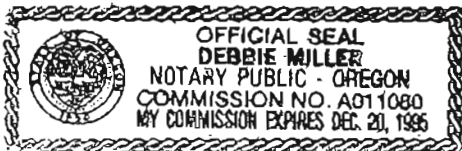

Commission expires: 12-20-95

RECEIVED

OCT 24 1994

T. 6N., R. 35E., W.M.

WATER RESOURCES DEPT.
SALEM, OREGON

NOTE:
The information shown on this map is solely for Water Rights purposes. The data shown does not represent ownership information.

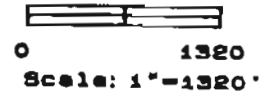

N.W. Cor.
Sec. 33

RS

IP

Present Use
24.8 acres orchard
Pleasant View
Irrigation District
22 acres - 0.26 cfs
Permit GR 2822
Supplemental Well
to 25 acres - 350 gpm

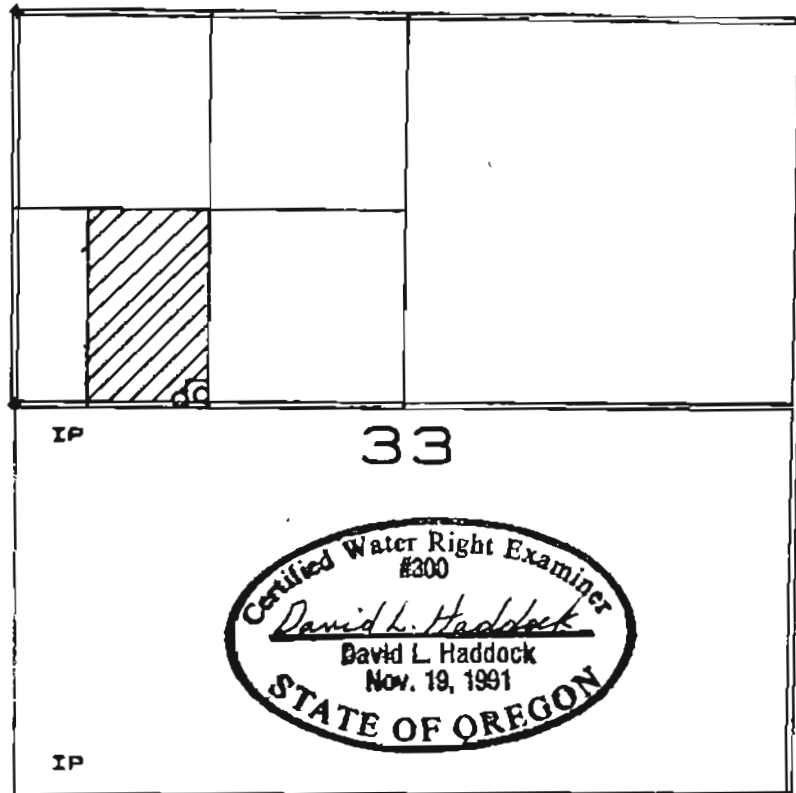

Certified Water Right Examiner
#300
David L. Haddock
David L. Haddock
Nov. 19, 1991
STATE OF OREGON

Old well 2608' S. and 1289' E. of N. W. Cor. Sec. 33
New well 2640' S. and 1139' E. of N. W. Cor. Sec. 33

Application No.
Permit. No. GR 2822
In Name of: S. Dunlap
Present Owner:
James Waliser
Route 2, Box 357B
Milton-Freewater, OR 97862
(503) 938-3149

Survey By:
CWRE 300
(renews 6-30-95)
David Haddock
P. O. Box 1574
Pendleton, OR 97801
(503) 278-2193
Date: September, 1994

STATE OF OREGON
WATER WELL REPORT
 (as required by ORS 537.765)

OCT 24 1994

PLEASE TYPE OR PRINT IN INK

Start Card 63013 (for official use only)

(1) OWNER:

Name Jim Waliser
 Address RT 2 Box 226
 City Milton Freewater State Oregon

(2) TYPE OF WORK (check):

New Well Deepening Reconditioning Abandon
 If abandonment, describe material and procedure in Item 12.

(3) TYPE OF WELL:

Rotary Air Driven
 Rotary Mud Dug
 Cable Bored

(4) PROPOSED USE (check):

Domestic Industrial Municipal
 Thermal: Irrigation Withdrawal ReInjection
 Other: Piezometric Grounding Test

(5) CASING INSTALLED:

Steel Plastic
 Threaded Welded
10 Diam. from +1 ft. to 30 ft. Gauge 0250

LINER INSTALLED:

Steel Plastic
 Threaded Welded
8 Diam. from -22 ft. to 180 ft. Gauge SCH 40

(6) PERFORATIONS:

Parforated? Yes No liner
 Size of perforations in. by in.
6.72 perforations from 120 ft. to 182 ft.

(7) SCREENS:

Well screen installed? Yes No
 Manufacturer's Name _____ Type _____ Model No. _____
 Diam. _____ Slot Size _____ Set from _____ ft. to _____ ft.

(8) WELL TESTS:

Drawdown is amount water level is lowered below static level
 Was a pump test made? Yes No If yes, by whom?
 Yield: _____ gal./min. with _____ ft. drawdown after _____ hrs.
 Air test 300 gal./min. with drill stem at 180 ft. 2 hrs.
 Bailer test _____ gal./min. with _____ ft. drawdown after _____ hrs.
 Artesian flow _____ g.p.m.
 Temperature of water 54 Depth artesian flow encountered _____ ft.

(9) CONSTRUCTION:

Special standards: Yes No
 Well seal—Material used Ben Brite
 Well sealed from land surface to 29 ft.
 Diameter of well bore to bottom of seal 1.574 in.
 Diameter of well bore below seal 10 in.
 Amount of sealing material 32 sacks pounds
 How was cement grout placed? _____

Was pump installed? NO Type _____ HP _____ Depth _____ ft.
 Was a drive shoe used? Yes No Plugs _____ Size: location _____ ft.
 Did any strata contain unusable water? Yes No
 Type of Water? _____ depth of strata _____
 Method of sealing strata off _____
 Was well gravel packed? Yes No Size of gravel: _____
 Gravel placed from _____ ft. to _____ ft.

(10) LOCATION OF WELL by legal description:

County Umatilla SW 1/4 NW 1/4 of Section 33 of
 Township 6 North Range 35 East WM.
 (Township is North or South) (Range is East or West)
 Tax Lot _____ Lot _____ Block _____ Subdivision _____
 MAILING ADDRESS OF WELL (or nearest address) County Road

(11) WATER LEVEL of COMPLETED WELL:

Depth at which water was first found 68 ft.
 Static level 50 ft. below land surface. Date 9-7-94
 Artesian pressure _____ lbs. per square inch. Date _____

(12) WELL LOG:

Diameter of well below casing 10"
 Depth drilled 142 ft. Depth of completed well 182 ft.
 Formation: Describe color, texture, grain size and structure of materials; and show thickness and nature of each stratum and aquifer penetrated, with at least one entry for each change of formation. Report each change in position of Static Water Level and indicate principal water-bearing strata.

MATERIAL	From	To	SWL
Brown Soil + Gravel	0	2	
Tan Silt + Boulders	2	12	
Loose Gravel Brown Silt	12	16	
Brown Silt Cemented Gravel	16	22	
Tan Silt Cemented Gravel	22	68	
Brown Silt Cemented Gravel	68	128	50
Grey cemented Gravel			
Clear water Bearing	128	180	50
Brown Silt Large Gravel	180	192	50

Date work started 8-30-94 / completed 9-7-94
 Date well drilling machine moved off of well 9-7 19 94

(unbonded) Water Well Constructor Certification (if applicable):

This well was constructed under my direct supervision. Materials used and information reported above are true to my best knowledge and belief.

(Signed) _____ Date _____, 19 _____

(bonded) Water Well Constructor Certification:

Bond _____ Issued by: Aetna
 (number) (Surety Company Name)
 On behalf of Mr. Drill Etc
 (type or print name of Water Well Constructor)

This well was drilled under my jurisdiction and this report is true to the best of my knowledge and belief:

(Signed) [Signature]
 (Water Well Constructor)

(Dated) 9-7-94

NOTICE TO WATER WELL CONSTRUCTOR

The original and first copy of this report are to be filed with the

WATER RESOURCES DEPARTMENT,
 SALEM, OREGON 97310

within 30 days from the date of well completion.

SP-4696-689D

MINNICK, HAHNER & TUTTLE

LAWYERS

JONES BUILDING

WALLA WALLA, WASHINGTON

W. L. MINNICK
H. H. HAHNER
JOHN C. TUTTLE

P. O. BOX 218
JACKSON 5-5800

November 10, 1960

State Engineer
Water Resources Department
State of Oregon
Salem, Oregon

Gentlemen:

Would you kindly send us your form of assignment so that we can effect the assignment of registration number GR-3015, Certificate of Registration No. GR-2822 from John V. and Helen L. Jones to LaVerne A. Siverling, the new purchaser.

Very truly yours,

MINNICK, HAHNER & TUTTLE



By H. H. Hahner

*Mailed
11-14-60*

HHH: dee

#3015

August 19, 1960

John V. and Helen L. Jones
P. O. Box 244
College Place, Washington

Dear Sir and Madam:

This will acknowledge receipt of an assignment of Registration No. GR-3015, Certificate of Registration No. GR-2822 from Joe Mathews to John V. and Helen L. Jones, together with the statutory recording fee of \$1.00, for which our receipt No. 26568 is enclosed.

The assignment has been recorded in Miscellaneous Records of the State Engineer and is enclosed.

Very truly yours,

LEWIS A. STANLEY
State Engineer

By
Wm. S. Bartholomew
Geologist

WSB:mb
enc

GR-3015

June 30, 1959

Joe Mathews
Rt. 2, Box 60
Milton-Freewater, Oregon

Dear Sir:

GR-3015

GR-2822

GR-3015

August 8, 1958

Joe Mathews
Rt. 2, Box 60
Milton-Freewater, Oregon

Dear Mr. Mathews:

15.00

18734

3015