

Application Map for a Permit to Store Water in a Reservoir

R-187496

Richard D. Stephens
Stephens Upper Pond

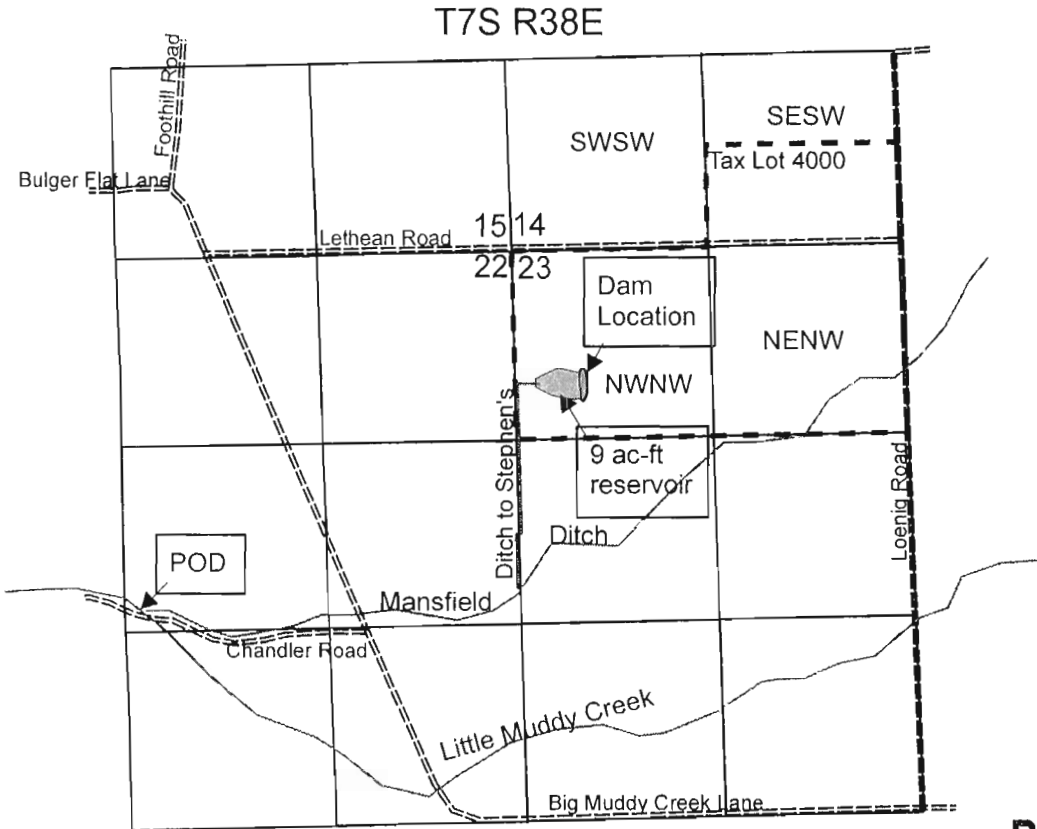

RECEIVED

FEB 27 2009

WATER RESOURCES DEPT
SALEM, OREGON

POD: Mansfield Ditch POD on Little Muddy Creek is
2470' South and 2540' West from the NE Corner Section 22

Dam Location: 910' South and 650' East from NW Corner, Section 33

