

Application Map for a Permit to Store Water in a Reservoir

Richard D. Stephens
Stephens Lower Pond

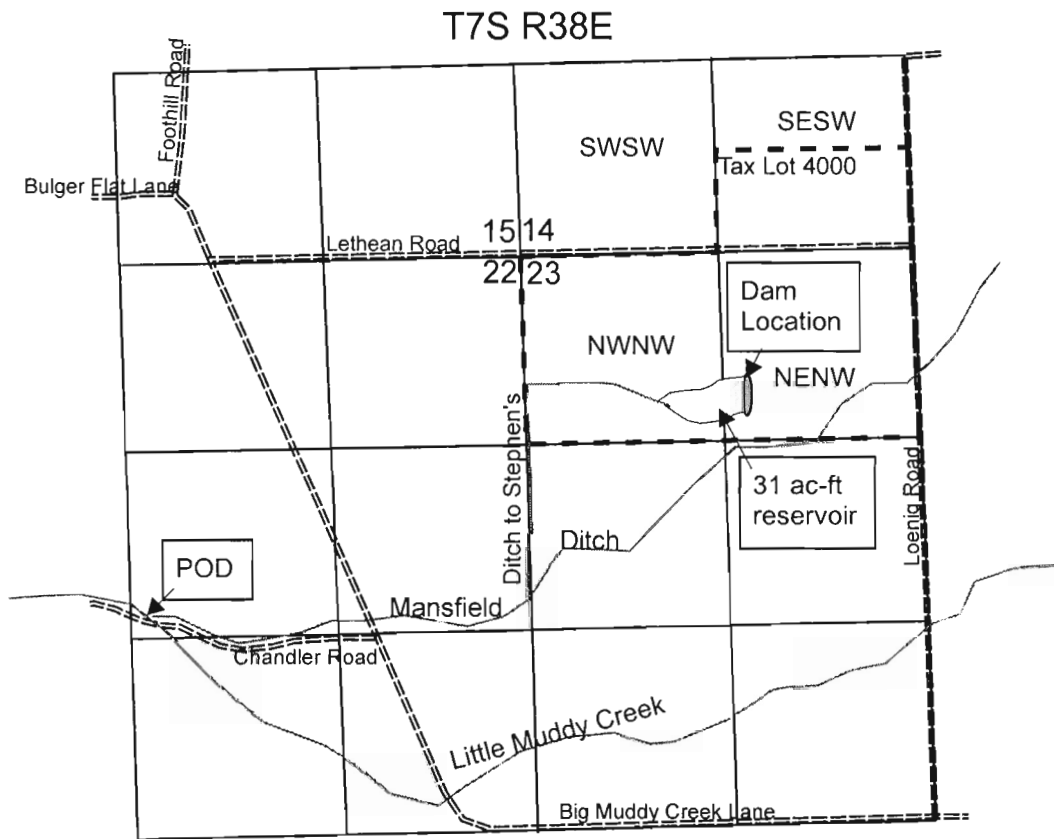

POD: Mansfield Ditch POD on Little Muddy Creek is 2470' South and 2540' West from the NE Corner Section 22

Dam Location: 1600' South and 1520' East from NW Corner, Section 33

RECEIVED

FEB 27 2009

WATER RESOURCES DEPT
SALEM, OREGON

3/23/09

center of dam appears to be approx. 1000' south of

nw corner, section 23.

will get clarification from applicant.

-yvana eastman

