

T.5S., R.3W., W.M.

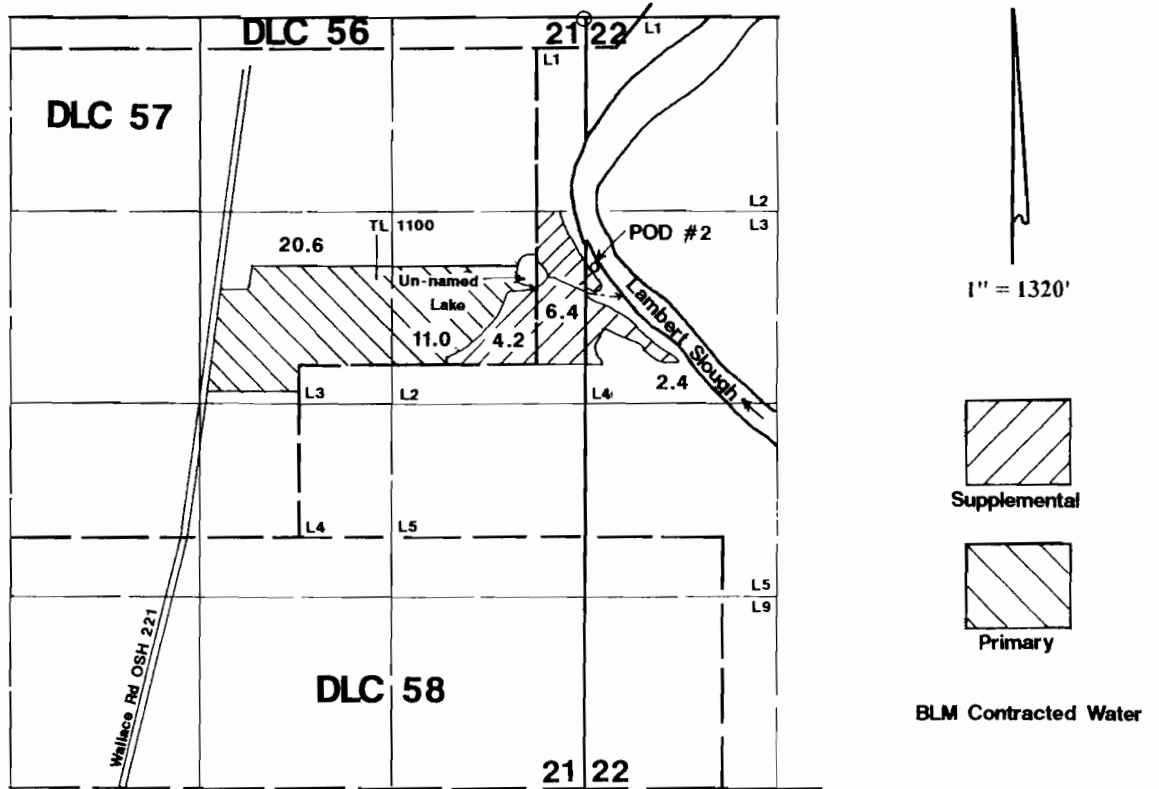

POD #2 is located 1700' S & 65' E from the NE corner Section 21.

Application Map

Juan Ramirez-Mora

Application #:

Permit #:

This Map was Prepared for the Purpose of Identifying the Location of a Water Right Only and is Not Intended to Provide Legal Dimensions or Location of Property Ownership Lines

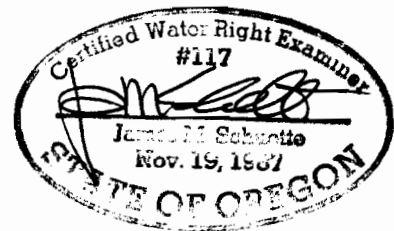

T. 5S. R. 3W. W.M.

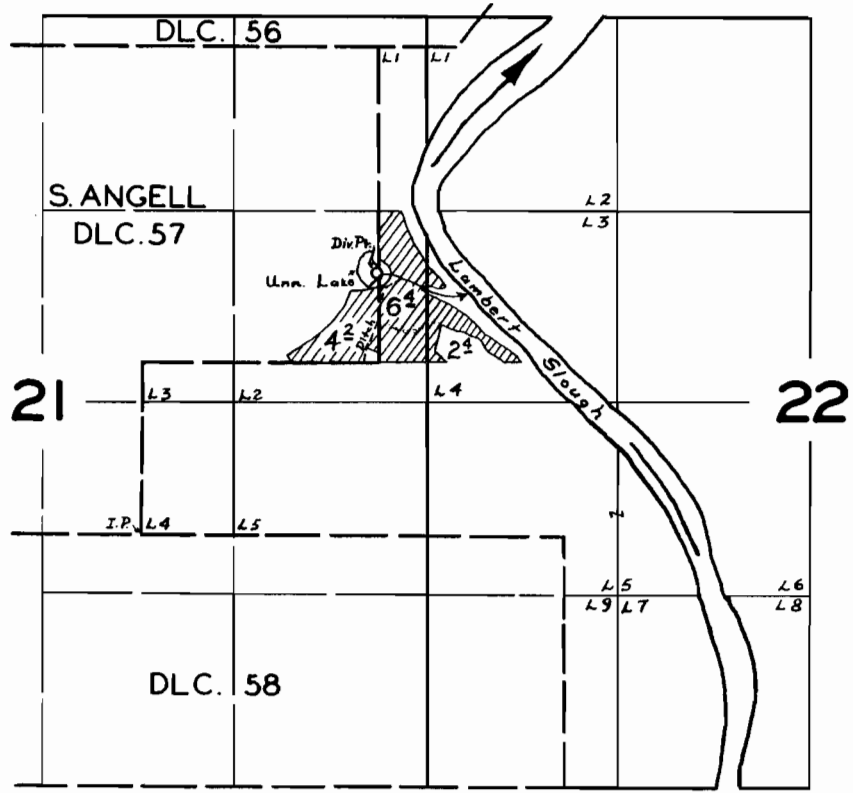

FINAL PROOF SURVEY UNDER

Application No. **25290** Permit No. **21233**
IN NAME OF

HAROLD L. STOUTENBERG

Surveyed **APR. 2**, 1958, by *m. Bish*