

12-87459

Robin Olterman Alternate Reservoir Application Map T.14S.R.32E. Sec 01

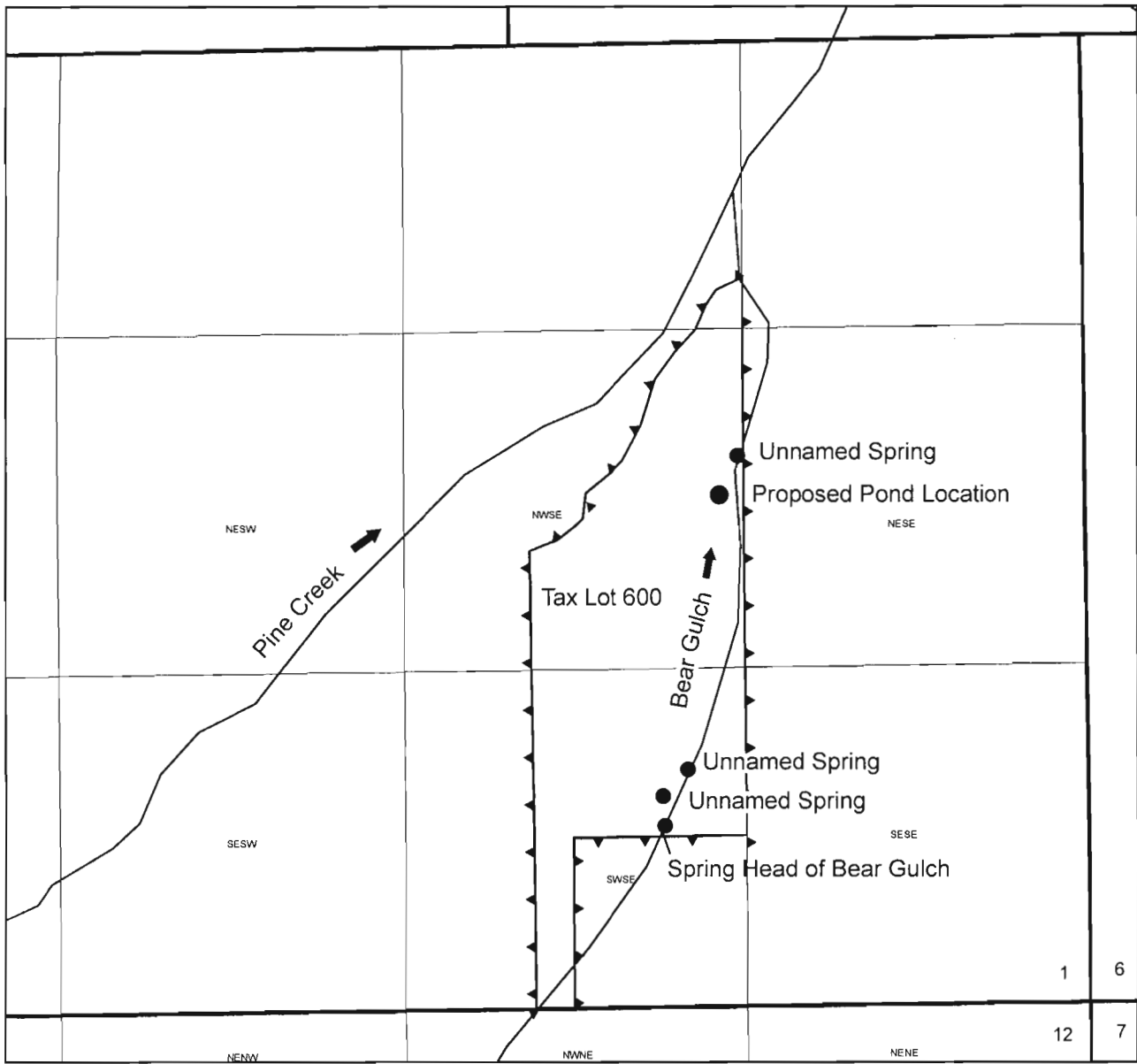

Pond is located approximately 1905' N and 1400' W of the SE section corner of section 1, T.14S.R.32E W.M.
Being within the NWSE of section 1, T14S.R.32E. W.M.



1 inch = 660 feet

RECEIVED
MAY 26 2009
WATER RESOURCES DEPT
SALEM, OREGON

R-87459

Robin Olterman Alternate Reservoir Application Map T.14S.R.32E. Sec 01

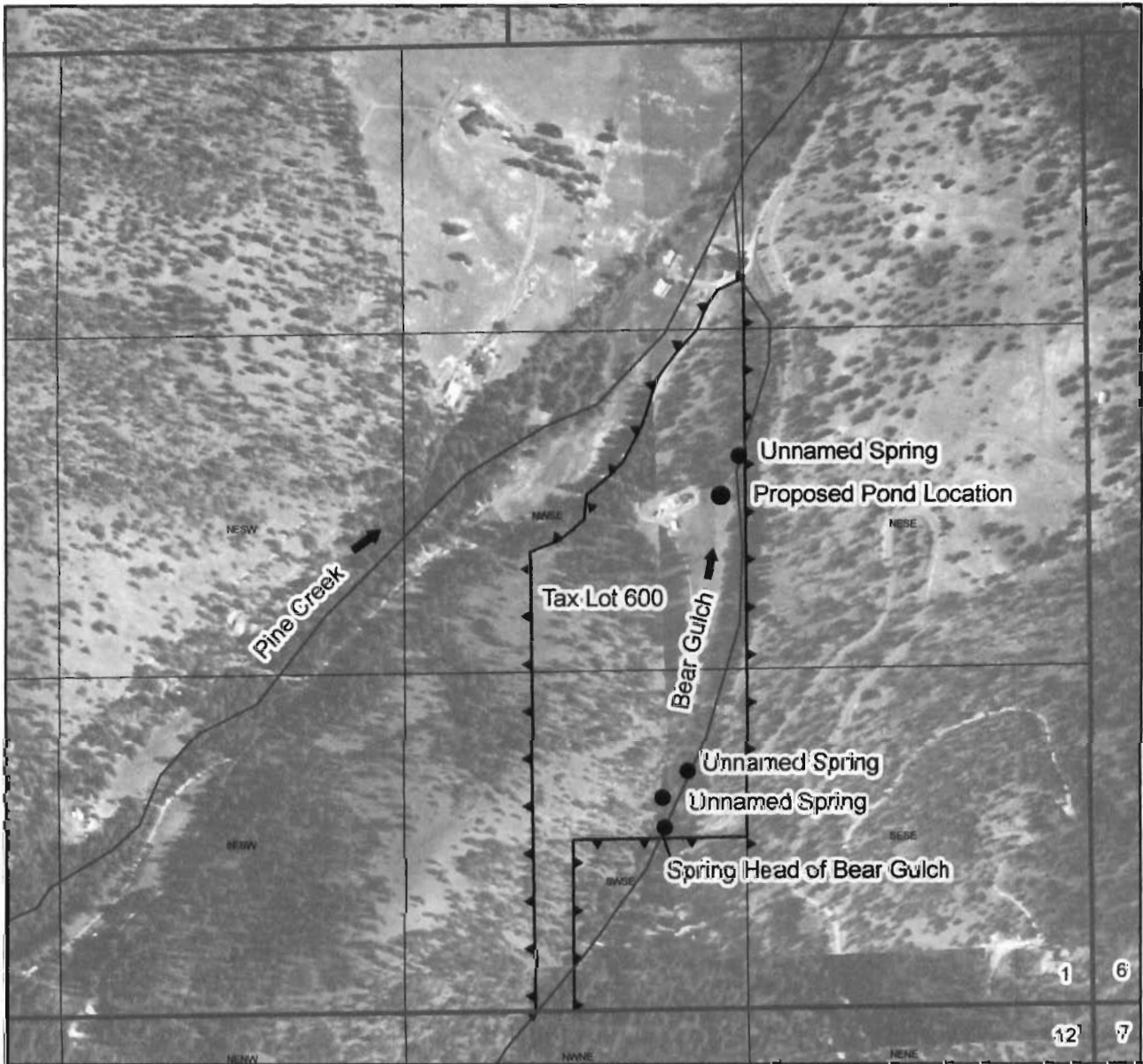

Pond is located approximately 1905' N and 1400' W of the SE section corner of section 1, T.14S.R.32E W.M. Being within the NWSE of section 1, T14S.R.32E. W.M.

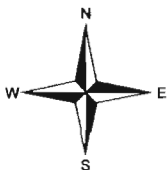

1 inch = 660 feet

RECEIVED

MAY 28 2009

WATER RESOURCES DEPT
SALEM, OREGON