

T5S, R1E, Section 7 & 18, WM Clackamas County, Oregon Application Map

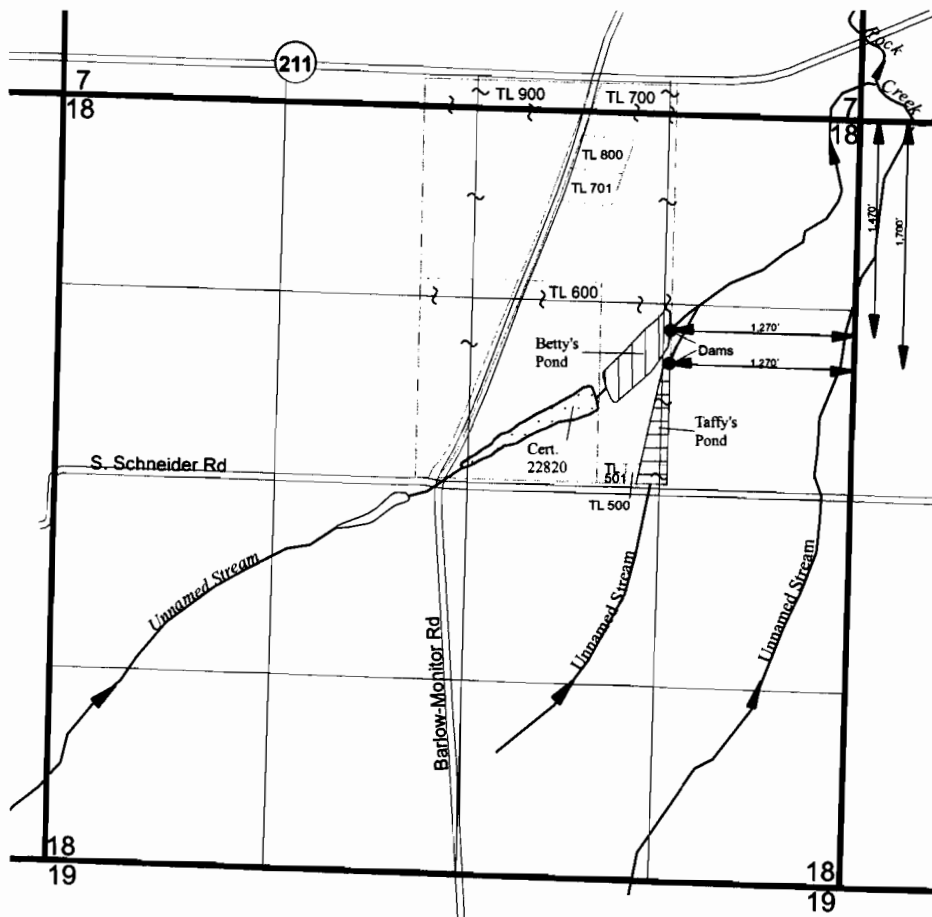

Proposed Places of Use

- Dam
- Betty's Pond-
Proposed Place of Use
(13.0 acre-feet)
- Taffy's Pond-
Proposed Place of Use
(11.0 acre-feet)

Existing Certificate

- Certificate 22820

RECEIVED
JUN 30 2009
WATER RESOURCES DIV
SALEM OREGON



1 inch = 1,320 feet

THIS MAP IS NOT INTENDED TO
PROVIDE LEGAL DIMENSIONS OR
LOCATIONS OF PROPERTY
OWNERSHIP LINES.

FIGURE 1

June 24, 2009