

DETAIL MAP FOR:

Tom Harrison

LOCATION:

T.35S., R.1W., W.M., SECTION 20 AND 29  
Jackson County, Oregon

PREPARED BY:

Gary D. Kaiser  
19440 Hwy. 62  
Eagle Point, OR. 97524

DATE:

June 16, 2009



SCALE: 1" = 100'

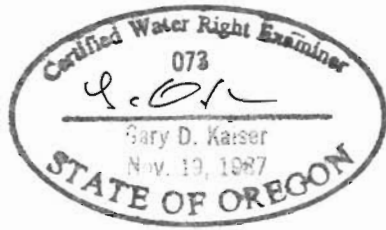

*G. D. Kaiser*

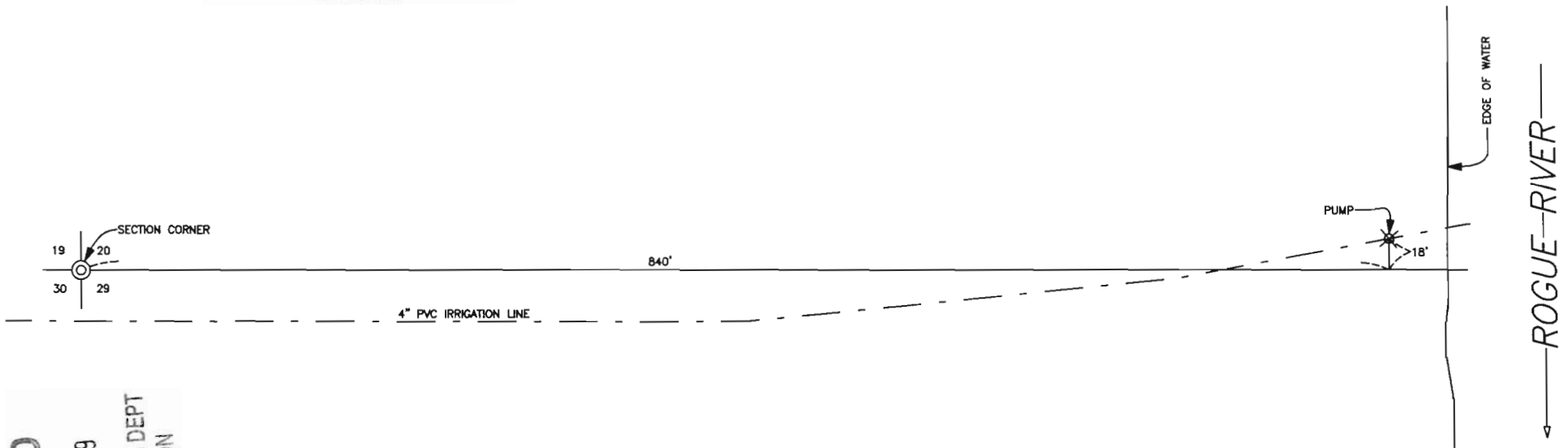
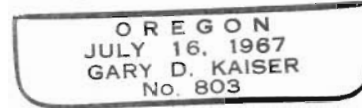

RECEIVED

JUL 02 2009

WATER RESOURCES DEPT  
SALEM, OREGON

ROGUE RIVER

Sht 8-S

RECEIVED

JUL 02 2009

WATER RESOURCES DEPT  
SALEM, OREGON



SCALE 1" = 400'

APPLICANT:

Edward T. & Kendall Harrison  
13334 MODOC ROAD  
Central Point, OR. 97502

T.35S., R.1W., W.M.

Jackson County, Oregon  
Tax Lot No. 351W 30 - 215  
and

Tax Lot No. 351W 29 - 302 & 303

PREPARED BY:

Gary D. Kaiser  
19440 HWY. 62  
Eagle Point, OR. 97524

June 16, 2009

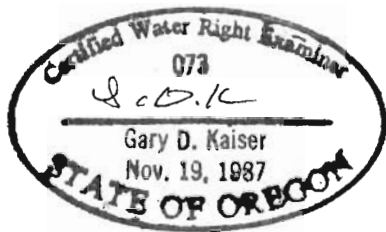

NOTE: MAP PREPARED FOR  
WATER RIGHT PURPOSES ONLY,  
NOT FOR PROPERTY BOUNDARY  
LOCATIONS.



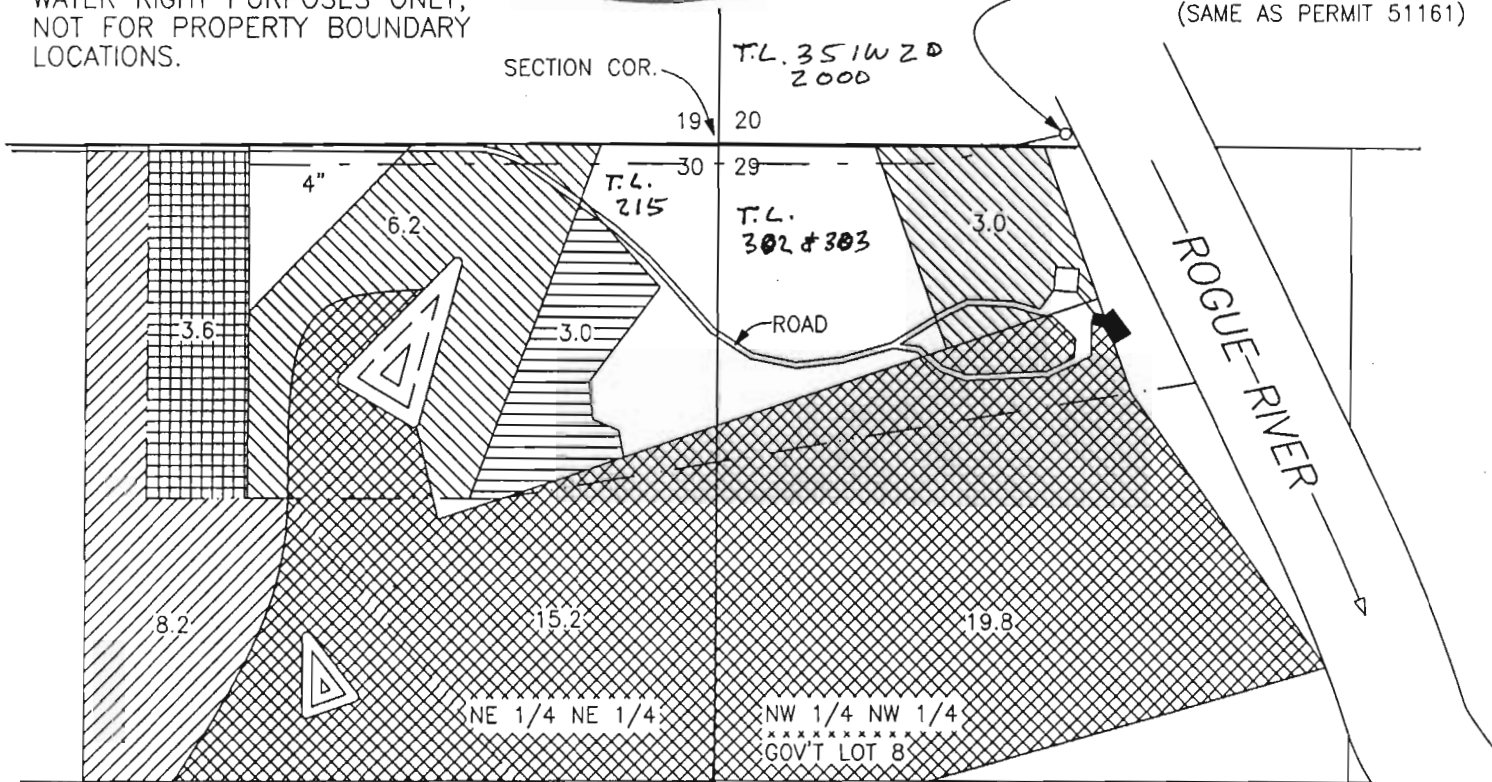

RE-DIVERSION POINT  
NORTH, 18' AND EAST 840'  
FROM THE NW COR. SEC. 29  
(SAME AS PERMIT 51161)

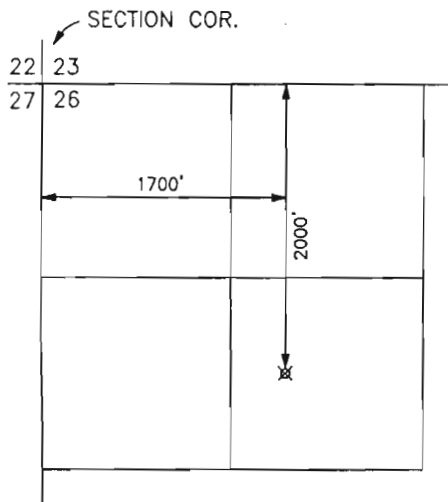

MAP TO ACCOMPANY AN APPLICATION TO USE  
SURFACE WATER (LOST CREEK RESERVOIR WATER)



LOST CREEK RESERVOIR  
POINT OF DIVERSION  
T.33S., R.1E., W.M.  
SCALE 1" = 1320'

-  = PERMIT NO. 51161 IN THE NAME OF JIM AND LAURA SESMA, CURRENT OWNER HARRISON
-  = PERMIT NO. 51161 IN THE NAME OF CARPENTER, CURRENT OWNER HARRISON
-  = PERMIT NO. 51161 IN THE NAMES OF CARPENTER AND MEDFORD READY MIX
-  = PERMIT NO. 40004
-  = AREA REQUESTING A NEW WATER RIGHT. LOST CREEK RESERVOIR WATER