

# SECTION PLAT

Section 9 Township 24-S Range 30-E

County of Harney State of OR

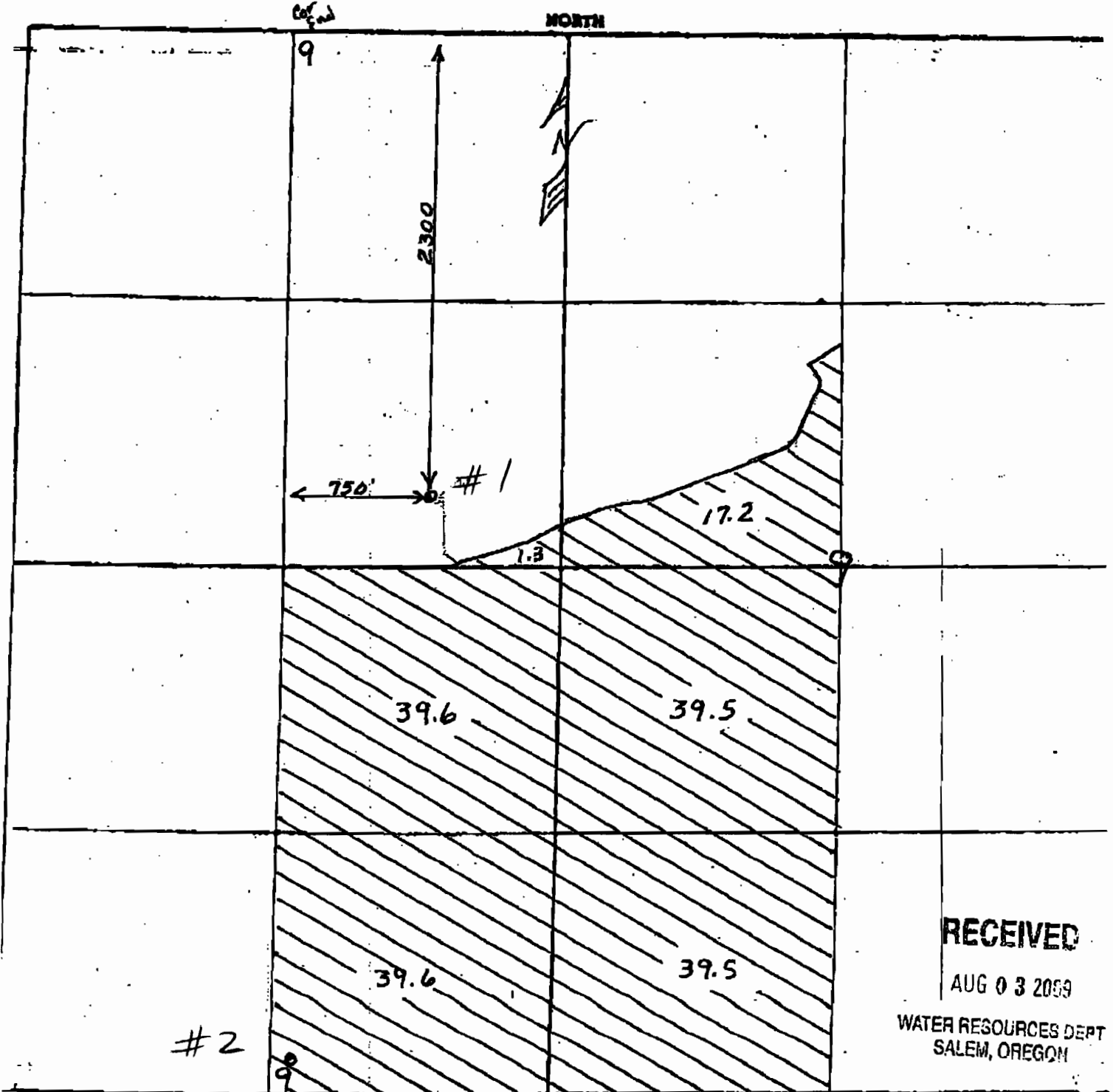

**RECEIVED**

AUG 03 2009

WATER RESOURCES DEPT  
SALEM, OREGON

8" = 1 mile  
1" = 660'

← well is 150<sup>ft</sup> North and 55<sup>ft</sup> EAST of survey stake @ S.W. corner of property  
Blocha A-M

# SECTION PLAT

Section 9 Township 24-5 Range 30-E

County of Harney State of OR

Cor. find

NORTH

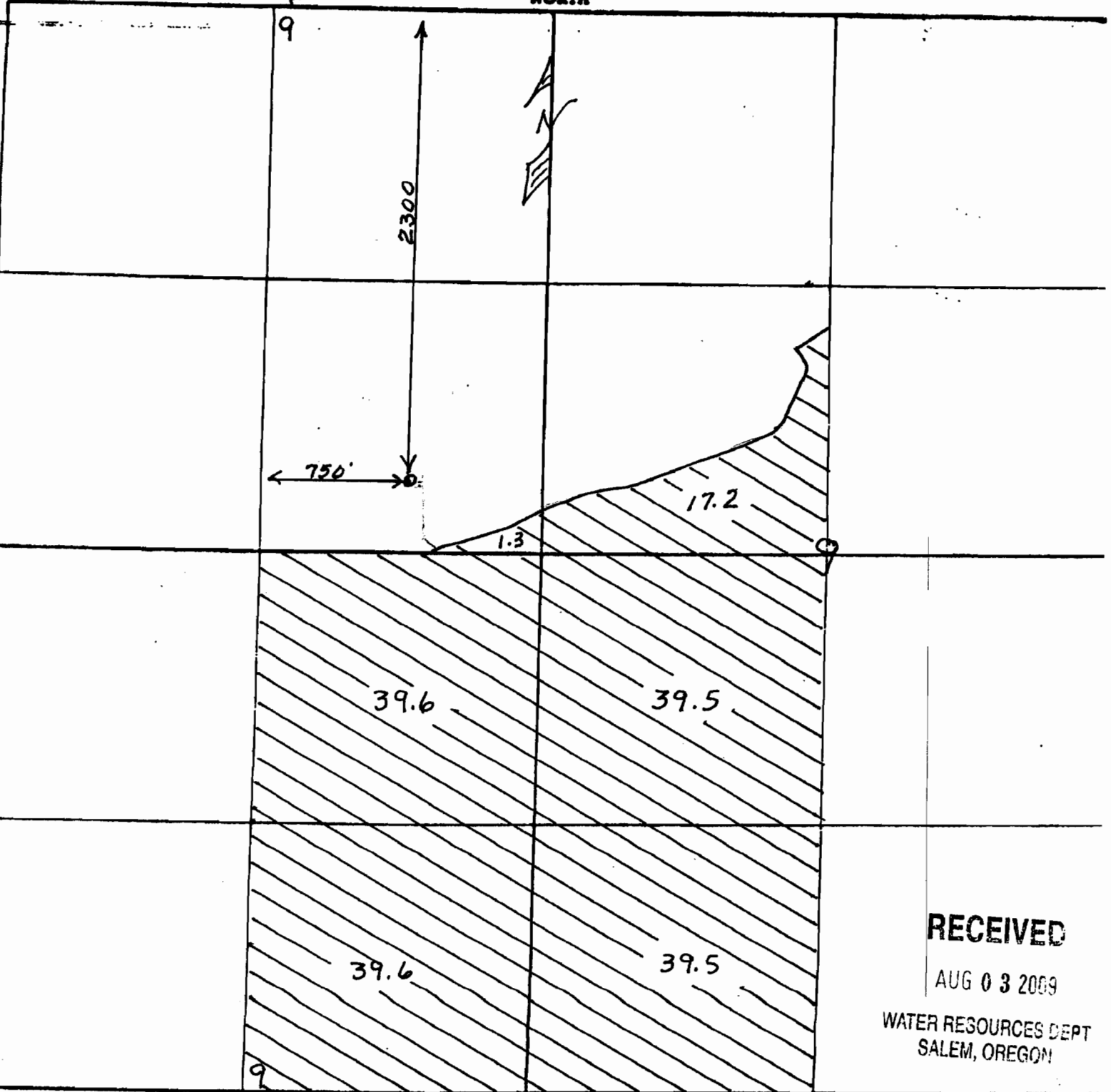

**RECEIVED**

AUG 03 2009

WATER RESOURCES DEPT  
SALEM, OREGON

8" = 1 mile

1" = 660'