

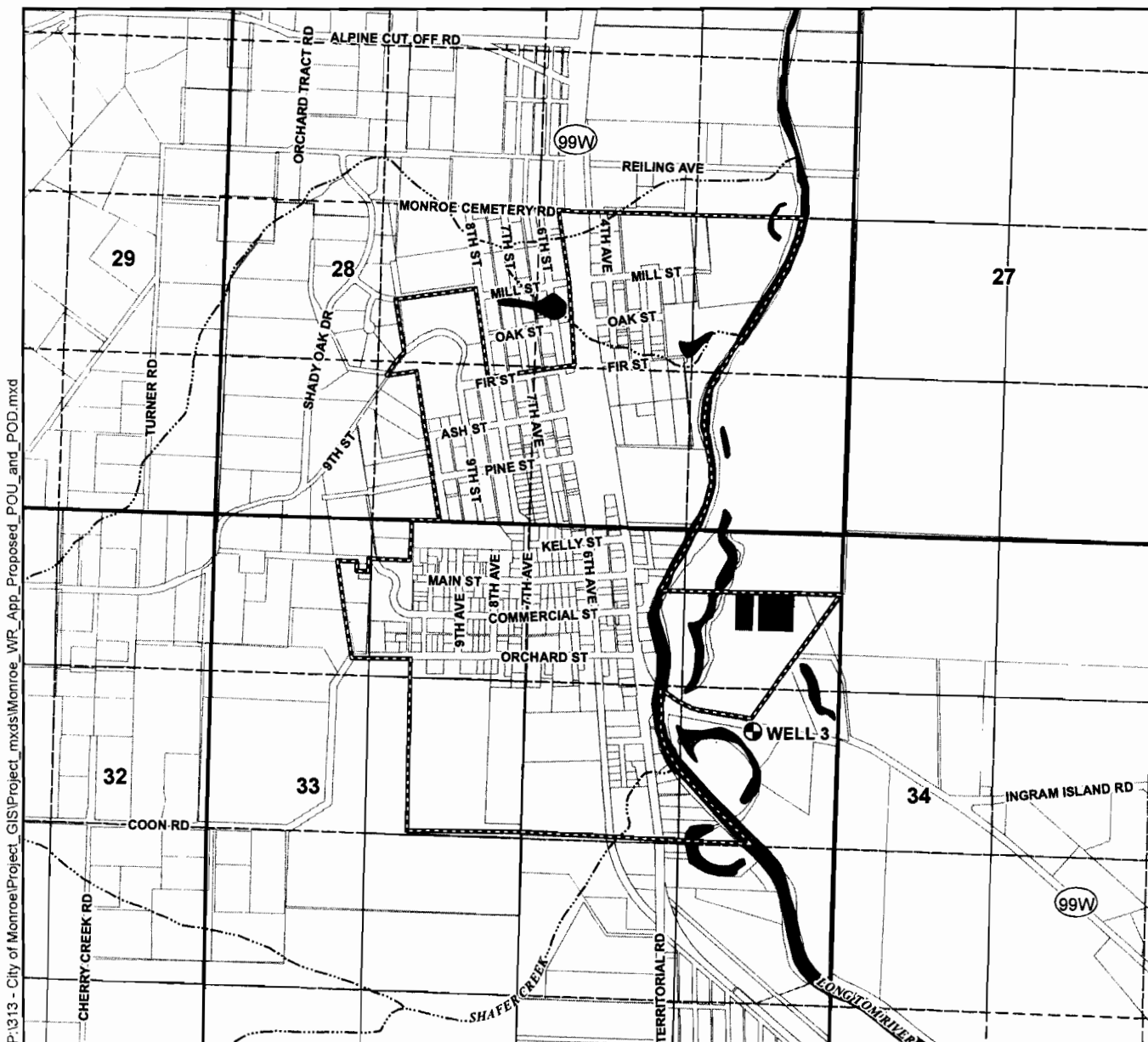





Water Right Application Map in the Name of the City of Monroe Proposed Point of Diversion and Place of Use

Township 14 South, Range 5 West (W.M.)



P:\313 - City of Monroe\Project_GIS\Project_mxd\Monroe_WF_App_Proposed_POU_and_POD.mxd

Legend

-  Proposed Point of Diversion (POD)
-  Proposed Place of Use (POU)
-  Tax Lots
-  Waterbodies
-  Watercourses

POD Location Description

Well 3
 Located 1,670 feet South and 720 feet West from the NE corner of
 Section 33, Township 14 South, Range 5 West (W.M.), within tax lot 2500

RECEIVED

OCT 05 2009

WATER RESOURCES DEPT
 SALEM, OREGON

Map Information

Projection: Oregon State Plane North Zone
 Datum: North American Datum of 1983
 Date: March 5, 2009
 Prepared By: GSI Water Solutions, Inc.

Data Sources

Oregon Geospatial Data Clearinghouse, Benton County GIS

Disclaimer

This map was prepared for the purpose of identifying the location of a water right only and it is not intended to provide legal dimensions or location of property ownership lines.

