

DEC 28 2011

T.5S. R.3W. Sec. 4, 5, and 8, W.M.

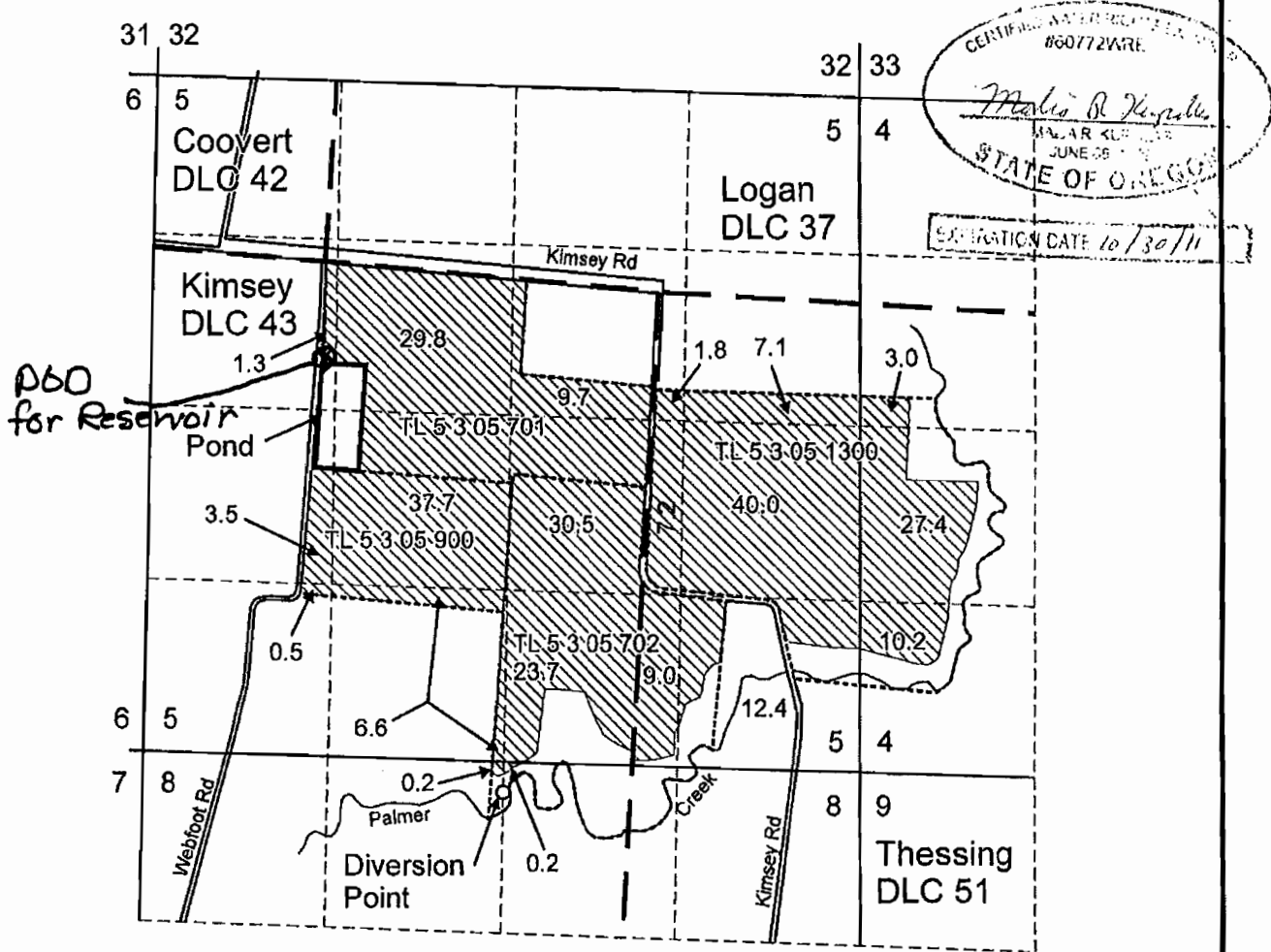

Proposed point of diversion is located 4,020 feet south and 1,350 feet east from the SE corner of DLC 42.

POD for Reservoir 780 feet south & 0 feet west from SE Corner of DLC 42

 Area (261.8 Acres) to be Irrigated.

 DLC boundary

 Tax lot boundary

Note: The quarter quarter lines have been projected using a tax map, government land survey maps, an aerial photograph, and best professional judgement.

This map was prepared for the purpose of identifying the location of a water right only and is not intended to provide legal dimensions or location of property ownership lines.

Scale: 1" = 1,320'

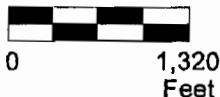

Pacific Hydro-Geology Inc.

7/2009

Water Right Application Map
 Surface Water Right
 Carlton Nursery Co., LLC.
 Gordon/Ediger/Webfoot
 T.5S. R.3W. Sec. 4, 5, and 8, W.M.

GordonGW-SWAApp.cdr

87564