

RECEIVED

RECEIVED

DEC 28 2009

JAN 12 2010

WATER RESOURCES DEPT
SALEM, OREGON

WATER RESOURCES DEPT
SALEM, OREGON

T.5S. R.3W. Sec. 4, 5, and 8, W.M.

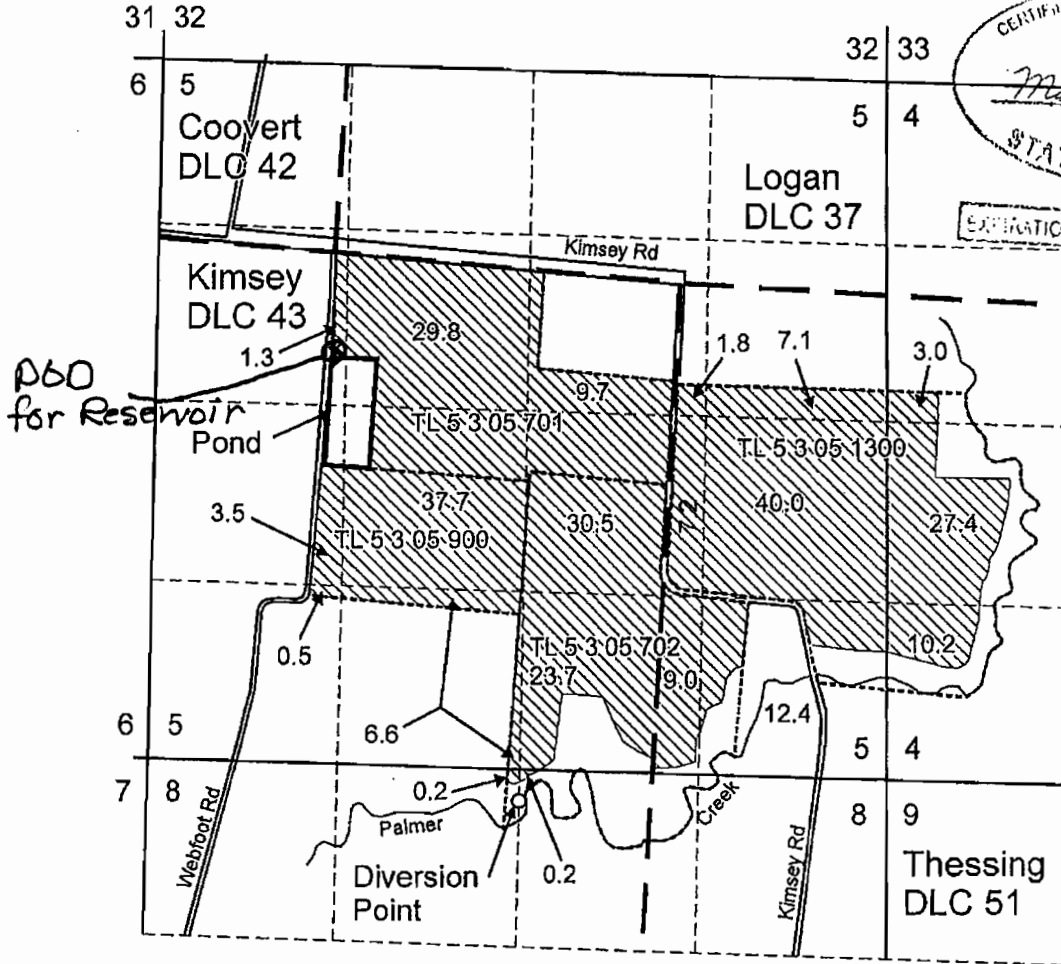

CERTIFIED WATER RIGHT APPLICATION
#60772WRE

Melissa R. Karpis
MELISSA R. KARPIS
JUNE 28 2009
STATE OF OREGON

EXPIRATION DATE 10/30/11

Proposed point of diversion is located 4,020 feet south and 1,350 feet east from the SE corner of DLC 42.
 POD for Reservoir 780 feet south & 0 feet west from SE Corner of DLC 42

- Area (261.8 Acres) to be irrigated.
- DLC boundary
- Tax lot boundary

Note: The quarter quarter lines have been projected using a tax map, government land survey maps, an aerial photograph, and best professional judgement.

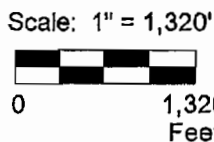

This map was prepared for the purpose of identifying the location of a water right only and is not intended to provide legal dimensions or location of property ownership lines.



GordonGW-SWApp.cdr

Pacific Hydro-Geology Inc.

7/2009

Water Right Application Map
 Surface Water Right
 Carlton Nursery Co., LLC.
 Gordon/Ediger/Webfoot
 T.5S. R.3W. Sec. 4, 5, and 8, W.M.

* orig w/S-875dt/mm