

T.13S., R.33E., W.M.

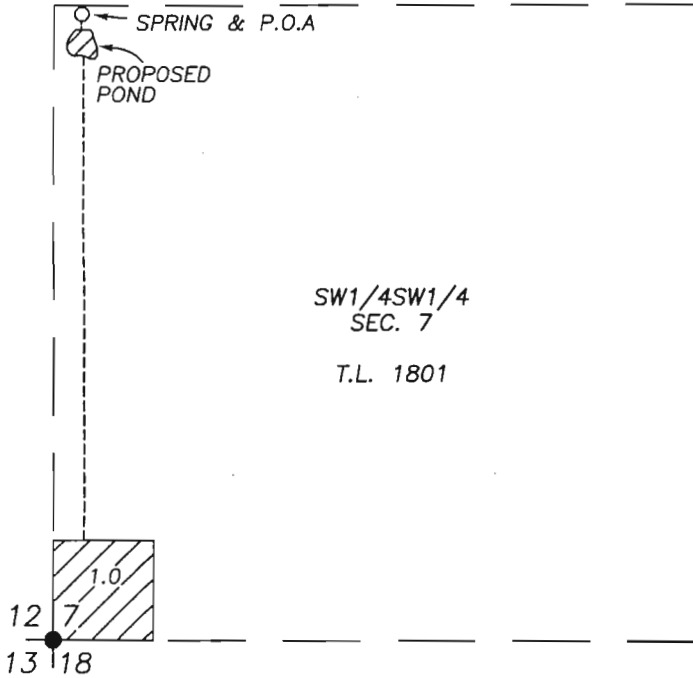

SCALE: 1"=400'

SPRING AND POINT OF APPROPRIATION IS 1310 FT. NORTH AND 60 FT. EAST OF THE SW CORNER OF SECTION 7 T.13S., R.33E., W.M.

APPLICATION MAP  
 FOR  
 POINT OF APPROPRIATION  
 &  
 PROPOSED PLACE OF USE  
 FOR  
 KELLY & BARBARA VOIGT

- FOUND ALUMINUM CAP MONUMENT
- T.L. TAX LOT
- PROPOSED PIPE LINE
- ▨ PROPOSED PLACE OF USE

BY

ROBERT D. BAGETT  
 217 N. CANYON BLVD.  
 JOHN DAY, OREGON  
 (541) 575-1251

JANUARY 22, 2010

RECEIVED

FEB 03 2010

WATER RESOURCES DEPT  
 SALEM, OREGON

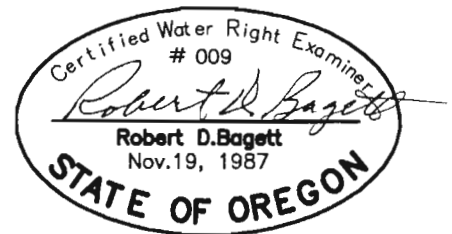

NOTE: THE PREPARATION OF THIS MAP WAS FOR THE PURPOSE OF IDENTIFYING THE LOCATION OF THE PROPOSED WATER RIGHT AND HAS NO INTENT TO PROVIDE DIMENSIONS OR LOCATION OF PROPERTY OWNERSHIP LINES.

S-87577