

Application No. 5-84168  
 Permit No. 53659

RECEIVED  
 JUN 08 1999  
 WATER RESOURCES DEPT.  
 SALEM, OREGON

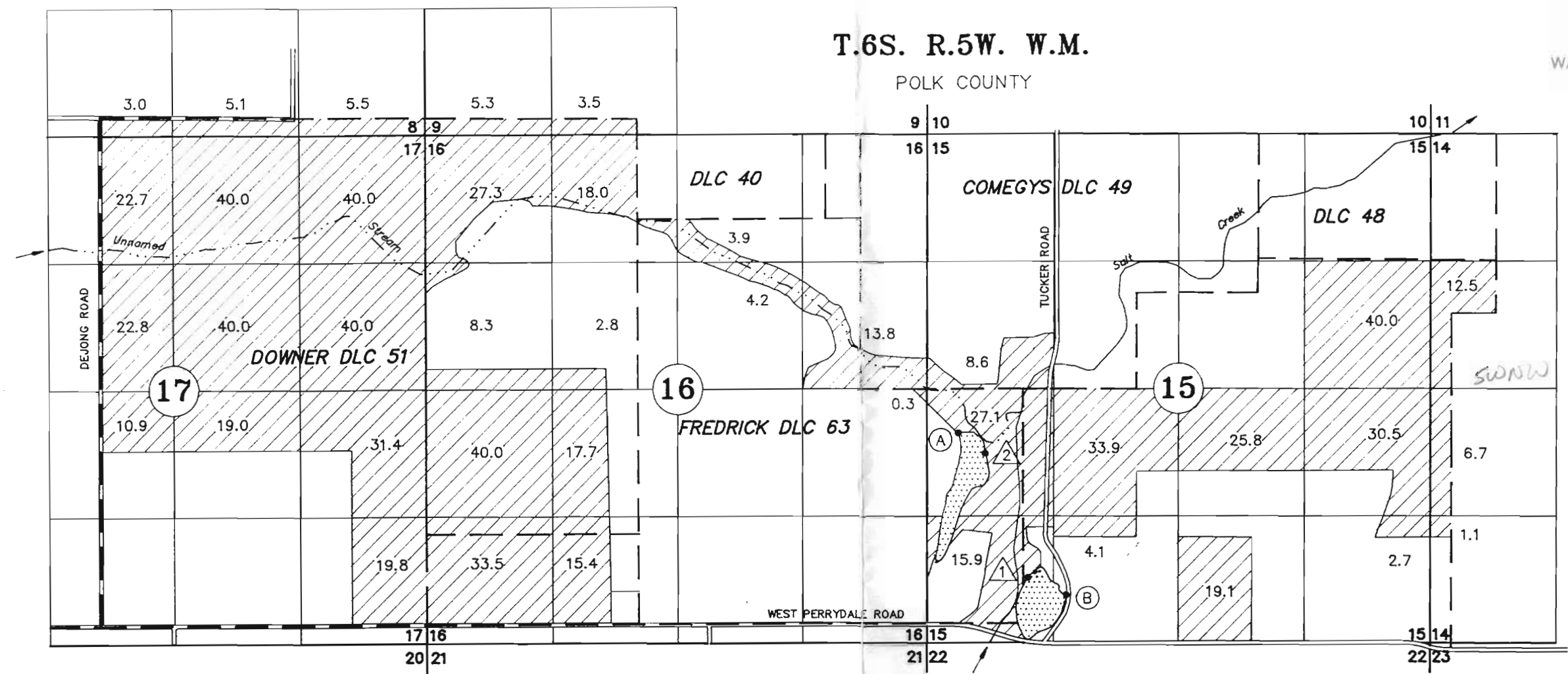

DIVERSION POINTS: RESERVOIR ① : 680' NORTH AND 1590' WEST FROM THE SOUTH 1/4 CORNER OF SECTION 15.  
 RESEPVOIR ② : 1970' NORTH AND 600' EAST FROM THE SOUTHWEST CORNER OF SECTION 15.  
 DIVERSION POINTS: PUMP ① : 2185' NORTH AND 325' EAST FROM THE SOUTHWEST CORNER OF SLCTION 15.  
 PUMP ② : 505' NORTH AND 1190' WEST FROM THE SOUTH 1/4 CORNER OF SECTION 15.

TAX LOTS:  
 6 5W 17 00100, 00200, 00700, 00800, 00900, 01000  
 6 5W 16 00100, 00101, 00200, 00300  
 6 5W 15 00400, 00500, 00700, 00800

APPLICATION NO. 84168

PERMIT NO. \_\_\_\_\_

APPLICATION TO APPROPRIATE SURFACE WATER  
**SCHARF BROS. FARMS**

JUNE 07, 1999  
 SCALE 1" = 1320'

NOTE: This map is for the purpose of identifying the location of water rights and has no intent to dimension or locate property ownership lines.

