

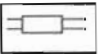

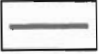

**RECEIVED**

MAR 16 2010

WATER RESOURCES DEPT  
SALEM, OREGON

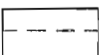
**LEGEND**

- POINT OF DIVERSION (POD) 
- COUNTY ROAD 
- ALL WEATHER ROCKED ROAD 
- STATE HIGHWAY 
- PROJECT AREA 
- B.L.M. OWNERSHIP 

U. S. DEPARTMENT OF THE INTERIOR  
BUREAU OF LAND MANAGEMENT  
COOS BAY DISTRICT OREGON

EXHIBIT A  
OR. 54529

DRAWN BY: PJR	SCALE 1" = 1000'
DATE: 8-25-98	SHEET OF



S-87592

T29S R12W

15 | 14  
22 | 23

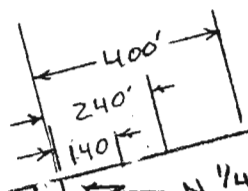

N 1/4 Corner

POD #1 (A SPRING)

NW 1/4 NE 1/4

POD #3

POD #2 (A SPRING)

NE 1/4 NW 1/4

NW 1/4 NW 1/4

SW 1/4 NW 1/4

SE 1/4 NE 1/4

P. Pipeline

Mill Cr

From N 1/4 Cor Sec 23  
POD's w/in NW 1/4 NE 1/4 Sec 23

POD #1	330'S	400'E
POD #2	770'S	240'E
POD #3	720'S	140'E

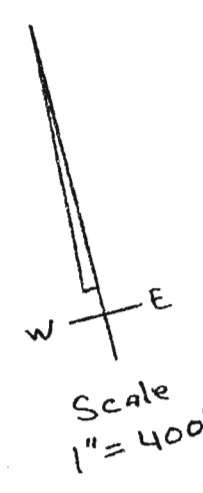

J.P. Drolet / 08 MAR '10  
S-87392

TL 102  
POU Ho.

NE 1/4 SE 1/4

SE 1/4 SE 1/4

Guerin Lane

SW 1/4 SE 1/4

RECEIVED

MAR 16 2010

WATER RESOURCES DEPT  
SALEM, OREGON