

T. 8 S., R. 45 E., W. M., Section 2, Quarter NE 1/4 SW 1/4

Mapped by Charles Thompson

Scale: 2 inches = 1 mile.

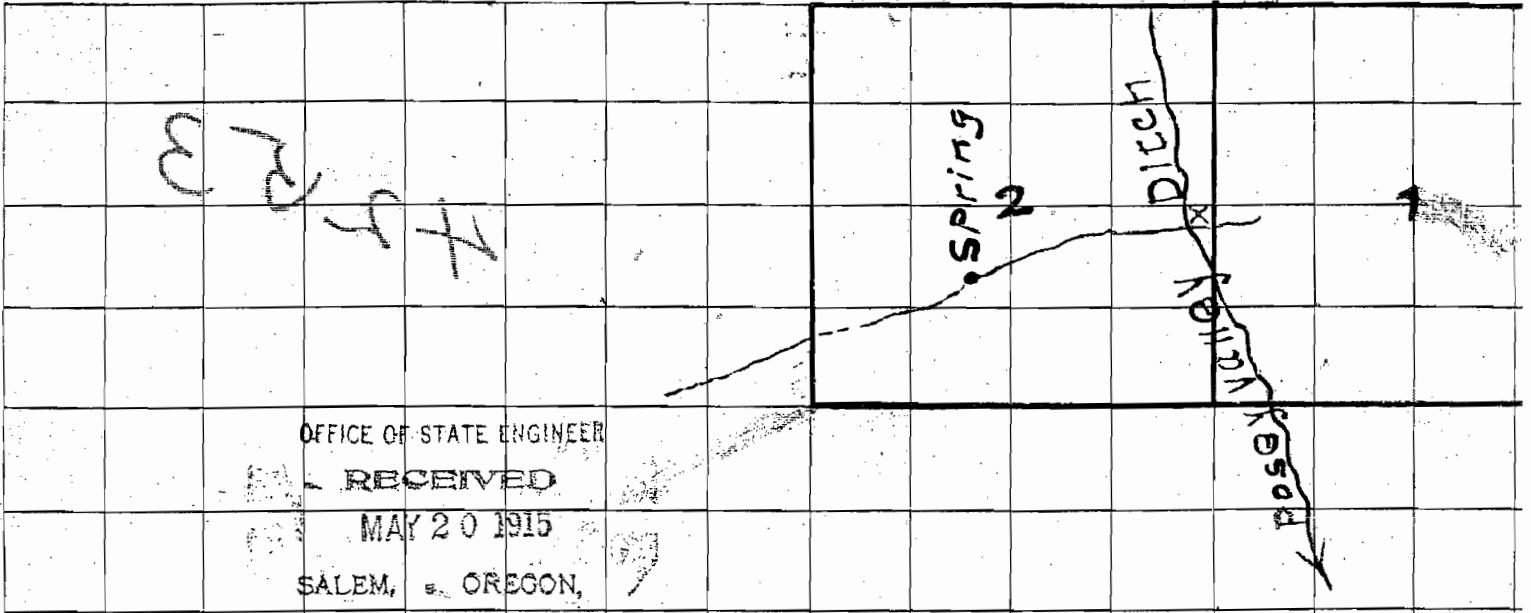

OFFICE OF STATE ENGINEER
 RECEIVED
 MAY 20 1915
 SALEM, OREGON

CERTIFICATE OF SURVEYOR

I Charles Thompson, of Halfway, Oregon, do hereby certify that this map was made from notes taken during a actual survey made by me on May 1, 1915, and that it correctly represents the works described in the accompanying application, together with location of streams and other ditches in the immediate vicinity, and has written thereon the area in each smallest legal subdivision which it is proposed to irrigate

Charles Thompson
 (Surveyor)

Application No. 4253
 Permit No. 2471

X Land to be irrigated.

NE CORNE
SEC 2 T 8 S. R 45 E

RECEIVED

DEC 5 1983

WATER RESOURCES DEPT.
SALEM, OREGON

ALL SHOULD NOT
HAVE BEEN ALLOWED
SINCE ONLY 27AC PERM.
TRM
1/8/84
8/2

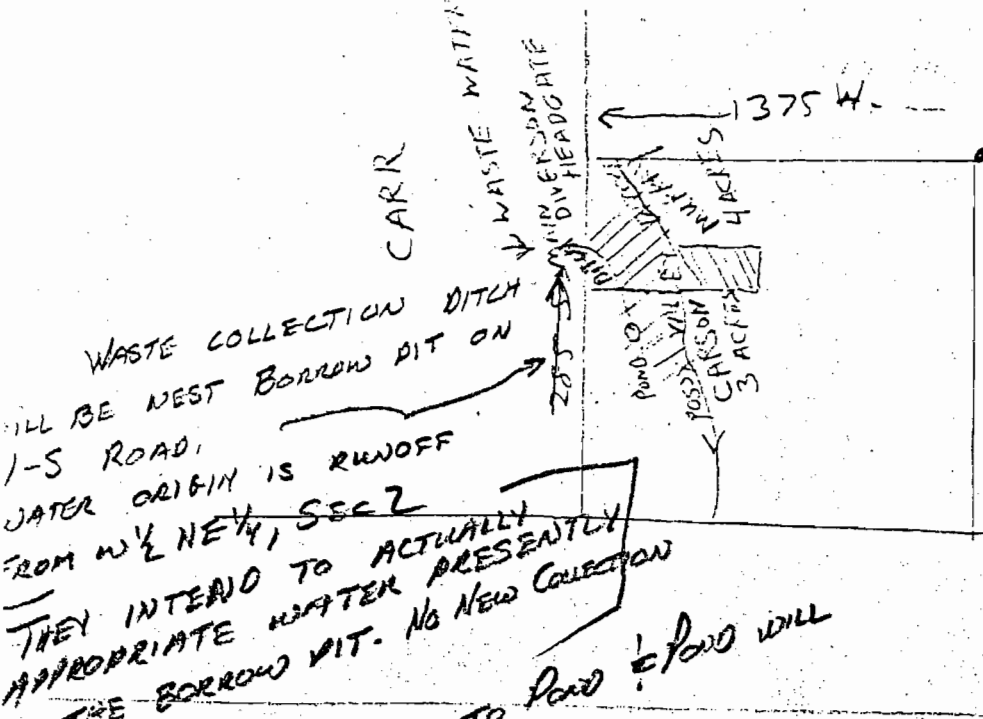

WASTE COLLECTION DITCH
WILL BE NEXT BORROW PIT ON
1-S ROAD.
WATER ORIGIN IS RUNOFF
FROM NW 1/4 NE 1/4 SEC 2

THEY INTEND TO ACTUALLY
APPROPRIATE WATER PRESENTLY
IN THE BORROW PIT. NO NEW COLLECTION

DITCH FROM BORROW PIT TO ROAD & POND WILL
BE NEW CONSTRUCTION

NE 1/4 NE 1/4 PINE LAKES 27 3 BL POSEY DITCH

Decree 15AC POSEY	10318	1890
1075 12AC CURRY	E-TB	1910

NOTES APPL# 4253
PERM# 2471
CERT# 1285

CHARLES THOMPSON
1915

LAND IRRIGATED IS WITHIN THE NE 1/4 SEC 2 AS
SHOWN ON MAP - THERE HAS BEEN A SCREW-UP
SOMEWHERE TO LOCATE THE IRR LAND WITHIN THE NE 1/4 NE 1/4
PINE LAKES VALLEY DITCH?

NOTES ONLY MAP PROVIDING LOCATION OF LAND IRR BY E-TB IS
WHY DID APPLICANT USE CURRY DITCH FOR LAND BL POSEY

RECEIVED

AUG 3 1983

WATER RESOURCES DEPT.
SALEM, OREGON

NOTES ONLY MAP PROVIDING LOCATION OF LAND IRR BY E-TB IS
WHY DID APPLICANT USE CURRY DITCH FOR LAND BL POSEY

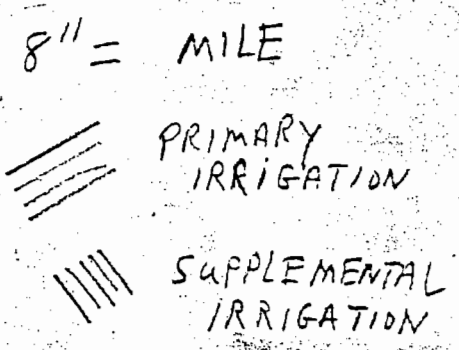
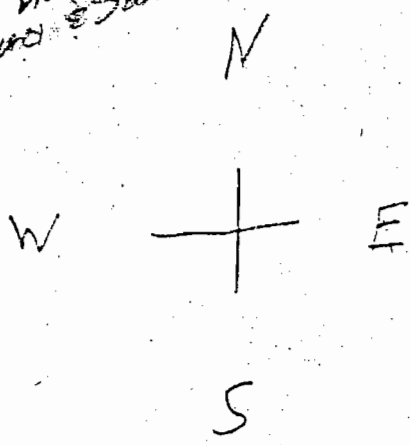

Application No. 65501

Division No. 2

Permit No. 2471

County of Baker

Application No. 4253

Proof of Appropriation of Water

(In accordance with the provisions of Chapter 216, Laws of Oregon for 1909, and the regulations of the State Water Board thereunder.)

From Spring located in NE 1/4 Sec 2 - T. 8 N. R. 45 E Tributary of _____

1. Name Charles Thompson

2. Postoffice address Halfway Oregon

3. For what purpose is water used? Irrigation

4. Did you begin the actual construction of the _____ Ditch,

(or other distributing works described in said permit), on or before June 7, 1916 ?

Yes.

5. Give the date of completion of such construction work April 1916.

6. When was all the water completely applied to the proposed use? April 10, 1916.

7. The description of land given below corresponds to that found in your permit covering land to be irrigated, or, if for other purposes, the place of use. In the blank column on the right, headed "No. acres actually irrigated," fill in the number of acres you have irrigated in each of the tracts described.

Tp.	Rg.	Sec.	Forty-acre Tract	No. Acres Described in Permit	No. Acres Actually Irrigated
88	45E	2	NE 1/4 NE 1/4 in Baker County	3 or 4	3 1/2

9. State the character of the soil and kind of crops raised Soil black loam .
Carden is all that is raised this season.
10. Does the accompanying blue print of the map filed with your permit show correctly the location of diverting works and area of land where water is used? Yes.
11. If not, state wherein such map is in error
12. If the dimensions of your ditch or dam do not correspond to those described in your permit, state what changes have been made, giving dimensions of ditch (or other distributing works)
No change made.
13. If water is used for power, mining, domestic, municipal, storage, manufacturing, or any other purpose than irrigation, give the extent and method of such use
0.05 cuft per second granted for irrigation

STATE OF OREGON,
 County of Baker } ss.

I, Charles Thompson, being first duly sworn, depose and say that I have read the above and foregoing proof of appropriation of water; that I know the contents thereof; and that the facts therein stated are true.

IN WITNESS WHEREOF, I have hereunto set my hand this the 5th day of August Sept, 1916:

x Charles Thompson

Subscribed and sworn to before me this 5 day of September, 1916.

(Notarial Seal)

[Signature]
 Notary Public for Oregon.

AFFIDAVIT OF WITNESSES

We, I. Miller and Henry Thompson,

of Halfway, Oregon, being first duly sworn, depose and say that

we are well acquainted with the facts and conditions set forth in the foregoing statement relative to proof of appropriation of water under Permit No. 2471; that we and each of us have been over and upon each tract described in said proof and from such personal inspection, have knowledge that all necessary ditches, dams and other diversion and distributing works have been constructed, and water used as stated therein; that we have carefully read such proof of appropriation, and that each and every statement contained therein is true to the best of our knowledge and belief.

I. Miller

Henry Thompson

Subscribed and sworn to before me this 7 day of September, 1916.

(Notarial Seal)

[Signature]
Notary Public for Oregon.

My commission expires Mar 22 - 1920

PROOF OF APPROPRIATION

Permit No. 2471

\$ 1.00 fee paid

priority 5-3-1915

City of

MEMPHIS TENNESSEE

Approved: _____

July 1, 1963

U. S. Department of Agriculture
Forest Service
Halfway Ranger Station
Halfway, Oregon

Attention Mr. Albert H. Leuthauser

Gentlemen:

A search of our records discloses six completed and perfected rights of record for appropriation of water from sources occurring within the lands identified in your letter of June 21 and on the map received with it. A brief resume of the rights, which are evidenced by the certificates recorded at pages 1285, 3881, 10449, 10388, 10381 and 10321, State Record of Water Rights Certificates, follows:

Certificate 1285 in the name of Charles Thompson was issued in evidence of the right established under permit No. 2471 for the appropriation of not to exceed 0.05 second foot of water from a spring located within the NE¹/₄ SE¹/₄ of Section 2, Township 8 South, Range 45 East, W.M., with the priority date of May 3, 1915, for irrigation of 3.5 acres in the NE¹/₄ NE¹/₄ of said Section 2.

Certificate 3881 in the name of George W. Miller was issued in evidence of the right established under permit No. 5073 for the appropriation of not to exceed 0.07 second foot of water from a spring, with the priority date of May 25, 1921, for irrigation of 5 acres in the SE¹/₄ SE¹/₄ of Section 12, Township 8 South, Range 45 East, W.M. The map submitted with the application shows location of the spring as being within the SW¹/₄ SE¹/₄ of said Section 12.

Certificate 10321 in the name of City of Halfway was issued in evidence of the right established by a decree of the court in the Pine Creek adjudication for appropriation of an unspecified amount of water from springs rising in the NW¹/₄ of Section 13, Township 8 South, Range 45 East, W.M., with a priority date of 1882, for domestic and municipal use for the City of Halfway within Sections 8 and 17, Township 8 South, Range 46 East, W.M.

July 1, 1953

Certificate 10381 in the name of Warren E. and Lillie M. Makinson was issued in evidence of the right established by a decree of the court in the Pine Creek adjudication, which includes the use of water from a spring in the $\frac{3}{4}$ SW $\frac{1}{4}$ NE $\frac{1}{4}$ of Section 12, Township 8 South, Range 45 East, W.M., with the priority date of 1883, for supplemental irrigation of 7 acres in the southwest corner of the SW $\frac{1}{4}$ NE $\frac{1}{4}$ of said Section 12.

Certificate 10388 in the name of Claude Martin was issued in evidence of the right established by a decree of the court in the Pine Creek adjudication, which includes the use of water from a Spring Creek rising on SW $\frac{1}{4}$ NE $\frac{1}{4}$ of Section 2, Township 8 South, Range 45 East, W.M., with the priority date of 1885, for domestic, stock and irrigation of 20 acres in the SW $\frac{1}{4}$ NE $\frac{1}{4}$ of said Section 2.

Certificate 10449 in the name of C. H. Reeder was issued in evidence of the right established by a decree of the court in the Pine Creek adjudication for the appropriation of water from Pine Creek and springs on the SW $\frac{1}{4}$ NE $\frac{1}{4}$ of Section 18, Township 8 South, Range 46 East, W.M. and on the NE $\frac{1}{4}$ of Section 13, Township 8 South, Range 45 East, W.M., with the priority date of 1910, for domestic, stock and irrigation of 25 acres in the SW $\frac{1}{4}$ NW $\frac{1}{4}$ of Section 18, Township 8 South, Range 46 East, W.M.

Very truly yours,

CHRIS L. WHEELER
State Engineer

By

James W. Carver, Jr., Assistant

JWC:eh

NOTICE OF COMPLETION OF CONSTRUCTION

I, Charles Thompson, the holder of Application No. 4253, being
 also Permit No. 2471, issued by the State Engineer of the State of Oregon
 for the appropriation of 0.05 second feet of the waters of spring
 in accordance with the tenor of such permit and the limitations endorsed thereon by the State Engineer,
 have completed the construction of the works described therein the 8th day of November, 19 15,
 being within the time limitation as fixed in said permit or extended by the State Water Board for the
 completion of construction work.

Remarks:

If the works have a less capacity than as described in the permit, or you have definitely abandoned your plan of irrigating any of the

lands described in your permit, you should so state in order that our records may not be unnecessarily encumbered.

IN WITNESS WHEREOF, I have hereunto set my hand this 27th day of June, 19 16
Halfway, Oregon.

(Present Address.)

Charles Thompson
 (Signature of Applicant.)

Fill out, detach, and mail to the Secretary, State Water Board, Salem, Oregon. Form D should be used in reporting progress of work if
 more than one year has been allowed for completion.

NOTICE OF BEGINNING OF CONSTRUCTION

I, Charles Thompson, the holder of Application No. 4253, being

also Permit No. 2471, issued by the State Engineer of the State of Oregon

for the appropriation of 0.05 second feet of the waters of Spring
in accordance with the tenor of such permit and the limitations endorsed thereon by the State Engineer,

began the actual construction of the works described therein on the 8th day of Nov., 19 15,
being within the time limitation as fixed in said permit for the beginning of construction work.

A small ditch was made with a plow on November 8, 1915, which was

The appropriator should state the manner of beginning construction work, number of men and teams employed, the amount of work completed

sufficient to carry the water to my land.

up to the date of this statement, and any additional information which may tend to show the beginning of work in good faith.

IN WITNESS WHEREOF, I have hereunto set my hand this 27th day of June, 19 16.

Halfway, Oregon.

Charles Thompson

(Signature of Applicant.)

(Present Address.)

Fill out, detach, and mail to the Secretary, State Water Board, Salem, Oregon.

NOTICE OF COMPLETE APPLICATION OF WATER TO A BENEFICIAL USE

I, Charles Thompson, the holder of Application No. 4253, being

also Permit No. 2471, issued by the State Engineer of the State of Oregon

for the appropriation of 0.05 second feet of the waters of spring
in accordance with the tenor of such permit and the limitations endorsed thereon by the State Engineer,

completely applied the water to a beneficial use, on the 8th day of November, 1915,
being within the time limitation as fixed in said permit or extended by the State Water Board for the complete application of water to a beneficial use.

Remarks: Al the the water is applied to a benificial use.

If all of the water granted in the permit had not been fully applied to beneficial use, you should so state, so that subsequent

appropriators may have notice.

IN WITNESS WHEREOF, I have hereunto set my hand this 27th day of June, 1916

Halfway, Oregon.

(Present Address.)

Charles Thompson

(Signature of Applicant.)

Fill out, detach, and mail to the Secretary, State Water Board, Salem, Oregon.

Send
Form
W.S.C.

OFFICE OF STATE WATER BOARD

RECEIVED

JUN 14 1916

SALEM,

OREGON.

Halfway, Ore.
June 12-1916

M. L. Mers.

Salem,

Ore.

Dear Sir:

I am sorry to say that I have lost my notice and would be very much obliged if you would send me another one or would fill in the blank for me. I began using the water from the spring under permit no. 247th October 16th 1915. It has been in constant use since.

I also lost the receipt of my filing at the same

time for \$3⁶⁰. Would it be possible for you to obcure another one for me?

If so I will willingly pay you for your trouble if you will forward one immediately.

My permit and receipt were lost through an accident and I havn't been able to find them because of a high wind since. They were lost from my pocket.

Hoping every thing can be arranged satisfactory

I am

Very Respectfully
Charles Thompson

September 11, 1916.

Mr. Charles Thompson.

Halfway, Oregon.

Dear Sir:-

Proof of appropriation of water under permit No. 2471, together with \$1.00 recording fee, has been received in this office.

I am returning the proof herein for answer to question seven. The number of acres actually irrigated should be set opposite the forty acre tract in the column left blank at the right.

Upon receipt of the corrected proof, the matter will be presented to the State Water Board for approval and issuance of certificate.

Very respectfully,

Secretary.

GE.

July 14, 1916.

Mr. Charles Thompson.

Railway, Oregon.

Dear Sir:-

I am enclosing blank for proof of appropriation of water under permit No. 2471 which you will please fill out and return to this office, together with \$1.00 recording fee, and the matter will be presented to the State Water Board at its next meeting for approval and issuance of certificate.

Very respectfully,

Secretary.

CB.

October 31, 1916.

Mr. Charles Thompson.

Halfway, Oregon.

Dear Sir:-

Corrected proof of appropriation of water under permit No. 2471 has been received and filed in this office.

This proof will be presented to the State Water Board at its next meeting for approval and issuance of certificate.

Very respectfully,

Secretary.

GB.

June 30, 1916.

Mr. Charles Thompson.

Halfway, Oregon.

Dear Sir:-

Forms A, B and C in connection with permit No. 2471 have been received and filed in this office.

In due course, proof of appropriation of water under this permit will be taken by the State Water Board, and final water right certificate issued thereafter in accordance with such proof.

Very respectfully,

Secretary.

June 15, 1916.

Mr. Charles Thompson.

Halfway, Oregon.

Dear Sir:-

I am inclosing forms A, B and C which should be filled out and returned to this office when construction is commenced, completed and water applied to beneficial use under permit No.2471.

Very respectfully,

Secretary

GB.

4253-2471

Spring No. 2 - T 88 R 46 E

Halway Ore.

Mar. 12-1916

John H. Lewis, State

Engineer

Dear Sir: Salem Ore.

Will you please
tell ^{me} if the spring, or
application no. 4653
was ever filed on before
my filing and when?

I hold the Receipt
no. 3425 of for \$3.60 paid
for filing, dated May 21-15

Would like to know
if my right is good.

Yours
Chas Thompson.

Application No. 4253.

June 7, 1915.

Mr. Charles Thompson,

Halfway, Oregon.

Dear Sir:-

I enclose your Application No. 4253, being Permit No. 2471, which has been approved and recorded in this office. Map is also enclosed.

DEPARTMENT OF THE INTERIOR,
GENERAL LAND OFFICE.

The Dalles, Oregon
April 20, 20

OFFICE OF STATE ENGINEER
RECEIVED
APR 21 1920
SALEM, OREGON

Perry A. Cupper,
State Engineer,
Salem, Ore.

Dear Sir:

Please advise me whether the Records of your
office show water right application filed by one
Edward A. Pausch, presumably in connection with
the S²E¹/₄, S²NE¹/₄, E²NW¹/₄, Sec. 29, T. 20 S. R. 22 E. or
if not in connection with the tracts described, with
what lands.

Very Respectfully

C. B. Walker

Special Agent

General Land Office,

Address, ^{The} Dalles
Gen. Land Office

4353-2612 Edward Pausch Cont 2414 .75 Lufs for 60 a.
10 a NW NW
10 SE NW
40 NW SE Oct. 13 - 1919

4750-4346 Edward Pausch .75 Lufs from McAlleger Canyon
& Triangle Horsehoe Res for in 60 a
10 a NE NW
10 SE NW
40 NW SE In 29, T. 20 S R. 22 E.

Supp Supply.

Halfway, Oregon, April 30, 1915.

4253

Mr. J. H. Lewis,

Salem, Oregon.

Dear Mr. Lewis:

I would like to file on a spring which flows approximately 6 miners inches, situated in the NE 1/4 of SW 1/4, Sec. 2, T 8 S, R 45 E, W. M.

If this letter is not sufficient application, please mail to me an application blank with instructions.

Very sincerely yours,

Charles Thompson

OFFICE OF STATE ENGINEER
RECEIVED
MAY 20 1915
SALEM, OREGON.

Halfway, Oregon, May 26, 1915.

Mr. John H. Lewis,

Salem, Oregon.

Dear Sir:

Your letter of May 21 is received.

The domestic use of this spring can be eliminated for I have water for domestic use without this spring. You are therefore authorized to make the necessary change in application No. 4253 to eliminate domestic use.

Very truly yours,

Charles Thompson

OFFICE OF STATE ENGINEER

RECEIVED

MAY 28 1915

SALEM, - - OREGON.

Halfway, Oregon, May 17, 1915.

4253

Mr. John H. Lewis,

Salem, Oregon.

Dear Sir:

Find enclosed application and two maps which shows the location of the spring and the land where the water will be used.

I am also mailing draft for \$3.60 which I figure is the correct amount in this case. If this amount is not right, please inform me and I will make it right.

Very sincerely yours,

Charles Thompson

2 maps

Domestic use 500 day

OFFICE OF STATE ENGINEER

RECEIVED

MAY 20 1915

SALEM, OREGON.

4253

Halfway, Oregon, April 30, 1915.

Mr. J. H. Lewis,

Salem, Oregon.

Dear Mr. Lewis:

(Trick Penick)

I would like to file on a spring which flows approximately 6 miners inches, situated in the NE 1/4 of SW 1/4, Sec. 2, T 8 S, R 45 E, W. M.

If this letter is not sufficient application, please mail to me an application blank with instructions.

Very sincerely yours,

Charles Thompson

OFFICE OF STATE ENGINEER
RECEIVED
MAY 3 1915
SALEM, OREGON.

OFFICE OF STATE ENGINEER
RECEIVED
MAY 3 1915
SALEM, OREGON.

Application No. 4253.

May 3, 1915.

Mr. Charles Thomson,

Halfway, Oregon.

Dear Sir:

I am in receipt of your letter of the 30th ultimo in regard to an appropriation of water and the same has been numbered 4253 and placed on file in this office. I will ask that you fill out the enclosed blank with the information required and furnish maps and fees as required by the enclosed copy of instructions. Upon receipt of this blank properly filled out and the required maps and fees, the application will be taken up for approval.

Very respectfully,

Percy A. Capper,

Acting State Engineer.

RS

Encs.

Application No. 4253.

May 21, 1915.

Mr. Charles Thompson,

Halfway, Oregon.

Dear Sir:

Enclosed please find my official receipt No. 3425 for \$3.60, which amount was transmitted with your letter of the 17th instant together with your corrected application No. 4253. Also received two maps.

I note that the application is for water for the irrigation of four acres of land and for domestic use. A fee of \$5.00 is required for domestic use in addition to the amount you have transmitted. However, if domestic use can be eliminated the fees transmitted will be sufficient. The application is being held here awaiting additional fees or instructions from you to eliminate domestic use.

Very respectfully,

John H. Lewis,

State Engineer.

RS.

Encs.

4353

Application No. 6750

April 22nd, 1920.

Mr. C. B. Walker,
Special Agent,
General Land Office,
The Dalles, Oregon.

Dear Sir:

In reply to your letter of April 20th our records show that Edward Fausch secured a water right under Water Right Certificate No. 2414 dated October 13, 1919, covering the appropriation of 0.75 second feet from McClegan Canyon for the irrigation of 10 acres NE $\frac{1}{4}$ NW $\frac{1}{4}$, 10 acres SE $\frac{1}{4}$ NE $\frac{1}{4}$, 40 acres NW $\frac{1}{4}$ SE $\frac{1}{4}$, Section 29, Twp. 20 South, Range 22 East.

A new filing was made however under application No. 6750, Permit No. 4345 by Mr. Fausch covering the appropriation of 0.75 second feet from McClegan Canyon and Triangle Harseshoe Reservoir for a supplemental supply for the irrigation of this same land, which was filed on September 10th, 1919.

Trusting this will give you the desired information, I remain,

Very respectfully,

Percy A. Cupper,
State Engineer.

RS-R.

Application No. 4253.

Mar. 18, 1916.

Mr. Chas. Thompson,

Halfway, Oregon.

Dear Sir:

In reply to your letter of the 12th instant you are advised that the records of this office do not show any filings on the spring located in the NE SW Sec. 2, T. 8 S. R. 46 E., except your application No. 4253, permit No. 2471. However, you will understand that the records of this office are complete only since February 24, 1909, at which time the water code became effective.

By creating this will give you the desired information, I am,

Very respectfully,

Percy A. Cupper,

Acting State Engineer.

RS.