

SEC.33 T.31S. R.4W. W.M.
DOUGLAS COUNTY
Scale 1" =500'

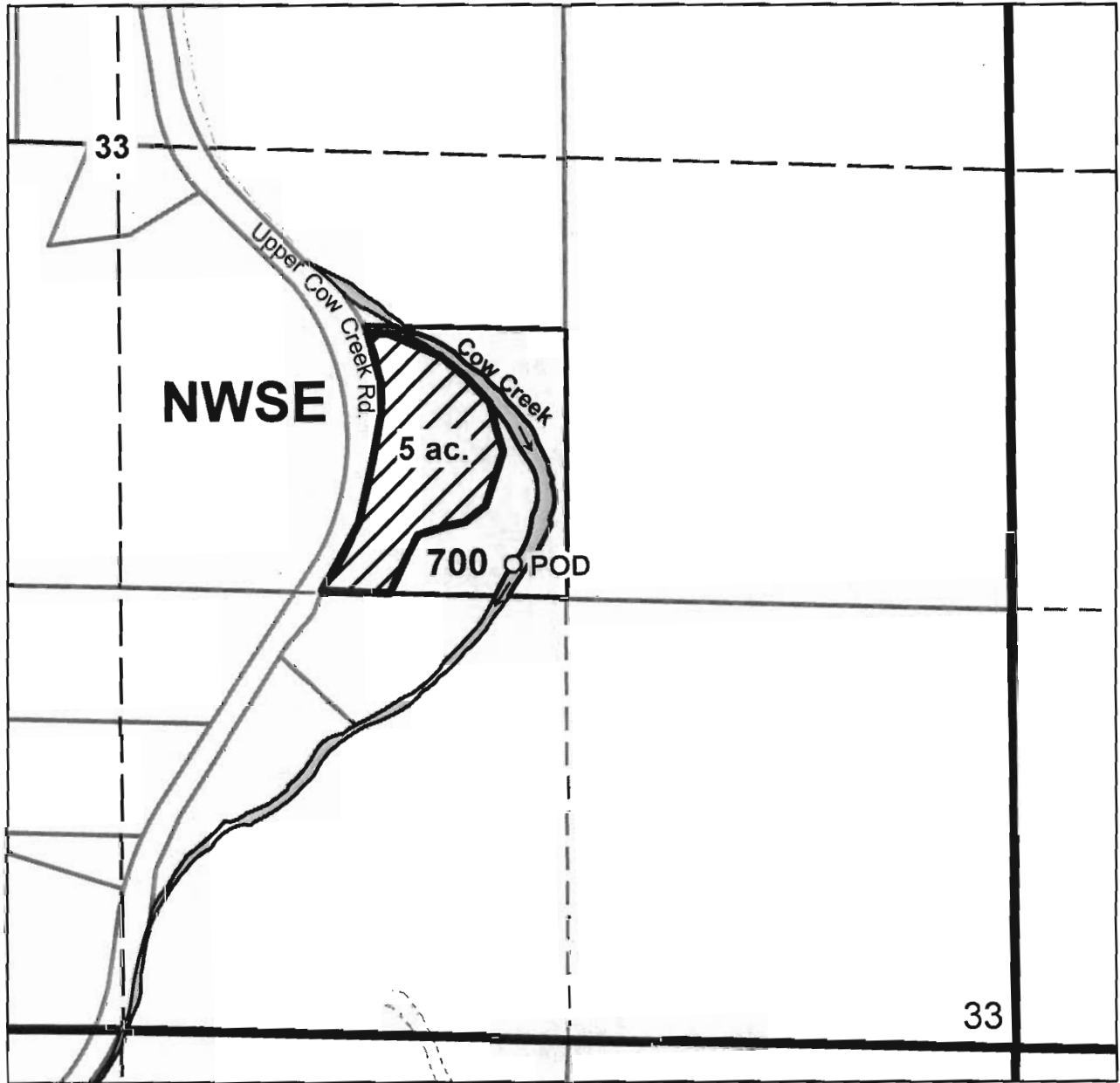

POD: 1200 ft. S. and 1200 ft. W. from the center of Section 33

Marc Eastman 4/29/10

S-87598

RECEIVED
MAY 03 2010
WATER RESOURCES DEPT
SALEM, OREGON