

SEC.21 T.23S. R.4W. W.M.
DOUGLAS COUNTY
Scale 1" = 1000'

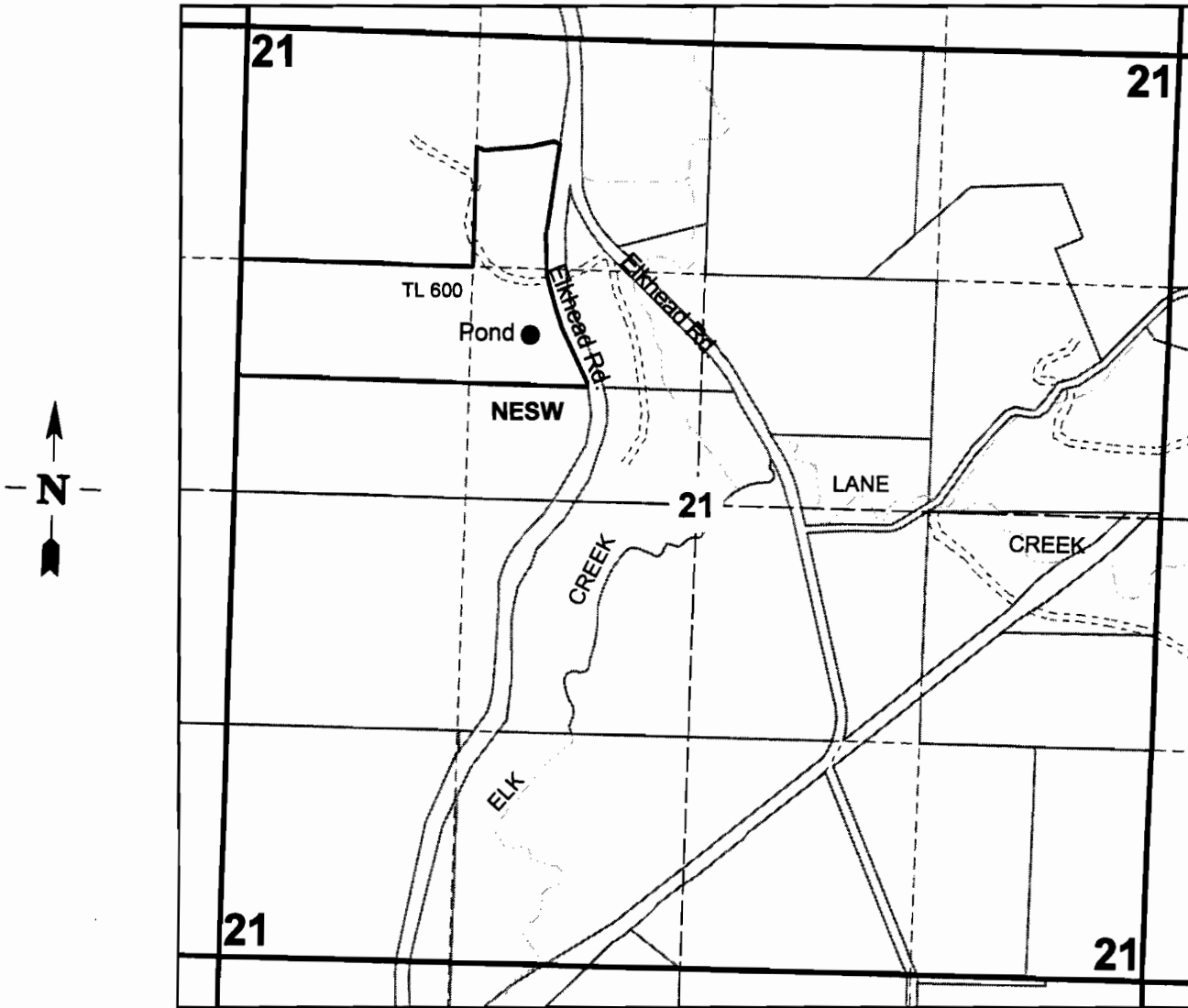

**Pond is located 1700 ft. South and 1650 ft. East
from the NW corner of Section 21**

RECEIVED

MAY 12 2010

WATER RESOURCES DEPT
SALEM, OREGON

R-87610