

0621-070

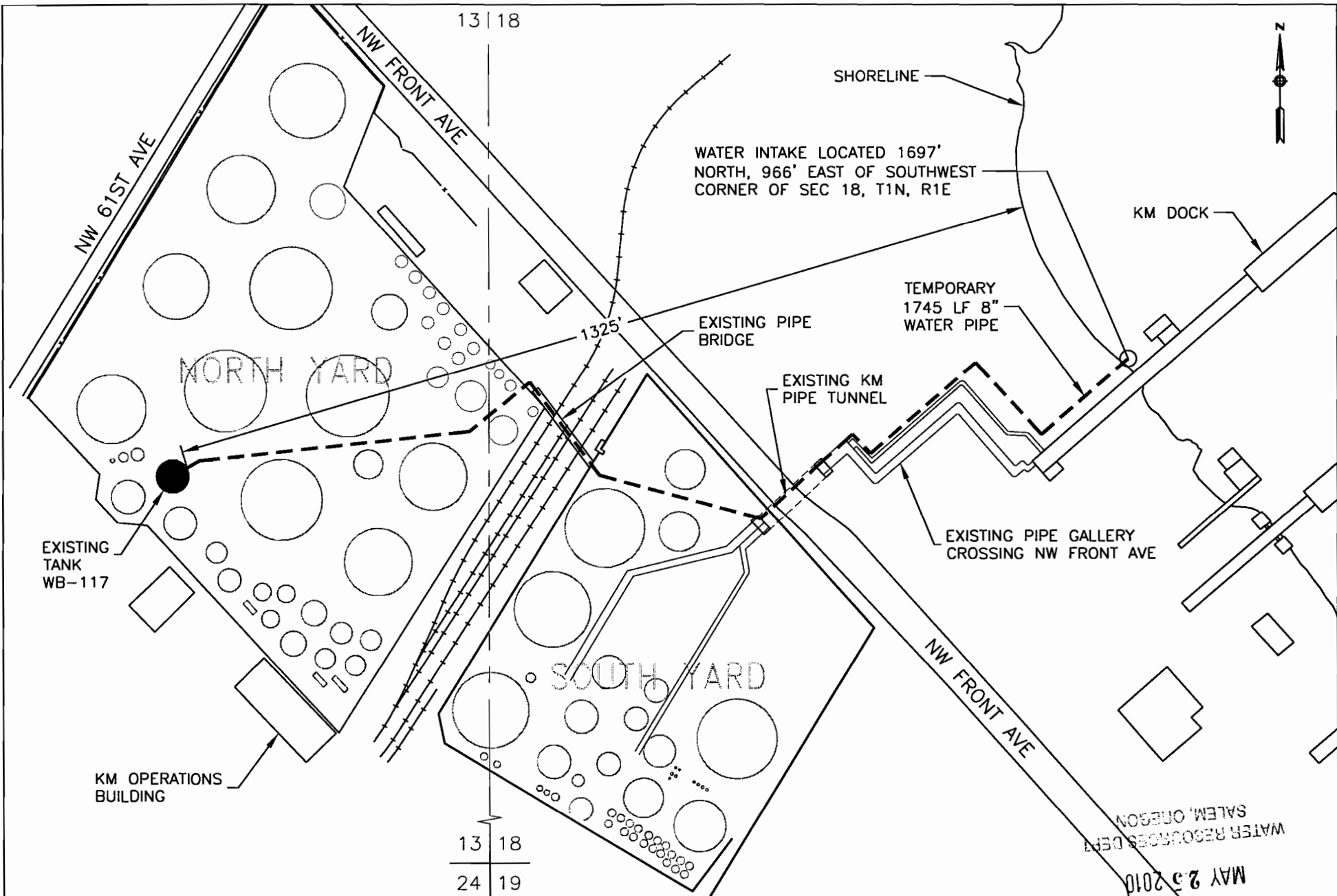

WILLBRIDGE WATER USAGE SITE PLAN

1" = 200'

SW 1/4, SW 1/4, SECTION 18, TOWNSHIP 1 NORTH, RANGE 1 EAST, W-1.

WATER RESOURCES DEPT
SALEM, OREGON
MAY 25 2010

RECEIVED