

T13S R4W Sections 7, 8, 17 & 18, W.M.
Benton County

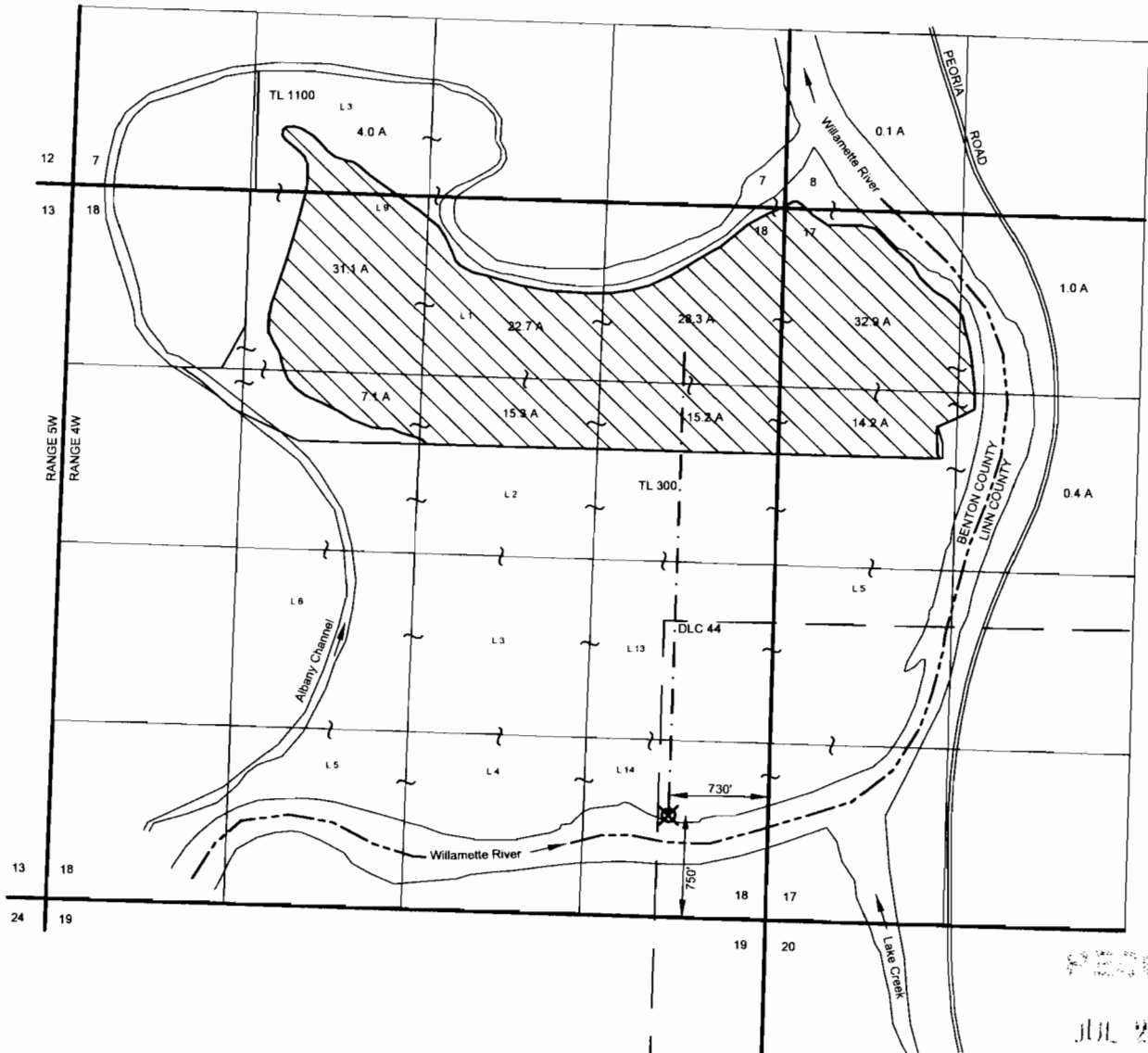

RECEIVED

JUL 27 2010

WATER ASSOCIATES
SERVICES

April 6, 2010

THIS MAP IS NOT INTENDED TO
PROVIDE LEGAL DIMENSIONS OR
LOCATIONS OF PROPERTY
OWNERSHIP LINES.

EXPLANATION:



- Proposed Irrigation
(172.3 Acres)



- Proposed Point of Diversion

- - - - - Mainline

SKOOKUM
WATER ASSOCIATES, INC.

P.O. Box 80174
Portland, OR 97280
(503) 319-8926

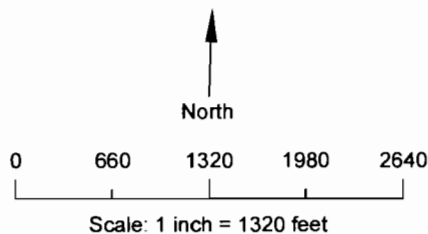

**Application Map
for J & C Bayne, LLC**

S-67644

RECEIVED

JUL 27 2010

Jul-19-2010 04:48 PM LaserPros International 17153695138

18/18

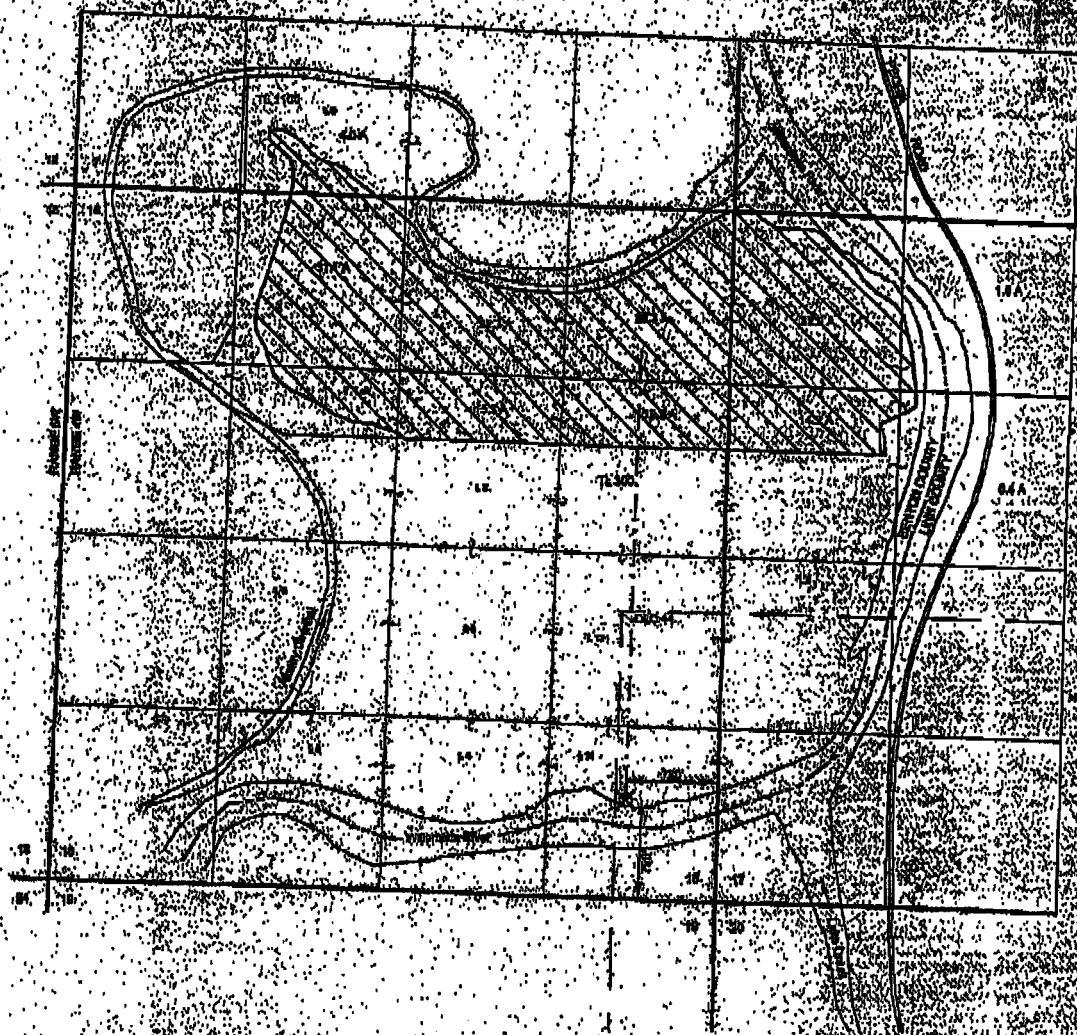

T13S R4W Sections 7, 8, 17 & 18 W/M
Benton County



April 2010

THIS MAP IS NOT INTENDED TO
PROVIDE LEGAL DIMENSIONS OR
LOCATIONS OF PROPERTY
OWNERSHIP LINES

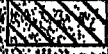
EXPLANATION

-  Proposed Irrigation (172.3 Acres)
-  Proposed Point of Diversion
-  Mainline

SKOOKUM
WATER ASSOCIATES, INC.
P.O. Box 80174
Portland, OR 97280
(503) 319-8928

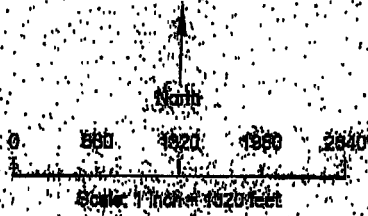

Application Map
for J & C Bayne, LLC

S-87644