

Application No. 73080

Permit No. 52525

APPLICATION MAP

RECEIVED

DEC 18 1992

IN THE NAME OF JOHN W. OR ANNA E. BRANDS

WATER RESOURCES DEPT.
SALEM, OREGON

SECTION 36, TOWNSHIP 25 SOUTH, RANGE 12 WEST, W.M.

SECTION 31, TOWNSHIP 25 SOUTH, RANGE 11 WEST, W.M.

SECTION 1, TOWNSHIP 26 SOUTH, RANGE 12 WEST, W.M.



1 INCH = 1320 FEET

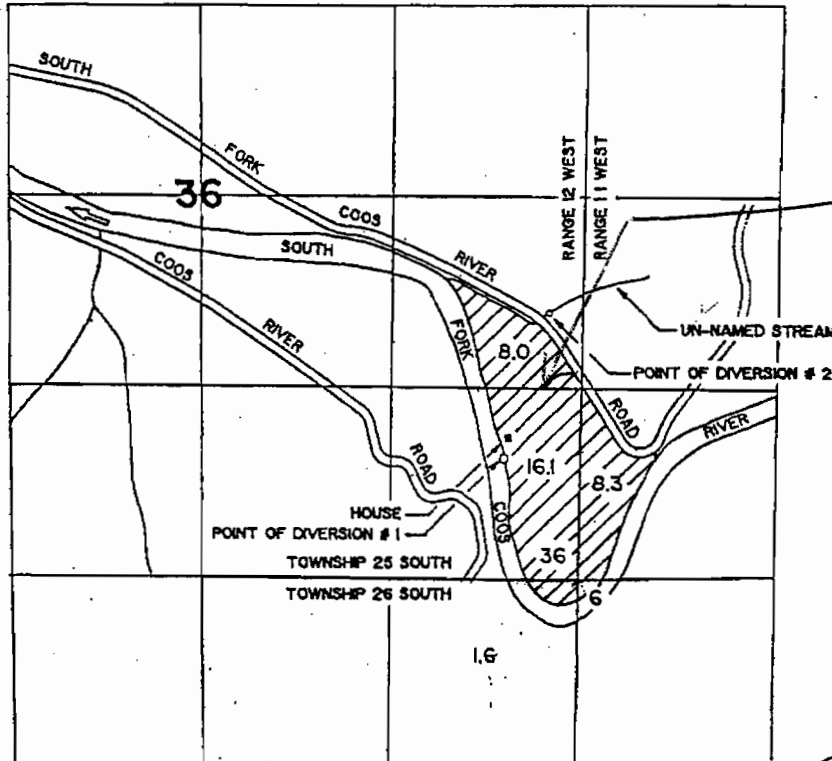

Portion assigned

RECEIVED

AUG 03 2010

WATER RESOURCES DEPT
SALEM, OREGON

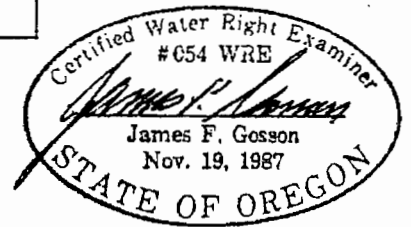

POINT OF DIVERSION #1 IS TO BE LOCATED 840 FEET NORTH AND 550 FEET WEST FROM THE SOUTHEAST CORNER OF SECTION 36, BEING WITHIN THE SE 1/4 OF THE SE 1/4 OF SECTION 36. POINT OF DIVERSION #2 IS TO BE LOCATED 1850 FEET NORTH AND 230 FEET WEST FROM THE SOUTHEAST CORNER OF SECTION 36, BEING WITHIN THE NE 1/4 OF THE SE 1/4 OF SECTION 36. BOTH POINTS OF DIVERSION BEING WITHIN TOWNSHIP 25 SOUTH, RANGE 12 WEST, W.M., COOS COUNTY.

THE PURPOSE OF THIS MAP IS TO IDENTIFY THE LOCATION OF THE WATER RIGHT. IT IS NOT INTENDED TO PROVIDE INFORMATION RELATIVE TO THE LOCATION OF PROPERTY OWNERSHIP BOUNDARY LINES.