

P. 10
7-12877
RECEIVED

DEC 27 1999

IN THE NAME OF PHILLIP OR MARIE CAMMENGA

WATER RESOURCES DEPT
SALEM, OREGON

SECTION 17, T 22 S, R 6 W, W.M.

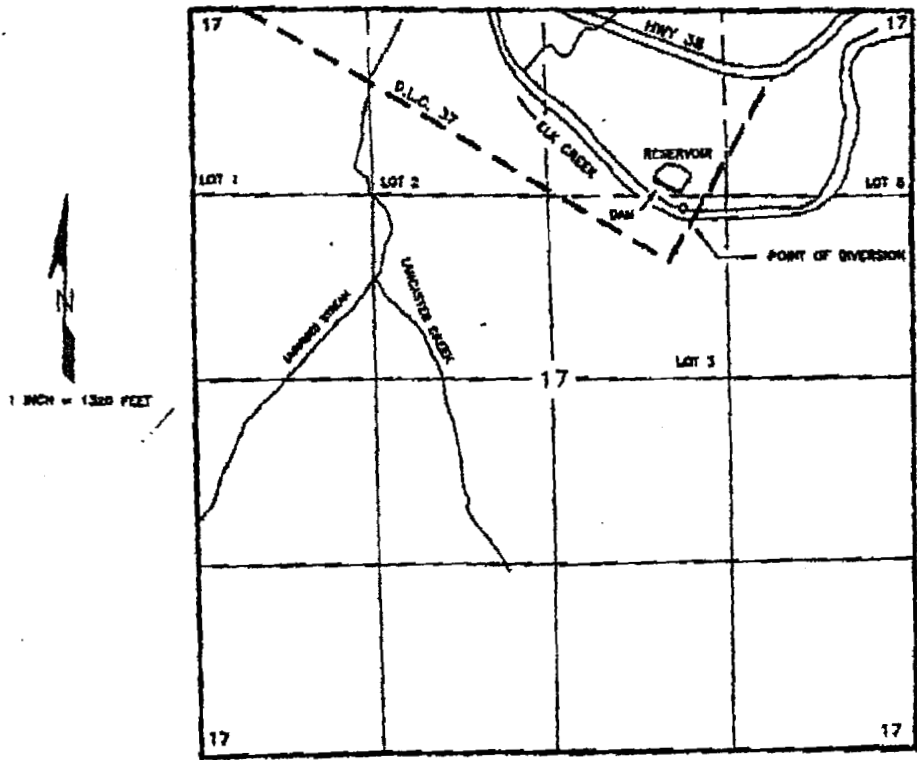

RECEIVED

JUL 23 2010

WATER RESOURCES DEPT
SALEM, OREGON

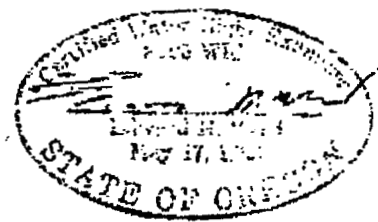

THE RESERVOIR IS TO BE LOCATED WITHIN THE NW¼ NE¼ OF SECTION 17, TOWNSHIP 22 SOUTH, RANGE 6 WEST, W.M.; THE CREEK POINT OF DIVERSION IS TO BE LOCATED 1450 FEET SOUTH AND 1680 FEET WEST FROM THE NORTHEAST CORNER OF SECTION 17, BEING WITHIN THE SW¼ NE¼ OF SECTION 17, TOWNSHIP 22 SOUTH RANGE 6 WEST, W.M., DOUGLAS COUNTY.

Applicator No. R-84339
Permit No. R-12899

THE PURPOSE OF THIS MAP IS TO IDENTIFY THE LOCATION OF THE WATER RIGHT.
IT IS NOT INTENDED TO PROVIDE INFORMATION RELATIVE TO THE LOCATION OF
PROPERTY OWNERSHIP BOUNDARY LINES.