

T.6S., R.4W. & T.7S., R.4W. W.M. RECEIVED

POLK COUNTY

SEP 08 1992

R.5W. R.4W.

25 30  
36 31

30 29  
31 32

WATER RESOURCES DEPT.  
SALEM, OREGON

DIV. PT. G

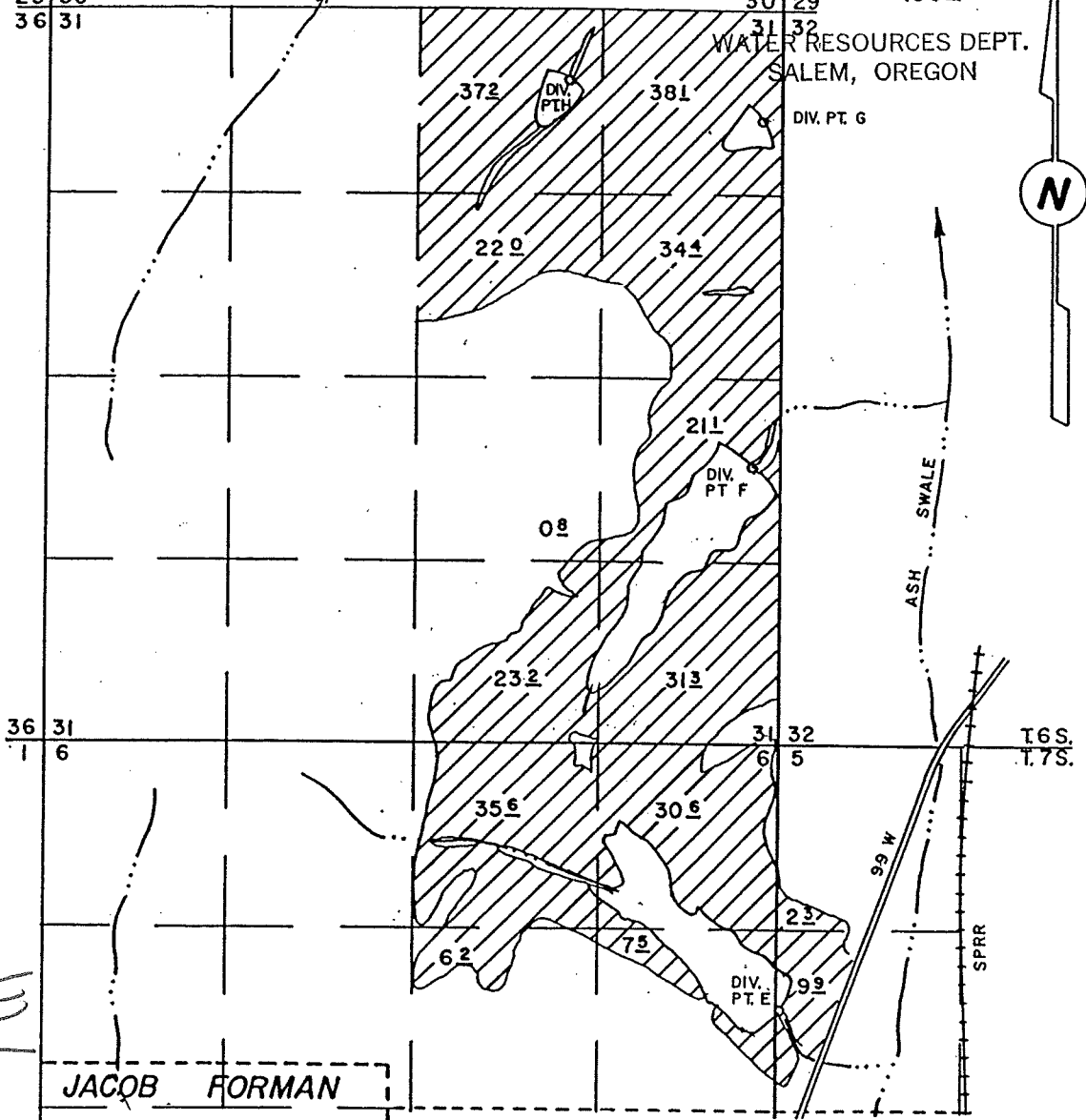
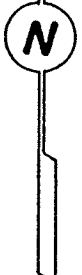

POD RES E

JACOB FORMAN

D.L.C. 37

- DIVERSION POINT :
- E 1990' S & 40' E OF THE NW CORNER OF SEC.5, T7S, R4W WM
  - F 3260' S & 200' W OF THE NE CORNER OF SEC.31, T6S, R4W WM
  - G 770' S & 130' W OF THE NE CORNER OF SEC.31, T6S, R4W WM
  - H 490' S & 1550' W OF THE NE CORNER OF SEC.31, T6S, R4W WM

### APPLICATION TO APPROPRIATE SURFACE WATER

Application No. 72659 Permit No. ~~51534~~  
CONRAD H. KONING

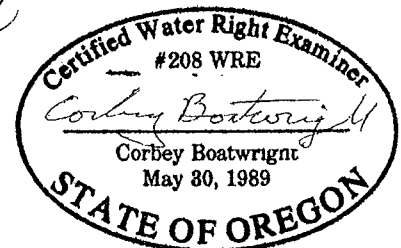

NOTE: This map is for the purpose of identifying the location of water rights and has no intent to dimension or locate property ownership lines.

AUGUST 27, 1992  
SCALE 1" = 1320'