

Application No. 615168

Permit No. 6-15158

RECEIVED

MAY 15 2000

WATER RESOURCES DEPT.
SALEM, OREGON

TL-300

TL 600

T-24-5

Sheet 3 of 3

R-27-E

R-28-E

1" = 660'

Primary →

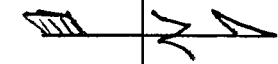

Sander Well

6

2310'

12" MAIN

1710'

4650

3260'

12" main

150' ← P. Vat Well

40.0

TL 200

.7

6.0

5.1

4.4

113

18

12

7

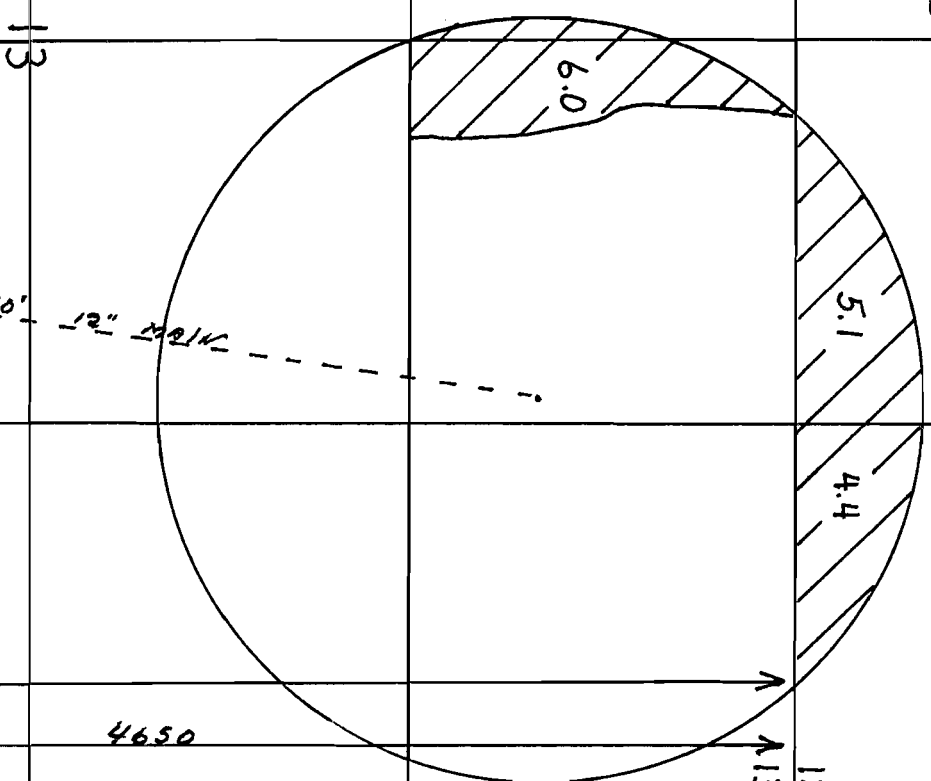

RECEIVED

MAY 15 2000

WATER RESOURCES DEPT.
SALEM, OREGON

TL 300

Sheet 2 of 3

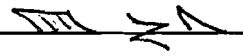

1" = 660'

T-24-S R-27-E

Primary

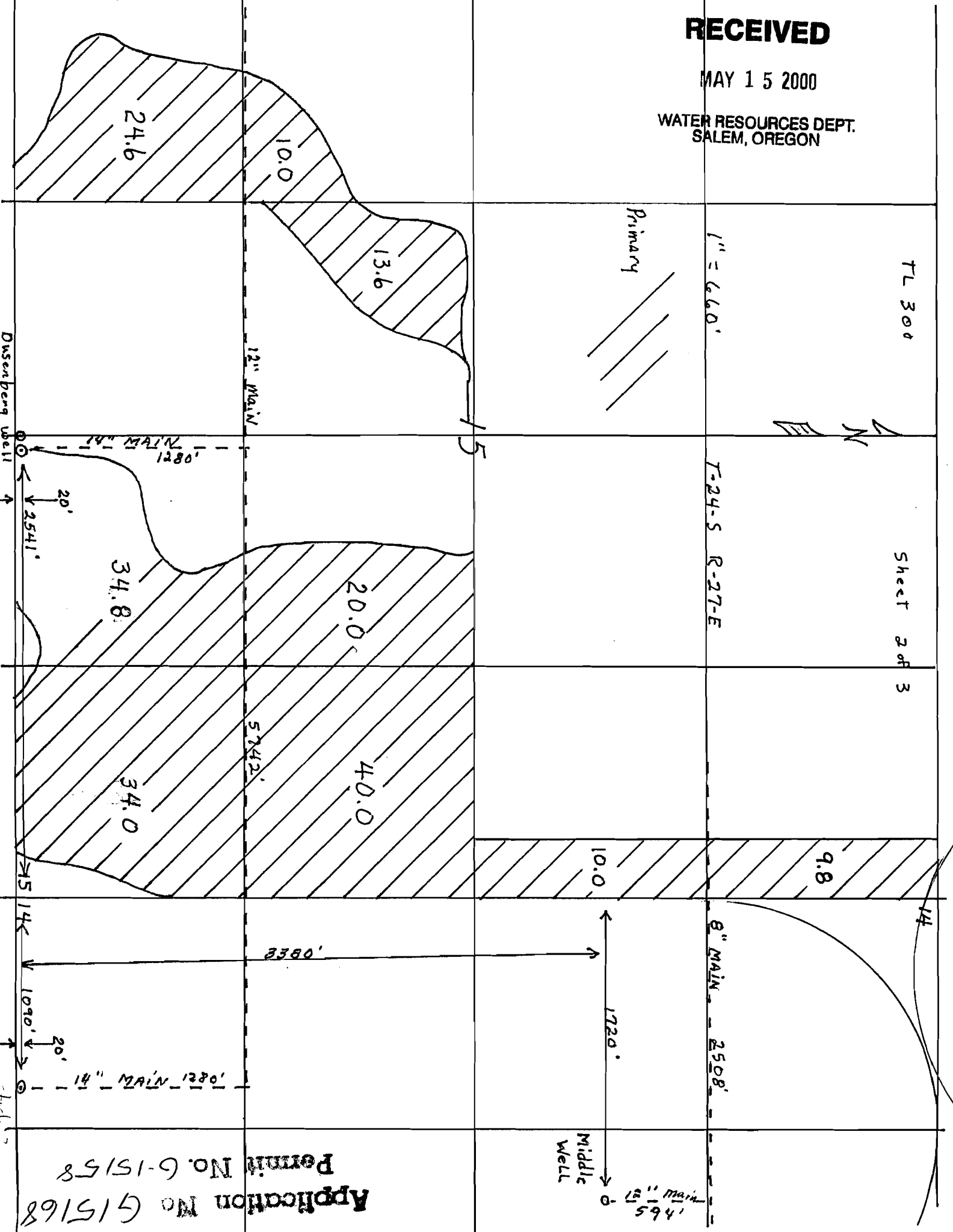
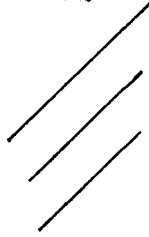

Dusenbery Well

check

Application No G15168
Permit No. G-15158

Middle Well

20'
2541'

15
14

20'
1090'

1495'

24.6

10.0

13.6

15

34.8

20.0

40.0

34.0

5742'

10.0

9.8

2380'

1720'

8" MAIN 2508'

14" MAIN 1280'

14" MAIN 1280'

12" MAIN

14

Application No G15168
Permit No. G-15158

T-24-S
R-27-E

TL-300

Sheet 1 of 3

1" = 660'

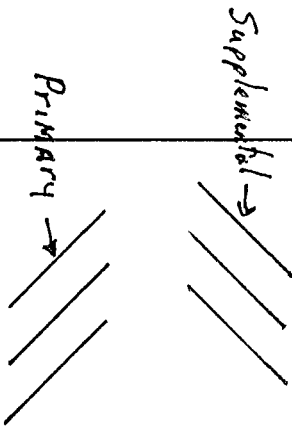

N

UPPER
DAM
WELL

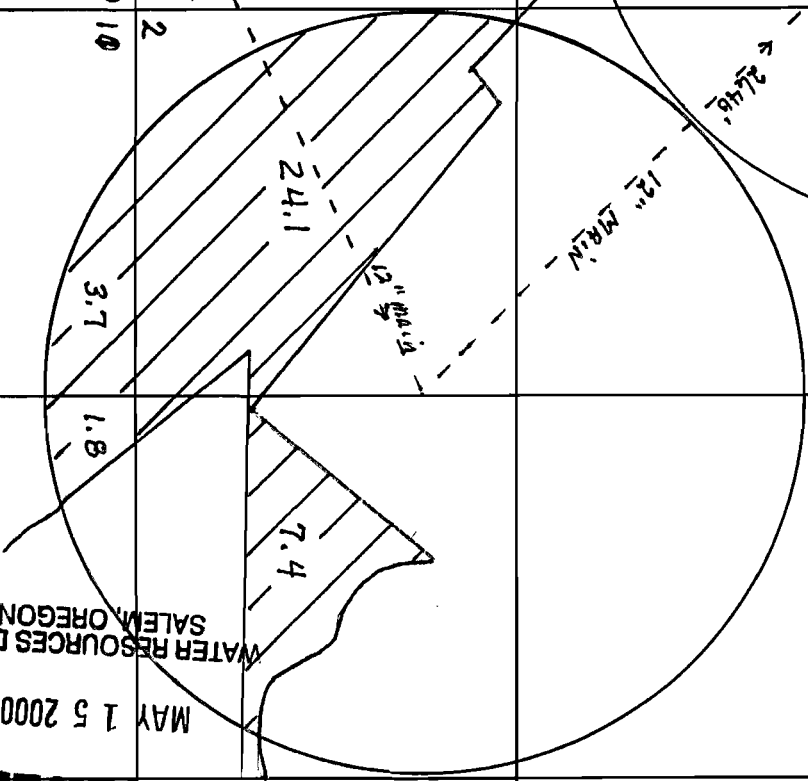
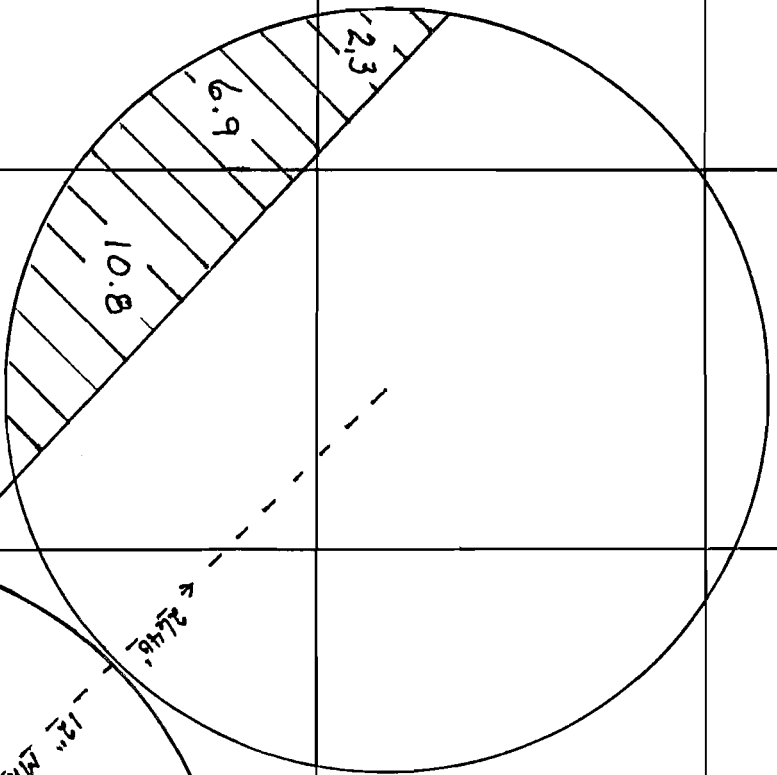
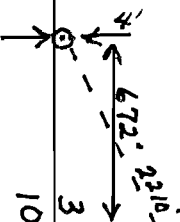

WATER RESOURCES DEPT.
SALEM, OREGON

MAY 15 2000

RECEIVED

R